

STAGE I TRAFFIC CONTROL
 (SIGNING & BARRICADING TO BE INSTALLED
 IN ACCORDANCE WITH STANDARD 701316)

TRAFFIC CONTROL AND STAGING LEGEND

- WORK ZONE
- DIRECTION OF TRAFFIC
- TEMPORARY RUMBLE STRIP
- TYPE III BARRICADES WITH FLASHING LIGHTS
- TRAFFIC SIGNAL

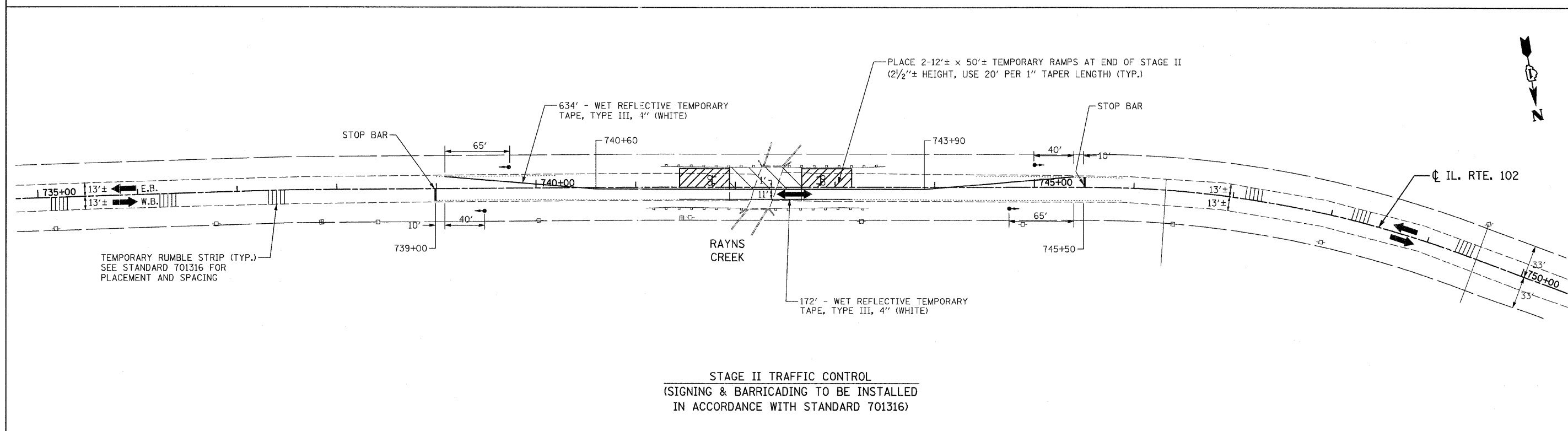

STAGE II TRAFFIC CONTROL
 (SIGNING & BARRICADING TO BE INSTALLED
 IN ACCORDANCE WITH STANDARD 701316)