

EXISTING STRUCTURE:

S.N. 016-2504 Built in 1983 as F.A.U. Route 2612, Section 3104-B(79) Relocated Stephen Street, 18-Span Steel Welded Girders with Concrete Deck with Concrete Planks Structure (Carrying F.A.U. Rte. 2612 over the I.C.G. R.R. I & M Canal, A.T. & S.F. R.R. Chicago Sanitary Drainage & Ship Canal and the Des Plaines River on R.C. Piers, R.C. Abutments and Approach Bents from Sta. 14+65.00 to Sta. 48+18.50). 6 1/2" Neoprene Expansion Joint was replaced with Finger Plate Expansion Joint @ North Abutment in 1995, Section 3104 B-1.

The Existing Structure is to be repaired and overlaid with a Latex Concrete Overlay.

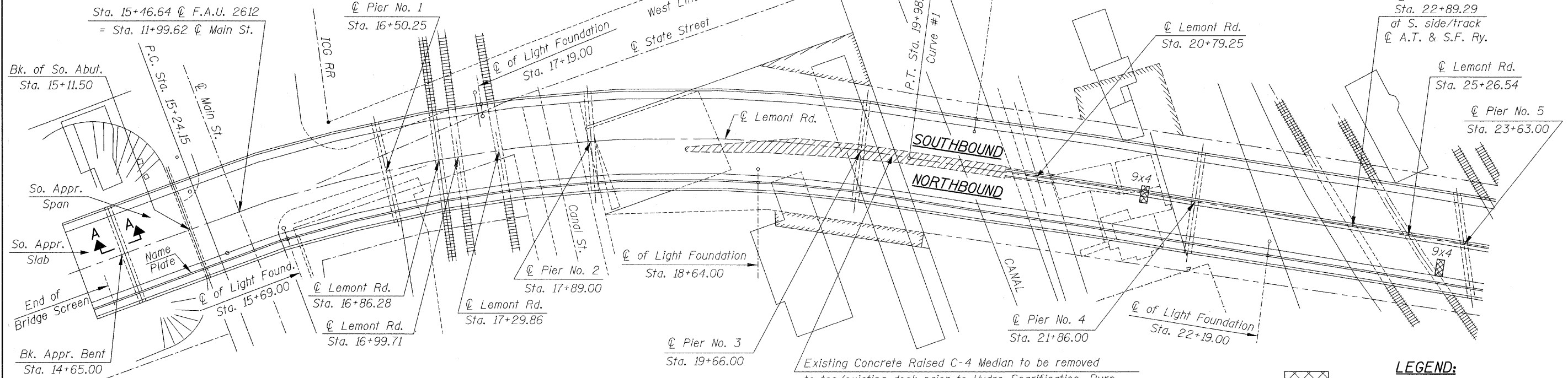

PLAN

Existing Concrete Raised C-4 Median to be removed to top/existing deck prior to Hydro-Scarification. Burn and cut vertical Dowels to top/existing deck. Cost included with Concrete Removal.

LEGEND:

- Deck Slab Repair (Full Depth, Type II) (See Note "A")
- Concrete Removal

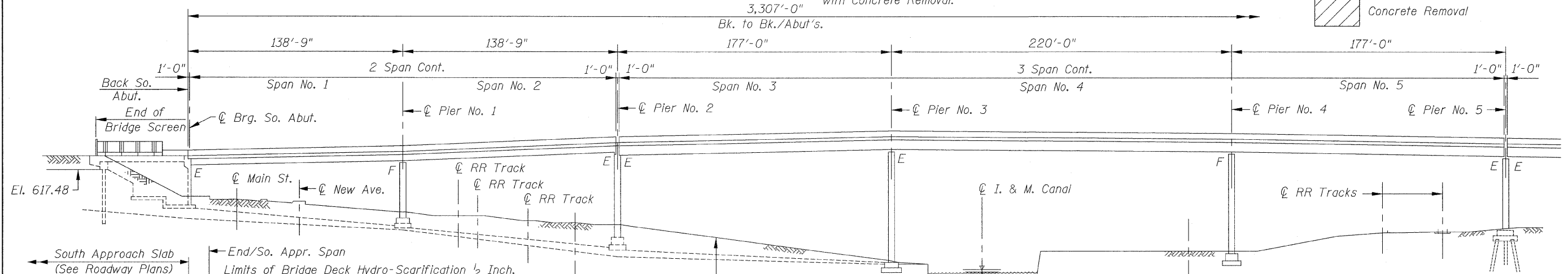

ELEVATION

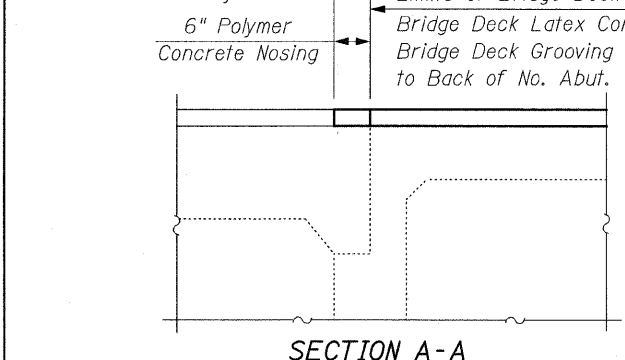

SECTION A-A

BILL OF MATERIAL

Item	Unit	Quantity
Concrete Removal	Cu. Yd.	21
Polymer Concrete	Cu. Ft.	12

NOTE:
All Dimensions are measured horizontally along the @ of Roadway.

NOTE "A"
For Median, Parapet & Deck Reconstruction Details for Deck Slab Repair (Full Depth, Type II), See Shf's. S9, S10 & S11.

CR & A CHRISTIAN-ROGE & ASSOCIATES, INC.
ENGINEERS / PLANNERS / SURVEYORS
211 W. WACKER DRIVE CHICAGO, IL. 60606
PHONE: (312)372-2023 FAX: (312)372-5274