

LIMITS OF PROTECTIVE SHIELD OVER RACINE AVENUE
 The outside Bays are 6'-0" wide by 50'-0" long, times 3 bays = 900 Sq. Ft. = 100 Sq. Yd.

LIMITS OF PROTECTIVE SHIELD OVER NORFOLK SOUTHERN R.R.
 105x6x2x19 = 140 Sq. Yd.

WEST APPROACH **ELEVATION** **GENERAL NOTE:** **EAST APPROACH**

LEGEND:

*** Deck Slab Repair (Full Depth, Type II)

Plan dimensions and details relative to existing plans are subject to routine variations. The Contractor shall field verify existing dimensions and details affecting new construction and make necessary approved adjustments prior to construction or ordering of materials. Such variations shall not be cause for additional compensation for a change in the scope of work, however, the Contractor will be paid for the quantity actually furnished based upon the unit price bid for the work.

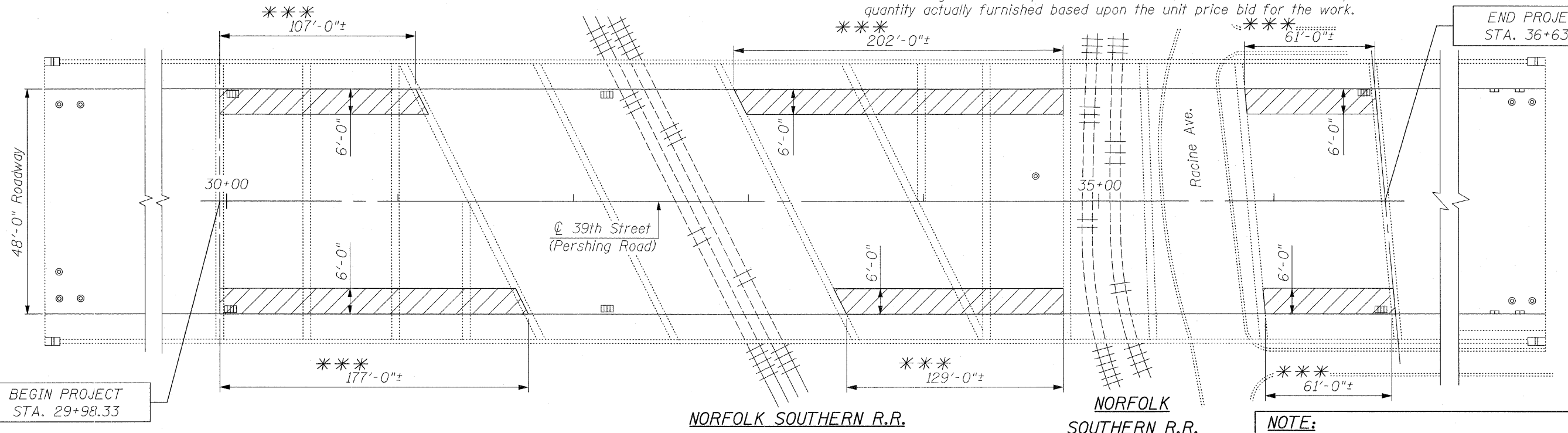

BEGIN PROJECT STA. 29+98.33

END PROJECT STA. 36+63.50

*** Perform full depth repair in stages. Patches shall be 12'x6' maximum with a minimum of 12' of existing Concrete deck between patches. After new Concrete is poured work cannot begin in an adjacent section until both of the following requirements are met:
 1. At least 72 hours shall have elapsed from the end of the previous pour on either end.
 2. The new Concrete on either end shall obtained a modulus of rupture of 650 psi or a minimum compressive strength of 3,500 psi.

NOTE:
 Inspection was conducted on September 28, 2007 by I.D.O.T. Field Maintenance Engineers

TOTAL BILL OF MATERIAL

ITEM	UNIT	QUANTITY
Deck Slab Repair (Full Depth, Type II)	Sq. Yd.	492
Protective Shield (Permanent)	Sq. Yd.	240

CR & A CHRISTIAN-ROGE & ASSOCIATES, INC.
 ENGINEERS / PLANNERS / SURVEYORS
 211 W. WACKER DRIVE CHICAGO, IL 60606
 PHONE: (312)372-2023 FAX: (312)372-5274

FILE NAME = plan.elevation.sht	USER NAME = IDOT	DESIGNED - B.N.S.	REVISED -
		DRAWN - D.L. / F.M.	REVISED -
	PLOT SCALE = 50,0000' / IN.	CHECKED - B.N.S.	REVISED -
	PLOT DATE = 2/17/2009	DATE - FEB. 2, 2009	REVISED -

STATE OF ILLINOIS
 DEPARTMENT OF TRANSPORTATION

GENERAL PLAN & ELEVATION
 39TH STREET (PERSHING ROAD) OVER
 SOUTH RACINE AVENUE
 S.N. 016-0396

F.A.P. RTE.	SECTION	COUNTY	TOTAL SHEETS	SHEET NO.
391	1616 VB-I	COOK	7	4
FED. ROAD DIST. NO.			ILLINOIS FED. AID PROJECT	
			CONTRACT NO. 60D78	