

F.A.I. RTE.	SECTION	COUNTY	TOTAL SHEETS	SHEET NO.
57	2021.1B-R	COOK	101	083
STA.		TO STA.		
FED. ROAD DIST. NO. 1		ILLINOIS	FED. AID PROJECT	
CONTRACT NO. 62532				

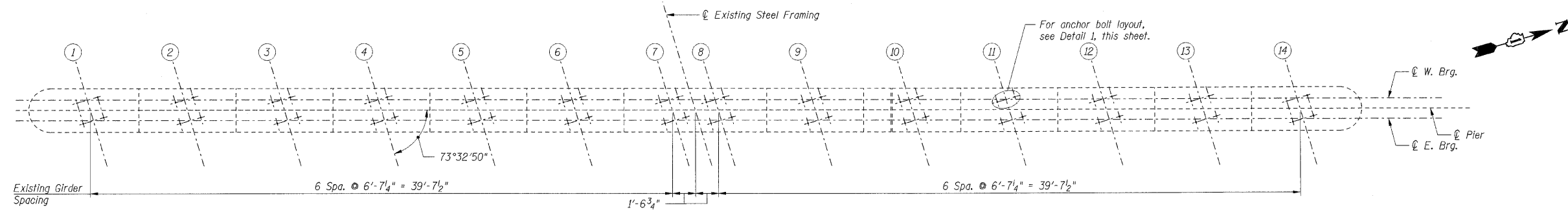

**TOP PLAN**

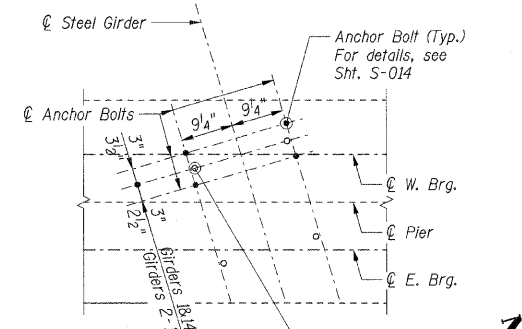

**DETAIL 1**

- Notes:**
- Quantities indicated with a double asterisk (\*\*) are estimated quantities to be determined by the Engineer in the field. Adjustment to the quantities shall not be cause for additional compensation; however the Contractor will be paid for the quantity of work performed at the unit price bid for the work.
  - For anchor bolt installation details, see Sht. S-014.
  - Crack widths are  $\frac{1}{8}'' \pm \frac{1}{16}''$  unless otherwise noted.
  - Girders bearing on the east side of the pier shall be supported during concrete repairs in accordance with the Special Provision for Temporary Shoring and Cribbing.
  - Girders bearing on the west side of the pier shall be supported during concrete repairs. Cost shall be included with Jack and Remove Existing Bearings.
  - Concrete Sealer shall be applied to the bearing seats.

- LEGEND**
- Structural Repair of Concrete, Depth Equal to or Less Than 5"
  - H.L. Hairline Crack - Not to be Sealed

BILL OF MATERIAL		
Item	Unit	Total
Concrete Sealer	Sq Ft	271
Structural Repair of Concrete, Depth Equal to or Less Than 5" **	Sq Ft	950

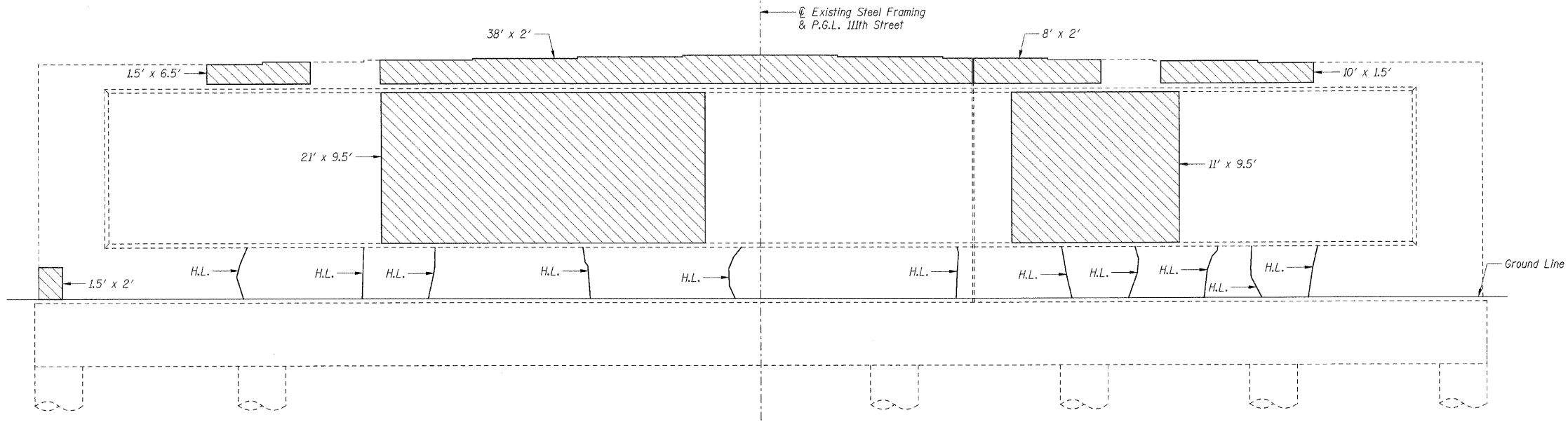

**ELEVATION**  
(Looking West)

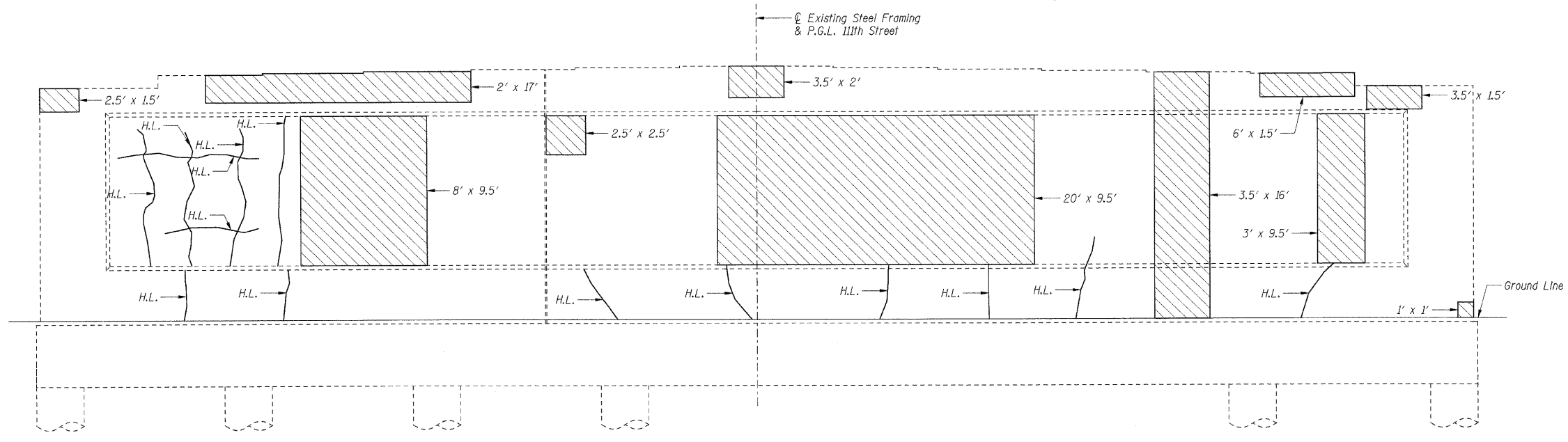

**ELEVATION**  
(Looking East)

REVISIONS	
NAME	DATE

SHT. S-019

ILLINOIS DEPARTMENT OF TRANSPORTATION  
F.A.I. ROUTE 57 (INTERSTATE 57)  
111TH STREET BRIDGE DECK REPLACEMENT  
111TH STREET OVER I-57  
SN 016-0989 STA. 556+99.89  
COOK COUNTY

PIER 2 REPAIRS

DATE: 01/16/09

DRAWN BY: TMH  
CHECKED BY: JLR

**TENG**  
TENG & ASSOCIATES, INC.  
ENGINEERS/ARCHITECTS/PLANNERS  
205 N. MICHIGAN AVE., CHICAGO, IL 60601  
TELEPHONE: 312.618.0000

\CPECONFE2\DCAL\BRBORBER.DGN \VPROJNT\DCAL\ART00085.DGN \VPROJ080.DGN HUGHJHM  
 3-03-2009 14:47:39 T:\DOCUMENT\830860\STRUCT\DCAL\PROJ\BRBORBER.DGN color: tabler: K:\STANDARD\TENG\DATA\COLORTABLE.TBL  
 pen: tabler: N/A