

SCHEDULE OF QUANTITIES
MAGNETIC DETECTOR AND LOOP DETECTOR REPLACEMENT

QUANTITY	UNIT	PAY ITEM
748	FOOT	ELECTRIC CABLE IN CONDUIT, LEAD-IN, NO. 14 1 PAIR
2	EACH	INDUCTIVE LOOP DETECTOR
66	FOOT	DETECTOR LOOP, TYPE I
260	FOOT	DETECTOR LOOP REPLACEMENT
1	EACH	MAINTENANCE OF EXISTING TRAFFIC SIGNAL INSTALLATION
0	FOOT	TRENCH AND BACKFILL FOR ELECTRICAL WORK
3	EACH	DRILL EXISTING HANDHOLE
540	FOOT	REMOVE ELECTRICAL CABLE FROM CONDUIT

NOTE:
 THIS PLAN IS FOR THE PURPOSE OF REPLACING THE DETECTOR LOOPS ONLY. ALL OTHER INFORMATION SHOWN IS NOT RELATED AND WILL BE DISREGARDED

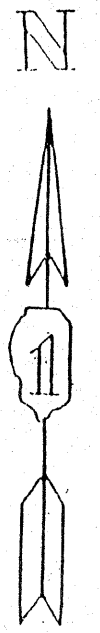
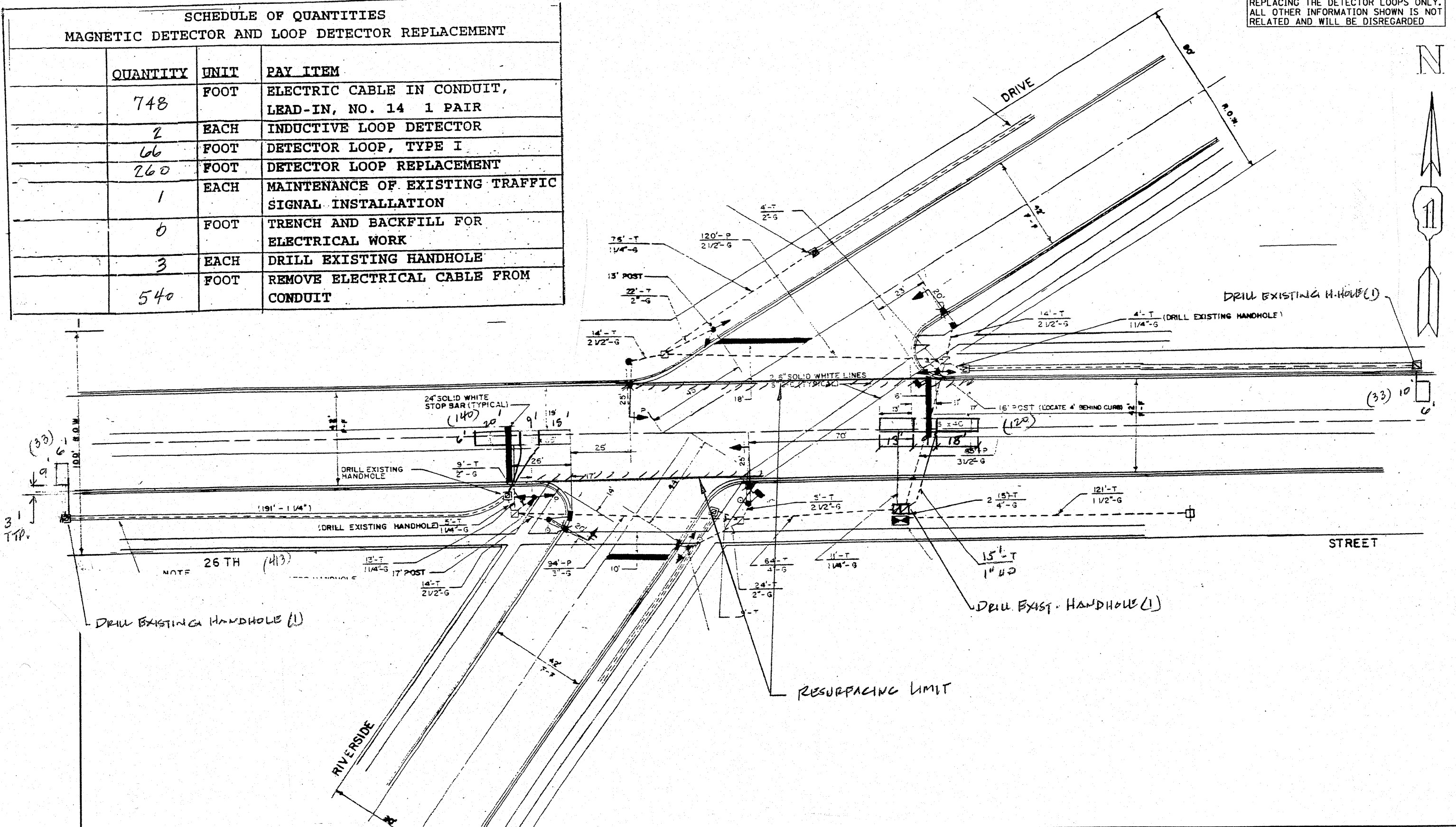

FILE NAME =
 USER NAME = guillaumefp
 PLOT SCALE = 1/8\"/>

CHECKED
 DATE

STATE OF ILLINOIS
DEPARTMENT OF TRANSPORTATION

26TH STREET /25TH PLACE (IL 43 TO IL 50)
26TH STREET & RIVERSIDE

F.A.J. RTE.	SECTION	COUNTY	TOTAL SHEETS	SHEET NO.
1459	(0505.1, 0606 & 0707) RS-12	COOK	32	14
FED. ROAD DIST. NO. 1 ILLINOIS FED. AID PROJECT			CONTRACT NO. 62818	

SCALE: SHEET NO. OF SHEETS STA. TO STA.