

F.A.P. RTE.	SECTION	COUNTY	TOTAL SHEETS	SHEET NO.
681	(115)RS-1	LIVINGSTON	279	111
STA. 161+00		TO STA. 167+00		
FED. ROAD DIST. NO.		ILLINOIS FED. AID PROJECT		
CONTRACT NO. 66375				

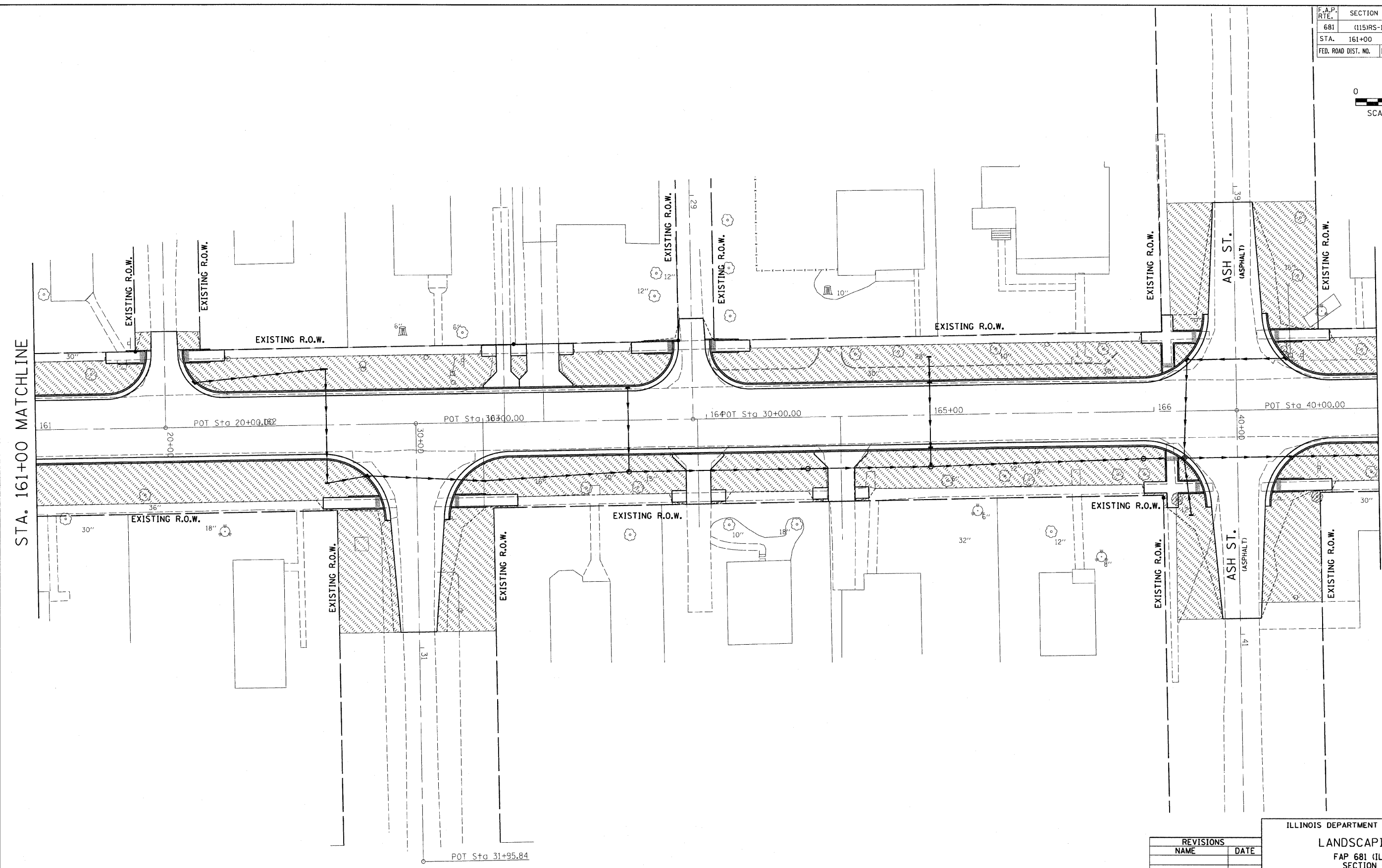
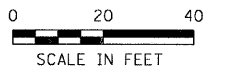

STA. 161+00 MATCHLINE

STA. 167+00 MATCHLINE

REVISIONS	
NAME	DATE

ILLINOIS DEPARTMENT OF TRANSPORTATION
LANDSCAPING PLAN
 FAP 681 (IL RTE. 116)
 SECTION (115)RS-1
 LIVINGSTON COUNTY
 VILLAGE OF CULLOM

SCALE: AS SHOWN DRAWN BY: CAR
 DATE CHECKED BY: TMM

McDonough-Whitlow, P.C.
 Consulting Engineers & Land Surveyors

138 East Wood Street
 Hillboro, IL 62049
 Phone: 217.532.9233
 Fax: 217.532.6300
 MW PROJ. 03-060

1/8/2005 4:05:48 PM 3:\3145\UN\HW\116\RS-1\LANDSCAPE.dgn