

F.A.P. RTE.	SECTION	COUNTY	TOTAL SHEETS	SHEET NO.
681	115R5-1	LIVINGSTON	279	169
STA. 165+95.00		TO STA. 166+00.00		
FED. ROAD DIST. NO. ILLINOIS		FED. AID PROJECT		
		CONTRACT NO. 66375		

DESIGN		
INT.	DATE	REASON

BY	DATE

PLOTS & CHECKS			
INT.	DATE	NO.	REASON

BY	DATE

CHECKS		
INT.	DATE	REASON

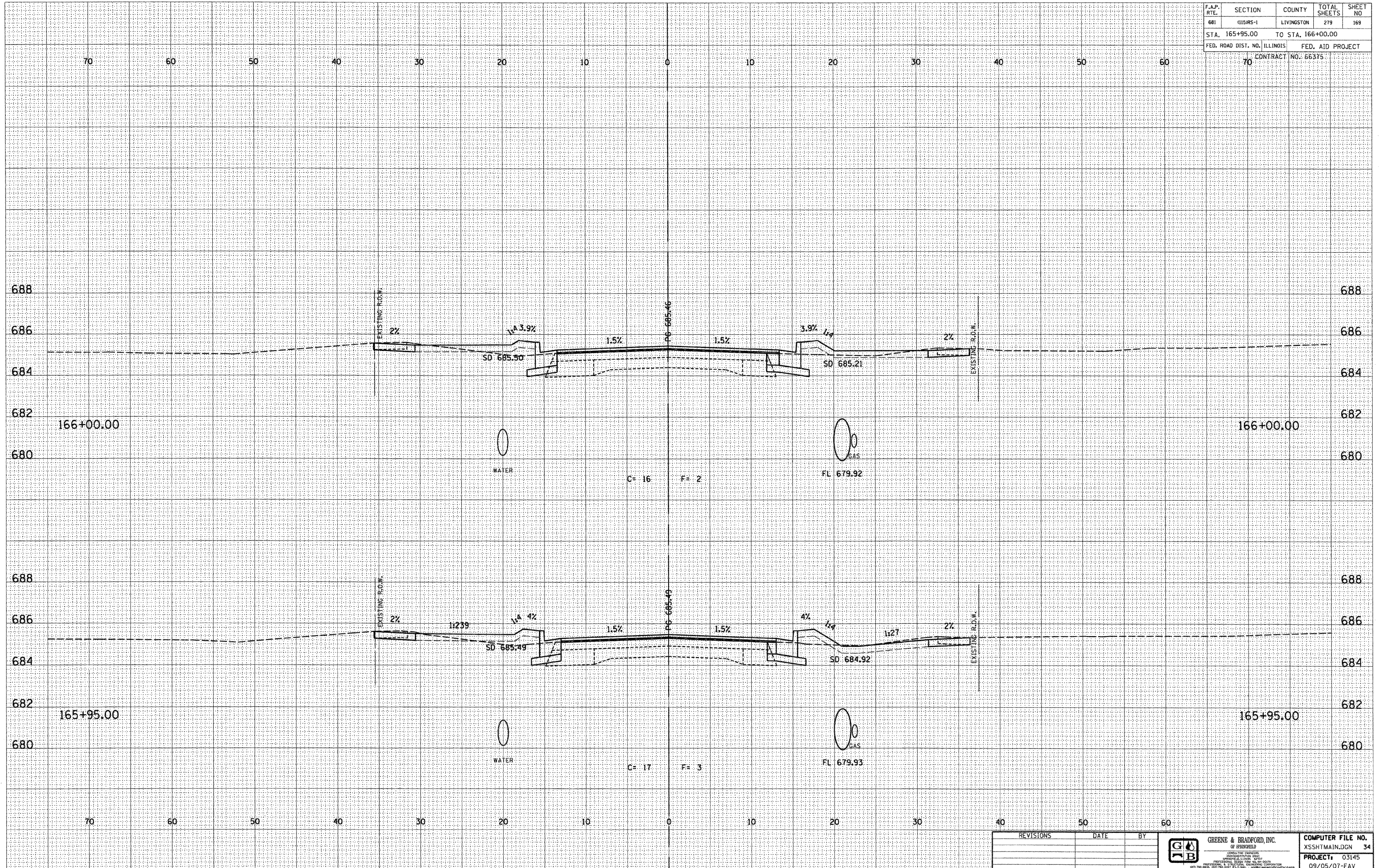

REVISIONS	DATE	BY

GREENE & BRADFORD, INC.
 OF SPRINGFIELD
 ENGINEERS, ARCHITECTS, SURVEYORS
 1001 N. WASHINGTON ST., SPRINGFIELD, ILL. 62761
 (217) 786-6200 FAX (217) 786-6201

COMPUTER FILE NO.	XSSHTMAIN.DGN	34
PROJECT:	03145	
	09/05/07-FAV	

E-XSEC 2:1 06/09/03

CROSS SECTIONS - FAP 681 (IL RTE. 116) LIVINGSTON COUNTY
 STA. 165+95.00 TO STA. 166+00.00