

F.A.P. RTE.	SECTION	COUNTY	TOTAL SHEETS	SHEET NO.
681	115RS-1	LIVINGSTON	279	177
STA. 168+75.00		TO STA. 168+96.05		
FED. ROAD DIST. NO. ILLINOIS			FED. AID PROJECT	
70			CONTRACT NO. 66375	

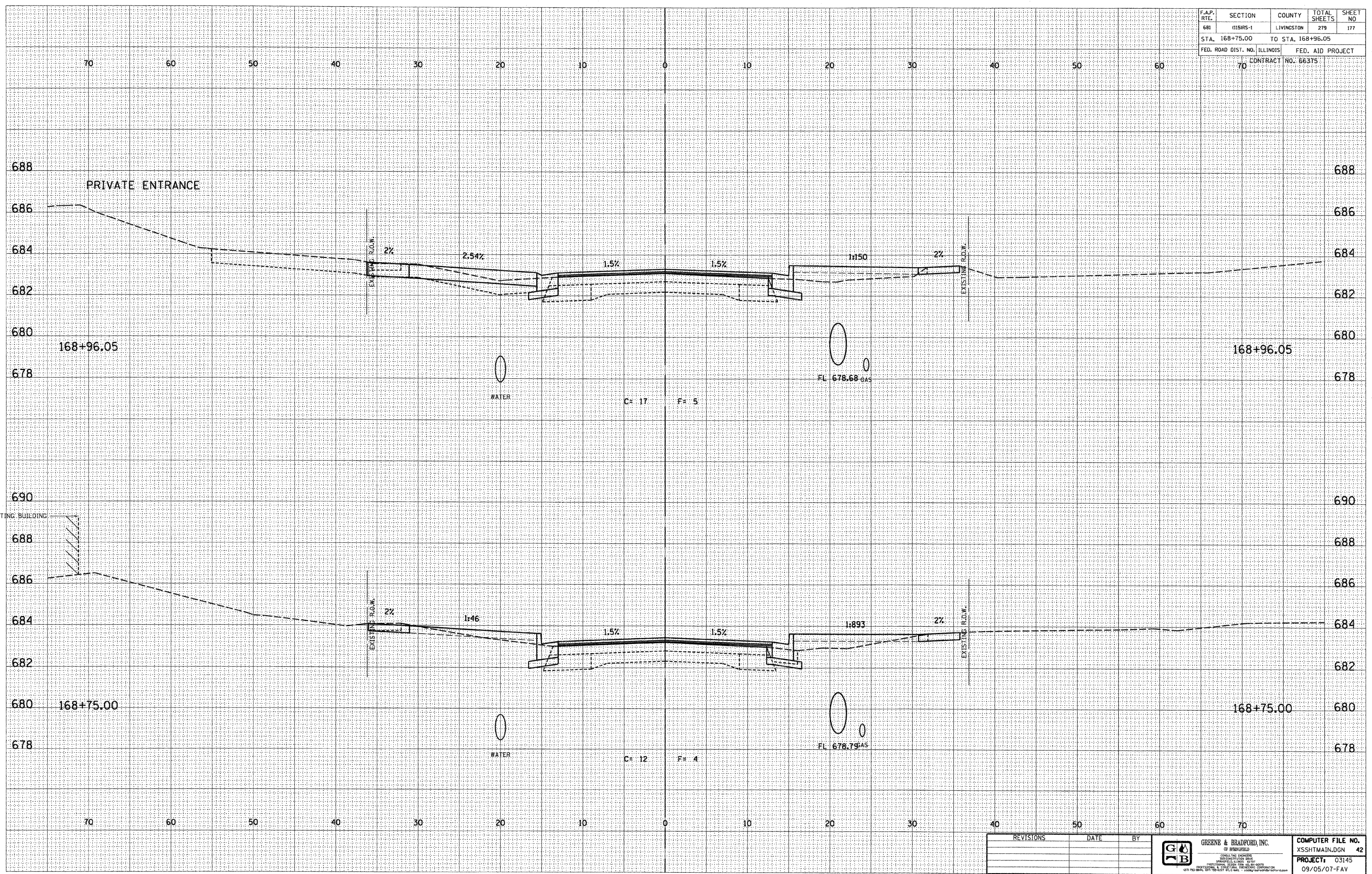

DESIGN		
INT.	DATE	REASON

BY	DATE

PLOTS & CHECKS			
INT.	DATE	NO.	REASON

BY	DATE

CHECKS		
INT.	DATE	REASON

REVISIONS	DATE	BY

**GREENE & BRADFORD, INC.**  
 OF SPRINGFIELD  
 CONSULTING ENGINEERS  
 1000 W. MONROE STREET  
 SPRINGFIELD, ILLINOIS 62761-3008  
 PHONE: 217-223-1111 FAX: 217-223-1112  
 WWW: WWW.GREENE-AND-BRADFORD.COM

**COMPUTER FILE NO.**  
 XSSHTMAIN.DGN 42  
**PROJECT:** 03145  
 09/05/07-FAV

E-XSEC 2:1 06/09/03

CROSS SECTIONS - FAP 681 (IL RTE. 116) LIVINGSTON COUNTY  
 STA. 168+75.00 TO STA. 168+96.05