

F.A.P. RTE.	SECTION	COUNTY	TOTAL SHEETS	SHEET NO.
681	116SR5-1	LIVINGSTON	279	212
STA. 180+27.00		TO STA. 180+40.61		
FED. ROAD DIST. NO. ILLINOIS			FED. AID PROJECT	
70			CONTRACT NO. 66375	

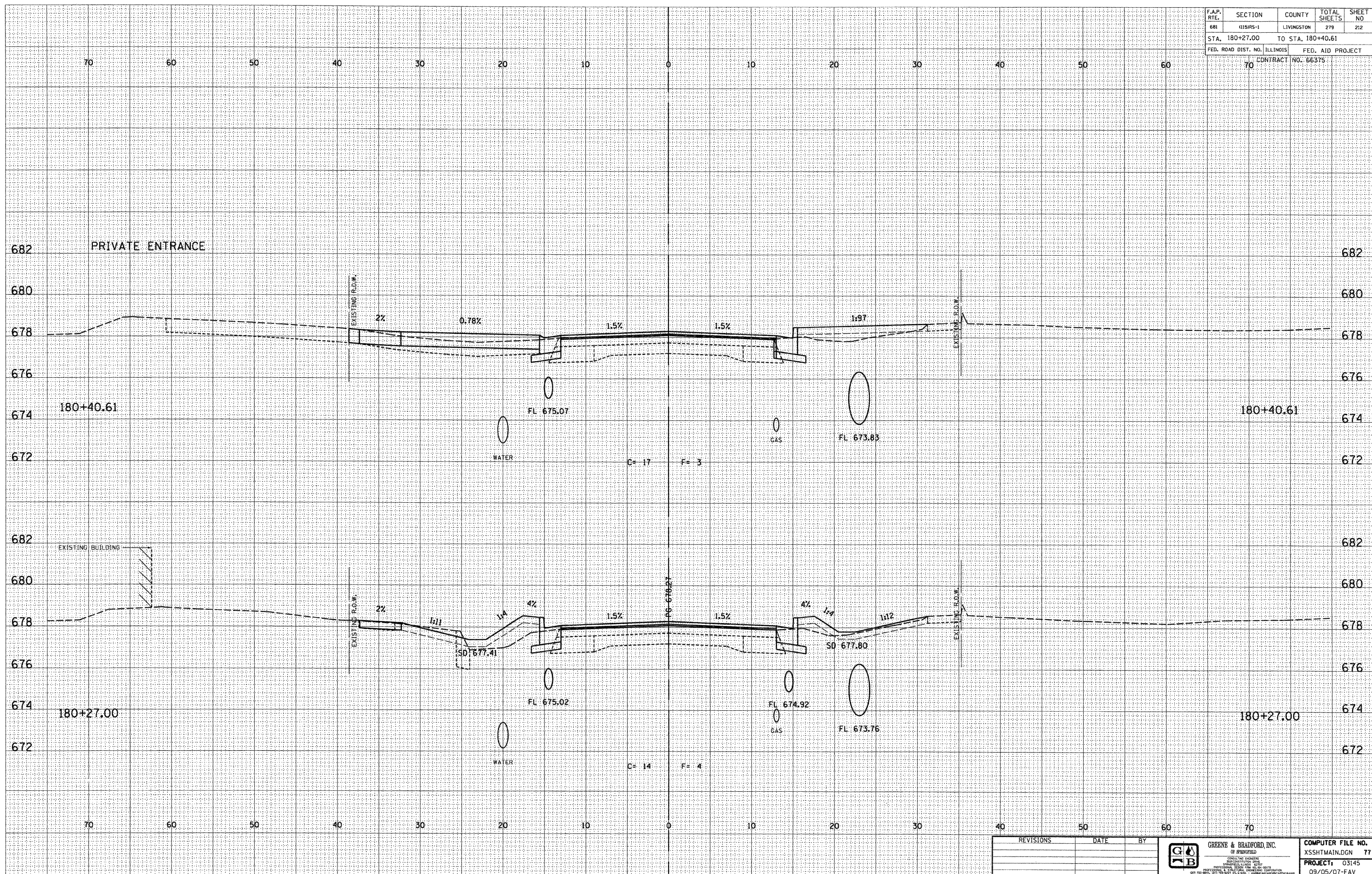

DESIGN		
INT.	DATE	REASON

BY	DATE

PLOTS & CHECKS			
INT.	DATE	NO.	REASON

BY	DATE

CHECKS		
INT.	DATE	REASON

REVISIONS	DATE	BY

GREENE & BRADFORD, INC.
 CIVIL ENGINEERS
 1100 W. MONROE ST.
 SPRINGFIELD, ILLINOIS 62761
 (618) 266-1111

COMPUTER FILE NO.	XSSHTMAIN.DGN	77
PROJECT:	03145	
	09/05/07-FAV	

E-XSEC 21 06/09/03

CROSS SECTIONS - FAP 681 (IL RTE. 116) LIVINGSTON COUNTY
 STA. 180+27.00 TO STA. 180+40.61