

F.A.P. RTE.	SECTION	COUNTY	TOTAL SHEETS	SHEET NO.
681	(115)RS-1	LIVINGSTON	279	261
STA. 194+50.00		TO STA. 194+75.00		
FED. ROAD DIST. NO.	ILLINOIS	FED. AID PROJECT		
70	CONTRACT NO. 66375			

DESIGN		
INT.	DATE	REASON

DATE	BY	NO.

PLOTS & CHECKS			
INT.	DATE	NO.	REASON

DATE	BY	NO.

CHECKS		
INT.	DATE	REASON

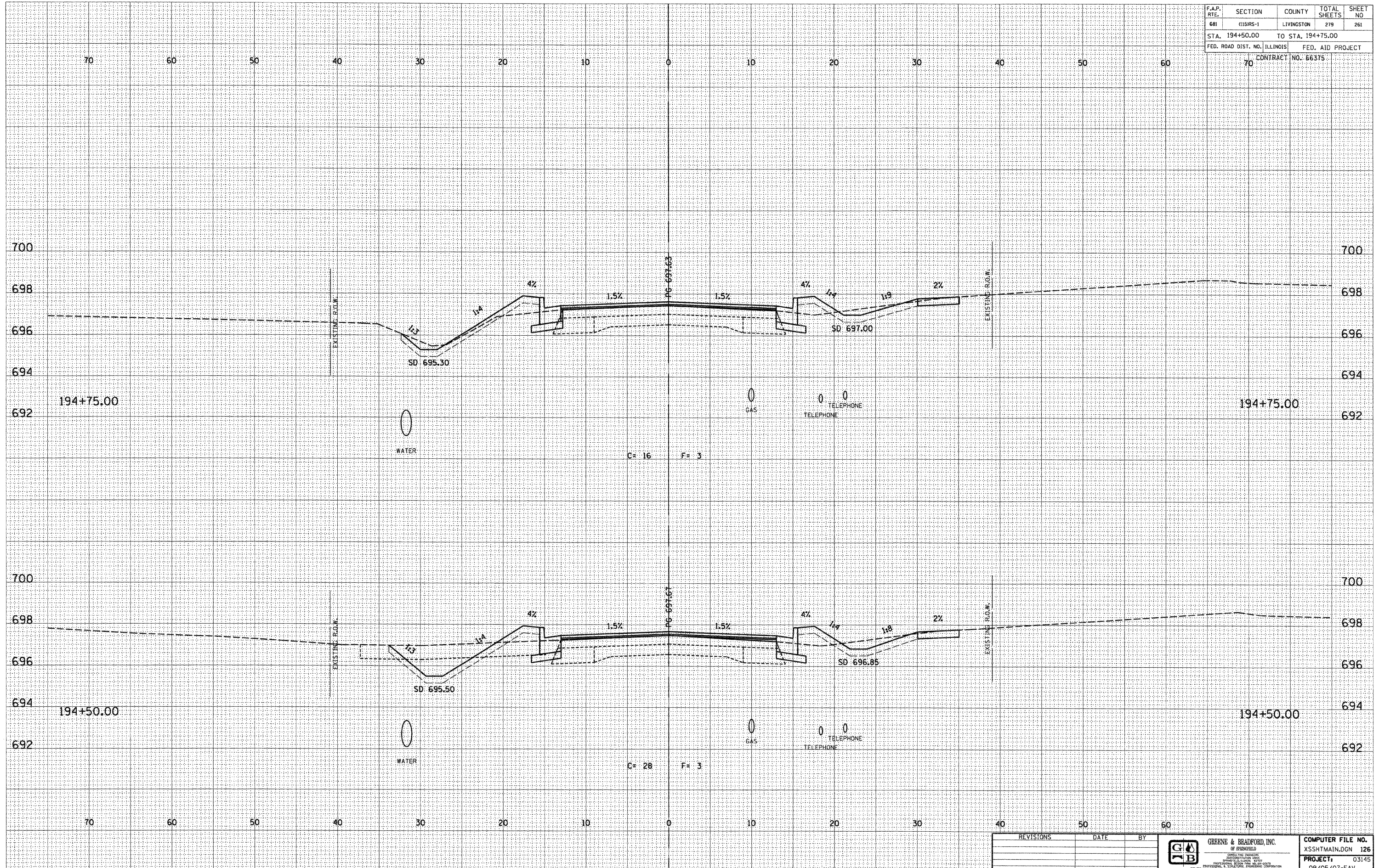

REVISIONS	DATE	BY

**GREENE & BRADFORD, INC.**  
 OF SPRINGFIELD  
 ENGINEERS, ARCHITECTS, SURVEYORS  
 1001 N. WASHINGTON ST., SPRINGFIELD, ILL. 62762  
 (217) 522-8844, (217) 522-7171 FAX • www.greenesbradford.com

**COMPUTER FILE NO.**  
 XSSHTMAIN.DGN 126  
**PROJECT:** 03145  
 09/05/07-FAV

E-XSEC 2:1 06/09/03

CROSS SECTIONS - FAP 681 (IL RTE. 116) LIVINGSTON COUNTY  
 STA. 194+50.00 TO STA. 194+75.00