

F.A.P. RTE.	SECTION	COUNTY	TOTAL SHEETS	SHEET NO.
323	(143,R,144)RS-4	*	56	1

* DOUGLAS & PIATT

STATE OF ILLINOIS
DEPARTMENT OF TRANSPORTATION
DIVISION OF HIGHWAYS

**PROPOSED
HIGHWAY PLANS**
F.A.P. ROUTE 323 (US 36)
SECTION (143,R,144)RS-4
DOUGLAS & PIATT COUNTIES
RESURFACING (3P)

FOR INDEX OF SHEETS, SEE SHEET NO. 2
FOR SUMMARY OF QUANTITIES, SEE SHEET NO. 4-5
FOR EXISTING STRUCTURE TYPES SEE SHEET 2

D-95-050-02

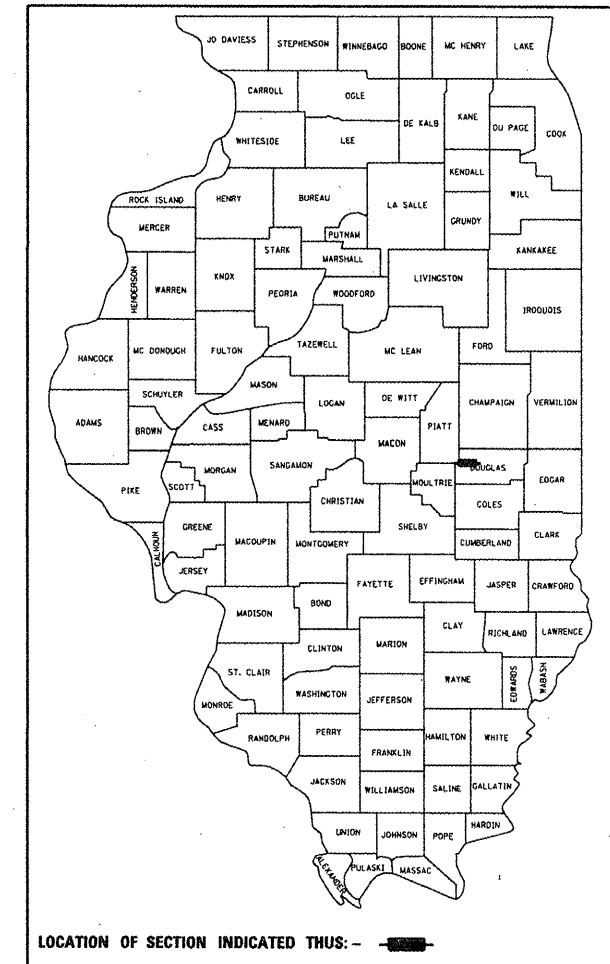

LOCATION OF SECTION INDICATED THUS: - [black box] -

CURRENT TRAFFIC DATA				
	LEG A	LEG B	LEG C	LEG D
CURRENT ADT	4,050	4,450	5,400	5,900
20 YR. ADT	4,450	4,900	5,900	6,500
P.U. & P.C. %	85.9	85.0	87.0	88.6
S.U. %	5.0	5.8	4.6	5.0
M.U. %	9.1	9.2	8.4	6.4

MOULTRIE COUNTY LINE TO WASHINGTON ST. IN TUSCOLA

C-95-098-02

PROJECT ESP-0323(026)

STATION EQUATION:
STATION 765+84.00 BK =
STATION 0+00.00 AH

SECTION (143,R,144)RS-4
BEGINS STA 759+39.00

STATION EQUATION:
STATION 18+37.66 BK =
STATION 18+78.66 AH

STATION EQUATION:
STATION 315+83.74 BK =
STATION 316+00.00 AH

STATION EQUATION:
STATION 482+06.78 BK =
STATION 482+17.54 AH

STATION EQUATION:
STATION 492+13.60 BK =
STATION 103+00.00 AH

DESIGN DESIGNATION

OTHER PRINCIPAL ARTERIAL

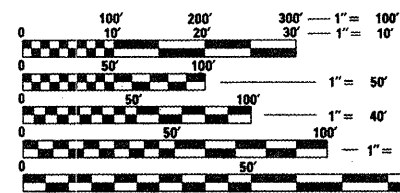

FULL SIZE PLANS HAVE BEEN PREPARED USING STANDARD ENGINEERING SCALES. REDUCED SIZED PLANS WILL NOT CONFORM TO STANDARD SCALES. IN MAKING MEASUREMENTS ON REDUCED PLANS, THE ABOVE SCALES MAY BE USED.

J.U.L.I.E.
JOINT UTILITY LOCATION INFORMATION FOR EXCAVATION
1-800-892-0123 *

* (UNITY, LOWE, GARRETT & TUSCOLA TOWNSHIPS)

CONTRACT NO. 70256

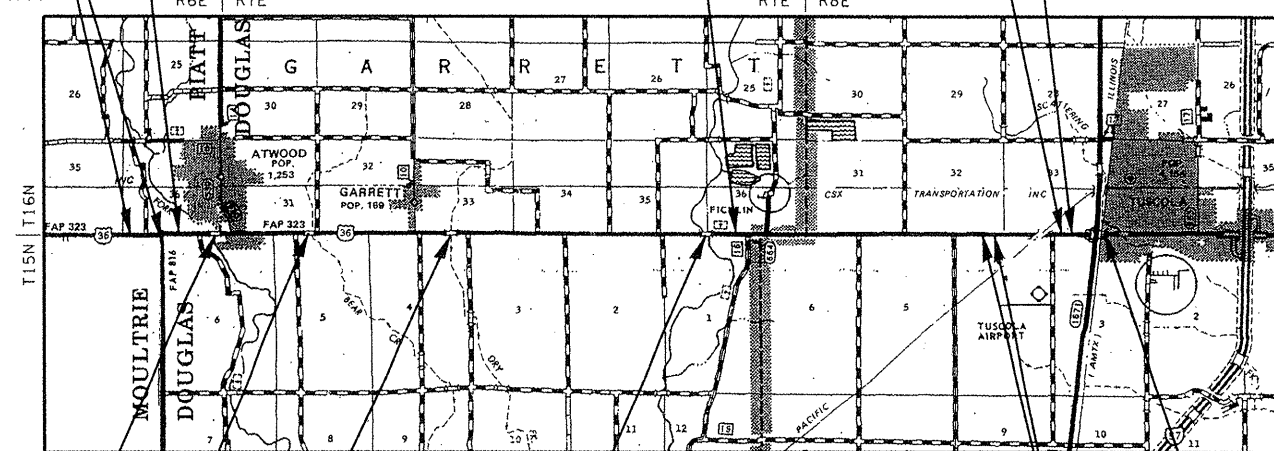

Ⓐ OMISSION FROM RESURFACING
STA 28+82.00 TO STA. 30+65.00
SN 021-0051

Ⓐ MILL & INLAY 1 1/2"
STA 81+95.00 TO 82+19.00
SN 021-0016

Ⓑ OMISSION FROM RESURFACING
STA 156+42.5 TO STA 157+15.00
SN 021-0017

Ⓒ OMISSION FROM RESURFACING
STA 294+41.00 TO STA 296+75.00
SN 021-0018

Ⓒ OMISSION FROM RESURFACING
STA 461+52.00 TO STA 461+71.50
SN 021-2012

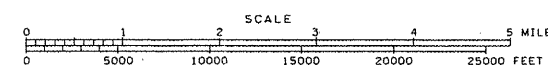

TOTAL LENGTH OF SECTION & PROJECT = 51,179.08 FEET = 9.693 MILES
NET LENGTH OF SECTION & PROJECT = 50,670.08 FEET = 9.597 MILES

STATE OF ILLINOIS
DEPARTMENT OF TRANSPORTATION
DIVISION OF HIGHWAYS

SUBMITTED 1/23 20 09
Debra K. Rowe
DEPUTY DIRECTOR OF HIGHWAYS, REGION THREE ENGINEER

March 13, 20 09
Charles J. Ingersoll
ENGINEER OF DESIGN AND ENVIRONMENT

March 13, 20 09
Christine M. Reed
DIRECTOR OF HIGHWAYS, CHIEF ENGINEER

PRINTED BY THE AUTHORITY OF THE STATE OF ILLINOIS