

FOR THE COMPLETION OF
RAMP J & RAMP F (AT I-74)
SEE SHEET NO. 51

FOR RAMP O (CONNECTING VETERANS
PARKWAY NB WITH I-74 EB)
SEE SHEET NO. 52

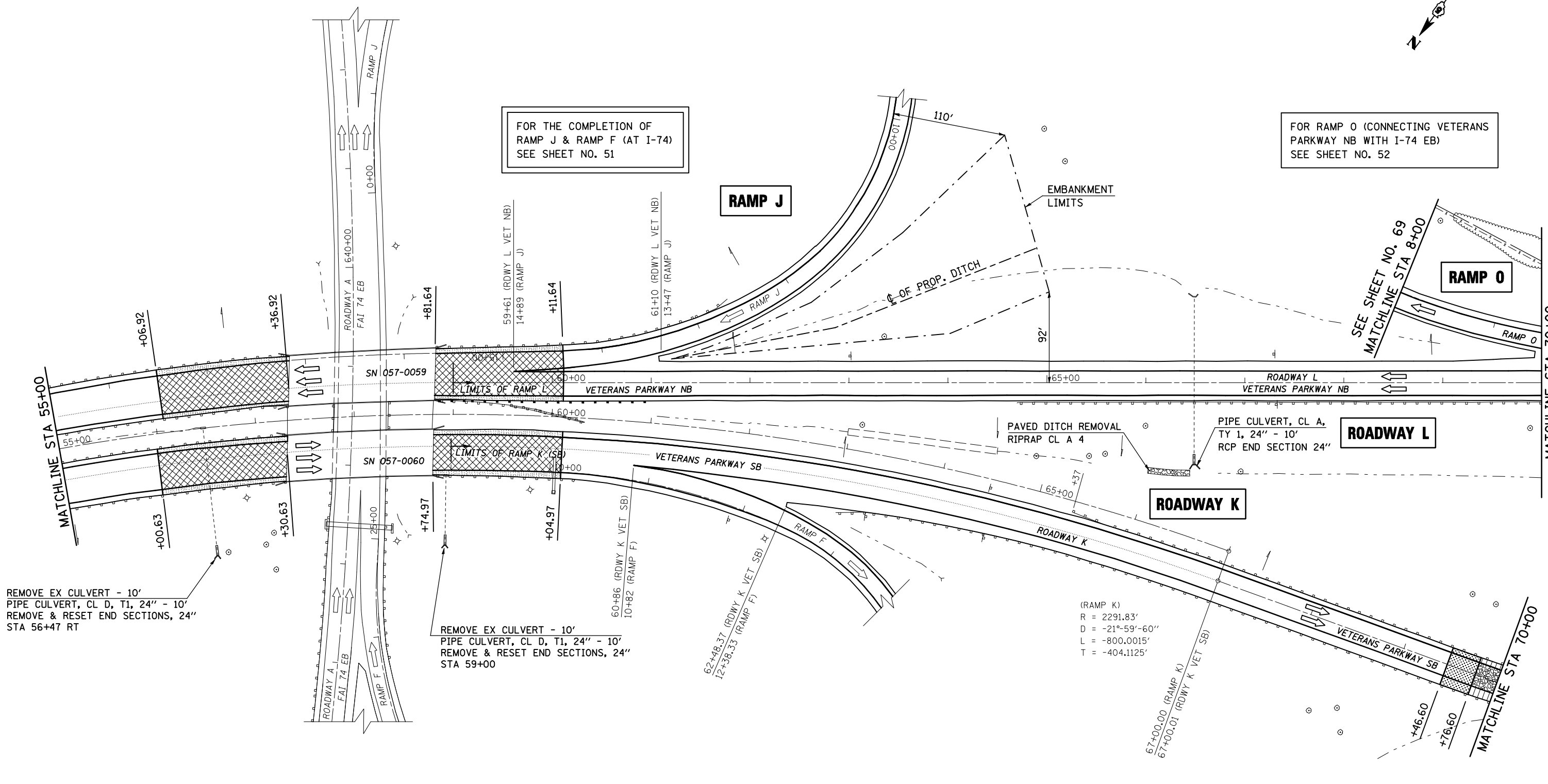

REMOVE EX CULVERT - 10'
PIPE CULVERT, CL D, T1, 24" - 10'
REMOVE & RESET END SECTIONS, 24"
STA 56+47 RT

REMOVE EX CULVERT - 10'
PIPE CULVERT, CL D, T1, 24" - 10'
REMOVE & RESET END SECTIONS, 24"
STA 59+00

(RAMP K)
R = 2291.83'
D = -21°-59'-60"
L = -800.0015'
T = -404.1125'

- MILLING TRANSITION FOR STRUCTURES
- MILLING TRANSITION FOR UNDER S.N. 057-0004
- HMA SURFACE REMOVAL- 1 1/2"
- HMA SURFACE REMOVAL-BUTT JOINT
- HMA SURFACE REMOVAL-3 1/4"

FOR MILLING TRANSITION DETAILS
SEE SHEET NO. 87-90

FOR GUARDRAIL DETAILS
SEE SHEET NO. 120-132

SHEET 3 OF 4

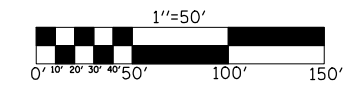

FILE NAME =	USER NAME = shererjm	DESIGNED - JMS	REVISED -	STATE OF ILLINOIS DEPARTMENT OF TRANSPORTATION	VETERANS PARKWAY NORTHBOUND & SOUTHBOUND	F.A.I. RTE. =	SECTION =	COUNTY =	TOTAL SHEETS =	SHEET NO. =	
ct:\pw\work\PWIDOT\SHERERJM\dms83233\7055SHEETS.DGN		DRAWN - JRP	REVISED -			74	57-20(1) & (57-4,5,6)RS-3	MCLEAN	160	65	
PLOT SCALE = 100.0000' / IN.		CHECKED -	REVISED -			CONTRACT NO. 70505					
PLOT DATE = 1/30/2009		DATE - 05-20-08	REVISED -			FED. ROAD DIST. NO. ILLINOIS FED. AID PROJECT					

SCALE: 1" = 50' PLAN VIEW SHEET 19 OF 21 STA 55+00 TO STA 70+00 (NB & SB)