

F.A.I. RTE.	SECTION	COUNTY	TOTAL SHEETS	SHEET NO.
172	*	ADAMS	108	52
STA. 248+58.31		TO STA. 263+93.90		
FED. ROAD DIST. NO. 6 ILLINOIS FED. AID PROJECT				

**\* (1-5)RS-1; (1-6)RS  
CONTRACT NO. 72694**



**CURVE RAMP D**  
P.I. STA= 12+15.04  
 $\Delta$ = 47°11'43" RT  
D= 7°30'00"  
R= 763.94'  
T= 333.72'  
L= 629.27'  
E=  
PR SE= 8.00%  
T.R.= 44.4'  
S.E. RUN= 236.80'  
P.C. STA= 8+81.32  
P.T. STA= 15+10.59  
SE TRANS.:  
STA 7+61.32 TO STA 9+98.12  
STA 14+31.62 TO STA 16+43.97

S.N. 001-0047	EXISTING BRIDGE CLEARANCES					
	SB			NB		
	EOP	CL	EOP	EOP	CL	EOP
NORTH BEAM	16.33	16.55	16.70	16.45	16.72	16.94
SOUTH BEAM	17.69	17.90	18.15	17.95	18.08	18.32

NOTE: 16.0' MIN. CLEARANCE MUST BE MAINTAINED AFTER RESURFACING (SEE RAMP DETAILS).

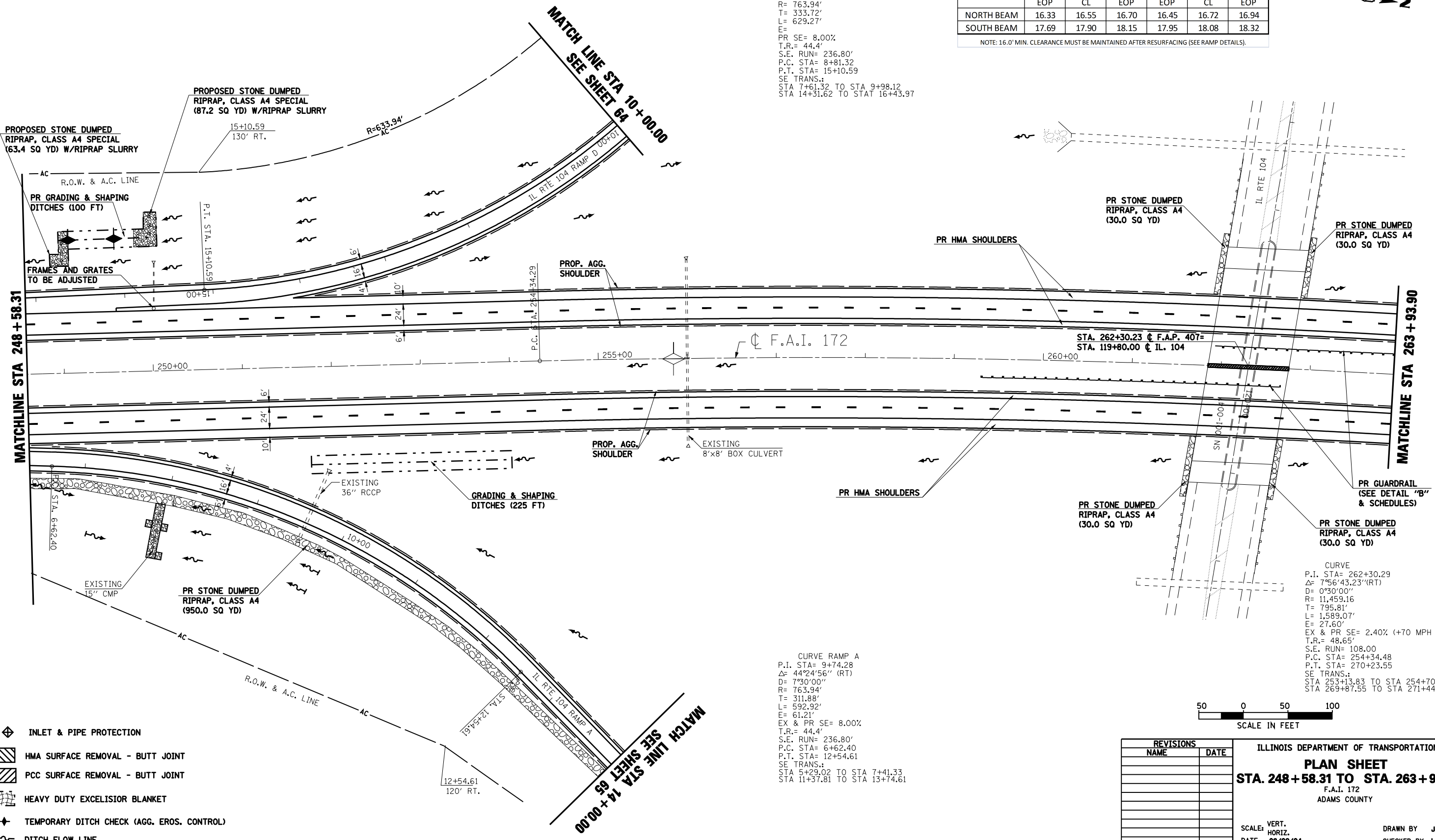

MATCHLINE STA 248 + 58.31

MATCHLINE STA 263 + 93.90

- INLET & PIPE PROTECTION
- HMA SURFACE REMOVAL - BUTT JOINT
- PCC SURFACE REMOVAL - BUTT JOINT
- HEAVY DUTY EXCELSIOR BLANKET
- TEMPORARY DITCH CHECK (AGG. EROS. CONTROL)
- DITCH FLOW LINE

**CURVE RAMP A**  
P.I. STA= 9+74.28  
 $\Delta$ = 44°24'56" (RT)  
D= 7°30'00"  
R= 763.94'  
T= 311.88'  
L= 592.92'  
E= 61.21'  
EX & PR SE= 8.00%  
T.R.= 44.4'  
S.E. RUN= 236.80'  
P.C. STA= 6+62.40  
P.T. STA= 12+54.61  
SE TRANS.:  
STA 5+29.02 TO STA 7+41.33  
STA 11+37.81 TO STA 13+74.61

**CURVE**  
P.I. STA= 262+30.29  
 $\Delta$ = 7°56'43.23" (RT)  
D= 0°30'00"  
R= 11,459.16'  
T= 795.81'  
L= 1,589.07'  
E= 27.60'  
EX & PR SE= 2.40% (+70 MPH DESIGN)  
T.R.= 48.65'  
S.E. RUN= 108.00'  
P.C. STA= 254+34.48  
P.T. STA= 270+23.55  
SE TRANS.:  
STA 253+13.83 TO STA 254+70.48  
STA 269+87.55 TO STA 271+44.20

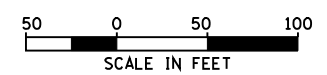

REVISIONS	
NAME	DATE

ILLINOIS DEPARTMENT OF TRANSPORTATION  
**PLAN SHEET**  
**STA. 248 + 58.31 TO STA. 263 + 93.30**  
F.A.I. 172  
ADAMS COUNTY

SCALE: VERT. \_\_\_\_\_  
HORIZ. \_\_\_\_\_  
DATE: 08/09/04  
DRAWN BY: JJS  
CHECKED BY: LLQ