

F.A. RTE.	SECTION	COUNTY	TOTAL SHEETS	SHEET NO.
172	*	ADAMS	108	67
STA. 190+13.56		TO STA. 205+48.66		
FED. ROAD DIST. NO. 6 ILLINOIS FED. AID PROJECT				

\* (1-5)RS-1; (1-6)RS  
CONTRACT NO. 72694

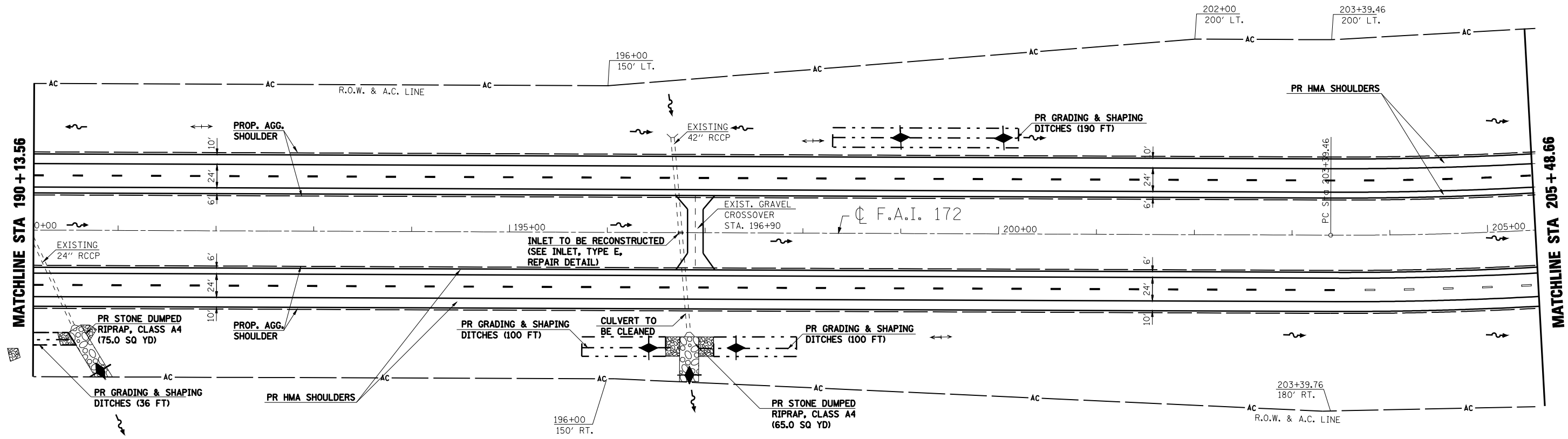

- ◆ INLET & PIPE PROTECTION
- ▨ HMA SURFACE REMOVAL - BUTT JOINT
- ▩ PCC SURFACE REMOVAL - BUTT JOINT
- ▧ HEAVY DUTY EXCELISIOR BLANKET
- ✦ TEMPORARY DITCH CHECK (AGG. EROS. CONTROL)
- ~ DITCH FLOW LINE

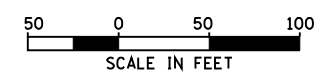

REVISIONS	
NAME	DATE

ILLINOIS DEPARTMENT OF TRANSPORTATION  
**PLAN SHEET**  
**STA. 190+13.56 TO STA. 205+48.66**  
F.A.I. 172  
ADAMS COUNTY

SCALE: VERT. \_\_\_\_\_  
HORIZ. \_\_\_\_\_  
DATE: 08/09/04  
DRAWN BY: JJS  
CHECKED BY: LLQ