

F.A.I. RTE.	SECTION	COUNTY	TOTAL SHEETS	SHEET NO.
172	*	ADAMS	108	70
STA. 236+30.36		TO STA. 248+00		
FED. ROAD DIST. NO. 6 ILLINOIS FED. AID PROJECT				

*** (1-5)RS-1; (1-6)RS
CONTRACT NO. 72694**

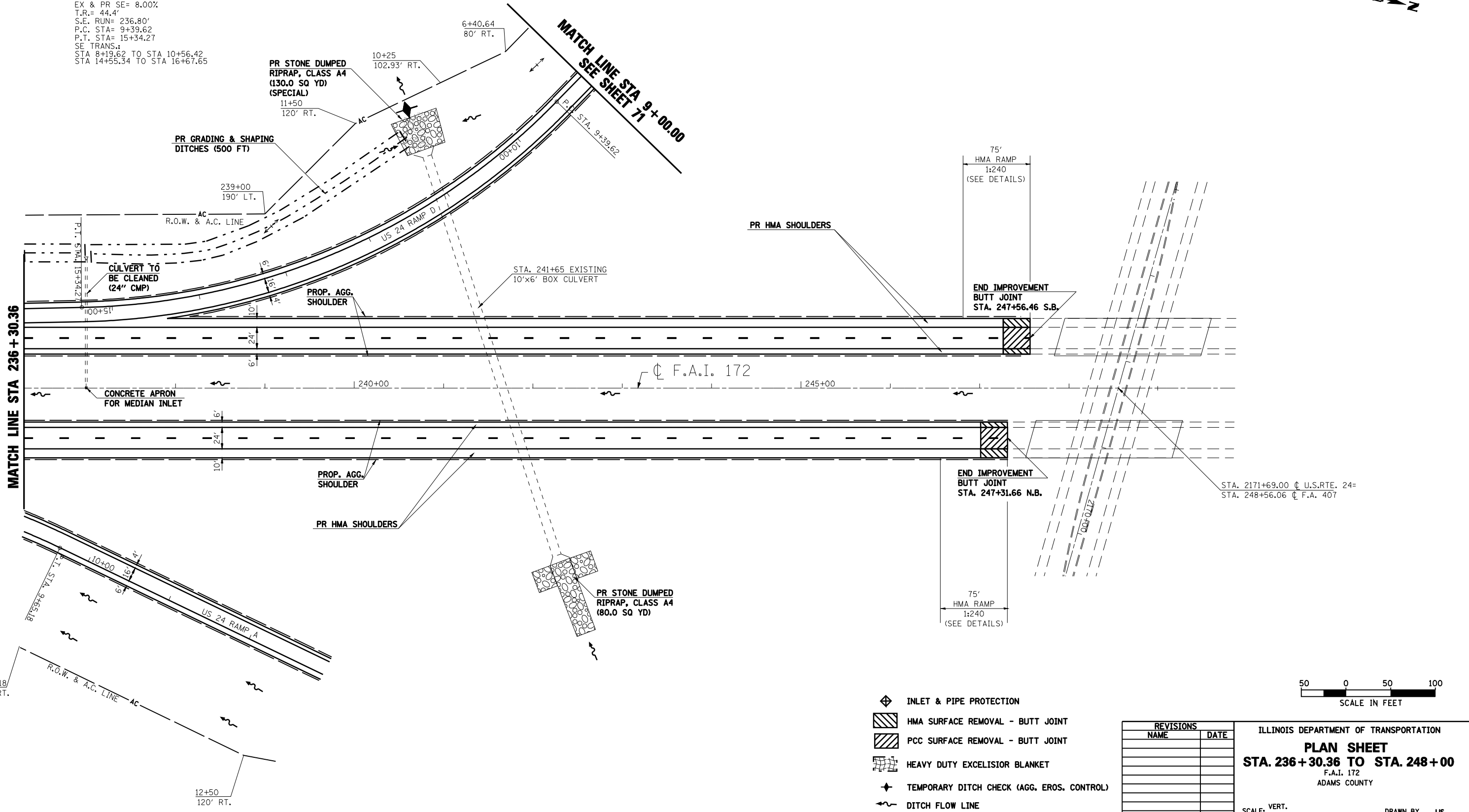

CURVE RAMP D
P.I. STA= 12+52.93
Δ= 44°35'54" (RT)
D= 7°30'00"
R= 763.94'
T= 313.30'
L₁= 594.65'
E= 61.75'
EX & PR SE= 8.00%
T.R.= 44.4'
S.F. RUN= 236.80'
P.C. STA= 9+39.62
P.T. STA= 15+34.27
SE TRANS.:
STA 8+19.62 TO STA 10+56.42
STA 14+55.34 TO STA 16+67.65



- ◆ INLET & PIPE PROTECTION
- ▨ HMA SURFACE REMOVAL - BUTT JOINT
- ▩ PCC SURFACE REMOVAL - BUTT JOINT
- ▧ HEAVY DUTY EXCELISIOR BLANKET
- ✦ TEMPORARY DITCH CHECK (AGG. EROS. CONTROL)
- ~ DITCH FLOW LINE

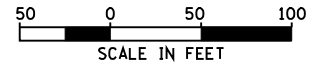

REVISIONS	
NAME	DATE

ILLINOIS DEPARTMENT OF TRANSPORTATION
PLAN SHEET
STA. 236+30.36 TO STA. 248+00
F.A.I. 172
ADAMS COUNTY
SCALE: VERT. _____
HORIZ. _____
DATE: 08/09/04
DRAWN BY: JJS
CHECKED BY: LLQ