

F.A.I. RTE.	SECTION	COUNTY	TOTAL SHEETS	SHEET NO.
172		ADAMS	108	82
STA.		TO STA.		
FED. ROAD DIST. NO.		ILLINOIS FED. AID PROJECT		
		• (1-5)RS-1; (1-6)RS		

CONTRACT NO. 72694

CURVE
 P.I. STA= 62+78.35
 $\Delta = 27^{\circ}7'59''$ (LT)
 $D = 4^{\circ}00'00''$
 $R = 1432.40'$
 $T = 345.65'$
 $L = 678.33'$
 $E = 41.11'$
 $EX \ \& \ PR \ SE = 6.30\%$
 $T.R. = 36.00'$
 $S.E. \ RUN = 151.20'$
 $P.C. \ STA = 59+32.70$
 $P.T. \ STA = 66+11.03$
 $SE \ TRANS.:$
 $STA \ 57+90.00 \ TO \ STA \ 59+77.20$

PAVEMENT MARKING LEGEND

- ① PR PREFORMED PLASTIC PAVEMENT MARKING, TYPE B (INLAID), LINE 5" (30' SKIP, 10' WHITE DASH)
- ② PR URETHANE PAVEMENT MARKING, LINE 5" (SOLID YELLOW)
- ③ PR URETHANE PAVEMENT MARKING, LINE 5" (SOLID WHITE)
- ④ PR URETHANE PAVEMENT MARKING, LINE 6" (SOLID WHITE)
- ⑤ PR PREFORMED PLASTIC PAVEMENT MARKING, TYPE B (INLAID), LINE 8" (SOLID WHITE)
- ⑥ PR PREFORMED PLASTIC PAVEMENT MARKING, TYPE B (INLAID), LINE 12" (SOLID YELLOW)
- ⑦ PR PREFORMED PLASTIC PAVEMENT MARKING, TYPE B (INLAID), LINE 12" (SOLID WHITE)
- ⑧ PR PREFORMED PLASTIC PAVEMENT MARKING, TYPE B (INLAID), LINE 24" (SOLID WHITE)
- ⑨ PR PREFORMED PLASTIC PAVEMENT MARKING, TYPE B (INLAID), LETTERS & SYMBOLS (SOLID WHITE)
- ▲ PR RAISED PAVEMENT MARKERS, ONE-WAY CRYSTAL
- ▲ PR RAISED PAVEMENT MARKERS, ONE-WAY AMBER
- ◆ PR RAISED PAVEMENT MARKERS, TWO-WAY AMBER

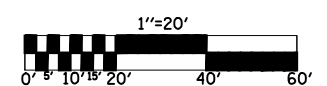
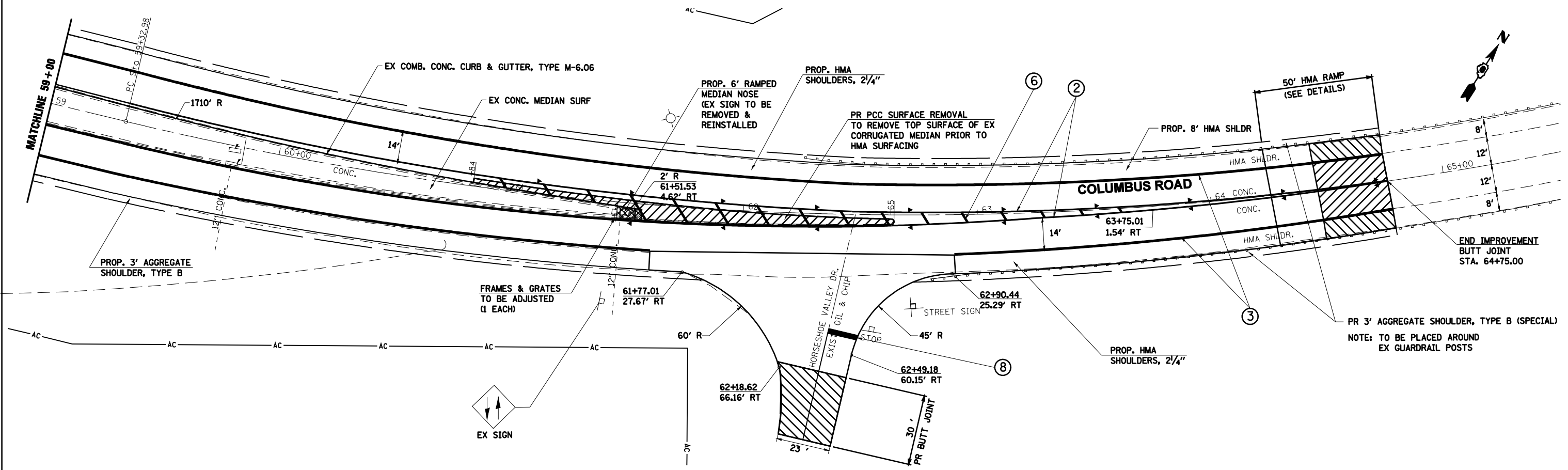

REVISIONS	
NAME	DATE

ILLINOIS DEPARTMENT OF TRANSPORTATION
INTERCHANGE DETAILS
I-172 & COLUMBUS ROAD
ADAMS COUNTY
 SCALE: VERT. 1"=20'
 HORIZ. 1"=40'
 DATE 08/03/2004
 DRAWN BY LLO
 CHECKED BY LEL

c:\p\work\p\DOT\LAUGH\INR\dma26563\078-082 PROPOSED.COLUMBUS Interchange Plans_IDOT_REV.dgn
 Feb-11-2009 12:48:52PM
 *REF01