

F.A.P. RTE.	SECTION	COUNTY	TOTAL SHEETS	SHEET NO.
325		MONTGOMERY	28	21
STA. 316+00.00		TO STA.		
FED. ROAD DIST. NO.	ILLINOIS	FED. AID PROJECT		
• 18(RS-4); 19(RS-7); 20Z(RS-5)				
CONTRACT NO. 72795				

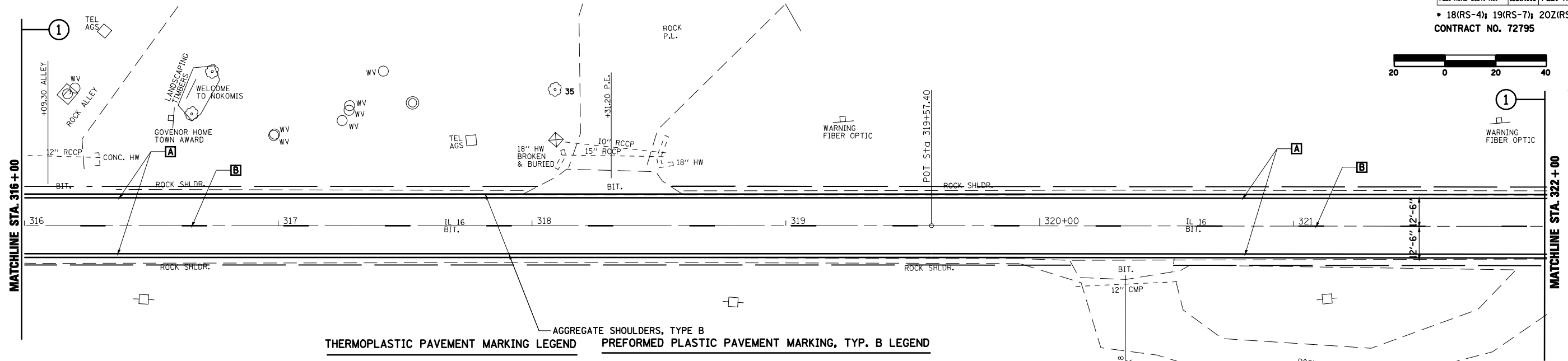

PLAN	SURVEYED	DATE
	PLOTTED	BY
	NOTED	
	NOTE BOOK	
	NO.	
	CADD FILE NAME	



- AGGREGATE SHOULDERS, TYPE B
- THERMOPLASTIC PAVEMENT MARKING LEGEND**
- A** 5" SOLID (WHITE)
 - B** 5" SKIP-DASH (YELLOW)
 - C** 5" SOLID (YELLOW)
 - D** 5" DOUBLE YELLOW (WIDE)
- PREFORMED PLASTIC PAVEMENT MARKING, TYP. B LEGEND**
- 1** 6" SOLID (WHITE)
 - 2** 24" STOP BAR (WHITE)
 - 3** 6" CROSSWALKS (WHITE)
 - 4** LETTERS & SYMBOLS
 - 5** 12" DIAGONAL (WHITE)
 - 6** 12" DIAGONAL (YELLOW)
- 13"** ITEM **D** 5" DOUBLE YELLOW (WIDE)

PROFILE	SURVEYED	DATE
	PLOTTED	BY
	NOTED	
	NOTE BOOK	
	NO.	
	STRUCTURE NOTATIONS CHKD	

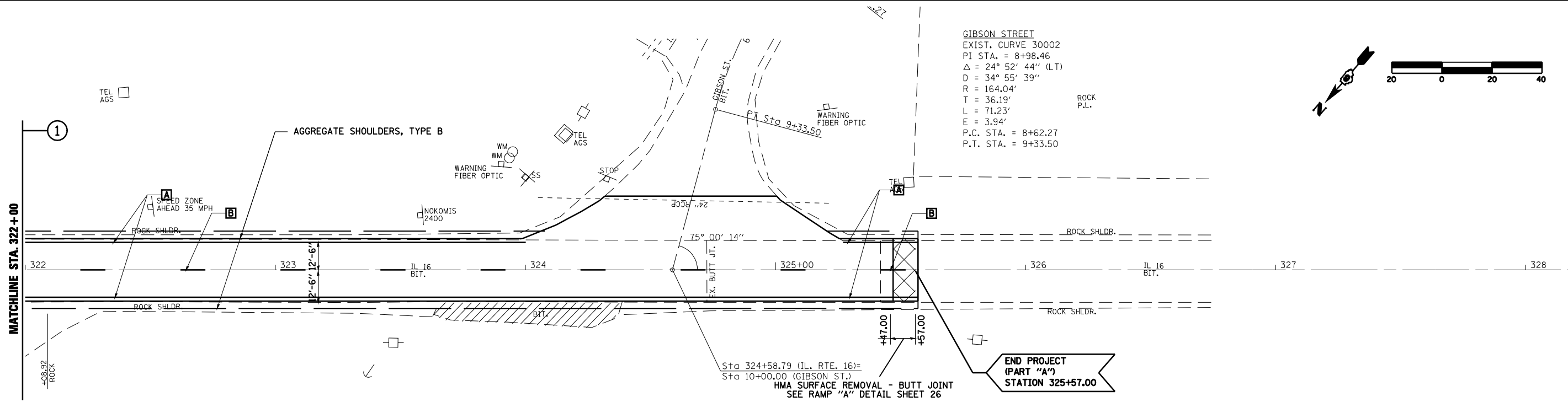

REVISIONS	
NAME	DATE

ILLINOIS DEPARTMENT OF TRANSPORTATION

F.A.P. ROUTE 325

PLAN SHEET 7 OF 7

(PART "A")

DATE 3/2004

DRAWN BY MLO

CHECKED BY SJK