

F.A.S. RTE.	SECTION	COUNTY	TOTAL SHEETS	SHEET NO.
723	*	MONTGOMERY	28	23
STA. 5+00.00		TO STA. 11+00.00		
FED. ROAD DIST. NO.		ILLINOIS	FED. AID PROJECT	
* 18(RS-4); 19(RS-7); 20Z(RS-5)				

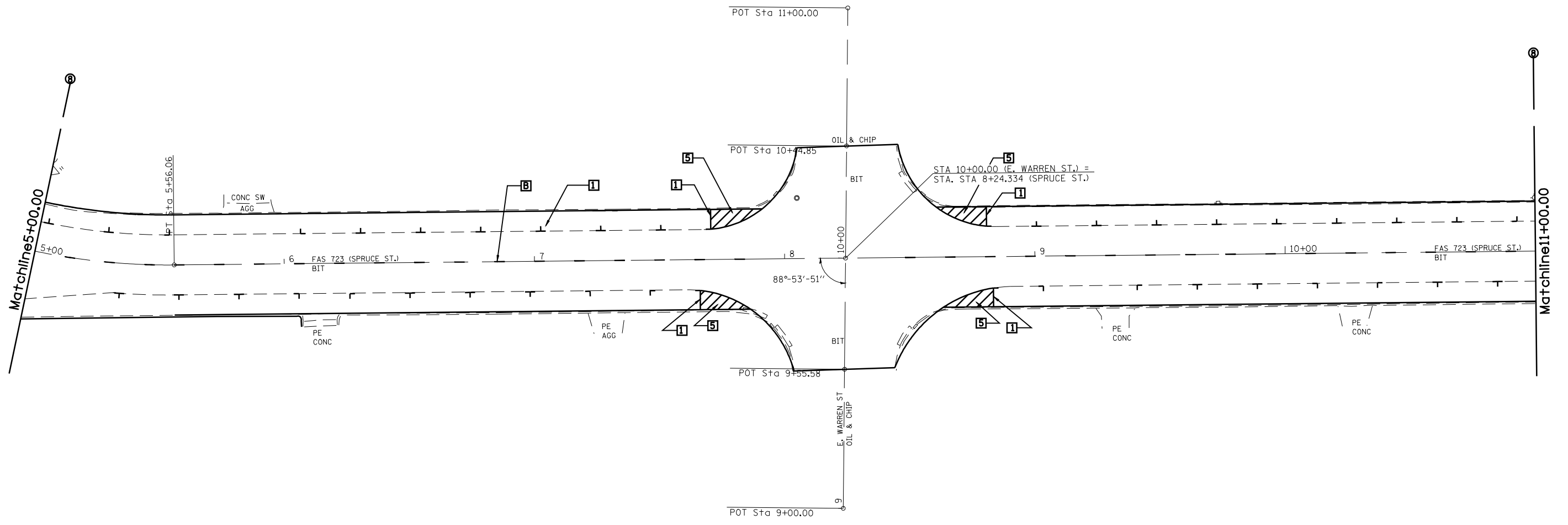
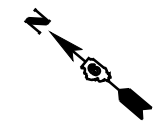

THERMOPLASTIC PAVEMENT MARKING LEGEND

- A** 5" SOLID (WHITE)
- B** 5" SKIP-DASH (YELLOW)
- C** 5" SOLID (YELLOW)
- D** 5" DOUBLE YELLOW (WIDE)
- f** 13" ITEM **D** 5" DOUBLE YELLOW (WIDE)

PREFORMED PLASTIC PAVEMENT MARKING, TYP. B LEGEND

- 1** 6" SOLID (WHITE)
- 2** 24" STOP BAR (WHITE)
- 3** 6" CROSSWALKS (WHITE)
- 4** LETTERS & SYMBOLS
- 5** 12" DIAGONAL (WHITE)

REVISIONS	
NAME	DATE

ILLINOIS DEPARTMENT OF TRANSPORTATION

FAS ROUTE 723
PLAN SHEET 2 OF 4
(PART "B")

SCALE: VERT. _____
HORIZ. _____

DATE _____ DRAWN BY _____
CHECKED BY _____

PLOT DATE = Jan-22-2009 01:44:34PM
 FILE NAME = c:\pva\work\pva\p1001\LAUHL\INR\cdms24286\72795-ah\plan_spruce.dgn
 PLOT SCALE = 42.3529' / IN.
 USER NAME = laughlinr1