

F.A.P. RTE.	SECTION	COUNTY	TOTAL SHEETS	SHEET NO.
310	•	CASS	33	22
STA. 367+00	TO STA. 395+00			
FED. ROAD DIST. NO.		ILLINOIS	FED. AID PROJECT	
• 114(RS-3); 115(RS-3)				72830

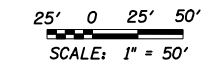
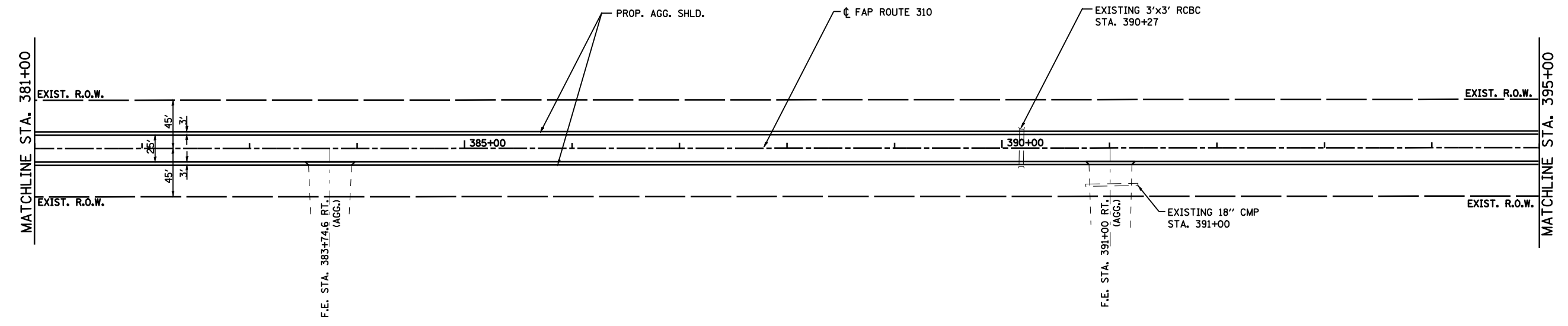
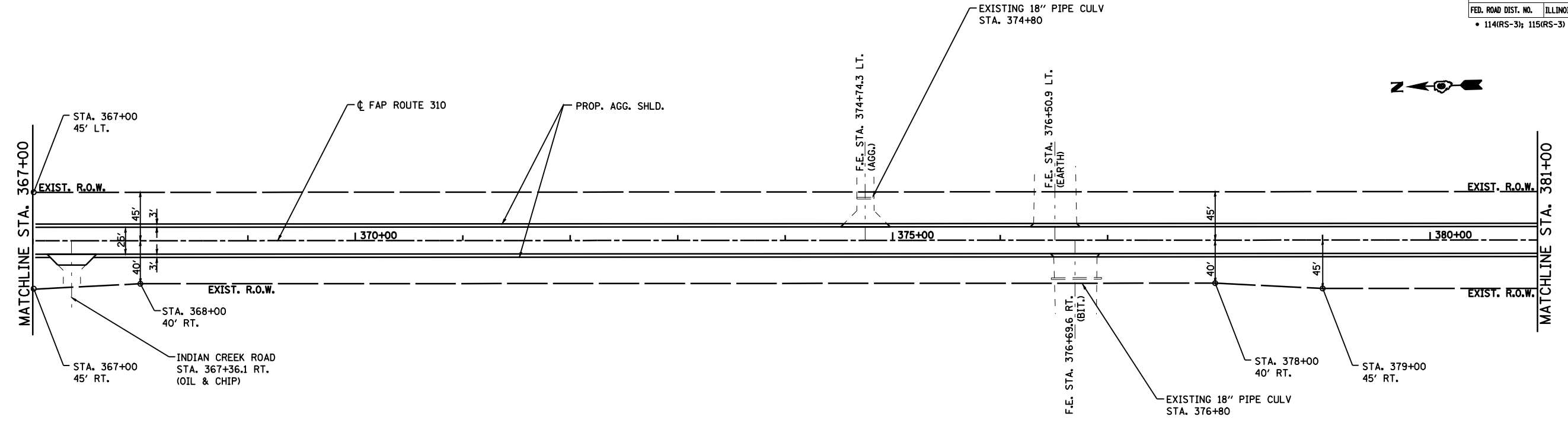

REVISIONS	
NAME	DATE

ILLINOIS DEPARTMENT OF TRANSPORTATION  
**PLAN**  
 FAP ROUTE 310 (US 67)  
 SECTION 114 (RS-3); 115 (RS-3)  
 CASS COUNTY  
 SCALE: 1"=50'  
 DATE: 11/2003  
 DRAWN BY: FCX  
 CHECKED BY: FML