

SECTION 27, T. 18 N., R. 11 W., 3rd P.M.

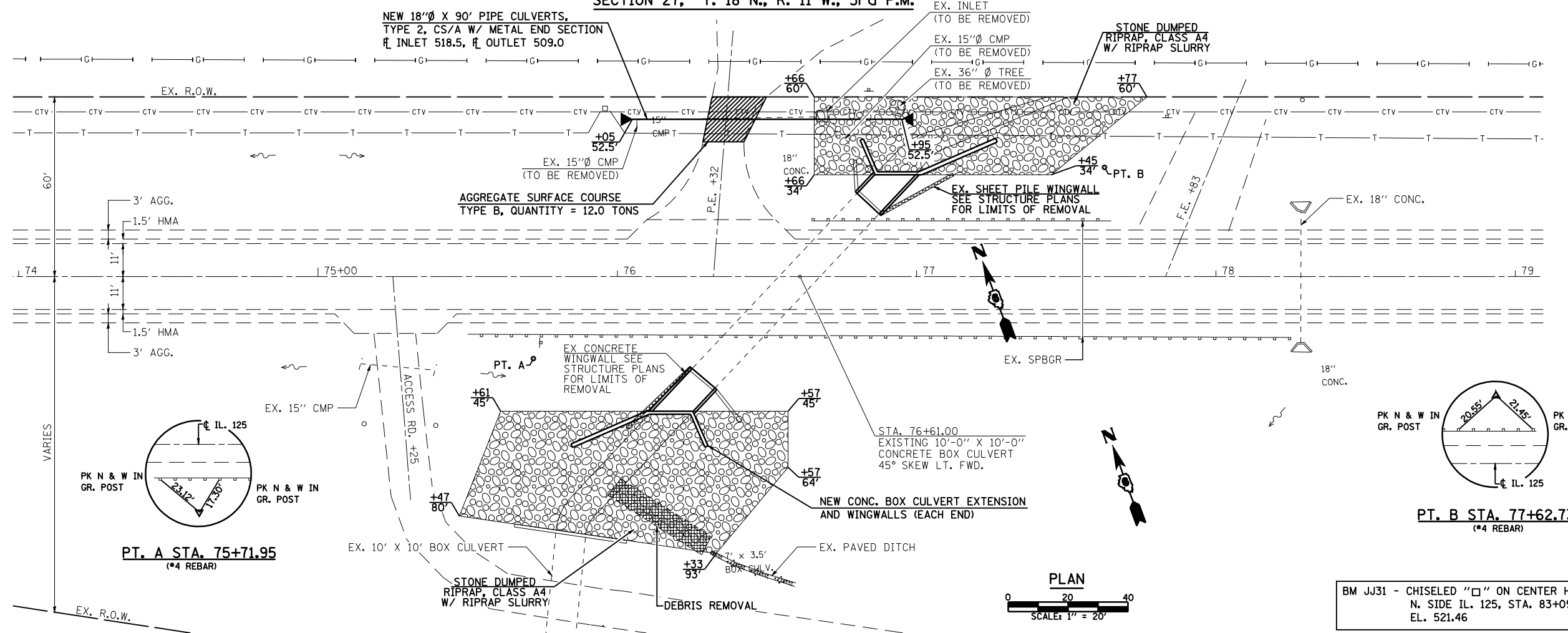

PLAN SURVEYED BY DATE
 PLOTTED BY
 CHECKED BY
 NOTE BOOK NO.
 ALIGNED TO FILE NAME

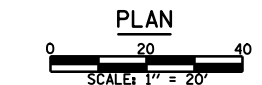
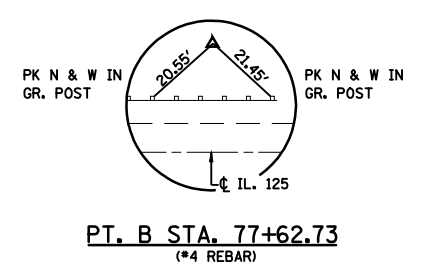
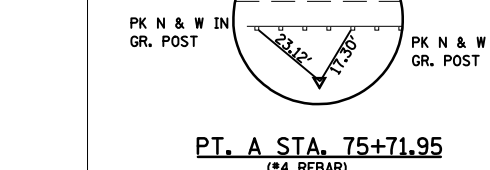

BM JJ31 - CHISELED "□" ON CENTER HEADWALL,
 N. SIDE IL. 125, STA. 83+09 25' LT.
 EL. 521.46

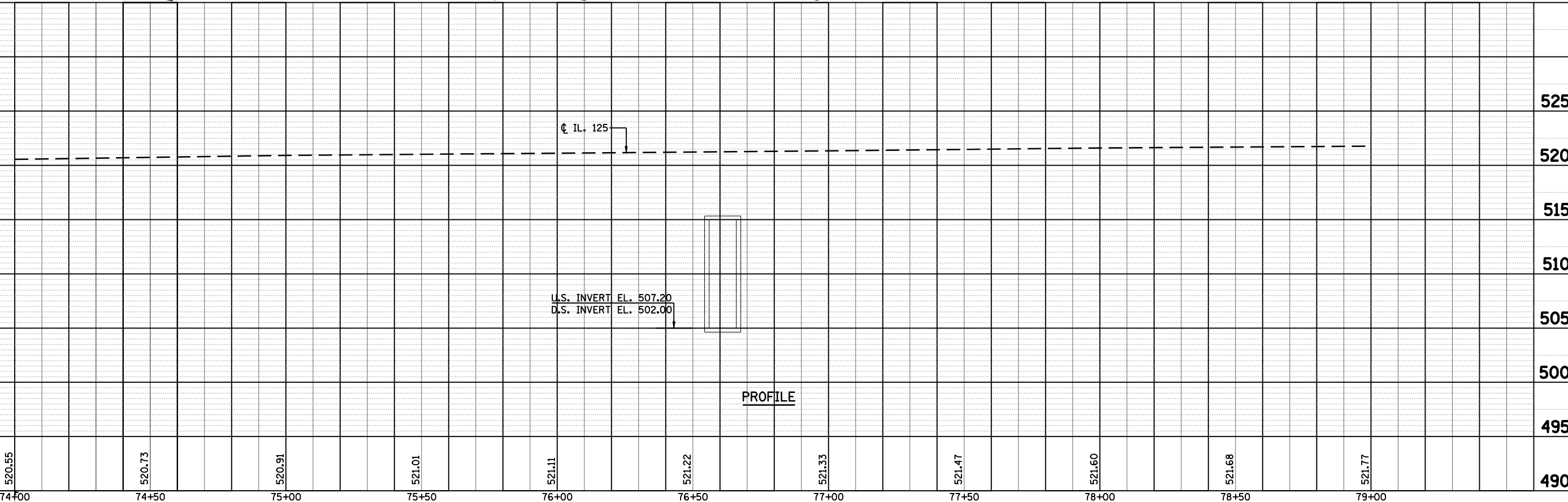

FILE NAME =	USER NAME =	DESIGNED - RKA	REVISSED -	<p>Allen Henderson & Associates, Inc. Civil and Structural Engineers Springfield, IL. 62708 Phone: (217)544-8033 IL Design Firm No. 184-001907</p>	<p>PLAN & PROFILE STA. 76 + 61.00</p>	F.A.P. RTE. 67	SECTION (6X-1JB-2)	COUNTY CASS	TOTAL SHEETS 71	SHEET NO. 19	
FILE#	PLOT SCALE =	CHECKED - RKA	REVISSED -			CONTRACT NO. 72875					
	PLOT DATE = Jan-30-2009 09:38:17AM	DRAWN - CPK	REVISSED -			FED. ROAD DIST. NO.	ILLINOIS FED. AID PROJECT				
		CHECKED - 04/07/08	REVISSED -			SCALE: 1" = 20'	SHEET NO. 8 OF 71 SHEETS	STA.	TO STA.		

PROFILE SURVEYED BY DATE
 PLOTTED BY
 CHECKED BY
 NOTE BOOK NO.
 STRUCTURE NOTATIONS CHECKED