

Note: Order v3 bars full length. Lay out in field as shown. Cut along cut line. Use remainder of bar in opposite wingwall.

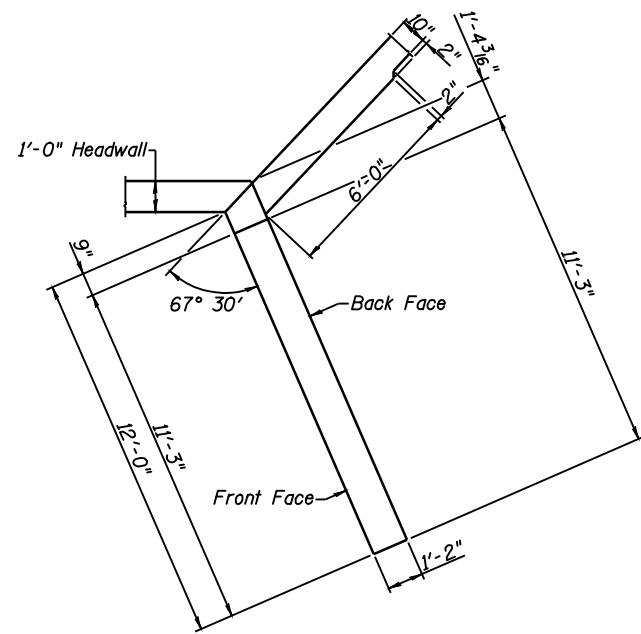
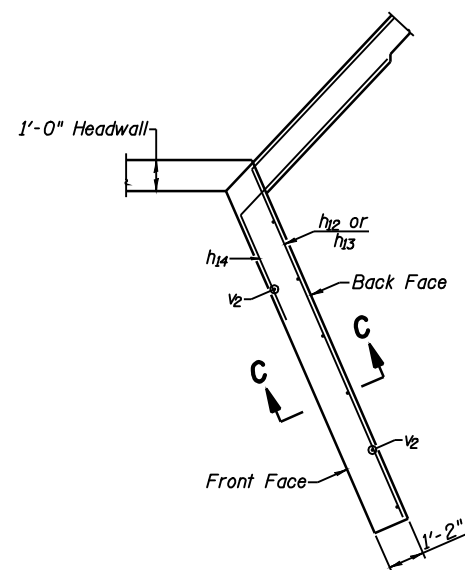

**BILL OF MATERIAL**

| Bar                              | No.     | Size  | Length  | Shape |
|----------------------------------|---------|-------|---------|-------|
| a                                | 98      | #8    | 13'-2"  | U     |
| a1                               | 15      | #4    | 11'-4"  | —     |
| d                                | 30      | #4    | 5'-10"  | U     |
| h                                | 11      | #7    | 20'-6"  | —     |
| h1                               | 8       | #6    | 16'-0"  | —     |
| h2                               | 20      | #5    | 20'-6"  | —     |
| h3                               | 8       | #8    | 16'-0"  | —     |
| h4                               | 10      | #7    | 20'-6"  | —     |
| h5                               | 10      | #7    | 10'-6"  | —     |
| h6                               | 10      | #7    | 8'-8"   | —     |
| h7                               | 10      | #7    | 18'-8"  | —     |
| h8                               | 11      | #7    | 18'-8"  | —     |
| h9                               | 20      | #5    | 18'-8"  | —     |
| h10                              | 34      | #4    | 14'-2"  | —     |
| h11                              | 10      | #8    | 17'-10" | —     |
| h12                              | 14      | #8    | 18'-9"  | —     |
| h13                              | 10      | #8    | 10'-11" | —     |
| h14                              | 24      | #8    | 11'-1"  | —     |
| h15                              | 12      | #4    | 11'-3"  | —     |
| h16                              | 10      | #9    | 16'-1"  | —     |
| h17                              | 24      | #9    | 18'-10" | —     |
| h18                              | 4       | #9    | 14'-6"  | —     |
| h19                              | 28      | #9    | 14'-6"  | —     |
| h20                              | 4       | #4    | 13'-8"  | —     |
| h21                              | 16      | #6    | 11'-4"  | —     |
| n(E)                             | 30      | #6    | 7'-9"   | —     |
| s                                | 63      | #4    | 4'-1"   | □     |
| s1                               | 15      | #4    | 4'-0"   | □     |
| f                                | 36      | #5    | 7'-8"   | —     |
| f1                               | 30      | #6    | 7'-8"   | —     |
| v                                | 102     | #4    | 2'-11"  | —     |
| v1                               | 102     | #4    | 10'-1"  | —     |
| v2                               | 14      | #5    | 15'-0"  | —     |
| v3                               | 5       | #4    | 18'-7"  | —     |
| v4                               | 18      | #5    | 15'-0"  | —     |
| v5                               | 30      | #4    | 7'-2"   | —     |
| w                                | 24      | #6    | 14'-2"  | —     |
| Concrete Box Culverts            | Cu. Yd. | 114.1 |         |       |
| Reinforcement Bars               | Pound   | 16610 |         |       |
| Reinforcement Bars, Epoxy Coated | Pound   | 350   |         |       |
| Furnishing Steel Piles, HP 12x53 | Foot    | 600   |         |       |
| Driving Piles                    | Foot    | 600   |         |       |
| Test Piles, Steel HP 12x53       | Each    | 2     |         |       |
| Expansion Bolts 3/4 Inch         | Each    | 56    |         |       |

**CULVERT DETAILS**  
IL. ROUTE 125 OVER  
TRIBUTARY TO LOST CREEK  
F.A.P. ROUTE 67 - SECTION (6X-1)B-2  
CASS COUNTY  
STA. 76+61.00  
S.N. 009-7000

|  |                            |             |           |        |                     |                           |
|--|----------------------------|-------------|-----------|--------|---------------------|---------------------------|
| <b>Allen Henderson &amp; Associates, Inc.</b><br>Civil and Structural Engineers Springfield, IL.<br>62703 Phone: (217)544-8033 IL. Design Firm<br>No. 184-001907 | SHEET NO. 4<br>OF 5 SHEETS | F.A.P. RTE. | SECTION   | COUNTY | TOTAL SHEETS        | SHEET NO.                 |
|  |                            | 67          | (6X-1)B-2 | CASS   | 71                  | 33                        |
| CONTRACT NO. 72875   |                            |             |           |        | FED. ROAD DIST. NO. | ILLINOIS FED. AID PROJECT |