

**BAR v3 CUT DIAGRAM**  
 Note: Order v3 bars full length. Lay out in field as shown. Cut along cut line. Use remainder of bar in opposite wingwall.

**BILL OF MATERIAL**

Bar	No.	Size	Length	Shape
a	144	#7	9'-1"	—
a1	148	#7	24'-5"	—
a2	244	#6	25'-9"	—
d	50	#4	5'-6"	—
h	100	#5	39'-8"	—
h1	200	#5	27'-7"	—
h2	33	#7	39'-8"	—
h3	66	#7	28'-2"	—
h4	16	#6	24'-5"	—
h5	8	#6	22'-7"	—
h6	16	#4	17'-0"	—
h7	20	#8	15'-6"	—
h8	56	#8	15'-4"	—
h9	36	#8	26'-2"	—
h10	20	#8	24'-8"	—
s	75	#4	4'-9"	—
s1	25	#4	4'-7"	—
v	483	#5	3'-5"	—
v1	487	#5	11'-2"	—
v2	4	#5	14'-3"	—
v3	14	#5	26'-9"	—
Concrete Box Culverts		Cu. Yd.	327.6	
Reinforcement Bars		Pound	52200	
Bar Splicers		Each	133	

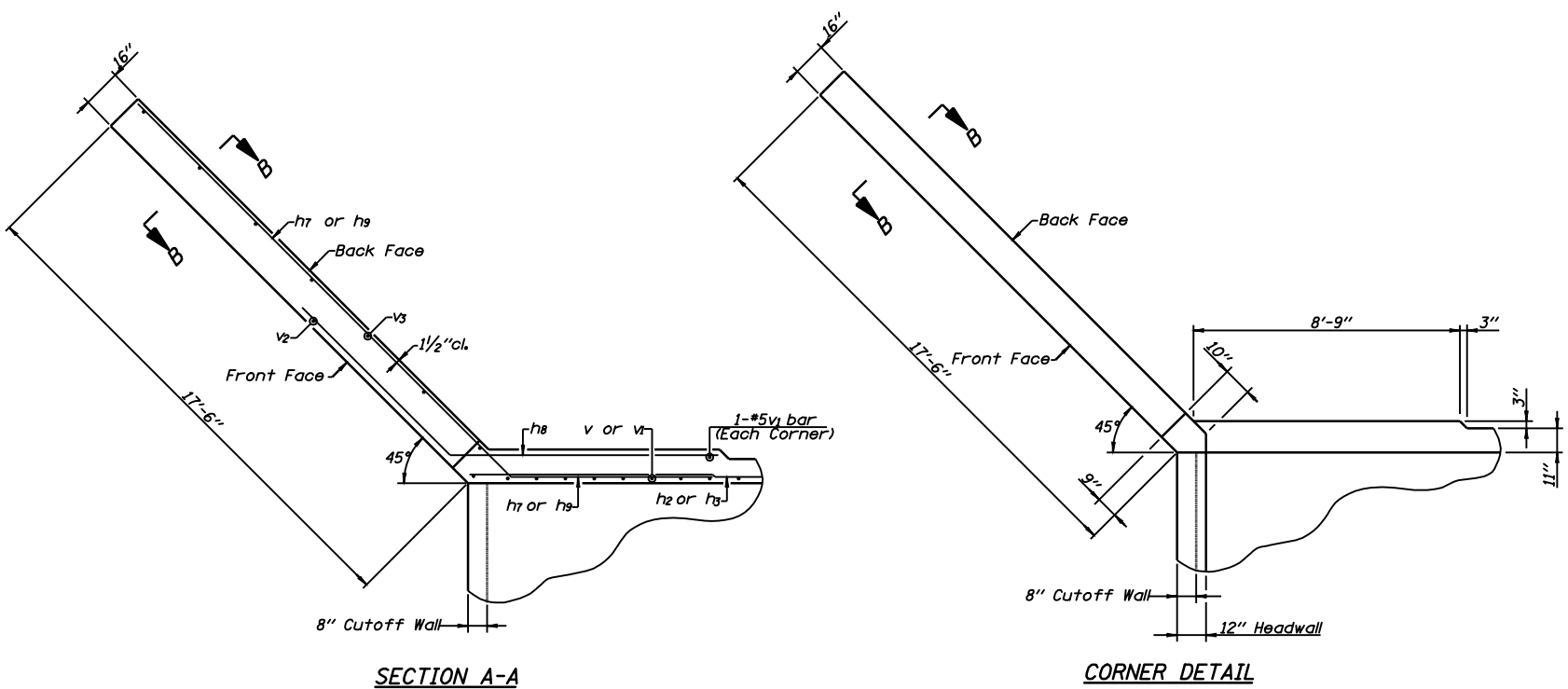
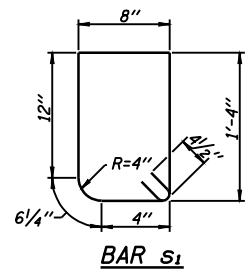
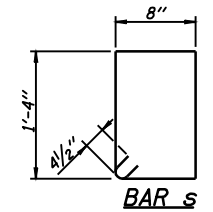

**CULVERT DETAILS**  
 I.L. ROUTE 125 OVER  
 TRIBUTARY TO LOST CREEK  
 F.A.P. ROUTE 67 - SECTION (6X-1)B-2  
 CASS COUNTY  
 STA. 136+64.40  
 S.N. 009-2506

**Allen Henderson & Associates, Inc.**  
 Civil and Structural Engineers Springfield, IL  
 62703 Phone: (217)544-8033 I.L. Design Firm  
 No. 184-001907

SHEET NO. 5  
 OF 9 SHEETS

F.A.P. RTE.	SECTION	COUNTY	TOTAL SHEETS	SHEET NO.
67	(6X-1)B-2	CASS	71	39
CONTRACT NO. 72875				
FED. ROAD DIST. NO.	ILLINOIS FED. AID PROJECT			