

STATE OF ILLINOIS  
DEPARTMENT OF TRANSPORTATION  
DIVISION OF HIGHWAYS

**PROPOSED  
HIGHWAY PLANS**

FAP ROUTE 67 (IL 97 / JEFFERSON ST)  
SECTION (S)RS-5; (107Z)RS-8  
PROJECT ESP-0067(079)  
RESURFACING  
SANGAMON COUNTY

C-96-017-09

F.A.P. RTE.	SECTION	COUNTY	TOTAL SHEETS	SHEET NO.
67	(S)RS-5; (107Z)RS-8	SANGAMON	---	1
		ILLINOIS	CONTRACT NO. 72C40	

D-96-017-09



**INDEX OF SHEETS**

1	COVER SHEET
2	GENERAL NOTES
3	SUMMARY OF QUANTITIES
4-7	TYPICAL SECTIONS
8-12	SCHEDULE OF QUANTITIES
13-31	PLAN SHEETS & PAVEMENT MARKING PLANS
32	BUTT JOINT/ CURB DETAILS
33-38	TRAFFIC SIGNAL PLANS
39	LEGEND FOR TRAFFIC SIGNAL DETAILS
40-41	TRAFFIC SIGNAL DETAILS

**IDOT HIGHWAY STANDARDS**

000001-05	701311-02
442201-03	701426-02
424001-05	701601-05
604001-02	701602-03
606001-03	701701-05
606301-03	701901-01
701201-02	780001-01
701301-02	781001-02
701306-01	

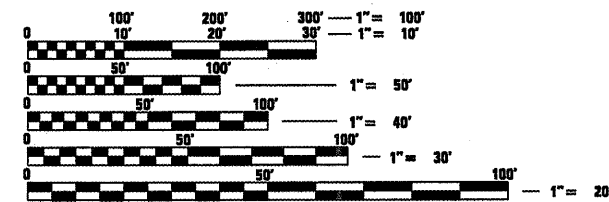
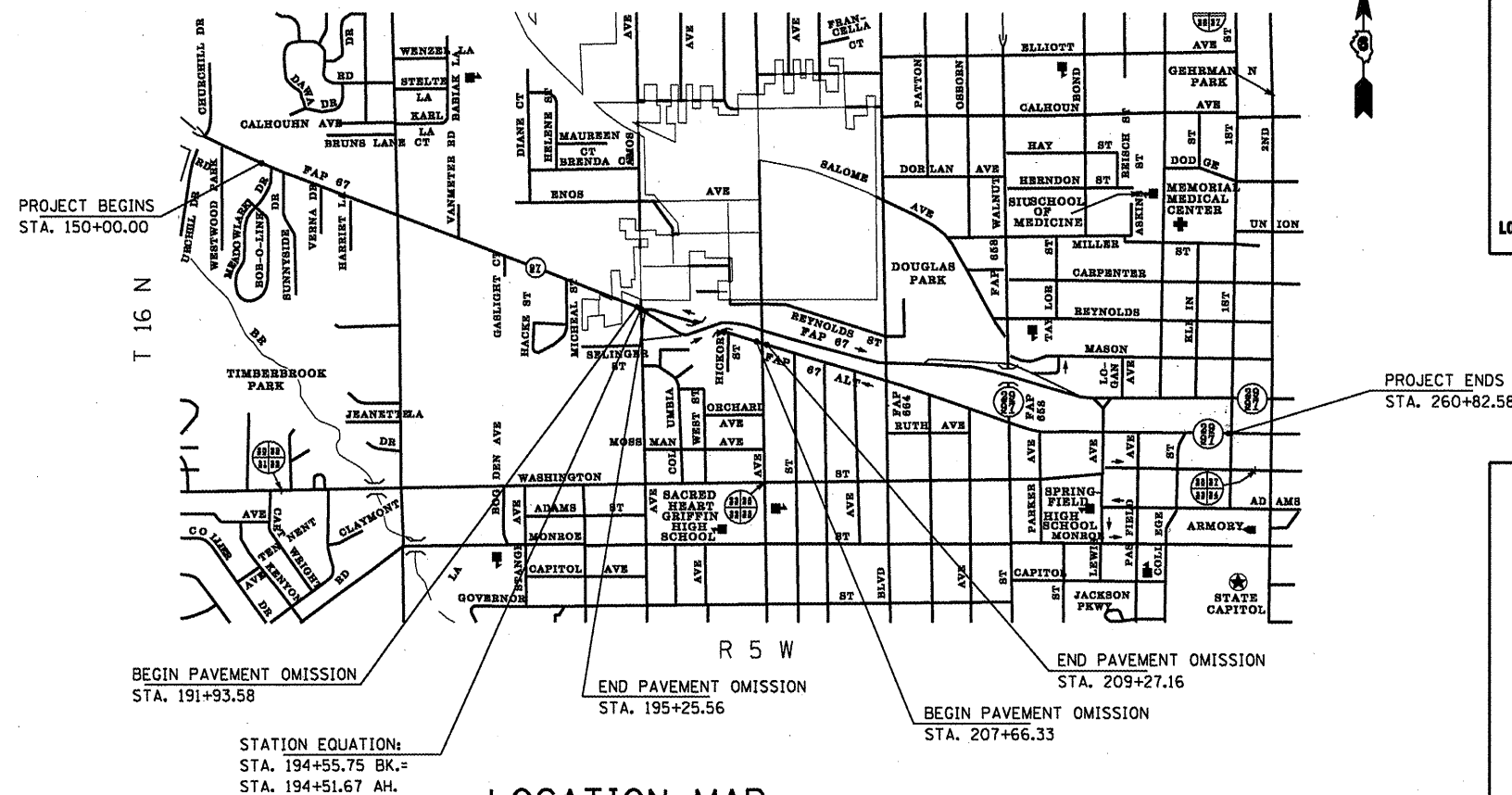

FULL SIZE PLANS HAVE BEEN PREPARED USING STANDARD ENGINEERING SCALES. REDUCED SIZED PLANS WILL NOT CONFORM TO STANDARD SCALES. IN MAKING MEASUREMENTS ON REDUCED PLANS, THE ABOVE SCALES MAY BE USED.

J.U.L.I.E.  
JOINT UTILITY LOCATION INFORMATION FOR EXCAVATION  
1-800-892-0123  
OR 811

PROJECT ENGINEER: SAL MADONIA 217-782-4761  
PROJECT MANAGER: KEN ANDERSON 217-524-7546

CONTRACT NO. 72C40

LOCATION MAP  
SPRINGFIELD IL

GROSS LENGTH = 11086.66 FT. = 2.100 MILE  
NET LENGTH = 11086.66 FT. = 2.100 MILE

ADT = 18066 (YR. 2008)

STATE OF ILLINOIS  
DEPARTMENT OF TRANSPORTATION  
DIVISION OF HIGHWAYS

SUBMITTED January 16 2009  
*Roger Oriskany*  
DEPUTY DIRECTOR OF HIGHWAYS, REGION ENGINEER

March 13 2009  
*Charles J. Groszoll*  
ENGINEER OF DESIGN AND ENVIRONMENT

March 13 2009  
*Christine M. Reed*  
DIRECTOR OF HIGHWAYS, CHIEF ENGINEER

PRINTED BY THE AUTHORITY  
OF THE STATE OF ILLINOIS