

F.A.P. RTE.	SECTION	COUNTY	TOTAL SHEETS	SHEET NO.
741	12RS-3	MACON	26	1
		ILLINOIS	CONTRACT NO. 74378	

STATE OF ILLINOIS  
DEPARTMENT OF TRANSPORTATION  
DIVISION OF HIGHWAYS  
**PROPOSED  
HIGHWAY PLANS**

FAP ROUTE 741 (IL ROUTE 105)  
SECTION 12RS-3  
PROJECT: *ESP-0741(094)*  
HMA RESURFACING  
MACON COUNTY

C-97-063-09

FOR INDEX OF SHEETS, SEE SHEET NO.

ADT 2007 = 9,700

BRIDGE OMISSION  
STATION 1102 + 42.96 TO STATION 1106 + 29.38

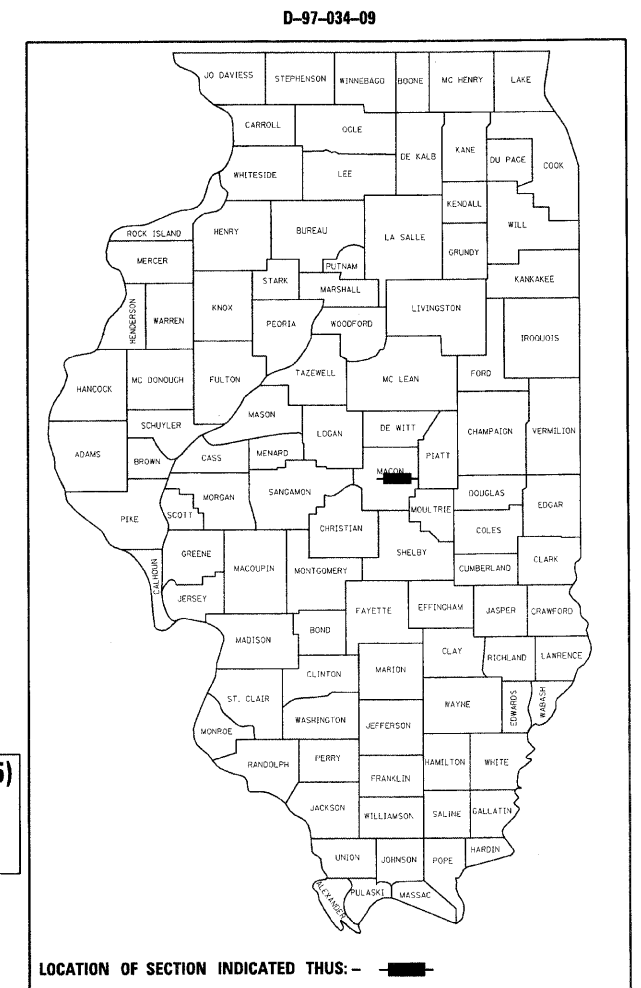

FAP ROUTE 741 (IL 105)  
SECTION 12RS-3  
PROJECT ENDS  
STATION 1167 + 13.39

FAP ROUTE 741 (IL 105)  
SECTION 12RS-3  
PROJECT BEGINS  
STATION 1007 + 00

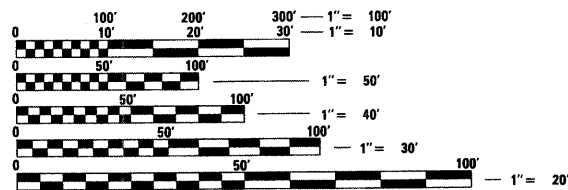

FULL SIZE PLANS HAVE BEEN PREPARED USING STANDARD ENGINEERING SCALES. REDUCED SIZED PLANS WILL NOT CONFORM TO STANDARD SCALES. IN MAKING MEASUREMENTS ON REDUCED PLANS, THE ABOVE SCALES MAY BE USED.

J.U.L.I.E.  
JOINT UTILITY LOCATION INFORMATION FOR EXCAVATION  
1-800-892-0123  
OR 811

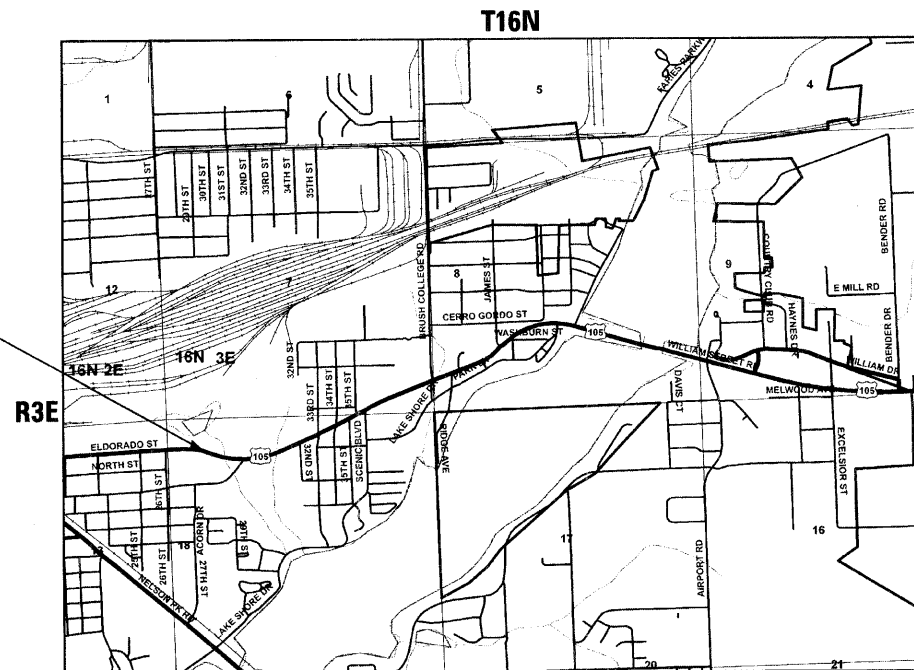

PROJECT ENGINEER: MARK DAUGHERTY  
PROJECT MANAGER: MYRA OLTMAN

GROSS LENGTH = 15,723 FT. = 2.98 MILE  
NET LENGTH = 15,723 FT. = 2.98 MILE

CONTRACT NO. 74378

STATE OF ILLINOIS  
DEPARTMENT OF TRANSPORTATION  
DIVISION OF HIGHWAYS

SUBMITTED February 6, 2009

*Roger L. Dinkels*  
DEPUTY DIRECTOR OF HIGHWAYS, REGION ENGINEER

March 13, 2009  
*Charles J. Ingersoll*  
ENGINEER OF DESIGN AND ENVIRONMENT

March 13, 2009  
*Christina M. Reed*  
DIRECTOR OF HIGHWAYS, CHIEF ENGINEER

PRINTED BY THE AUTHORITY  
OF THE STATE OF ILLINOIS