

SEC. 7, T 23 N, R 11 W, 2ND P.M.



STA. 1246+00.00
60.00' LT

STA. 1241+00.00
50.00' LT

STA. 1241+00.00
60.00' LT

EXISTING R.O.W. LINE

S.N. 092-0048
STA. 1243+12.00

STA. 1246+00.00
50.00' LT

PLAN	SURVEYED	DATE
	PLOTTED	BY
	GRADES CHECKED	
	STRUCTURE NOTATION CHECKED	
	NOTE BOOK NO.	
	CADD FILE NAME	

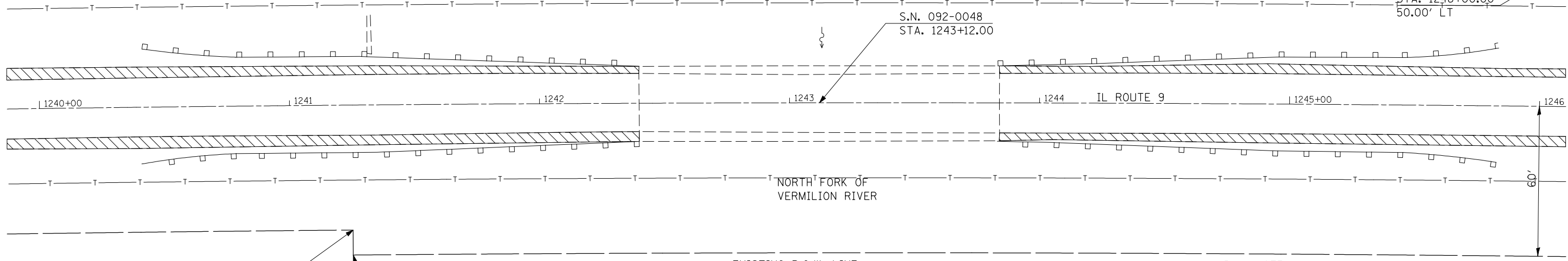

STA. 1241+25.00
50.00' RT

EXISTING R.O.W. LINE

STA. 1241+25.00
60.00' RT

SEC. 18, T 23 N, R 11 W, 2ND P.M.

PLAN NOTE:
NO UTILITY CONFLICTS
ARE ANTICIPATED ON THIS PROJECT

HMA BASE COURSE WIDENING, 9"

PROFILE	SURVEYED	DATE
	PLOTTED	BY
	GRADES CHECKED	
	STRUCTURE NOTATION CHECKED	
	NOTE BOOK NO.	
	CADD FILE NAME	

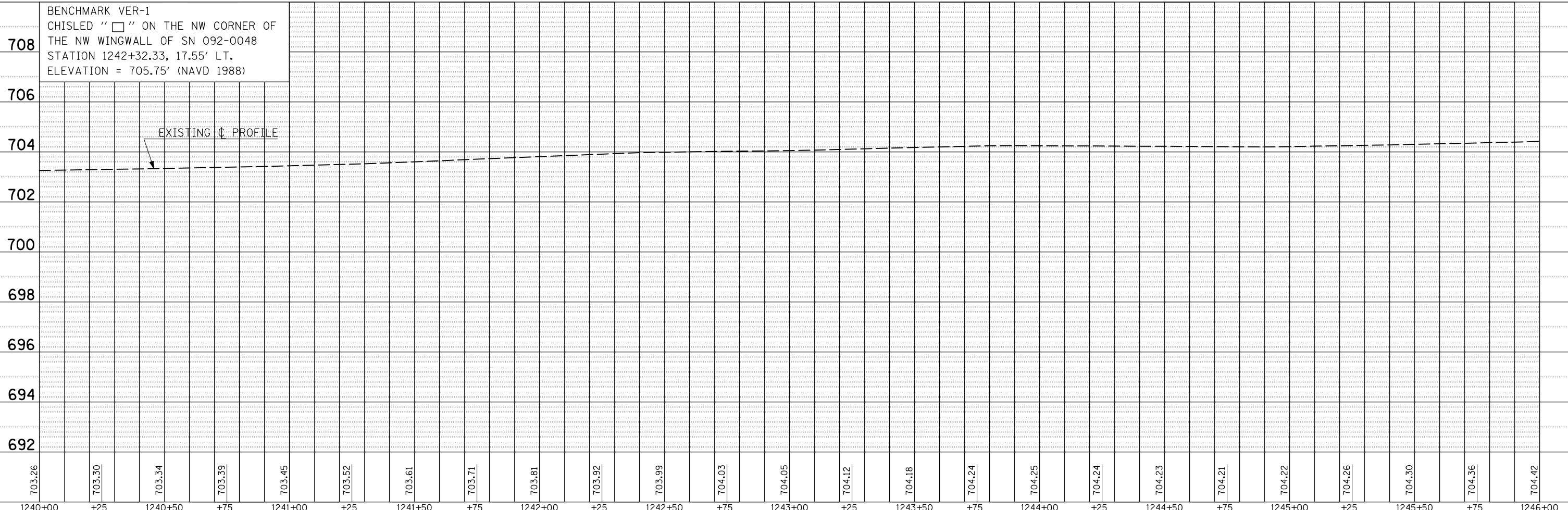

BENCHMARK VER-1
CHISELED "□" ON THE NW CORNER OF
THE NW WINGWALL OF SN 092-0048
STATION 1242+32.33, 17.55' LT.
ELEVATION = 705.75' (NAVD 1988)

EXISTING C PROFILE

FILE NAME =	USER NAME = ceorlockjd	DESIGNED - DMH	REVISD -
ct:\pwork\pwork\ceorlockjd\dms87652\90866\90866sheets.dgn		DRAWN -	REVISD -
		CHECKED -	REVISD -
		DATE -	REVISD -
STATE OF ILLINOIS DEPARTMENT OF TRANSPORTATION			
PLAN & PROFILE (S.N. 092-0048)			
SCALE:	SHEET NO. OF SHEETS	STA. 1240+00 TO STA. 1246+00	F.A.P. RTE. SECTION COUNTY TOTAL SHEETS SHEET NO.
			697 46RS-8&1RS-2&46BDR VERMILION 75 39
			CONTRACT NO. 90866
FED. ROAD DIST. NO. ILLINOIS FED. AID PROJECT			