

ROUTE	SECTION	COUNTY	TOTAL SHEETS	SHEET NUMBER
VARIOUS	2008-011 PP	DUPAGE	37+1=38	1

STATE OF ILLINOIS
DEPARTMENT OF TRANSPORTATION
DIVISION OF HIGHWAYS
DISTRICT ONE
PROPOSED HIGHWAY PLANS

CONTRACT NO. 60E37
 D-91-362-08

FOR INDEX OF SHEETS SEE SHEET 2

VARIOUS ROUTES
 SECTION: 2008-011 PP
 VARIOUS LOCATIONS IN DUPAGE COUNTY
 PAVEMENT PATCHING
 DUPAGE COUNTY
 C-91-362-08

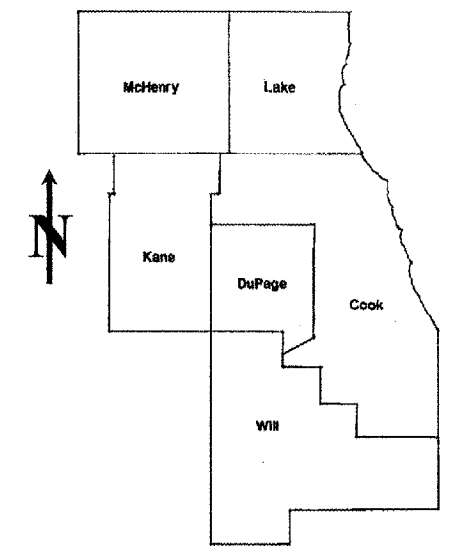

LOCATION OF IMPROVEMENT INDICATED THUS:

DISTRICT ONE - DESIGN - PLAN PREPARATION ENGINEER:
 KEN ENG / (847) 705-4247

CONTRACT NO. 60E37

STATE OF ILLINOIS
DEPARTMENT OF TRANSPORTATION
DIVISION OF HIGHWAYS

SUBMITTED: MARCH 14, 2008
Diane M. O'Keefe
 DEPUTY DIRECTOR OF HIGHWAYS, REGION ENGINEER

March 20, 2008
Eric E. Harn
 INTERIM ENGINEER OF DESIGN AND ENVIRONMENT

March 20, 2008
Christine M. Reed
 DIRECTOR, DIVISION OF HIGHWAYS

PRINTED BY THE AUTHORITY
OF THE STATE OF ILLINOIS

J.U.L.I.E.: JOINT UTILITY LOCATION
INFORMATION FOR EXCAVATION
(312) 744-7000

INDEX OF SHEETS

<u>SHEET NO.</u>	<u>DESCRIPTION</u>
1	TITLE SHEET
2	INDEX OF SHEETS, STATE STANDARDS AND GENERAL NOTES
3	SUMMARY OF QUANTITIES
4	GENERAL LOCATION MAP
5	SUMMARY OF PATCHING SCHEDULE
6-31	PATCHING SCHEDULE
32	PAVEMENT PATCHING FOR HMA SURFACED PAVEMENT
33	BUTT JOINT AND HMA TAPER DETAILS
34	TYPICAL APPLICATIONS: RAISED REFLECTIVE PAVEMENT MARKERS (SNOW-PLOW RESISTANT)
35	DISTRICT ONE TYPICAL PAVEMENT MARKINGS
36	TRAFFIC CONTROL AND PROTECTION OF TURN BAYS (TO REMAIN OPEN TO TRAFFIC)
37	ARTERIAL ROAD INFORMATION SIGN
37A	TRAFFIC CONTROL AND PROTECTION FOR SIDE ROADS, INTERSECTIONS AND DRIVEWAYS

STATE STANDARDS

<u>STANDARD NO.</u>	<u>DESCRIPTION</u>
000001-05	TYPICAL SYMBOLS, ABBREVIATIONS AND PATTERNS
420001-07	PAVEMENT JOINTS
442201-03	CLASS C AND D PATCHES
701201-02	LANE CLOSURE, 2L, 2W, DAY ONLY
701306-01	LANE CLOSURE, 2L, 2W, SLOW MOVING OPERATIONS - DAY ONLY
701336-04	LANE CLOSURE, 2L, 2W, WORK AREAS IN SERIES
701501-04	URBAN LANE CLOSURE, 2L, 2W, UNDIVIDED
701601-05	URBAN LANE CLOSURE, MULTILANE, 1W OR 2W WITH NONTRAVERSABLE MEDIAN
701606-05	URBAN LANE CLOSURE, MULTILANE, 2W WITH MOUNTABLE MEDIAN
701701-05	URBAN LANE CLOSURE, MULTILANE INTERSECTION
701901	TRAFFIC CONTROL DEVICES

GENERAL NOTES

BEFORE STARTING ANY EXCAVATION, THE CONTRACTOR SHALL CALL "JULIE" AT (800) 892-0123 OR 811 FOR FIELD LOCATIONS OF BURIED ELECTRIC, TELEPHONE AND GAS FACILITIES. (48 HOUR NOTIFICATION REQUIRED)

THE CONTRACTOR WILL NOT BE ALLOWED TO SET UP A YARD OR FIELD OFFICE ON STATE (OR TOLLWAY) PROPERTY WITHOUT WRITTEN PERMISSION FROM THE DEPARTMENT (OR ISTHA)

WHEN ARTIFICIAL LIGHTING IS UTILIZED IN NIGHT OPERATIONS, THE CONTRACTOR SHALL EXERCISE THE UTMOST PRECAUTIONS IN PREVENTING ADVERSE VISABILITY TO THE MOTORING PUBLIC AND ADJOINING RESIDENTIAL AREAS.

ANY PAVEMENT MARKINGS AND RAISED REFLECTIVE PAVEMENT MARKERS OBLITERATED BY MILLING AND RESURFACING OPERATIONS ON SIDE STREETS AND ENTRANCES SHALL BE REPLACED AND PAID FOR IN KIND.

BEFORE BEGINNING ANY WORK, THE CONTRACTOR SHALL RETAIN AND RECORD FOR FUTURE REFERENCE, ALL EXISTING PAVEMENT MARKING LINES (AND RAISED REFLECTIVE PAVEMENT MARKERS) IN ORDER THAT THESE LOCATIONS CAN BE RE-ESTABLISHED FOR STRIPING. EXACT LOCATIONS OF ALL PAVEMENT MARKINGS SHALL BE AS DIRECTED BY THE ENGINEER.

ALL PAVEMENT PATCHING LOCATIONS WILL BE DETERMINED IN THE FIELD BY THE ENGINEER.

DRAINAGE ADJUSTMENT OR RECONSTRUCTION LOCATIONS WILL BE DETERMINED IN THE FIELD BY THE ENGINEER.

THE CONTRACTOR SHALL CONTACT THE DISTRICT ONE TRAFFIC CONTROL SUPERVISOR AT (847) 705-4470 A MINIMUM OF 72 HOURS IN ADVANCE OF BEGINNING WORK.

THE ENGINEER SHALL CONTACT MS. CORA MATHIS, AREA TRAFFIC FIELD ENGINEER AT (815) 485-6475 MINIMUM OF TWO (2) WEEKS PRIOR TO PLACEMENT OF PERMANENT PAVEMENT MARKINGS.

DOUBLE LANE MARKERS ARE TO BE USED AS SHOWN ON THE DISTRICT ONE DETAIL "TYPICAL APPLICATIONS - RAISED REFLECTIVE PAVEMENT MARKERS (SNOW-PLOW RESISTANT)" SHOWN IN THE PLANS.

THE EXISTING ROADWAY TYPICAL SECTION IS ASSUMED TO HAVE A 3 INCH HOT-MIX ASPHALT OVERLAY ON TOP OF A TEN INCH CONCRETE BASE.

HOT-MIX ASPHALT MIXTURE REQUIREMENTS

MIXTURE TYPE	AC TYPE	AIR VOIDS (%)
HOT-MIX ASPHALT SURFACE COURSE, MIX "D", N70 (IL 9.5 MM)	PG 64-22	4% @ 70 GYR
LEVELING BINDER (MM), N70	PG 64-22/58-22	4% @ 70 GYR
CLASS D PATCHES, (HMA BINDER IL-19.0 MM)	PG 64-22 *	4% @ 70 GYR
HOT-MIX ASPHALT REPLACEMENT OVER PATCHES, (HMA BINDER IL-19.0 MM)	PG 64-22 *	4% @ 70 GYR

THE UNIT WEIGHT USED TO CALCULATE ALL HOT-MIX ASPHALT SURFACE MIXTURE QUANTITIES IS 112 LBS/SY/IN.

* WHEN RAP EXCEEDS 20%, THE NEW ASPHALT BINDER IN THE MIX SHALL BE PG 58-22

CONTRACT NO. 60E37

SUMMARY OF QUANTITIES			URBAN 100% STATE		CONSTRUCTION TYPE CODE					
CODE NO	ITEM	UNIT	TOTAL QUANTITIES	1000-2A						
40600200	BITUMINOUS MATERIALS (PRIME COAT)	TON	15	15						
40600300	AGGREGATE (PRIME COAT)	TON	75	75						
40600400	MIXTURE FOR CRACKS, JOINTS, AND FLANGEWAYS	TON	15	15						
40600635	LEVELING BINDER (MACHINE METHOD), N70	TON	1260	1260						
40600982	HOT-MIX ASPHALT SURFACE REMOVAL - BUTT JOINT	SO YD	2880	2880						
40601005	HOT-MIX ASPHALT REPLACEMENT OVER PATCHES	TON	1500	1500						
40603340	HOT-MIX ASPHALT SURFACE COURSE, MIX "D", N70	TON	2520	2520						
44000158	HOT-MIX ASPHALT SURFACE REMOVAL, 2 1/4"	SO YD	29973	29973						
44002212	HOT-MIX ASPHALT REMOVAL OVER PATCHES, 3"	SO YD	8810	8810						
44201349	CLASS C PATCHES, TYPE I, 10 INCH	SO YD	615	615						
44201353	CLASS C PATCHES, TYPE II, 10 INCH	SO YD	194	194						
44201761	CLASS D PATCHES, TYPE I, 10 INCH	SO YD	683	683						
44201765	CLASS D PATCHES, TYPE II, 10 INCH	SO YD	2054	2054						
44201769	CLASS D PATCHES, TYPE III, 10 INCH	SO YD	1499	1499						
44201771	CLASS D PATCHES, TYPE IV, 10 INCH	SO YD	3105	3105						
67000400	ENGINEER'S FIELD OFFICE, TYPE A	CAL MO	3	3						
67100100	MOBILIZATION	L SUM	1	1						
70100450	TRAFFIC CONTROL AND PROTECTION, STANDARD 701201	L SUM	1	1						
70100460	TRAFFIC CONTROL AND PROTECTION, STANDARD 701306	L SUM	1	1						
70100600	TRAFFIC CONTROL AND PROTECTION, STANDARD 701336	L SUM	1	1						
70102620	TRAFFIC CONTROL AND PROTECTION, STANDARD 701501	L SUM	1	1						
70102625	TRAFFIC CONTROL AND PROTECTION, STANDARD 701606	L SUM	1	1						
70102630	TRAFFIC CONTROL AND PROTECTION, STANDARD 701601	L SUM	1	1						
70102635	TRAFFIC CONTROL AND PROTECTION, STANDARD 701701	L SUM	1	1						

SUMMARY OF QUANTITIES			URBAN 100% STATE		CONSTRUCTION TYPE CODE					
CODE NO	ITEM	UNIT	TOTAL QUANTITIES	1000-2A						
* 78000200	THERMOPLASTIC PAVEMENT MARKING - LINE 4"	FOOT	27250	27250						
* 78100100	RAISED REFLECTIVE PAVEMENT MARKER	EACH	1436	1436						
78300200	RAISED REFLECTIVE PAVEMENT MARKER REMOVAL	EACH	1436	1436						
X0322256	TEMPORARY INFORMATION SIGNING	SO FT	823	823						
X0324626	PORTLAND CEMENT CONCRETE SURFACE REMOVAL 2 1/4"	SO YD	33	33						
* XX006058	POLYUREA PAVEMENT MARKING - LINE 4"	FOOT	1340	1340						

* SPECIALTY ITEM

REVISIONS	
NAME	DATE

ILLINOIS DEPARTMENT OF TRANSPORTATION
SUMMARY OF QUANTITIES

PLOT DATE: 3/14/2008

3/14/2008 11:01:42 AM User:wjgreendp

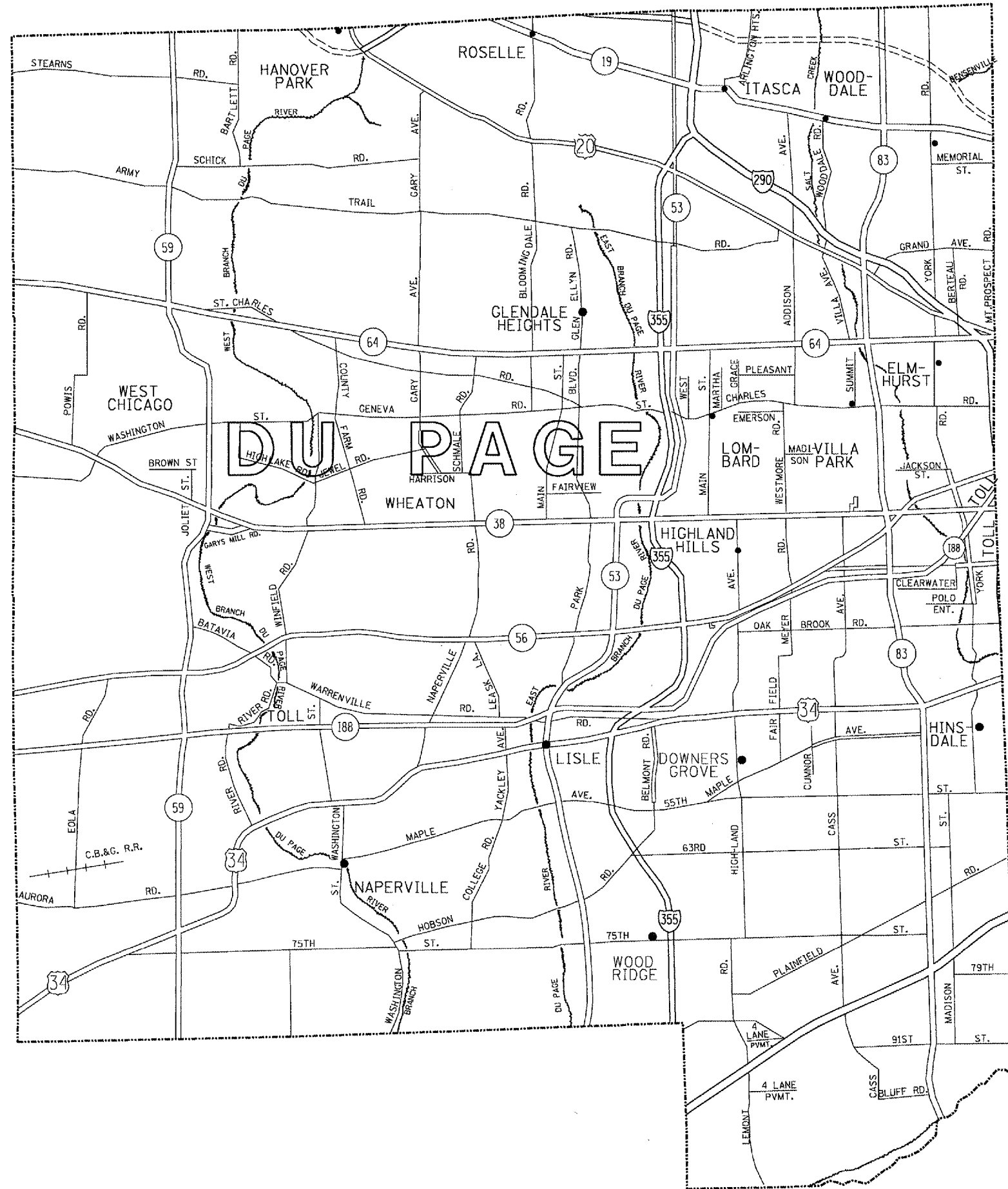

FILE NAME =
 c:\projects\113408\sh_cdw.dgn

USER NAME = sm:thkl
 PLOT SCALE = 100.0000 / IN.
 PLOT DATE = 3/14/2008

DESIGNED -
 DRAWN -
 CHECKED -
 DATE -

REVISED -
 REVISED -
 REVISED -
 REVISED -

**STATE OF ILLINOIS
 DEPARTMENT OF TRANSPORTATION**

GENERAL LOCATION MAP - DUPAGE COUNTY

SCALE: SHEET NO. OF SHEETS STA. TO STA.

F.A. RTE.	SECTION	COUNTY	TOTAL SHEETS	SHEET NO.
VAR.	2008-011 PP	DUPAGE	37	4
FED. ROAD DIST. NO. 1 ILLINOIS FED. AID PROJECT			CONTRACT NO. 60E37	

DuPAGE COUNTY ROUTE SEGMENT	MILL & RESURF (SY)	CLASS D PATCH TYPE I (SY)	CLASS D PATCH TYPE II (SY)	CLASS D PATCH TYPE III (SY)	CLASS D PATCH TYPE IV (SY)	PAVT MARKING 4" (FT)	RAISED REFL PAVT MKS (EACH)	PAVT MARKING 6" (FT)	PAVT MARKING 12" (FT)	PAVT MARKING 24" (FT)
22ND STREET (IL 83 TO BUTTERFIELD ROAD)	998	167	22	0	0	2640	300	750		
IL 38 (COUNTY FARM ROAD TO IL 59)	4406	17	124	147	355	2700	140			
IL 38 (IL 59 TO KIRK ROAD)	553	14	126	88	66	800	40			
IL 53 (75TH ST TO ST ANDREWS DRIVE)	3170	17	131	209	441	700	14			
IL 53 (BAKER HILL ROAD TO NICOLE WAY)	700		66	61	219	400	20			
IL 53 (LAKE STREET TO I-290)	1648		21			900	46			
IL 56 (I-355 TO LLOYD AVENUE)	2832		64	104		1500	70			
IL 56 (NAPERVILLE ROAD TO IL 25)	2173		80	351	451	120	60			
IL 59 (IL 64 TO HAWTHORNE LANE)	2523	8	128	122	269	1300	70			
IL 83 (BUTTERFIELD ROAD BRIDGE TO RIVERSIDE DRIVE)	1831	304	659			1700	160			
THORNDALE AVENUE(I-290 TO PARK AVENUE)	667		315	92	259	200	20			
US 20 (WALNUT ROAD TO YORK ROAD)	317	18	38			500	46			
US 20 (WALNUT ROAD TO YORK ROAD)		138	96			840	50			
US 30 (ORCHARD ROAD TO BLACKBERRY ROAD)	2044					250	20			
US 34 (I-355 TO BELMONT AVE)	675		150	161	390	12700	300		200	100
US 34 (NORTH AURORA TO IL 59)	5436		34	164	655					
SUMMARY TOTALS:	29973	683	2054	1499	3105	27250	1356	750	200	100

DuPAGE COUNTY ROUTE SEGMENT (PCC SECTIONS)	MILL & RESURF (SY)	CLASS C PATCH TYPE I (SY)	CLASS C PATCH TYPE II (SY)	CLASS C PATCH TYPE III (SY)	CLASS C PATCH TYPE IV (SY)	PAVT MARKING 4" (FT)	RAISED REFL PAVT MKS (EACH)
22ND STREET (IL 83 TO BUTTERFIELD ROAD)	33	477	98			500	30
US 20 (WALNUT ROAD TO YORK ROAD)		138	96			840	50
SUMMARY TOTALS:	33	615	194			1340	80

ROUTE: US RTE 20 (WALNUT RD TO YORK RD)

CROSS STREETS		DIRECTION (EB/WB) (NB/SB)	LANE NO. (1, 2, 3)	PAVEMENT PATCH WIDTH	PAVEMENT PATCH LENGTH	REPAIR AREA (SQ FT)	REPAIR AREA (SQ YD)	SURFACE TYPE (PCC/ASPHALT)	MILL & RESURF	CLASS D PATCH TYPE I	CLASS D PATCH TYPE II	CLASS D PATCH TYPE III	CLASS D PATCH TYPE IV	PAVT MARKING 4"	RAISED REFL PAVT MKS
FROM	TO														
WALNUT RD	YORK RD	EB	1	2	3	6	1	PCC		1					
WALNUT RD	YORK RD	EB	1	2	3	6	1	PCC		1					
WALNUT RD	YORK RD	EB	1	3	3	9	1	PCC		1					
WALNUT RD	YORK RD	EB	1	12	2	24	3	PCC		3					
WALNUT RD	YORK RD	EB	1	12	2	24	3	PCC		3					
WALNUT RD	YORK RD	EB	1	12	2	24	3	PCC		3					
WALNUT RD	YORK RD	EB	1	2	2	4	1	PCC		1					
WALNUT RD	YORK RD	EB	1	6	5	30	3	PCC		3					
WALNUT RD	YORK RD	EB	1	2	2	4	1	PCC		1					
WALNUT RD	YORK RD	EB	1	3	2	6	1	PCC		1					
WALNUT RD	YORK RD	EB	1	12	2	24	3	PCC		3					
WALNUT RD	YORK RD	EB	1	12	2	24	3	PCC		3					
WALNUT RD	YORK RD	EB	1	12	2	24	3	PCC		3					
WALNUT RD	YORK RD	EB	1	12	2	24	3	PCC		3					
WALNUT RD	YORK RD	EB	1	3	3	9	1	PCC		1					
WALNUT RD	YORK RD	EB	1	3	3	9	1	PCC		1					
WALNUT RD	YORK RD	EB	1	3	15	45	5	PCC			5				
WALNUT RD	YORK RD	EB	1	3	3	9	1	PCC		1					
WALNUT RD	YORK RD	EB	1	12	2	24	3	PCC		3					
WALNUT RD	YORK RD	EB	1	12	2	24	3	PCC		3					
WALNUT RD	YORK RD	EB	1	12	2	24	3	PCC		3					
WALNUT RD	YORK RD	EB	1	12	7	84	9	PCC			9				
WALNUT RD	YORK RD	EB	1	6	3	18	2	PCC		2					
WALNUT RD	YORK RD	EB	1	12	2	24	3	PCC		3					
WALNUT RD	YORK RD	EB	1	12	2	24	3	PCC		3					
WALNUT RD	YORK RD	EB	1	6	4	24	3	PCC		3					
WALNUT RD	YORK RD	EB	1	3	15	45	5	PCC			5				
WALNUT RD	YORK RD	EB	1	4	4	16	2	PCC		2					
WALNUT RD	YORK RD	EB	2	4	4	16	2	PCC		2					
WALNUT RD	YORK RD	EB	2	4	4	16	2	PCC		2					
WALNUT RD	YORK RD	EB	2	6	2	12	1	PCC		1					
WALNUT RD	YORK RD	EB	2	12	2	24	3	PCC		3					
WALNUT RD	YORK RD	EB	2	4	5	20	2	PCC		2					
WALNUT RD	YORK RD	EB	2	3	3	9	1	PCC		1					
WALNUT RD	YORK RD	EB	2	4	5	20	2	PCC		2					
WALNUT RD	YORK RD	EB	2	6	2	12	1	PCC		1					
WALNUT RD	YORK RD	EB	2	6	2	12	1	PCC		1					
WALNUT RD	YORK RD	EB	2	4	4	16	2	PCC		2					
WALNUT RD	YORK RD	EB	2	12	2	24	3	PCC		3					
WALNUT RD	YORK RD	EB	2	12	6	72	8	PCC			8				
WALNUT RD	YORK RD	EB	2	2	7	14	2	PCC		2					
WALNUT RD	YORK RD	EB	2	4	5	20	2	PCC		2					
WALNUT RD	YORK RD	EB	2	4	4	16	2	PCC		2					
WALNUT RD	YORK RD	EB	2	4	4	16	2	PCC		2					
WALNUT RD	YORK RD	EB	2	4	6	24	3	PCC		3					
WALNUT RD	YORK RD	EB	2	2	3	6	1	PCC		1					
WALNUT RD	YORK RD	EB	2	3	3	9	1	PCC		1					
WALNUT RD	YORK RD	EB	2	12	2	24	3	PCC		3					
WALNUT RD	YORK RD	EB	2	12	10	120	13	PCC			13				
WALNUT RD	YORK RD	EB	2	12	2	24	3	PCC		3					
WALNUT RD	YORK RD	EB	2	12	2	24	3	PCC		3					
WALNUT RD	YORK RD	EB	2	2	2	4	1	PCC		1					
WALNUT RD	YORK RD	EB	2	12	3	36	4	PCC		4					
WALNUT RD	YORK RD	EB	2	4	3	12	1	PCC		1					
WALNUT RD	YORK RD	EB	2	12	2	24	3	PCC		3					
WALNUT RD	YORK RD	EB	2	12	8	96	11	PCC			11				
WALNUT RD	YORK RD	EB	2	12	2	24	3	PCC		3					
WALNUT RD	YORK RD	EB	2	12	2	24	3	PCC		3					
WALNUT RD	YORK RD	EB	2	4	4	16	2	PCC		2					
WALNUT RD	YORK RD	EB	2	12	2	24	3	PCC		3					
WALNUT RD	YORK RD	EB	2	4	4	16	2	PCC		2					
WALNUT RD	YORK RD	EB	2	4	4	16	2	PCC		2					
WALNUT RD	YORK RD	EB	2	4	4	16	2	PCC		2					
WALNUT RD	YORK RD	EB	2	4	5	20	2	PCC		2					
WALNUT RD	YORK RD	EB	2	12	2	24	3	PCC		3					
WALNUT RD	YORK RD	EB	2	12	2	24	3	PCC		3					
WALNUT RD	YORK RD	EB	2	4	6	24	3	PCC		3					
WALNUT RD	YORK RD	EB	2	4	4	16	2	PCC		2					
WALNUT RD	YORK RD	EB	2	12	2	24	3	PCC		3					
WALNUT RD	YORK RD	EB	2	12	6	72	8	PCC			8				
WALNUT RD	YORK RD	EB	2	3	3	9	1	PCC		1					
WALNUT RD	YORK RD	EB	2	12	2	24	3	PCC		3					
WALNUT RD	YORK RD	EB	2	12	6	72	8	PCC			8				
WALNUT RD	YORK RD	EB	2	12	4	48	5	PCC			5				
WALNUT RD	YORK RD	EB	2	4	4	16	2	PCC		2					
WALNUT RD	YORK RD	EB	2	12	6	72	8	PCC			8				
WALNUT RD	YORK RD	EB	2	12	6	72	8	PCC			8				
WALNUT RD	YORK RD	EB	2	3	3	9	1	PCC		1					
WALNUT RD	YORK RD	EB	2	12	3	36	4	PCC		4					
WALNUT RD	YORK RD	EB	2	12	6	72	8	PCC			8				

TOTLAS:

235
SY

138
SY

96
SY

FILE NAME =
c:\pcc\jts\dl36208\design_00.dgn

USER NAME = wilgreendp

DESIGNED -

REVISED -

DRAWN -

REVISED -

PLOT SCALE = 103.7051' / IN.

CHECKED -

REVISED -

PLOT DATE = 3/14/2008

DATE -

REVISED -

STATE OF ILLINOIS
DEPARTMENT OF TRANSPORTATION

PATCHING SCHEDULE
US 20

SCALE: SHEET NO. OF SHEETS STA. TO STA.

F.A.P. RTE. VAR.	SECTION 2008-011 PP	COUNTY DUPAGE	TOTAL SHEETS 37	SHEET NO. 7
FED. ROAD DIST. NO. 1 ILLINOIS FED. AID PROJECT			CONTRACT NO. 60E37	

ROUTE: US 30 (ORCHARD RD TO BLACKBERRY RD)

CROSS STREETS		DIRECTION (EB/WB) (NB/SB)	LANE NO. (1, 2, 3)	PAVEMENT PATCH WIDTH	PAVEMENT PATCH LENGTH	REPAIR AREA (SQ FT)	REPAIR AREA (SQ YD)	MILL & RESURF	CLASS D PATCH TYPE I	CLASS D PATCH TYPE II	CLASS D PATCH TYPE III	CLASS D PATCH TYPE IV	PAVT MARKING 4"	RAISED REFL PAVT MKS
FROM	TO													
ORCHARD RD	BLACKBERRY RD	EB & WB	1, 2	32	584	18396	2044	2044						
							SY	SY						

FILE NAME = c:\projects\dl136288\design_00.dgn	USER NAME = wilgreendp	DESIGNED -	REVISED -	STATE OF ILLINOIS DEPARTMENT OF TRANSPORTATION	PATCHING SCHEDULE US 30			F.A.P. RTE.	SECTION	COUNTY	TOTAL SHEETS	SHEET NO.
	PLOT SCALE = 1/8" = 100' / IN.	DRAWN -	REVISED -					VAR.	2008-011 PP	DUPAGE	37	8
PLOT DATE = 3/14/2008	CHECKED -	REVISED -	SCALE: SHEET NO. OF SHEETS STA. TO STA.			FED. ROAD DIST. NO. 1 ILLINOIS FED. AID PROJECT		CONTRACT NO. 60E37				
	DATE -	REVISED -										

ROUTE: IL 38 (County Farm Road to IL 59)

CROSS STREETS		DIRECTION (EB/WB) (NB/SB)	LANE NO. (1, 2, 3)	PAVEMENT PATCH WIDTH	PAVEMENT PATCH LENGTH	REPAIR AREA (SQ FT)	REPAIR AREA (SQ YD)	MILL & RESURF	CLASS D PATCH TYPE I	CLASS D PATCH TYPE II	CLASS D PATCH TYPE III	CLASS D PATCH TYPE IV	PAVT MARKING 4"	RAISED REFL PAVT MKS
FROM	TO													
COUNTY FARM RD	SHAFFNER RD	WB	1	11	11	121	13			13				
		WB	2	8	250	2000	222	222						
SHAFFNER RD	MYRTLE ST	WB	2	11	70	770	86	86						
MYRTLE ST	EAST ST	WB	1	8	40	320	36	36						
EAST ST	MADISON ST	WB	1	4	100	400	44	44						
		WB	2	11	16	176	20				20			
	NEAR E.O.P	WB	2	6	150	900	100	100						
		WB	1	11	50	550	61	61						
	NEAR E.O.P	WB	2	6	100	600	67	67						
		WB	1	11	60	660	73	73						
MADISON ST	FOREST ST	WB	2	6	200	1200	133	133						
		WB	2	6	100	600	67	67						
		WB	2	4	100	400	44	44						
FOREST ST	GRAND ST	WB	1	11	30	330	37					37		
GRAND ST	WINFIELD RD	WB	2	11	12	132	15			15				
WINFIELD RD	WYNWOOD	WB	2	11	12	132	15			15				
GARYMILLS	EAST ST	EB	1	8	20	160	18				18			
		EB	1	10	30	300	33					33		
	WEST OF GARY MILLS	EB	2	8	40	320	36					36		
	EAST OF GARYMILLS	EB	1	8	30	240	27					27		
	EAST OF GARYMILLS	EB	2	8	40	320	36					36		
		EB	1	8	20	160	18				18			
		EB	1	6	100	600	67	67						
		EB	1	10	30	300	33					33		
		EB	1	8	30	240	27					27		
		EB	1	8	50	400	44	44						
	INDIAN KNOLL RD	EB	1	4	200	800	89	89						
		EB	2	11	10	110	12			12				
	E.O.P	EB	2	8	50	400	44	44						
		EB	1	4	200	800	89	89						
		EB	1	4	8	32	4		4					
		EB	1	4	300	1200	133	133						
		EB	1	6	100	600	67	67						
		EB	1	11	100	1100	122	122						
WYNWOOD	PRINCE CROSSING	WB	1	8	50	400	44	44						
		WB	2	11	16	176	20				20			
	E.O.P	WB	2	8	200	1600	178	178						
		WB	1	8	30	240	27					27		
	E.O.P	WB	2	6	50	300	33	33						
		WB	1	4	6	24	3		3					
		WB	1	4	6	24	3		3					
		WB	1	16	4	64	7			7				
		WB	1	11	6	66	7			7				
		WB	2	11	18	198	22				22			
		WB	2	11	60	660	73	73						
		WB	2	8	30	240	27					27		
		WB	2	8	75	600	67	67						
		WB	1&2	22	16	352	39					39		
	E.O.P	WB	2	8	150	1200	133	133						
		WB	2	10	30	300	33					33		
		WB	1	11	50	550	61	61						
		WB	2	8	30	240	27				27			
GRAND ST	FOREST STREET	EB	2	6	50	300	33	33						
		EB	1	8	60	480	53	53						
		EB	2	6	60	360	40	40						

CONTINUED ON THE NEXT SHEET

FILE NAME = c:\proj\jct\136228\design_aa.dgn	USER NAME = wilgreendp	DESIGNED -	REVISED -	STATE OF ILLINOIS DEPARTMENT OF TRANSPORTATION	PATCHING SCHEDULE IL 38				F.A.P. RTE.	SECTION	COUNTY	TOTAL SHEETS	SHEET NO.	
	PLOT SCALE = 1/83.7851" / IN.	DRAWN -	REVISED -		SCALE:	SHEET NO.	OF	SHEETS	STA.	TO STA.	VAR.	2008-011 PP	DUPAGE	37 / 11
	PLOT DATE = 3/14/2008	CHECKED -	REVISED -		CONTRACT NO. 60E37									
		DATE -	REVISED -		FED. ROAD DIST. NO. 1 ILLINOIS FED. AID PROJECT									

ROUTE: IL.38 (County Farm Road to IL.59)

CROSS STREETS		DIRECTION (EB/WB) (NB/SB)	LANE NO. (1, 2, 3)	PAVEMENT PATCH WIDTH	PAVEMENT PATCH LENGTH	REPAIR AREA (SQ FT)	REPAIR AREA (SQ YD)	MILL & RESURF	CLASS D PATCH TYPE I	CLASS D PATCH TYPE II	CLASS D PATCH TYPE III	CLASS D PATCH TYPE IV	PAVT MARKING 4"	RAISED REFL PAVT MKS
FROM	TO													
FORSET ST	MADISON ST	EB	2	11	12	132		15		15				
		EB	1	6	50	300	33	33						
	E.O.P	EB	2	6	100	600	67	67						
		EB	2	11	60	660	73	73						
	E.O.P	EB	2	4	200	800	89	89						
		EB	1	6	100	600	67	67						
		EB	1	8	100	800	89	89						
	E.O.P	EB	2	6	200	1200	133	133						
MADISON ST	EAST ST	EB	1	6	200	1200	133	133						
		EB	2	6	200	1200	133	133						
		EB	2	6	100	600	67	67						
	E.O.P	EB	1	8	100	800	89	89						
EAST ST	MYRTELE ST	EB	2	8	80	640	71	71						
		EB	1	8	100	800	89	89						
		EB	2	6	100	600	67	67						
	E.O.P FAILURE	EB	2	6	100	600	67	67						
IL.59	PRINCE CROSSING	EB	1	4	50	200	22	22						
		EB	2	10	20	200	22				22			
		EB	2	8	60	480	53	53						
		EB	1	11	50	550	61	61						
		EB	1	6	10	60	7	7	7					
		EB	2	8	60	480	53	53						
		EB	1	8	60	480	53	53						
		EB	1	8	50	400	44	44						
		EB	1,2	22	12	264	29	29						
	E.O.P	EB	2	8	40	320	36	36						
		EB	1	11	12	132	15	15		15				
		EB	1	4	500	2000	222	222						
PRINCE CROSSING	GARYMILLS	EB	2	8	12	96	11	11						
		EB	1	8	30	240	27	27						
		EB	1	6	50	300	33	33						
		EB	1	8	11	88	10	10			10			
MYRTLE ST		EB	1	6	100	600	67	67						
		EB	1	11	40	440	49	49						
		EB	1	11	12	132	15	15		15				
SHAFFNER RD 022-0145, WEST OF SHAFFNER RD BRIDGE		EB	1,2	22	4	88	10	10						
COUNTY FARM RD		EB	2	6	100	600	67	67						
		EB	2	11	40	440	49	49						

TOTALS: 5015 SY 4406 SY 17 SY 124 SY 147 SY 355 SY FT EACH

ROUTE: IL 38 (IL 59 to Kirk Road)

CROSS STREETS		DIRECTION (EB/WB) (NB/SB)	LANE NO. (1, 2, 3)	PAVEMENT PATCH WIDTH	PAVEMENT PATCH LENGTH	REPAIR AREA (SQ FT)	REPAIR AREA (SQ YD)	MILL & RESURF	CLASS D PATCH TYPE I	CLASS D PATCH TYPE II	CLASS D PATCH TYPE III	CLASS D PATCH TYPE IV	PAVT MARKING 4"	RAISED REFL PAVT MKS
FROM	TO													
IL 59	1 MILE WEST	WB	2	4	6	24	3		3					
IL 59	1 MILE WEST	WB	2	4	75	300	33	33				33		
JOLIET RD 1 MILE WEST	1000' WEST	WB	2	4	25	100	11			11				
	200' WEST/ 1000' EAST RR	WB	2	2	10	20	2		2					
RR BRIDGE	50 WEST	WB	1	4	24	96	11			11				
RR BIDGE	50 WEST	WB	1	12	10	120	13			13				
RR BRIDGE	200 WEST	WB	2	4	20	80	9			9				
RR BRIDGE	1000' WEST	WB	2	10	20	200	22				22			
PEARL RD	200' WEST	WB	2	5	15	75	8			8				
PERAL RD	250 WEST	WB	2	5	45	225	25	25						
PEARL RD	300 WEST	WB	2	3	15	45	5			5				
PEARL RD	300 WEST	WB	2	5	25	125	14			14				
PEARL RD	1000' WEST	WB	2	5	60	300	33	33						
PEARL RD	1000' WEST	WB	1	1	200	200	22	22						
IL 59/ 2 MILE WEST	1,500' WEST	WB	1	1	200	200	22	22						
IL 59 2 MILE WEST	2 MILE WEST	WB	2	4	4	16	2		2					
IL 59	2 MILE WEST	WB	2	4	20	80	9			9				
RR TRACKS	50' WEST	WB	2	5	100	500	56	56						
WASHINGTON STREET	1000' WEST	WB	2	4	100	400	44	44						
KRESS RD	1000' EAST	WB	2	10	30	300	33					33		
KRESS RD	1050' EAST	WB	2	4	10	40	4		4					
KRESS RD	2000' EAST	WB	2	5	60	300	33	33						
KRESS RD	2050 EAST	WB	2	5	10	50	6			6				
KAUTZ RD	1000' EAST AT RR TRACKS	WB	1	5	25	125	14			14				
KIRK RD	1000' WEST	WB	2	4	100	400	44	44						
KIRK RD	1000' EAST	EB	2	2	200	400	44	44						
KIRK RD	2000' EAST	EB	2	3	100	300	33	33						
KAUTZ RD	200' EAST	EB	2	4	6	24	3		3					
KRESS RD	2000' WEST	EB	2	5	60	300	33	33						
KRESS RD	1,500' WEST	EB	2	4	30	120	13			13				
WASHINGTON PASTAN PKWAY	1000' EAST	EB	2	5	75	375	42	42						
RR TRACKS / 2ND	50' WEST	EB	2	10	12	120	13			13				
	25' WEST	EB	2	10	20	200	22				22			
	10 WEST	EB	1	10	20	200	22				22			
	100' WEST	EB	2	10	20	200	22				22			
TOWN RD	100' WEST	EB	2	20	40	800	89	89						

TOTALS: 818 SY 553 SY 14 SY 126 SY 88 SY 66 SY FT EACH

ROUTE: IL 53 (75th St to St. Andrews Dr.)

CROSS STREETS		DIRECTION (EB/WB) (NB/SB)	LANE NO. (1, 2, 3)	PAVEMENT PATCH WIDTH	PAVEMENT PATCH LENGTH	REPAIR AREA (SQ FT)	REPAIR AREA (SQ YD)	MILL & RESURF	CLASS D PATCH TYPE I	CLASS D PATCH TYPE II	CLASS D PATCH TYPE III	CLASS D PATCH TYPE IV	PAVT MARKING 4"	RAISED REFL PAVT MKS
FROM	TO													
St. Andrews Dr	300' North	NB	1	6	10	60	7			7				
Justamere	200' South	NB	1	4	15	60	7			7				
	200' North	NB	1	4	6	24	3		3					
	210' North	NB	1	4	4	16	2		2					
	225' North	NB	1	6	10	60	7			7				
Oldwoods Drive	100' North	NB	1	6	20	120	13			13				
	400' North	NB	1	6	10	60	7			7				
	420' North	NB	1	4	4	16	2		2					
	500' North	NB	1	6	8	48	5			5				
63rd Street	100' South	NB	1	4	4	16	2		2					
	10' South	NB	2	4	4	16	2		2					
	500' North	NB	1	6	15	90	10			10				
Everglade Ave	100' North	NB	1	4	100	400	44	44						
	200' North	NB	1	4	125	500	56	56						
	300' North	NB	1	11	20	220	24				24			
	400' North	NB	2	11	10	110	12			12				
	600' North	NB	1	6	15	90	10			10				
	1000' North	NB	2	4	4	16	2		2					
Fox Ridge Ct	400' South	NB	2	4	10	40	4		2					
	350' South	NB	1	4	50	200	22	22						
	250' South	NB	1	11	40	440	49	49						
	At	NB	1	4	20	80	9			9				
75th Street	At	NB	1,2& turn Lns	44	300	13200	1467	1467						
	At	SB	1,2	22	300	6600	733	733						
Fox Ridge Ct	50' South	SB	2	11	20	220	24				24			
	75' South	SB	1	6	20	120	13			13				
	100' South	SB	2	11	100	1100	122	122						
	200' South	SB	2	11	50	550	61	61						
	300' South	SB	1	8	25	200	22				22			
	1000' South	SB	2	11	50	550	61	61						
	1200' South	SB	2	11	75	825	92	75						
Everglade Ave	200' North	SB	1	6	20	120	13			13				
	150' North	SB	2	11	30	330	37					37		
	50' North	SB	1	8	20	160	18				18			
	50' North	SB	2	8	20	160	18				18			
	At	SB	1	8	10	80	9			9				
Everglade Ave	25' South	SB	1	8	100	800	89	89						
	75' South	SB	2	8	20	160	18				18			
	125' South	SB	1	8	20	160	18				18			
	200' South	SB	2	8	30	240	27					27		
	225' South	SB	1	11	30	330	37					37		
	350' South	SB	2	8	30	240	27					27		
	400' South	SB	2	11	25	275	31					31		
	450' South	SB	2	8	40	320	36	36						
	500' South	SB	2	8	20	160	18				18			
	600' South	SB	2	8	100	800	89	89						
	700' South	SB	2	8	30	240	27					27		
63rd Street	200' North	SB	2	8	30	240	27					27		
	150' North	SB	2	11	30	330	37					37		
	50' North	SB	2	8	10	80	9			9				
	100' South	SB	2	11	30	330	37					37		
	125' South	SB	1	4	100	400	44	44						
	200' South	SB	1	11	40	440	49					49		
	500' South	SB	2	8	30	240	27				27			
63rd Street	600' South	SB	2	8	25	200	22				22			
Justamere Road	25' North	SB	2	11	30	330	37					37		
	50' South	SB	2	11	30	330	37					37		
	200' South	SB	2	4	4	16	2		2					
	500' South	SB	1	11	25	275	31					31		
	700' South	SB	2	11	50	550	61	61						
ST Andrews Dr	100' North	SB	1	11	100	1100	122	100						
	100' North	SB	2	11	50	550	61	61						

TOTALS:

4004 SY 3170 SY 17 SY 131 SY 209 SY 441 SY 700 FT 14 EACH

FILE NAME = c:\proj\p02a\dl36208\design.ae.dgn

USER NAME = wilgreendo

DESIGNED -

REVISED -

DRAWN -

REVISED -

CHECKED -

REVISED -

DATE -

REVISED -

STATE OF ILLINOIS
DEPARTMENT OF TRANSPORTATION

PATCHING SCHEDULE
IL 53

SCALE: SHEET NO. OF SHEETS STA. TO STA.

F.A.P. RTE.	SECTION	COUNTY	TOTAL SHEETS	SHEET NO.
VAR.	2008-011 PP	DUPAGE	37	14
FED. ROAD DIST. NO. 1 ILLINOIS FED. AID PROJECT			CONTRACT NO. 60E37	

ROUTE: IL 56 (Naperville Road to IL 25)

CROSS STREETS		DIRECTION (EB/WB) (NB/SB)	LANE NO. (1, 2, 3)	PAVEMENT PATCH WIDTH	PAVEMENT PATCH LENGTH	REPAIR AREA (SQ FT)	REPAIR AREA (SQ YD)	MILL & RESURF	CLASS D PATCH TYPE I	CLASS D PATCH TYPE II	CLASS D PATCH TYPE III	CLASS D PATCH TYPE IV	PAVT MARKING 4"	RAISED REFL PAVT MKS
FROM	TO													
300' east of Orchard Rd		WB	2	8	10	80	9		9					
40' east of madison St		WB / EB	1, 2	22	8	176	20			20				
30' west of madison St		WB / EB	1, 2	60	22	1320	147	147						
at winfield Rd, Soulder		WB		8	60	480	53	53						
400' east of Batavia Ave		WB / EB	1, 2	22	8	176	20			20				
east of west Branch dupage river	EAST BRIDGE APPROACH	WB / EB	1, 2	32	50	1600	178	178						
west approach of west branch dupage river	WEST BRIDGE APPROACH	EB / WB	1, 2	30	32	960	107				107			
Box culvert, SN 022-0166	DECK SURFACE	EB / WB	1, 2	24	40	960	107				107			
150' west of Barkly ave		WB	1	10	75	750	83	83						
quarter mile west of IL Rt 59		WB	1	12	8	96	11		11					
20' east of Briggs Ave		WB	1	12	12	144	16			16				
30' west of R.R Bridge		WB / EB	1, 2	22	12	264	29			29				
30' east of R.R Bridge		WB / EB	1, 2	22	20	440	49			49				
200' west of R.R Bridge		WB	1	11	12	132	15			15				
700' WEST OF EOLA Rd	NEAR E.O.P	WB	1	12	20	240	27			27				
800' west of eola Rd		WB	1	10	20	200	22			22				
2 miles west of eola Rd		WB	1	10	70	700	78	78						
100' west of county line		WB	1	10	20	200	22			22				
200' east of willian Rd		EB	1	8	60	480	53	53						
300' EAST OF WILLIAM RD		EB	1	11	50	550	61	61						
1/2 MILE WEST OF BATAVIA		EB	1	11	25	275	31				31			
100' west of Rockwell		EB	1	8	50	400	44				44			
1/4 MILE WEST OF WINFIELD RD		EB	1	6	100	600	67	67						
EB SHOULDER, EAST OF WINFIELD RD		EB		6	100	600	67	67						
WEST OF MADISON ST		EB		6	100	600	67	67						
300' west of wiesbrook Rd		EB	1	11	40	440	49				49			
200' west of wiesbrook		EB	1	6	12	72	8		8					
150' west of wiesbrook Rd		EB	1	8	15	120	13		13					
75' west of wiesbrook Rd		EB	1	10	20	200	22			22				
50' WEST OF PATTERNMAN	NEAR E.O.P	EB	1	6	50	300	33	33						
100' EAST OF PATTERNMAN		EB	1	4	50	200	22	22						
IL 56 & DUPAGE PARKWAY		WB	1,2	12	22	264	29			29				
100' OF BRAGGS		WB	1	10	12	120	13		13					
20 E. OF BRAGGS AV		WB	1	12	12	144	16			16				
30' WEST OF BRAGGS AV		WB/EB	1,2	22	12	264	29			29				
200' WEST OF R.R BRIDGE		WB	1	11	12	132	15			15				
100' West of County line, edge of shoulder		WB	1	5	100	500	56	56						
250' EAST OF KIRK RD	INTERSECTION UNDER CONSTRUCTION	WB	1	20	50	1000	111	111						
WEST OF HART RD		WB	1	8	150	1200	133	113						
300' WEST OF DANBURY RD	MISSING SURFACE	WB	1	10	100	1000	111	111						
200' EAST OF HART RD		EB	1	6	30	180	20			20				
WEST OF GINGER WOOD		EB	1	10	12	120	13		13					
600' E. OF GINGERWOOD		EB	1	6	100	600	67	67						
AT TRENT DR		EB	1	12	40	480	53				53			
AT DUPAGE COUNTY LINE & KANE		EB	1	6	100	600	67	67						
1000' W. OF HEDGROW DR		EB	1	8	15	120	13		13					
1000' W. OF HEDGEROW DR		EB	1	5	120	600	67	67						
1000' EAST OF HEDGEROW		EB	1	6	250	1500	167	167						
1/2 MILE W. OF EOLA RD		EB	1	6	50	300	33	33						
1/3 MILE W. OF EOLA RD		EB	1	8	30	240	27				27			
1/4 MILE W. OF EOLA RD		WB	1	10	30	300	33				33			
WEST OF IL 59		WB	1	10	300	3000	333	333						
EAST OF IL 59		EB	1	5	250	1250	139	139						

TOTALS:

3074 SY 2173 SY 80 SY 351 SY 451 SY

ROUTE: IL 59 (IL 64 to Hawthorne Lane)

CROSS STREETS		DIRECTION (EB/WB) (NB/SB)	LANE NO. (1, 2, 3)	PAVEMENT PATCH WIDTH	PAVEMENT PATCH LENGTH	REPAIR AREA (SQ FT)	REPAIR AREA (SQ YD)	MILL & RESURF	CLASS D PATCH TYPE I	CLASS D PATCH TYPE II	CLASS D PATCH TYPE III	CLASS D PATCH TYPE IV	PAVT MARKING 4"	RAISED REFL PAVT MKS
FROM	TO													
Hawthorne Ln	At	NB	1	4	20	80	9			9				
	10' North	NB	1	11	30	330	37					37		
	50' North	NB	1	11	30	330	37					37		
	400' North	NB	2	4	30	120	13			13				
	650' North	NB	1	4	70	280	31	31						
	700' North	NB	2	4	30	120	13			13				
Ingaltion Ave	500' South	NB	1,2	22	30	660	73					73		
	300' South	NB	1	8	25	200	22				22			
	200' South	NB	1	4	30	120	13			13				
	100' South	NB	1	4	20	80	9			9				
	50' South	NB	1	8	10	80	9			9				
	100' South	NB	RT	10	20	200	22				22			
Ingaltion Ave	At	NB	1	4	30	120	13			13				
	At	NB	2	4	60	240	27	27						
	20' North	NB	1	11	20	220	24				24			
	100' North	NB	1	11	40	440	49	49						
	300' North	NB	1	11	30	330	37					37		
	500' North	NB	1	8	30	240	27				27			
Ingaltion Ave	700' North	NB	2	8	40	320	36	36						
Hanford Road	300' South	NB	2	4	20	80	9			9				
	At	NB	1,2	4	30	120	13			13				
	20' North	NB	1,2	22	40	880	98	98						
	20' North	SB	1,2	22	20	440	49					49		
	60' North	NB	1,2	22	160	3520	391	391						
	60' North	SB	1,2	22	160	3520	391	391						
	200' North	NB	1,2	22	60	1320	147	147						
	200' North	SB	1,2	22	60	1320	147	147						
	250' North	NB	1	11	100	1100	122	122						
	10' South	SB	1	11	4	44	5			5				
	50' South	SB	2	4	10	40	4		4					
	100' South	SB	2	4	400	1600	178	178						
	600' South	SB	1	6	500	3000	333	333						
	500' South	SB	1	11	30	330	37							
	600' South	SB	2	8	100	800	89	89						
Anbor Ave	300' North	SB	1	8	200	1600	178	178						
	20' North	SB	1	8	30	240	27				27			
Arbor Ave	At	SB	1	8	40	320	36					36		
	100' South	SB	1	8	50	400	44	44						
	200' South	SB	1	4	100	400	44	44						
	200' South	SB	2	4	40	160	18	18						
	300' South	SB	1	6	300	1800	200	200						
	400' South	SB	2	4	10	40	4		4					
	700' South	SB	2	6	20	120	13			13				
	800' South	SB	1	4	20	80	9			9				

TOTALS: 3087 SY 2523 SY 8 SY 128 SY 122 SY 269 SY FT EACH

ROUTE: IL 83 (Butterfield Rd Bridge to Riverside Dr)

CROSS STREETS		DIRECTION (EB/WB) (NB/SB)	LANE NO. (1, 2, 3)	PAVEMENT PATCH WIDTH	PAVEMENT PATCH LENGTH	REPAIR AREA (SQ FT)	REPAIR AREA (SQ YD)	MILL & RESURF	CLASS D PATCH TYPE I	CLASS D PATCH TYPE II	CLASS D PATCH TYPE III	CLASS D PATCH TYPE IV	PAVT MARKING 4"	RAISED REFL PAVT MKS
FROM	TO													
Butterfield Rd Bridge	Riverside Dr	NB	1	4	4	16	2		2					
"	"	NB	1	3	4	12	1		1					
"	"	NB	1	2	6	12	1		1					
"	"	NB	1	6	6	36	4		4					
"	"	NB	1	2	2	4	1		1					
"	"	NB	2	2	4	8	1		1					
"	"	NB	1	3	3	9	1		1					
"	"	NB	1	2	4	8	1		1					
Butterfield Rd Bridge	Riverside Dr	NB	1	2	2	4	1		1					
"	"	NB	2	2	2	4	1		1					
"	"	NB	1	2	7	14	2		2					
"	"	NB	1	2	2	4	1		1					
Riverside Dr	Butterfield Rd Bridge	SB	2	2	2	4	1		1					
"	"	SB	2	2	2	4	1		1					
"	"	SB	1	2	2	4	1		1					
"	"	SB	1	12	7	84	9			9				
"	"	SB	2	12	7	84	9			9				
"	"	SB	1	2	10	20	2		2					
"	"	SB	1	12	5	60	7			7				
"	"	SB	2	8	15	120	13			3				
"	"	SB	2	2	4	8	1		1					
"	"	SB	2	6	15	90	10			10				
"	"	SB	2	2	4	8	1		1					
"	"	SB	2	3	10	30	3		3					
"	"	SB	2	2	3	6	1		1					
"	"	SB	2	2	2	4	1		1					
Riverside Dr	Butterfield Rd Bridge	SB	1	12	6	72	8			8				
"	"	SB	2	12	6	72	8			8				
"	"	SB	1	4	5	20	2		2					
"	"	SB	1	2	4	8	1		1					
"	"	SB	2	3	3	9	1		1					
"	"	SB	1	6	10	60	7			7				
"	"	SB	2	6	6	36	4		4					
"	"	SB	2	6	6	36	4		4					
"	"	SB	2	4	6	24	3		3					
"	"	SB	2	12	6	72	8			8				
"	"	SB	2	6	6	36	4		4					
"	"	SB	2	12	6	72	8			8				
"	"	SB	2	3	3	9	1		1					
"	"	SB	2	3	3	9	1		1					
"	"	SB	2	2	4	8	1		1					
"	"	SB	2	6	5	30	3		3					
"	"	SB	2	4	5	20	2		2					
"	"	SB	1	5	9	45	5		5					
Riverside Dr	Butterfield Rd Bridge	SB	2	3	3	9	1		1					
"	"	SB	2	2	3	6	1		1					
"	"	SB	1	12	5	60	7			7				
"	"	SB	2	12	5	60	7			7				
"	"	SB	1	12	5	60	7			7				
"	"	SB	2	12	5	60	7			7				
"	"	SB	1	12	5	60	7			7				
"	"	SB	2	12	5	60	7			7				
"	"	SB	2	6	6	36	4		4					
"	"	SB	2	6	6	36	4		4					
"	"	SB	2	5	9	45	5		5					
"	"	SB	1	12	5	60	7			7				
"	"	SB	2	12	5	60	7			7				
"	"	SB	2	12	300	3600	400	400						
"	"	SB	1	6	50	300	33	33						
"	"	SB	2	4	4	16	2		2					
"	"	SB	2	12	6	72	8			8				
"	"	SB	1	12	6	72	8			8				

CONTINUED ON THE NEXT SHEET

FILE NAME = c:\projects\136208\design_ee.dgn	USER NAME = wilgraendp	DESIGNED -	REVISED -	STATE OF ILLINOIS DEPARTMENT OF TRANSPORTATION	PATCHING SCHEDULE IL 83				F.A.P. RTE.	SECTION	COUNTY	TOTAL SHEETS	SHEET NO.
PLOT SCALE = 1/8" = 1' / IN.	DRAWN -	REVISED -	REVISED -		SCALE:	SHEET NO.	OF	SHEETS	STA.	TO STA.	DUPAGE	37	20
PLOT DATE = 3/14/2008	CHECKED -	REVISED -	REVISED -		CONTRACT NO. 60E37								
	DATE -	REVISED -	REVISED -		FED. ROAD DIST. NO. 1 ILLINOIS FED. AID PROJECT								

ROUTE: Thorndale Ave (I-290 to Park Ave)

CROSS STREETS		DIRECTION (EB/WB) (NB/SB)	LANE NO. (1, 2, 3)	PAVEMENT PATCH WIDTH	PAVEMENT PATCH LENGTH	REPAIR AREA (SQ FT)	REPAIR AREA (SQ YD)	CLASS D PATCH TYPE I	CLASS D PATCH TYPE II	CLASS D PATCH TYPE III	CLASS D PATCH TYPE IV	PAVT MARKING 4"	RAISED REFL PAVT MKS		
FROM	TO														
SB 290 Ramp	Park Ave.	EB	1	12	6	72	8		8						
		EB	3	12	6	72	8		8						
		EB	2	12	6	72	8		8						
		EB	2	12	6	72	8		8						
		EB	3	12	6	72	8		8						
		EB	1	12	6	72	8		8						
		EB	3	12	6	72	8		8						
		EB	2	12	15	180	20			20					
		EB	3	12	6	72	8		8						
		EB	1	12	15	180	20			20					
		EB	1	12	6	72	8		8						
		EB	1	12	6	72	8		8						
		EB	3	12	6	72	8		8						
		EB	2	12	6	72	8		8						
		EB	1	12	6	72	8		8						
		SB 290 Ramp	Park Ave.	EB	3	12	6	72	8		8				
EB	3			12	6	72	8		8						
EB	3			12	25	300	33				33				
EB	2			12	25	300	33				33				
EB	1			12	25	300	33				33				
EB	2			12	25	300	33				33				
@ BRIDGE APPR.	EB			3	12	25	300	33				33			
EB	1			12	8	96	11		11						
EB	2			12	6	72	8		8						
EB	3			12	6	72	8		8						
NB 290 RAMP	EB				12	6	72	8		8					
EB	3			12	8	96	11		11						
EB	2			12	6	72	8		8						
EXIT RAMP FR.NB					12	8	96	11		11					
EXIT RAMP FR.NB					12	10	120	13		13					
PARK AVE.	SB 290 RAMP			WB	2	12	6	72	8		8				
		WB	3	12	6	72	8		8						
		WB	3	12	6	72	8		8						
		WB	2	12	6	72	8		8						
		WB	3	12	6	72	8		8						
		WB	1	12	12	144	16			16					
		WB	1	35	12	420	47				47				
		WB	2	35	12	420	47				47				
		WB	3	15	12	180	20			20					
		WB	1	12	6	72	8		8						
		WB	1	12	6	72	8		8						
		WB	2	12	8	96	11		11						
		WB	3	12	8	96	11		11						
		WB	1	12	6	72	8		8						
		WB	2	12	12	144	16			16					

TOTALS:

667

315

92

259

FILE NAME = c:\proj\act\ad136208\design\ee.dgn

USER NAME = wilgreendp
 PLOT SCALE = 1/8" = 100.0000' / IN.
 PLOT DATE = 3/14/2008

DESIGNED -	REVISED -
DRAWN -	REVISED -
CHECKED -	REVISED -
DATE -	REVISED -

STATE OF ILLINOIS
 DEPARTMENT OF TRANSPORTATION

PATCHING SCHEDULE
 THORNDALE AVE.
 SCALE: SHEET NO. OF SHEETS STA. TO STA.

F.A.P. RTE.	SECTION	COUNTY	TOTAL SHEETS	SHEET NO.
VAR.	2008-011 PP	DUPAGE	37	23
FED. ROAD DIST. NO. 1 (ILLINOIS) FED. AID PROJECT			CONTRACT NO. 60E37	

ROUTE: 22nd St (IL 83 to Butterfield Road)

CROSS STREETS		DIRECTION (EB/WB) (NB/SB)	LANE NO. (1, 2, 3)	PAVEMENT PATCH WIDTH	PAVEMENT PATCH LENGTH	REPAIR AREA (SQ FT)	REPAIR AREA (SQ YD)	SURFACE TYPE (PCC/ASPHALT)	MILL & RESURF	CLASS C PATCH TYPE I	CLASS C PATCH TYPE II	CLASS C PATCH TYPE III	CLASS C PATCH TYPE IV	PAVT MARKING 4"	PAVT MARKING 6"	RAISED REFL PAVT MKS
FROM	TO															
Parkview Dr	Midwest Rd	WB	1	12	1.5	18	2	PCC		2						
"	"	WB	1	12	3	36	4	PCC		4						
"	"	WB	1	12	3	36	4	PCC		4						
"	"	WB	1	12	3	36	4	PCC		4						
"	"	WB	1	3	4	12	1	PCC		1						
"	"	WB	1	12	3	36	4	PCC		4						
"	"	WB	1	2	3	6	1	PCC		1						
"	"	WB	1	3	3	9	1	PCC		1						
"	"	WB	1	5	4	20	2	PCC		2						
"	"	WB	1	2	3	6	1	PCC		1						
"	"	WB	1	3	3	9	1	PCC		1						
"	"	WB	1	2	2	4	1	PCC		1						
"	"	WB	1	2	2	4	1	PCC		1						
"	"	WB	1	4	4	16	2	PCC		2						
"	"	WB	1	3	3	9	1	PCC		1						
"	"	WB	1	12	3	36	4	PCC		4						
"	"	WB	LTL	12	3	36	4	PCC		4						
Parkview Dr	Midwest Rd	WB	1	2	2	4	1	PCC		1						
"	"	WB	1	2	3	6	1	PCC		1						
"	"	WB	1	2	3	6	1	PCC		1						
"	"	WB	LTL	12	4	48	5	PCC			5					
"	"	WB	LTL	1.5	15	23	3	PCC		3						
"	"	WB	1	12	3	36	4	PCC		4						
"	"	WB	1	3	3	9	1	PCC		1						
"	"	WB	1	3	3	9	1	PCC		1						
"	"	WB	1	2	2	4	1	PCC		1						
"	"	WB	1	2	2	4	1	PCC		1						
"	"	WB	1	2	2	4	1	PCC		1						
"	"	WB	1	2	2	4	1	PCC		1						
"	"	WB	1	12	4	48	5	PCC			5					
"	"	WB	1	2	2	4	1	PCC		1						
"	"	WB	1	1	2	2	1	PCC		1						
"	"	WB	1	2	2	4	1	PCC		1						
"	"	WB	1	2	2	4	1	PCC		1						
"	"	WB	1	2	2	4	1	PCC		1						
"	"	WB	1	2	1	2	1	PCC		1						
Parkview Dr	Midwest Rd	WB	1	4	4	16	2	PCC		2						
"	"	WB	1	4	2	8	1	PCC		1						
"	"	WB	1	12	2	24	3	PCC		3						
"	"	WB	1	4	2	8	1	PCC		1						
"	"	WB	1	2	2	4	1	PCC		1						
"	"	WB	1	2	2	4	1	PCC		1						
"	"	WB	1	12	2	24	3	PCC		3						
"	"	WB	LTL	3	3	9	1	PCC		1						
"	"	WB	LTL	4	4	16	2	PCC		2						
"	"	WB	LTL	3	5	15	2	PCC		2						
"	"	WB	1	12	2	24	3	PCC		3						
"	"	WB	LTL	6	2	12	1	PCC		1						
"	"	WB	LTL	7	1.5	11	1	PCC		1						
"	"	WB	1	2	3	6	1	PCC		1						
"	"	WB	1	2	2	4	1	PCC		1						
"	"	WB	LTL	2	8	16	2	PCC		2						
"	"	WB	1	2	2	4	1	PCC		1						
"	"	WB	LTL	3	3	9	1	PCC		1						

CONTINUED ON THE NEXT SHEET

FILE NAME =	USER NAME = mlgrandp	DESIGNED -	REVISED -	STATE OF ILLINOIS DEPARTMENT OF TRANSPORTATION	PATCHING SCHEDULE 22ND ST.	F.A.P. RTE.	SECTION	COUNTY	TOTAL SHEETS	SHEET NO.	
at\projects\dl36288\design.es.dgn		DRAWN -	REVISED -			VAR.	2008-011 PP	DUPAGE	37	24	
PLOT SCALE = 1/83.7851" / IN.		CHECKED -	REVISED -			CONTRACT NO. 60E37					
PLOT DATE = 3/14/2008		DATE -	REVISED -			SCALE:	SHEET NO. OF SHEETS	STA. TO STA.	FED. ROAD DIST. NO. 1 [ILLINOIS] FED. AID PROJECT		

ROUTE: 22nd St (IL 83 to Butterfield Road)

CROSS STREETS		DIRECTION (EB/WB) (NB/SB)	LANE NO. (1, 2, 3)	PAVEMENT PATCH WIDTH	PAVEMENT PATCH LENGTH	REPAIR AREA (SQ FT)	REPAIR AREA (SQ YD)	SURFACE TYPE (PCC/ASPHALT)	MILL & RESURF	CLASS C PATCH TYPE I	CLASS C PATCH TYPE II	CLASS C PATCH TYPE III	CLASS C PATCH TYPE IV	PAVT MARKING 4"	PAVT MARKING 6"	RAISED REFL PAVT MKS
FROM	TO															
Midwest Rd	Butterfield Rd	WB	1	3	6	18	2	PCC		2						
"	"	WB	LTL	12	2	24	3	PCC		3						
"	"	WB	LTL	12	1	12	1	PCC		1						
"	"	WB	LTL	12	1	12	1	PCC		1						
"	"	WB	LTL	12	2	24	3	PCC		3						
Butterfield Rd	Midwest Rd	EB	1	12	4	48	5	PCC			5					
"	"	EB	1	12	2	24	3	PCC		3						
"	"	EB	1	4	2	8	1	PCC		1						
"	"	EB	1	4	2	8	1	PCC		1						
"	"	EB	1	2	2	4	1	PCC		1						
"	"	EB	1	12	2	24	3	PCC		3						
"	"	EB	1	3	3	9	1	PCC		1						
"	"	EB	1	12	2	24	3	PCC		3						
"	"	EB	1	12	2	24	3	PCC		3						
"	"	EB	1	3	3	9	1	PCC		1						
"	"	EB	1	3	3	9	1	PCC		1						
"	"	EB	1	2	2	4	1	PCC		1						
"	"	EB	1	3	2	6	1	PCC		1						
Butterfield Rd	Midwest Rd	EB	1	4	2	8	1	PCC		1						
"	"	EB	1	2	2	4	1	PCC		1						
"	"	EB	1	2	2	4	1	PCC		1						
"	"	EB	LTL	12	7	84	9	PCC			9					
"	"	EB	1	12	2	24	3	PCC		3						
"	"	EB	1	12	2	24	3	PCC		3						
"	"	EB	MED	15	3	45	5	PCC			5					
"	"	EB	1	12	2	24	3	PCC		3						
"	"	EB	1	12	3	36	4	PCC		4						
"	"	EB	1	3	2	6	1	PCC		1						
"	"	EB	1	2	2	4	1	PCC		1						
"	"	EB	1	2	2	4	1	PCC		1						
"	"	EB	1	2	2	4	1	PCC		1						
"	"	EB	1	2	2	4	1	PCC		1						
"	"	EB	1	2	2	4	1	PCC		1						
"	"	EB	1	12	6	72	8	PCC			8					
"	"	EB	LTL	2	2	4	1	PCC		1						
Butterfield Rd	Midwest Rd	EB	1	12	3	36	4	PCC		4						
"	"	EB	1	3	2	6	1	PCC		1						
"	"	EB	1	3	3	9	1	PCC		1						
"	"	EB	1	2	3	6	1	PCC		1						
"	"	EB	1	2	3	6	1	PCC		1						
"	"	EB	1	3	3	9	1	PCC		1						
"	"	EB	1	2	4	8	1	PCC		1						
"	"	EB	LTL	10	2	20	2	PCC		2						
"	"	EB	1	12	2	24	3	PCC		3						
Midwest Rd	Parkview Dr	EB	1	6	2	12	1	PCC		1						
"	"	EB	LTL	6	2	12	1	PCC		1						
"	"	EB	1	2	5	10	1	PCC		1						
"	"	EB	1	10	2	20	2	PCC		2						
"	"	EB	LTL	2	10	20	2	PCC		2						
"	"	EB	1	3	3	9	1	PCC		1						
"	"	EB	LTL	10	2	20	2	PCC		2						
"	"	EB	LTL	10	2	20	2	PCC		2						
"	"	EB	LTL	10	2	20	2	PCC		2						
"	"	EB	LTL	10	3	30	3	PCC		3						

CONTINUED ON THE NEXT SHEET

FILE NAME = ca:\projects\135208\design_aa.dgn	USER NAME = wilgreendp	DESIGNED -	REVISED -	STATE OF ILLINOIS DEPARTMENT OF TRANSPORTATION	PATCHING SCHEDULE 22ND ST.				F.A.P. RTE.	SECTION	COUNTY	TOTAL SHEETS	SHEET NO.	
		DRAWN -	REVISED -		SCALE:	SHEET NO.	OF	SHEETS	STA.	TO STA.	2008-011 PP	DUPAGE	37	26
		CHECKED -	REVISED -		FED. ROAD DIST. NO. 1 ILLINOIS FED. AID PROJECT									
		DATE -	REVISED -		CONTRACT NO. 60E37									

ROUTE: 22nd St (IL 83 to Butterfield Road)

CROSS STREETS		DIRECTION (EB/WB) (NB/SB)	LANE NO. (1, 2, 3)	PAVEMENT PATCH WIDTH	PAVEMENT PATCH LENGTH	REPAIR AREA (SQ FT)	REPAIR AREA (SQ YD)	SURFACE TYPE (PCC/ASPHALT)	MILL & RESURF	CLASS C PATCH TYPE I	CLASS C PATCH TYPE II	CLASS C PATCH TYPE III	CLASS C PATCH TYPE IV	PAVT MARKING 4"	PAVT MARKING 6"	RAISED REFL PAVT MKS
FROM	TO															
Parkview Dr	Midwest Rd	WB	2	2	4	8	1	PCC		1						
"	"	WB	2	2	2	4	1	PCC		1						
"	"	WB	2	2	3	6	1	PCC		1						
"	"	WB	2	2	3	6	1	PCC		1						
"	"	WB	2	2	4	8	1	PCC		1						
"	"	WB	2	2	3	6	1	PCC		1						
"	"	WB	2	2	2	4	1	PCC		1						
"	"	WB	2	2	2	4	1	PCC		1						
"	"	WB	2	4	5	20	2	PCC		2						
"	"	WB	2	2	2	4	1	PCC		1						
"	"	WB	2	2	2	4	1	PCC		1						
"	"	WB	2	2	2	4	1	PCC		1						
"	"	WB	2	12	2	24	3	PCC		3						
"	"	WB	2	4	2	8	1	PCC		1						
"	"	WB	2	2	2	4	1	PCC		1						
"	"	WB	2	2	4	8	1	PCC		1						
"	"	WB	2	2	4	8	1	PCC		1						
"	"	WB	2	4	2	8	1	PCC		1						
Parkview Dr	Midwest Rd	WB	2	4	4	16	2	PCC		2						
"	"	WB	2	2	6	12	1	PCC		1						
"	"	WB	RTL	2	12	24	3	PCC		3						
Midwest Rd	Butterfield Rd	WB	2	be replaced @ Shell Gas Station and OTB				PCC								
"	"	WB	2	12	5	60	7	PCC			7					
"	"	WB	2	5	2	10	1	PCC		1						
"	"	WB	2	2	5	10	1	PCC		1						
"	"	WB	2	2	4	8	1	PCC		1						
"	"	WB	2	4	4	16	2	PCC		2						
"	"	WB	2	2	5	10	1	PCC		1						
"	"	WB	2	12	2	24	3	PCC		3						
"	"	WB	2	2	4	8	1	PCC		1						
"	"	WB	2	12	3	36	4	PCC		4						
"	"	WB	2	5	3	15	2	PCC		2						
"	"	WB	2	3	2	6	1	PCC		1						
"	"	WB	2	4	4	16	2	PCC		2						
"	"	WB	2	12	2	24	3	PCC		3						
"	"	WB	2	5	2	10	1	PCC		1						
Midwest Rd	Butterfield Rd	WB	2	3	3	9	1	PCC		1						
"	"	WB	2	2	2	4	1	PCC		1						
"	"	WB	2	2	4	8	1	PCC		1						
"	"	WB	2	2	3	6	1	PCC		1						
"	"	WB	2	5	2	10	1	PCC		1						
"	"	WB	2	5	2	10	1	PCC		1						
"	"	WB	2	5	4	20	2	PCC		2						
"	"	WB	2	2	4	8	1	PCC		1						
"	"	WB	2	12	4	48	5	PCC			5					
"	"	WB	2	12	2	24	3	PCC		3						
"	"	WB	2	12	4	48	5	PCC			5					
Butterfield Rd	Midwest Rd	EB	2	1	7	7	1	PCC		1						
"	"	EB	2	2	2	4	1	PCC		1						
"	"	EB	3	2	2	4	1	PCC		1						
"	"	EB	3	2	3	6	1	PCC		1						
"	"	EB	2	3	1	3	1	PCC		1						
"	"	EB	2	1	25	25	3	PCC		3						
"	"	EB	2	2	4	8	1	PCC		1						

CONTINUED ON THE NEXT SHEET

ROUTE: 22nd St (IL 83 to Butterfield Road)

CROSS STREETS		DIRECTION (EB/WB) (NB/SB)	LANE NO. (1, 2, 3)	PAVEMENT PATCH WIDTH	PAVEMENT PATCH LENGTH	REPAIR AREA (SQ FT)	REPAIR AREA (SQ YD)	SURFACE TYPE (PCC/ASPHALT)	MILL & RESURF	CLASS C PATCH TYPE I	CLASS C PATCH TYPE II	CLASS C PATCH TYPE III	CLASS C PATCH TYPE IV	PAVT MARKING 4"	PAVT MARKING 6"	RAISED REFL PAVT MKS	
FROM	TO																
Butterfield Rd	Midwest Rd	EB	2	2	4	8	1	PCC		1							
"	"	EB	2	6	3	18	2	PCC		2							
"	"	EB	2	4	2	8	1	PCC		1							
"	"	EB	2	5	2	10	1	PCC		1							
"	"	EB	2	2	4	8	1	PCC		1							
"	"	EB	2	2	3	6	1	PCC		1							
"	"	EB	2	12	2	24	3	PCC		3							
"	"	EB	2	12	4	48	5	PCC			5						
"	"	EB	2	2	3	6	1	PCC		1							
"	"	EB	2	2	3	6	1	PCC		1							
"	"	EB	2	4	3	12	1	PCC		1							
"	"	EB	2	3	2	6	1	PCC		1							
"	"	EB	2	12	4	48	5	PCC			5						
Midwest Rd	Parkview Dr	EB	2	12	4	48	5	PCC			5						
"	"	EB	2	12	4	48	5	PCC			5						
"	"	EB	2	4	4	16	2	PCC		2							
"	"	EB	2	4	3	12	1	PCC		1							
"	"	EB	3	2	7	14	2	PCC		2							
Midwest Rd	Parkview Dr	EB	3	12	2	24	3	PCC		3							
"	"	EB	3	3	4	12	1	PCC		1							
"	"	EB	3	2	2	4	1	PCC		1							
"	"	EB	2	12	2	24	3	PCC		3							
"	"	EB	2	4	2	8	1	PCC		1							
"	"	EB	2	4	2	8	1	PCC		1							
"	"	EB	2	2	2	4	1	PCC		1							
"	"	EB	2	2	4	8	1	PCC		1							
"	"	EB	2	2	4	8	1	PCC		1							
"	"	EB	2	12	2	24	3	PCC		3							
"	"	EB	2	2	2	4	1	PCC		1							
"	"	EB	2	2	3	6	1	PCC		1							
"	"	EB	2	2	3	6	1	PCC		1							
"	"	EB	2	12	2	24	3	PCC		3							
"	"	EB	2	2	2	4	1	PCC		1							
"	"	EB	2	2	4	8	1	PCC		1							
"	"	EB	2	2	4	8	1	PCC		1							
"	"	EB	2	12	2	24	3	PCC		3							
"	"	EB	2	2	4	8	1	PCC		1							
"	"	EB	3	2	4	8	1	PCC		1							
Midwest Rd	Parkview Dr	EB	2	2	4	8	1	PCC		1							
"	"	EB	3	12	3	36	4	PCC		4							
"	"	EB	3	12	2	24	3	PCC		3							
"	"	EB	3	12	2	24	3	PCC		3							
"	"	EB	3	10	2	20	2	PCC		2							
"	"	EB	3	10	2	20	2	PCC		2							
"	"	EB	3	10	2	20	2	PCC		2							
"	"	EB	3	10	2	20	2	PCC		2							
"	"	EB	2	2	2	4	1	PCC		1							
"	"	EB	2	2	2	4	1	PCC		1							
"	"	EB	2	12	2	24	3	PCC		3							
Parkview Dr	Midwest Rd	WB	2 & 3	1.5	200	300	33	PCC	33								
							588										
							SY										
								33									
								SY									
									477								
									SY								
										98							
										SY							

ROUTE: 22nd St (IL 83 to Butterfield Road)

CROSS STREETS		DIRECTION (EB/WB) (NB/SB)	LANE NO. (1, 2, 3)	PAVEMENT PATCH WIDTH	PAVEMENT PATCH LENGTH	REPAIR AREA (SQ FT)	REPAIR AREA (SQ YD)	SURFACE TYPE (PCC/ASPHALT)	MILL & RESURF	CLASS C PATCH TYPE I	CLASS C PATCH TYPE II	CLASS C PATCH TYPE III	CLASS C PATCH TYPE IV	PAVT MARKING 4"	PAVT MARKING 6"	RAISED REFL PAVT MKS
FROM	TO															
Parkview Dr.	Midwest Rd.	WB	1&2	2	10	20	2	Asphalt		2						
"	"	WB	1&2	2	10	20	2	Asphalt		2						
"	"	WB	1&2	2	5	10	1	Asphalt		1						
"	"	WB	1&2	2	10	20	2	Asphalt		2						
"	"	WB	1&2	2	5	10	1	Asphalt		1						
"	"	WB	1&2	2	20	40	4	Asphalt		4						
"	"	WB	1&2	2	5	10	1	Asphalt		1						
"	"	WB	1&2	2	5	10	1	Asphalt		1						
"	"	WB	1&2	2	10	20	2	Asphalt		2						
"	"	WB	1&2	2	10	20	2	Asphalt		2						
"	"	WB	1&2	2	10	20	2	Asphalt		2						
"	"	WB	1&2	2	10	20	2	Asphalt		2						
"	"	WB	1&2	2	10	20	2	Asphalt		2						
"	"	WB	1&2	2	30	60	7	Asphalt			7					
"	"	WB	1&2	2	5	10	1	Asphalt		1						
Parkview Dr	Midwest Rd	WB	1&2	2	5	10	1	Asphalt		1						
"	"	WB	1&2	2	2	4	1	Asphalt		1						
"	"	WB	1&2	2	5	10	1	Asphalt		1						
"	"	WB	1&2	2	5	10	1	Asphalt		1						
"	"	WB	1&2	2	2	4	1	Asphalt		1						
"	"	WB	1&2	2	5	10	1	Asphalt		1						
"	"	WB	1&2	2	10	20	2	Asphalt		2						
"	"	WB	1&2	2	5	10	1	Asphalt		1						
"	"	WB	1&2	2	2	4	1	Asphalt		1						
"	"	WB	1&2	2	20	40	4	Asphalt		4						
"	"	WB	1&2	2	2	4	1	Asphalt		1						
"	"	WB	1&2	2	5	10	1	Asphalt		1						
"	"	WB	2 & RTL	1.5	300	450	50	PCC	50							
Midwest Rd	Butterfield Rd	WB	1&2	2	5	10	1	Asphalt		1						
"	"	WB	1&2	2	5	10	1	Asphalt		1						
"	"	WB	1&2	2	5	10	1	Asphalt		1						
"	"	WB	1&2	2	5	10	1	Asphalt		1						
"	"	WB	1&2	2	2	4	1	Asphalt		1						
Midwest Rd	Butterfield Rd	WB	1&2	2	2	4	1	Asphalt		1						
"	"	WB	1&2	2	5	10	1	Asphalt		1						
"	"	WB	1&2	2	5	10	1	Asphalt		1						
"	"	WB	1&2	2	10	20	2	Asphalt		2						
"	"	WB	1&2	2	10	20	2	Asphalt		2						
"	"	WB	1&2	2	10	20	2	Asphalt		2						
"	"	WB	1&2	2	10	20	2	Asphalt		2						
"	"	WB	1&2	2	30	60	7	Asphalt			7					
"	"	WB	1&2	2	10	20	2	Asphalt		2						
"	"	WB	1&2	2	2	4	1	Asphalt		1						
"	"	WB	1&2	2	10	20	2	Asphalt		2						
"	"	WB	1&2	2	5	10	1	Asphalt		1						
"	"	WB	1&2	2	10	20	2	Asphalt		2						
"	"	WB	1&2	2	10	20	2	Asphalt		2						
"	"	WB	1&2	2	5	10	1	Asphalt		1						
"	"	WB	1&2	2	10	20	2	Asphalt		2						
"	"	WB	1&2	2	20	40	4	Asphalt		4						

CONTINUED ON THE NEXT SHEET

FILE NAME =	USER NAME = w1greendp	DESIGNED -	REVISED -	STATE OF ILLINOIS DEPARTMENT OF TRANSPORTATION	PATCHING SCHEDULE 22ND ST.				F.A.P. RTE.	SECTION	COUNTY	TOTAL SHEETS	SHEET NO.
c:\projects\135208\design_no.dgn		DRAWN -	REVISED -		SCALE:	SHEET NO.	OF	SHEETS	STA.	TO STA.	ILLINOIS	37	30
		CHECKED -	REVISED -								DUPAGE		
		DATE -	REVISED -								CONTRACT NO. 60E37		
											FED. ROAD DIST. NO. 1 ILLINOIS FED. AID PROJECT		

ROUTE: 22nd St (IL 83 to Butterfield Road)

CROSS STREETS		DIRECTION (EB/WB) (NB/SB)	LANE NO. (1, 2, 3)	PAVEMENT PATCH WIDTH	PAVEMENT PATCH LENGTH	REPAIR AREA (SQ FT)	REPAIR AREA (SQ YD)	SURFACE TYPE (PCC/ASPHALT)	MILL & RESURF	CLASS C PATCH TYPE I	CLASS C PATCH TYPE II	CLASS C PATCH TYPE III	CLASS C PATCH TYPE IV	PAVT MARKING 4"	PAVT MARKING 6"	RAISED REFL PAVT MKS
FROM	TO															
Butterfield Rd	Midwest Rd	EB	1& 2	2	5	10	1	Asphalt		1						
"	"	EB	1& 2	2	5	10	1	Asphalt		1						
"	"	EB	1& 2	2	20	40	4	Asphalt		4						
"	"	EB	1& 2	2	5	10	1	Asphalt		1						
"	"	EB	1& 2	2	35	70	8	Asphalt			8					
Butterfield Rd	Midwest Rd	EB	1& 2	2	75	150	17	Asphalt	17							
"	"	EB	1& 2	2	15	30	3	Asphalt		3						
"	"	EB	1& 2	2	10	20	2	Asphalt		2						
"	"	EB	1& 2	2	10	20	2	Asphalt		2						
"	"	EB	1& 2	2	5	10	1	Asphalt		1						
"	"	EB	1& 2	2	10	20	2	Asphalt		2						
"	"	EB	1& 2	2	10	20	2	Asphalt		2						
"	"	EB	1& 2	2	100	200	22	Asphalt	22							
"	"	EB	1& 2	2	150	300	33	Asphalt	33							
"	"	EB	1& 2	2	30	60	7	Asphalt		7						
"	"	EB	1& 2	2	60	120	13	Asphalt		13						
"	"	EB	1& 2	2	10	20	2	Asphalt		2						
"	"	EB	1& 2	2	10	20	2	Asphalt		2						
"	"	EB	1& 2	2	5	10	1	Asphalt		1						
"	"	EB	1& 2	2	10	20	2	Asphalt		2						
"	"	EB	1& 2	2	10	20	2	Asphalt		2						
"	"	EB	1& LTL	1.5	400	600	67	PCC	67							
"	"	EB	1& LTL	1.5	250	375	42	PCC	42							
Midwest Rd	Parkview Dr	EB	1& 2	2	10	20	2	Asphalt		2						
"	"	EB	1& 2	2	20	40	4	Asphalt		4						
"	"	EB	1& 2	2	20	40	4	Asphalt		4						
"	"	EB	1& 2	2	10	20	2	Asphalt		2						
"	"	EB	1& 2	2	10	20	2	Asphalt		2						
"	"	EB	1& 2	2	20	40	4	Asphalt		4						
"	"	EB	1& 2	2	20	40	4	Asphalt		4						
"	"	EB	1& 2	2	20	40	4	Asphalt		4						
"	"	EB	1& 2	2	20	40	4	Asphalt		4						
"	"	EB	1& 2	2	10	20	2	Asphalt		2						
"	"	EB	1& 2	2	10	20	2	Asphalt		2						
"	"	EB	1& 2	2	10	20	2	Asphalt		2						
"	"	EB	1& 2	2	10	20	2	Asphalt		2						
"	"	EB	1& 2	2	10	20	2	Asphalt		2						
"	"	EB	2& 3	1.5	4000	6000	667	PCC	667							
"	"	EB	2& 3	1.5	600	900	100	PCC	100							

1185 SY 998 SY 167 SY 22 SY 2640 FT 750 FT 300 EACH

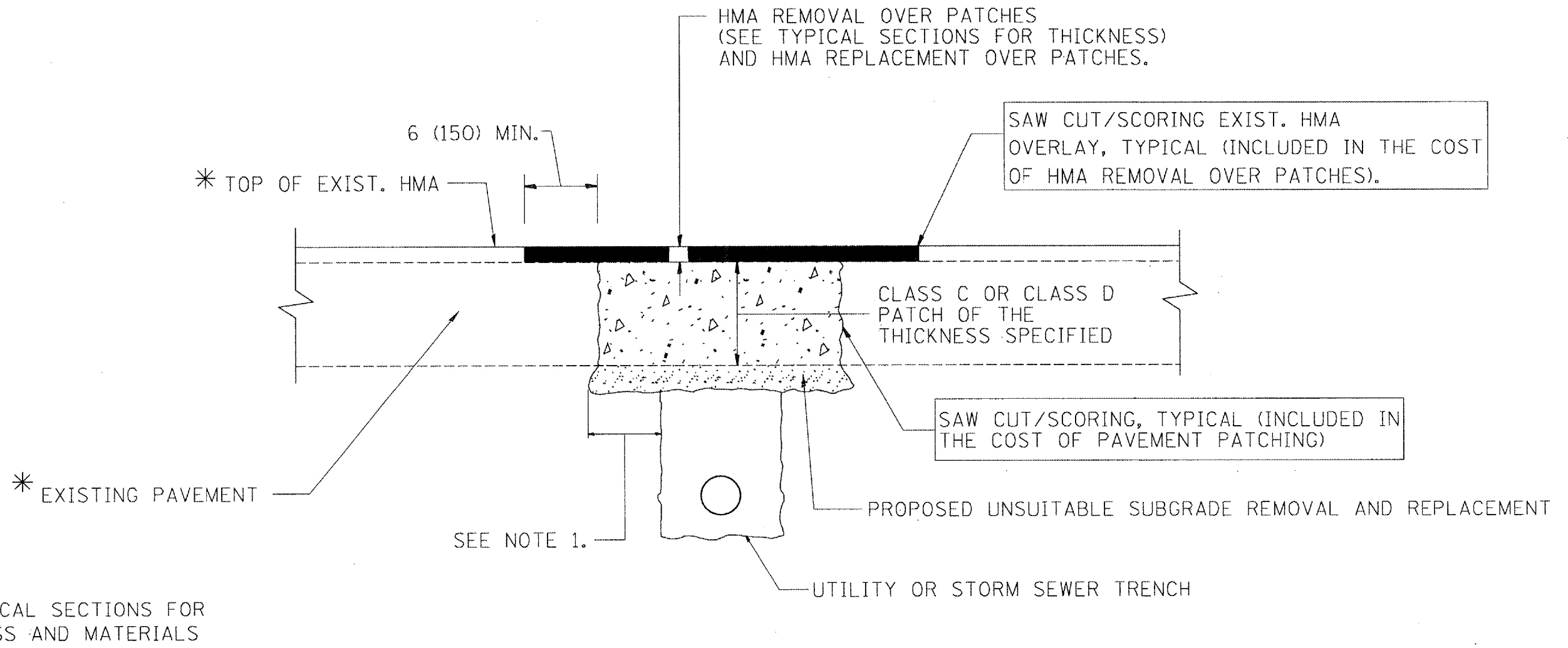

NOTES:

1. THE WIDTH OF THE FULL DEPTH PATCH OVER A TRENCH SHALL BE 12 (300) WIDER ON EACH SIDE OF THE TRENCH.
2. FOR METHOD OF MEASUREMENT AND BASIS OF PAYMENT, SEE RECURRING SPECIAL PROVISION "PATCHING WITH HOT-MIX ASPHALT OVERLAY REMOVAL".

SEQUENCE OF CONSTRUCTION

1. REMOVE THE EXISTING HMA MATERIAL OVER THE AREA TO BE PATCHED.
2. REMOVE AND REPLACE FULL DEPTH PATCHES
3. REPLACE HMA MATERIAL OVER THE AREA TO BE PATCHED.

ALL DIMENSIONS ARE IN INCHES (MILLIMETERS) UNLESS OTHERWISE SHOWN.

FILE NAME = M:\dist\td\22x34\bd22.dgn	USER NAME = smthk1	DESIGNED - R. SHAH	REVISED - A. ABBAS 01-20-98	STATE OF ILLINOIS DEPARTMENT OF TRANSPORTATION	PAVEMENT PATCHING FOR HMA SURFACED PAVEMENT		F.A. RTE.	SECTION	COUNTY	TOTAL SHEETS	SHEET NO.	
		DRAWN -	REVISED - A. ABBAS 04-27-98		SCALE: NONE	SHEET NO. 1 OF 1 SHEETS	STA.	TO STA.	VAR 2008-011PP	DUPAGE	37	32
		PLOT SCALE = 1/8" = 1'-0"	REVISED - R. BORO 01-01-07						BD400-04 (BD-22)	CONTRACT NO. 60E37		
		PLOT DATE = 3/14/2008	REVISED - R. BORO 09-04-07						FED. ROAD DIST. NO. 1 (ILLINOIS) FED. AID PROJECT			

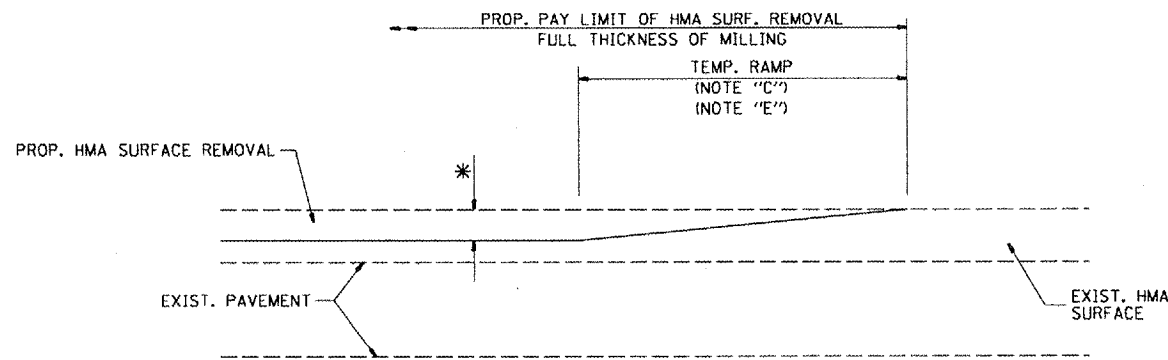

MILLED TEMPORARY RAMP
(FOR BUTT JOINT AND HMA TAPER SEE DETAIL BELOW)

OPTION 1

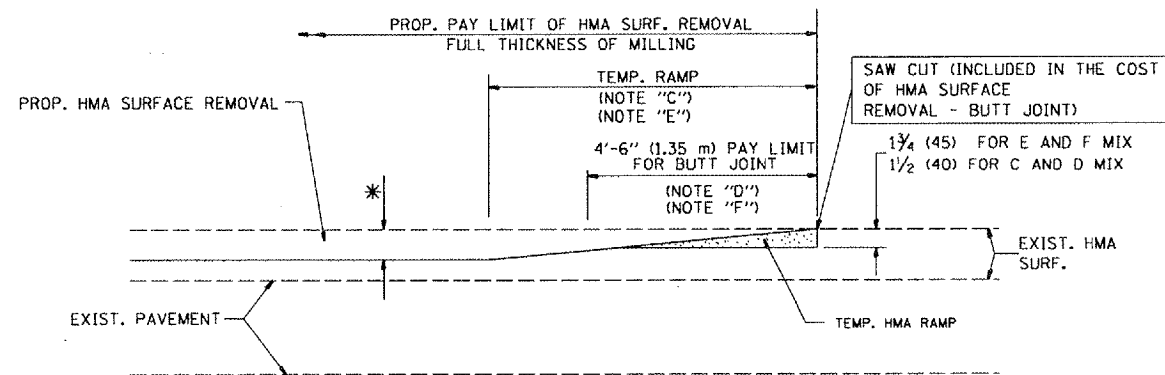

HMA CONSTRUCTED TEMPORARY RAMP
(FOR BUTT JOINT AND HMA TAPER SEE DETAIL BELOW)

OPTION 2

TYPICAL TEMPORARY RAMP

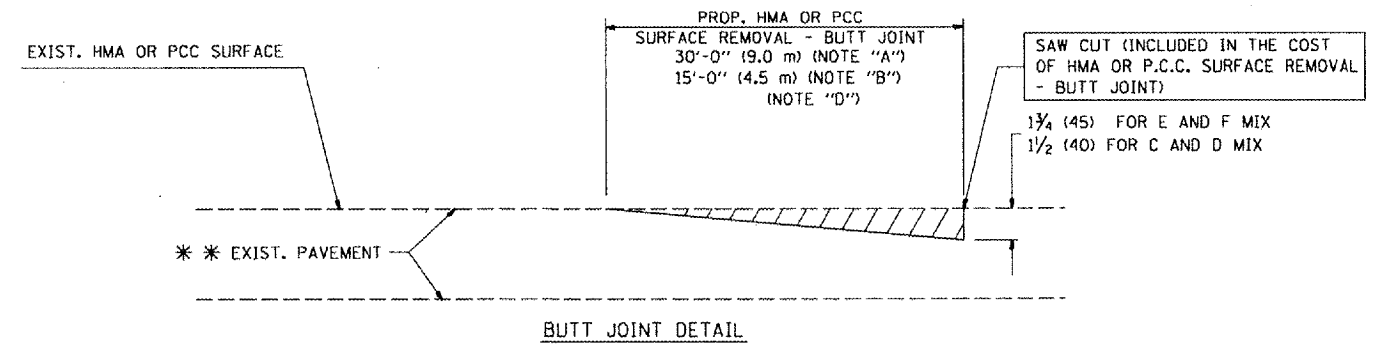

BUTT JOINT DETAIL

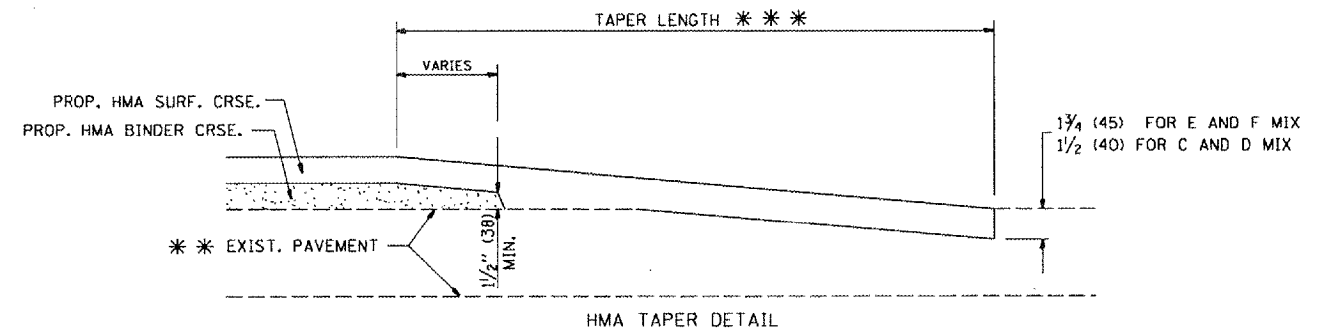

HMA TAPER DETAIL

TYPICAL BUTT JOINT AND HMA TAPER FOR RESURFACING ONLY

*** PC CONCRETE, HMA OR HMA RESURFACED PAVEMENT.

NOTES

- A: MAINLINE ROADWAYS AND MAJOR SIDE ROADS.
- B: MINOR SIDE ROADS.
- C: THE TEMP. RAMP SHALL BE CONSTRUCTED IMMEDIATELY UPON REMOVAL OF THE EXISTING HMA SURFACE.
- D: THE BUTT JOINT SHALL BE CONSTRUCTED IMMEDIATELY PRIOR TO PLACING THE PROPOSED HMA COURSES.
- E: TAPER THE TEMP. RAMP AT A RATE OF 3'-0" (900 mm) PER 1 INCH (25 mm) OF MILLING THICKNESS.
- F: INSTALLATION AND REMOVAL OF THE 4'-6" (1.35 m) TEMP. RAMP IS INCLUDED IN COST OF HMA SURFACE REMOVAL - BUTT JOINT
- G: SEE ARTICLE 406.08 AND 406.14 OF THE STANDARD SPECIFICATIONS FOR "HMA AND/OR PCC SURFACE REMOVAL, BUTT JOINT".

* SEE TYPICAL SECTIONS FOR MILLING THICKNESS.

*** 20'-0" (6.1 m) PER 1 (25) RESURFACING (NOTE "A")
10'-0" (3.0 m) PER 1 (25) RESURFACING (NOTE "B")

BASIS OF PAYMENT:

THE BUTT JOINT WILL BE PAID FOR AT THE CONTRACT UNIT PRICE PER SQUARE YARD (SQUARE METER) FOR "HOT-MIX ASPHALT SURFACE REMOVAL - BUTT JOINT" OR FOR "PORTLAND CEMENT CONCRETE SURFACE REMOVAL - BUTT JOINT".

ALL DIMENSIONS ARE IN INCHES (MILLIMETERS) UNLESS OTHERWISE SHOWN.

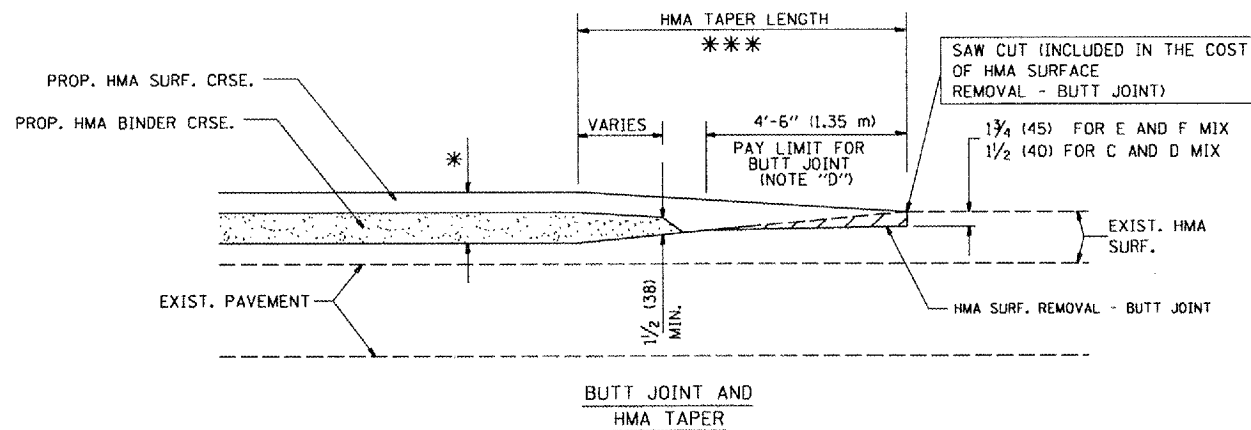

BUTT JOINT AND HMA TAPER

TYPICAL BUTT JOINT AND HMA TAPER FOR MILLING AND RESURFACING

FILE NAME = W:\dstatd\22x34\bd32.dgn	USER NAME = omu th-k	DESIGNED - M. DE YONG	REVISED - R. SHAH 10-25-94
		DRAWN -	REVISED - A. ABBAS 03-21-97
		CHECKED -	REVISED - M. GOMEZ 04-06-01
		DATE - 06-13-90	REVISED - R. BORO 01-01-07

STATE OF ILLINOIS
DEPARTMENT OF TRANSPORTATION

SCALE: NONE		SHEET NO. 1 OF 1 SHEETS		STA. TO STA.	
BUTT JOINT AND HMA TAPER DETAILS					

F.A. RTE.	SECTION	COUNTY	TOTAL SHEETS	SHEET NO.
VAR 2008-011PP	DUPAGE		37	33
BD400-05 BD32		CONTRACT NO. 60E37		
FED. ROAD DIST. NO. 1 ILLINOIS FED. AID PROJECT				

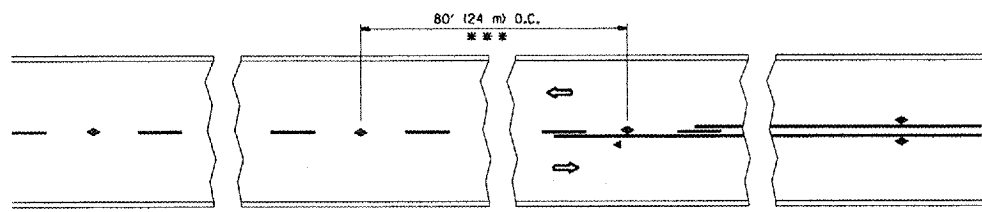

TWO-LANE/TWO-WAY

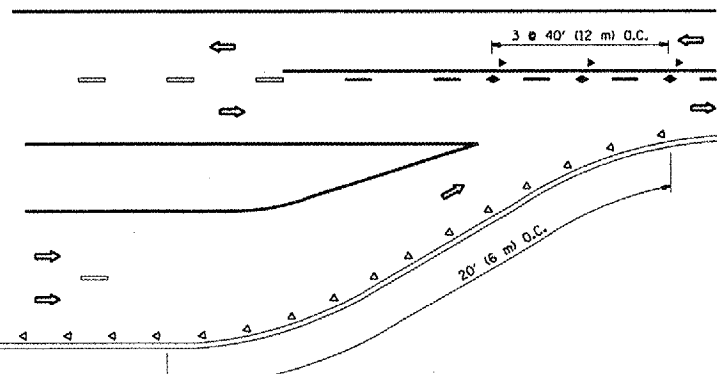

LANE REDUCTION TRANSITION

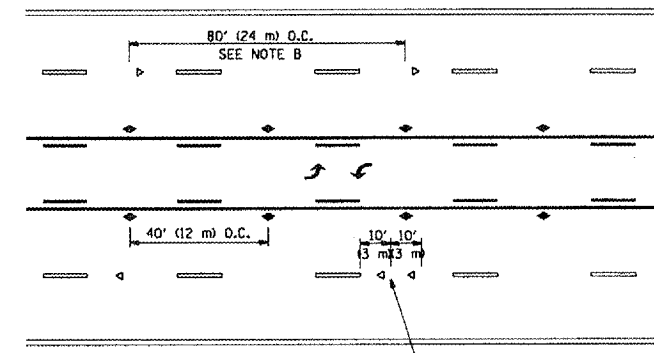

TWO-WAY LEFT TURN

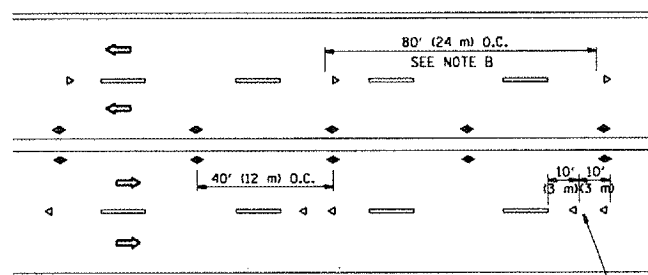

MULTI-LANE/UNDIVIDED

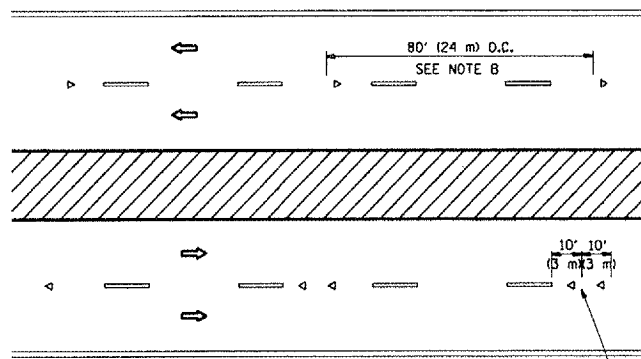

MULTI-LANE/DIVIDED

GENERAL NOTES

1. MARKERS USED WITH DASHED LINES SHALL BE CENTERED IN THE GAP BETWEEN SEGMENTS.
2. MARKERS USED ADJACENT TO SOLID LINES SHALL BE OFFSET 2 TO 3 (50 TO 75) TOWARD TRAFFIC AS SHOWN.
3. MARKERS THROUGH TANGENTS LESS THAN 500' (150 m) IN LENGTH BETWEEN CURVES SHALL BE INSTALLED AT THE LESSER OF THE TWO CURVE SPACINGS.

SYMBOLS

- YELLOW STRIPE
- WHITE STRIPE
- ◀ ONE-WAY AMBER MARKER
- ◁ ONE-WAY CRYSTAL MARKER (W/O)
- ◆ TWO-WAY AMBER MARKER

LANE MARKER NOTES

- B. REDUCE TO 40' (12 m) O.C. ON CURVES WHERE ADVISORY SPEEDS ARE 10 M.P.H. (20 km/h) LOWER THAN POSTED SPEEDS.
- A. USE DOUBLE LANE LINE MARKERS SPACED AS SHOWN.

DESIGN NOTES

1. DOUBLE LANE LINE MARKERS SHALL BE USED UNLESS SPECIFIED OTHERWISE.
2. EXCEPT AS SHOWN ON THE LANE REDUCTION TRANSITION AND FREEWAY EXIT RAMP DETAIL, MARKERS ARE NOT TO BE SPECIFIED ON RIGHT EDGE LINES.
3. THE EXACT MARKER LIMITS, SPACING, AND COLOR SHOULD BE INCLUDED IN THE PLANS.
4. MARKERS SHOULD NOT BE USED ALONGSIDE CURBS EXCEPT FOR EXTREMELY SHORT SECTIONS OF CURBS WHERE NOT MORE THAN TWO MARKERS WOULD BE INVOLVED.

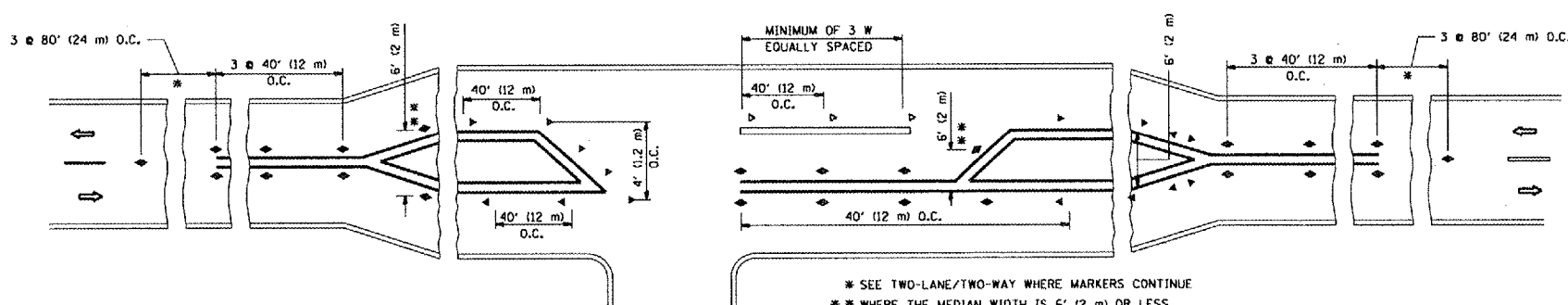

LEFT TURN

* SEE TWO-LANE/TWO-WAY WHERE MARKERS CONTINUE
 ** WHERE THE MEDIAN WIDTH IS 6' (2 m) OR LESS USE TWO-WAY MARKERS.

All dimensions are in inches (millimeters) unless otherwise shown.

FILE NAME = W:\dststd\22x34\toll.dgn	USER NAME = smthkl	DESIGNED -	REVISED - T. RAMMACHER 09-19-94	STATE OF ILLINOIS DEPARTMENT OF TRANSPORTATION	TYPICAL APPLICATIONS RAISED REFLECTIVE PAVEMENT MARKERS (SNOW-PLOW RESISTANT)			F.A. RTE. =	SECTION	COUNTY	TOTAL SHEETS	SHEET NO.	
		DRAWN -	REVISED - T. RAMMACHER 03-12-99		SCALE: NONE	SHEET NO. 1 OF 1 SHEETS	STA.	TO STA.	VAR 2008-011 PP	DUPAGE	37	34	
		CHECKED -	REVISED - T. RAMMACHER 01-06-00						TC-11				
		DATE -	REVISED -						FED. ROAD DIST. NO. 1	ILLINOIS	FED. AID PROJECT		

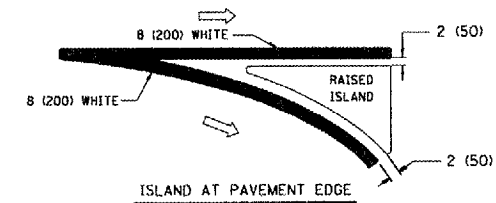
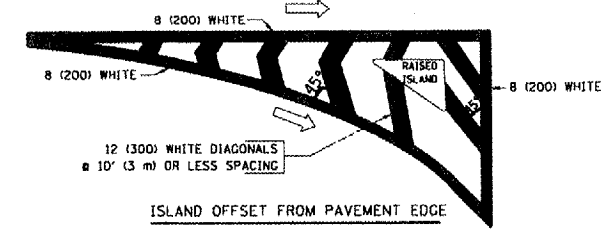
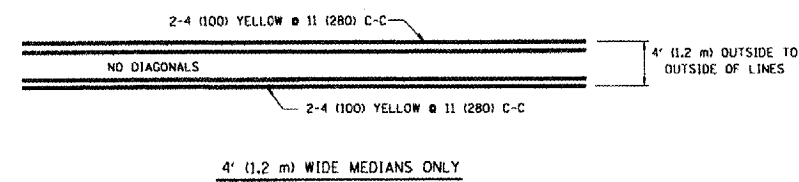
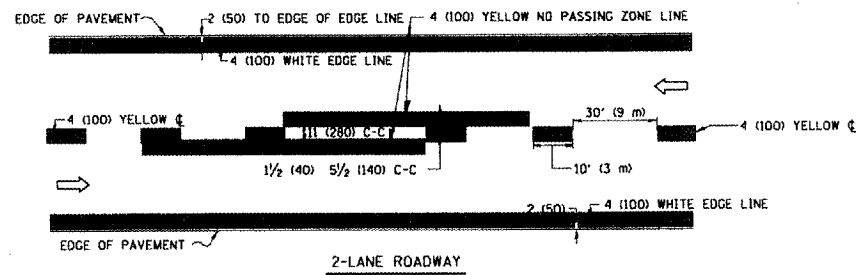

TYPICAL ISLAND MARKING

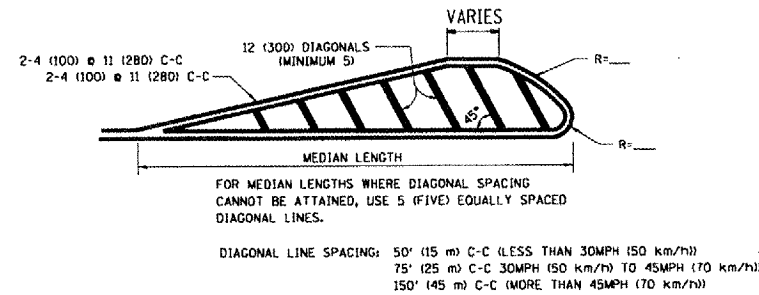

MEDIANS OVER 4' (1.2 m) WIDE

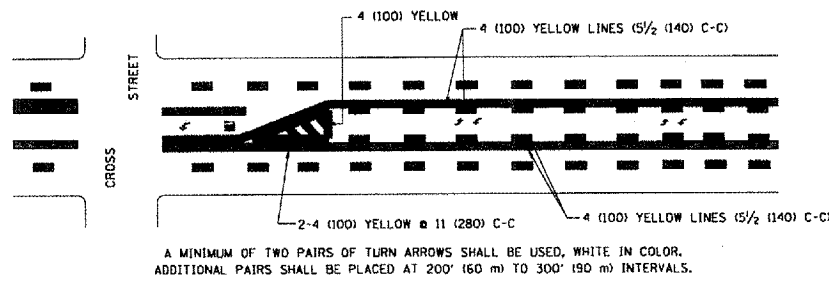

MEDIAN WITH TWO-WAY LEFT TURN LANE

TYPICAL PAINTED MEDIAN MARKING

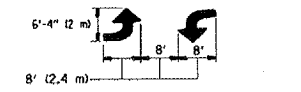

TYPICAL LEFT (OR RIGHT) TURN LANE

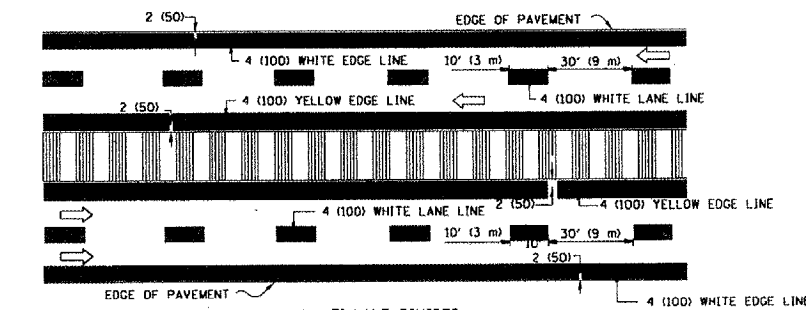
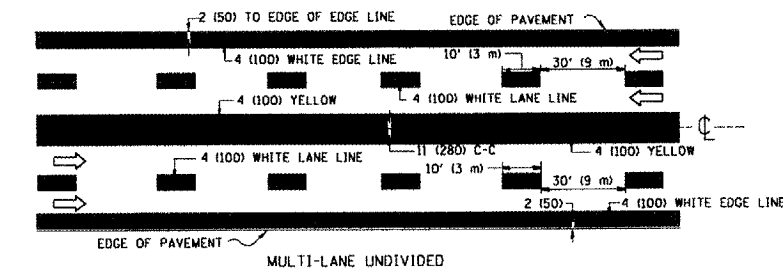

NOTE: MEDIANS WITH BARRIER CURB DO NOT REQUIRE AN EDGE LINE

TYPICAL LANE AND EDGE LINE MARKING

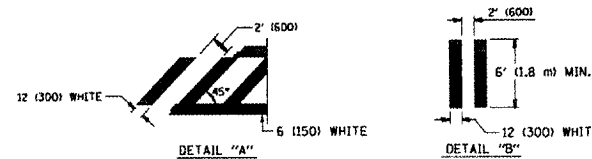
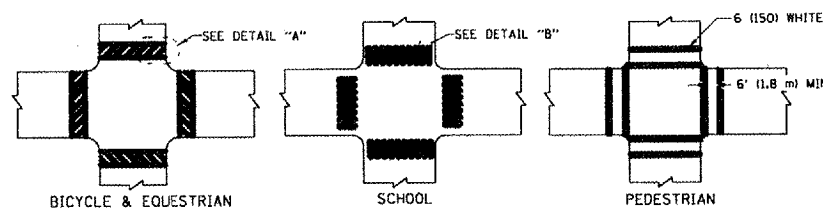

TYPICAL CROSSWALK MARKING

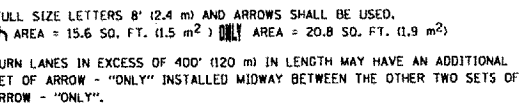

TYPICAL TURN LANE MARKING

TYPE OF MARKING	WIDTH OF LINE	PATTERN	COLOR	SPACING / REMARKS
CENTERLINE ON 2 LANE PAVEMENT	4 (100)	SKIP-DASH	YELLOW	10' (3 m) LINE WITH 30' (9 m) SPACE
CENTERLINE ON MULTI-LANE UNDIVIDED PAVEMENT	2 @ 4 (100)	SOLID	YELLOW	11 (280) C-C
NO PASSING ZONE LINES: FOR ONE DIRECTION FOR BOTH DIRECTIONS	4 (100) 2 @ 4 (100)	SOLID SOLID	YELLOW YELLOW	5/2 (140) C-C FROM SKIP-DASH CENTERLINE 11 (280) C-C OMIT SKIP-DASH CENTERLINE BETWEEN
LANE LINES	4 (100) 5 (125) ON FREEWAYS	SKIP-DASH SKIP-DASH	WHITE WHITE	10' (3 m) LINE WITH 30' (9 m) SPACE
DOTTED LINES (EXTENSIONS OF CENTER, LANE OR TURN LANE MARKINGS)	SAME AS LINE BEING EXTENDED	SKIP-DASH	SAME AS LINE BEING EXTENDED	2' (600) LINE WITH 6' (1.8 m) SPACE
EDGE LINES	4 (100)	SOLID	YELLOW-LEFT WHITE-RIGHT	OUTLINE MOUNTABLE MEDIANS IN YELLOW; EDGE LINES ARE NOT USED NEXT TO BARRIER CURB
TURN LANE MARKINGS	6 (150) LINE; FULL SIZE LETTERS & SYMBOLS (8' (2.4m))	SOLID	WHITE	SEE TYPICAL TURN LANE MARKING DETAIL
TWO WAY LEFT TURN MARKING	2 @ 4 (100) EACH DIRECTION 8' (2.4m) LEFT ARROW	SKIP-DASH AND SOLID IN PAIRS	YELLOW WHITE	10' (3 m) LINE WITH 30' (9 m) SPACE FOR SKIP-DASH; 5/2 (140) C-C BETWEEN SOLID LINE AND SKIP-DASH LINE SEE TYPICAL TWO-WAY LEFT TURN MARKING DETAIL
CROSSWALK LINES (PEDESTRIAN) A. DIAGONALS (BIKE & EQUESTRIAN) B. LONGITUDINAL BARS (SCHOOL)	2 @ 6 (150) 12 (300) @ 45° 12 (300) @ 90°	SOLID SOLID SOLID	WHITE WHITE WHITE	NOT LESS THAN 6' (1.8 m) APART 2' (600) APART 2' (600) APART SEE TYPICAL CROSSWALK MARKING DETAILS.
STOP LINES	24 (600)	SOLID	WHITE	PLACE 4' (1.2 m) IN ADVANCE OF AND PARALLEL TO CROSSWALK, IF PRESENT, OTHERWISE, PLACE AT DESIRED STOPPING POINT, PARALLEL TO CROSSROAD CENTERLINE, WHERE POSSIBLE
PAINTED MEDIANS	2 @ 4 (100) WITH 12 (300) DIAGONALS @ 45° NO DIAGONALS USED FOR 4' (1.2 m) WIDE MEDIANS	SOLID	YELLOW; TWO WAY TRAFFIC WHITE; ONE WAY TRAFFIC	11 (280) C-C FOR THE DOUBLE LINE SEE TYPICAL PAINTED MEDIAN MARKING.
CORE MARKING AND CHANNELIZING LINES	8 (200) WITH 12 (300) DIAGONALS @ 45°	SOLID	WHITE	DIAGONALS: 15' (4.5 m) C-C (LESS THAN 30MPH (50 km/h)) 20' (6 m) C-C 30MPH (50 km/h) TO 45MPH (70 km/h) 30' (9 m) C-C (OVER 45MPH (70 km/h))
RAILROAD CROSSING	24 (600) TRANSVERSE LINES, "RR" IS 6' (1.8 m) LETTERS: 16 (400) LINE FOR "X"	SOLID	WHITE	SEE STATE STANDARD 780001 AREA OF: "R"=3.6 SQ. FT. (0.33 m ²) EACH "X"=54.0 SQ. FT. (5.0 m ²)
SHOULDER DIAGONALS	12 (300) @ 45°	SOLID	WHITE - RIGHT YELLOW - LEFT	50' (15 m) C-C (LESS THAN 30MPH (50 km/h)) 75' (25 m) C-C (30 MPH (50 km/h) TO 45MPH (70 km/h)) 150' (45 m) C-C (OVER 45MPH (70 km/h))

FOR FURTHER DETAILS ON PAVEMENT MARKING REFER TO STANDARD SPECIFICATIONS FOR ROAD AND BRIDGE CONSTRUCTION AND STATE STANDARD 780001.



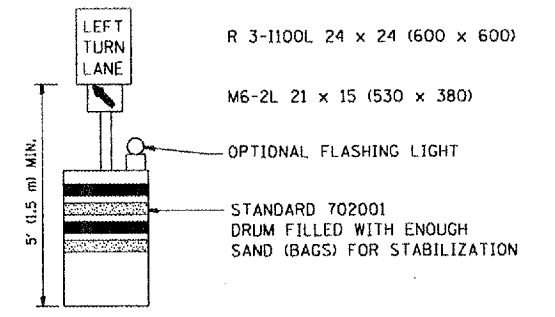
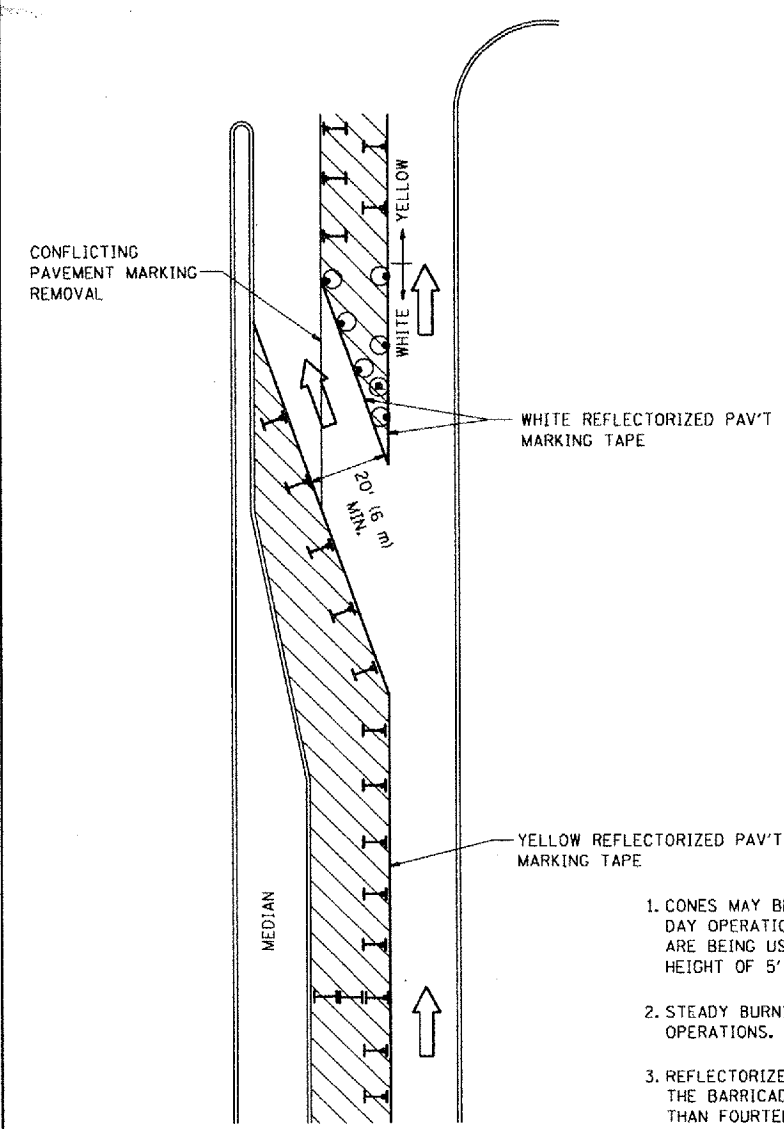

All dimensions are in inches (millimeters) unless otherwise shown.

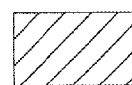
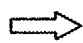

GENERAL NOTES

1. CONES MAY BE SUBSTITUTED FOR BARRICADES OR DRUMS AT HALF THE SPACING DURING DAY OPERATIONS. CONES SHALL BE A MINIMUM OF 28 (710) IN HEIGHT. WHEN CONES ARE BEING USED, THE "LEFT TURN LANE" SIGN MAY BE SKID MOUNTED AT A MINIMUM HEIGHT OF 5' (1.5 m).
2. STEADY BURNING LIGHTS WILL NOT BE REQUIRED ON BARRICADES OR DRUMS FOR DAY OPERATIONS. ALL LIGHTS SHALL BE MONODIRECTIONAL.
3. REFLECTORIZED TEMPORARY PAVEMENT MARKING TAPE SHALL BE PLACED THROUGHOUT THE BARRICADED AREA OF EACH TURN BAY WHERE THE CLOSURE TIME IS GREATER THAN FOURTEEN DAYS.
4. THIS APPLICATION ALSO APPLIES WHEN WORK IS BEING PERFORMED IN THE RIGHT LANE(S) AND THE RIGHT TURN BAY IS TO REMAIN OPEN. UNDER THIS CONDITION, "RIGHT TURN LANE" R3-100 24 x 24 (600 x 600) AND M6-2R 21 x 15 (530 x 380) SHALL BE USED.
5. THESE CONTROLS SHALL SUPPLEMENT MAINLINE TRAFFIC CONTROL FOR LANE CLOSURES.
6. LONGITUDINAL DIMENSIONS MAY BE ADJUSTED TO FIT FIELD CONDITIONS.
7. FORM BT 725 IS REQUIRED.
8. TRAFFIC CONTROL AND PROTECTION AT TURN BAYS (TO REMAIN OPEN TO TRAFFIC) SHALL BE INCLUDED IN THE COST SPECIFIED TRAFFIC CONTROL STANDARDS OR ITEMS.

LEGEND

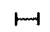
-  WORK AREA
-  LANE OPEN TO TRAFFIC
-  TYPE I OR II BARRICADE WITH STEADY BURN LIGHT
-  DRUM WITH STEADY BURN LIGHT
-  DRUM WITH SIGN (WITH OPTIONAL FLASHING LIGHT) SEE DETAIL
-  TYPE I OR II CHECK BARRICADE WITH FLASHING LIGHT

All dimensions are in inches (millimeters) unless otherwise shown.

FILE NAME =	USER NAME = smthk1	DESIGNED -	REVISED -T. RAMMACHER 09-08-94
W:\dstatd\22x34\to14.dgn		DRAWN -	REVISED - A. HOUSEH 11-07-95
		PLOT SCALE = 103.7049 / IN.	REVISED - A. HOUSEH 10-12-96
		PLOT DATE = 3/14/2008	REVISED -T. RAMMACHER 01-06-00

**STATE OF ILLINOIS
DEPARTMENT OF TRANSPORTATION**

TRAFFIC CONTROL AND PROTECTION AT TURN BAYS (TO REMAIN OPEN TO TRAFFIC)	
SCALE: NONE	SHEET NO. 1 OF 1 SHEETS
STA. _____	TO STA. _____

F.A. RTE.	SECTION	COUNTY	TOTAL SHEETS	SHEET NO.
VAR	2008-011PP	DUPAGE	37	36
TC-14			CONTRACT NO. 60E37	
FED. ROAD DIST. NO. 1 ILLINOIS FED. AID PROJECT				

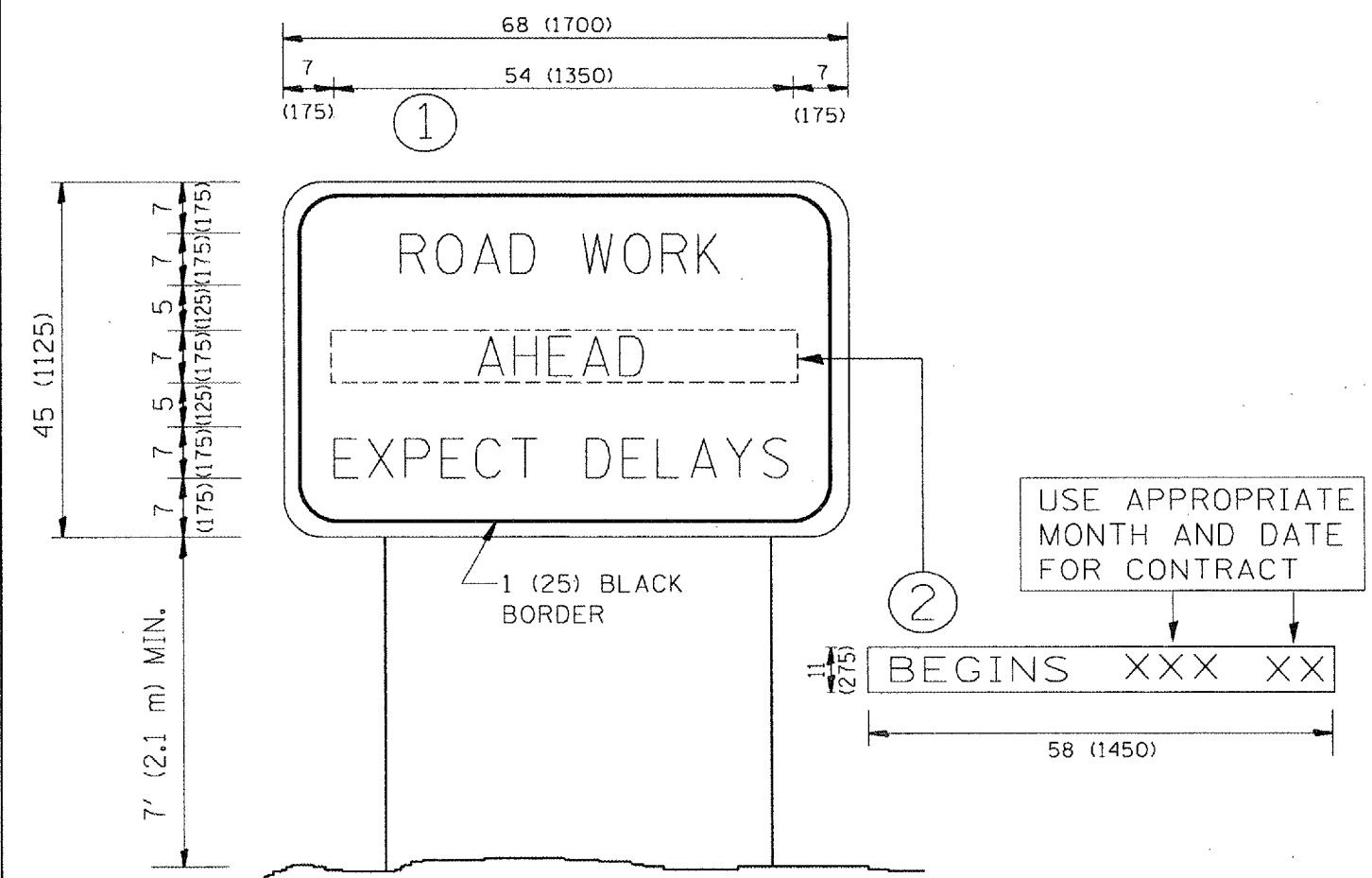

NOTES:

1. USE BLACK LETTERING ON ORANGE BACKGROUND.
2. ERECT SIGNS IN ADVANCE OF THE LOCATION FOR THE "ROAD CONSTRUCTION AHEAD" SIGN AT LOCATIONS AS DIRECTED BY THE ENGINEER.
3. ERECT SIGN ① WITH INSTALLED PANEL ② ONE WEEK PRIOR TO THE START OF CONSTRUCTION.
4. REMOVE PANEL ② SOON AFTER THE START OF CONSTRUCTION.
5. SEE SPECIAL PROVISION FOR "TEMPORARY INFORMATION SIGNING" FOR ADDITIONAL INFORMATION.
6. ONE SIGN ASSEMBLY EQUALS 25.70 SQ. FT. (2.3 SQ. M.)
7. SHALL BE PAID FOR AS TEMPORARY INFORMATION SIGNING.

ALL DIMENSIONS ARE IN INCHES (MILLIMETERS) UNLESS OTHERWISE SHOWN.

FILE NAME = W:\disto\22x34\to22.dgn	USER NAME = amichk1	DESIGNED -	REVISED - R. MIRS 09-15-97	STATE OF ILLINOIS DEPARTMENT OF TRANSPORTATION	ARTERIAL ROAD INFORMATION SIGN		F.A. RTE.	SECTION	COUNTY	TOTAL SHEETS	SHEET NO.	
		DRAWN -	REVISED - R. MIRS 12-11-97		SCALE: NONE	SHEET NO. 1 OF 1 SHEETS	STA.	TO STA.	VAR 2008-011 PP	DUPAGE	37	37
		PLOT SCALE = 103.785' / IN.	REVISED - T. RAMMACHER 02-02-99						TC-22	CONTRACT NO. 60E37		
		PLOT DATE = 3/14/2008	REVISED - C. JUCIUS 01-31-07						FED. ROAD DIST. NO. 1 [ILLINOIS] FED. AID PROJECT			

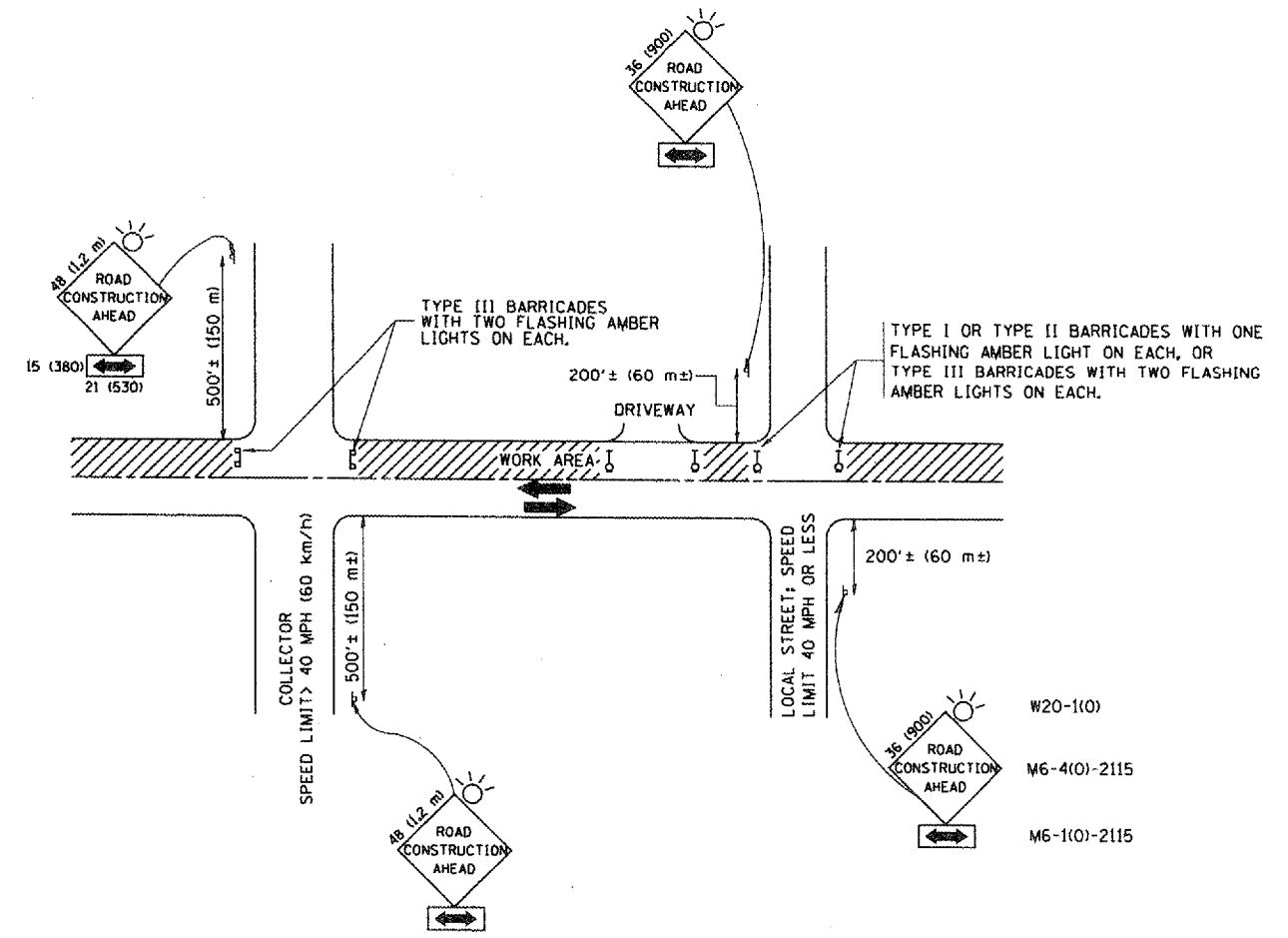

TRAFFIC CONTROL AND PROTECTION FOR SIDE ROADS, INTERSECTIONS, AND DRIVEWAYS

NOTES:

- A. FOR NO LANE RESTRICTION ON THE SIDE ROAD OR DRIVEWAYS
 - 1. SIDE ROAD WITH A SPEED LIMIT OF 40 MPH (60 km/h) OR LESS AS SHOWN ON THE DRAWING AND AS DIRECTED BY THE ENGINEER:
 - a) ONE ROAD CONSTRUCTION AHEAD SIGN 36 x 36 (900x900) WITH A FLASHER AND FLAG MOUNTED ON IT APPROXIMATELY 200' (60 m) IN ADVANCE OF THE MAIN ROUTE.
 - b) THE CLOSED PORTION OF THE MAIN ROUTE SHALL BE PROTECTED BY BLOCKING WITH TYPE I, TYPE II OR TYPE III BARRICADES, 1/3 OF THE CROSS SECTION OF THE CLOSED PORTION.
 - 2. SIDE ROAD WITH A SPEED LIMIT GREATER THAN 40 MPH (60 km/h) AS SHOWN ON THE DRAWING AND AS DIRECTED BY THE ENGINEER:
 - a) ONE ROAD CONSTRUCTION AHEAD SIGN 48 x 48 (1.2 m x 1.2 m) WITH A FLASHER MOUNTED ON IT APPROXIMATELY 500' (150 m) IN ADVANCE OF THE MAIN ROUTE.
 - b) THE CLOSED PORTION OF THE MAIN ROUTE SHALL BE PROTECTED BY BLOCKING WITH TYPE III BARRICADES, 1/2 OF THE CROSS SECTION OF THE CLOSED PORTION.
- 3. WHEN THE SIDE ROAD LIES BETWEEN THE BEGINNING OF THE MAINLINE SIGNING AND THE WORK ZONE, A SINGLE HEADED ARROW (M6-1) SHALL BE USED IN LIEU OF THE DOUBLE HEADED ARROW (M6-4).
- B. FOR A LANE CLOSURE ON A SIDE ROAD OR DRIVEWAY:
 - USE APPLICABLE PORTIONS OF THE TYPICAL APPLICATION OF TRAFFIC CONTROL DEVICES (STD. 701501, STD. 701606 OR THE APPROPRIATE STANDARD). THE SPACING OF SIGNS AND BARRICADES SHALL BE ADJUSTED FOR FIELD CONDITIONS AS DIRECTED BY THE ENGINEER. THE DIRECTIONAL ARROW SHALL BE COVERED OR REMOVED WHEN NO LONGER CONSISTENT WITH THE SIDE ROAD LANE CLOSURE.
- C. ADVANCE WARNING SIGNS ARE TO BE OMITTED ON DRIVEWAY UNLESS OTHERWISE NOTED.
- D. THE TRAFFIC CONTROL AND PROTECTION FOR SIDE ROADS, INTERSECTIONS, AND DRIVEWAYS SHALL BE INCIDENTAL TO THE COST OF SPECIFIED TRAFFIC CONTROL STANDARDS OR ITEMS.

All dimensions are in millimeters (inches) unless otherwise shown.

FILE NAME = V:\o\state\22x34\to18.dgn	USER NAME = gaglionobt	DESIGNED - LHA	REVISED - J. OBERLE 10-18-95
		DRAWN -	REVISED - A. HOUSEH 03-06-96
		CHECKED -	REVISED - A. HOUSEH 10-15-96
		DATE - 06-89 2/17/08	REVISED - T. RAMMACHER 01-06-00

STATE OF ILLINOIS
DEPARTMENT OF TRANSPORTATION

TRAFFIC CONTROL AND PROTECTION FOR SIDE ROADS, INTERSECTIONS, AND DRIVEWAYS		F.A. RTE.	SECTION	COUNTY	TOTAL SHEETS	SHEET NO.
SCALE: NONE		VAR	2008-011 PP	DUPAGE	37	37A
SHEET NO. 1 OF 1 SHEETS		TC-10		CONTRACT NO. 60E37		
STA. TO STA.		FED. ROAD DIST. NO. 1 ILLINOIS FED. AID PROJECT				