

STATE OF ILLINOIS  
DEPARTMENT OF TRANSPORTATION

Sheet No. 2  
of 11 Sheets

ROUTE NO.	SECTION	COUNTY	TOTAL SHEETS	SHEET NO.
FAS 1197	105BR-2	WHITESIDE	59	17
FED. ROAD DIST. NO.	ILLINOIS PROJECT			
		CONTRACT 64421		

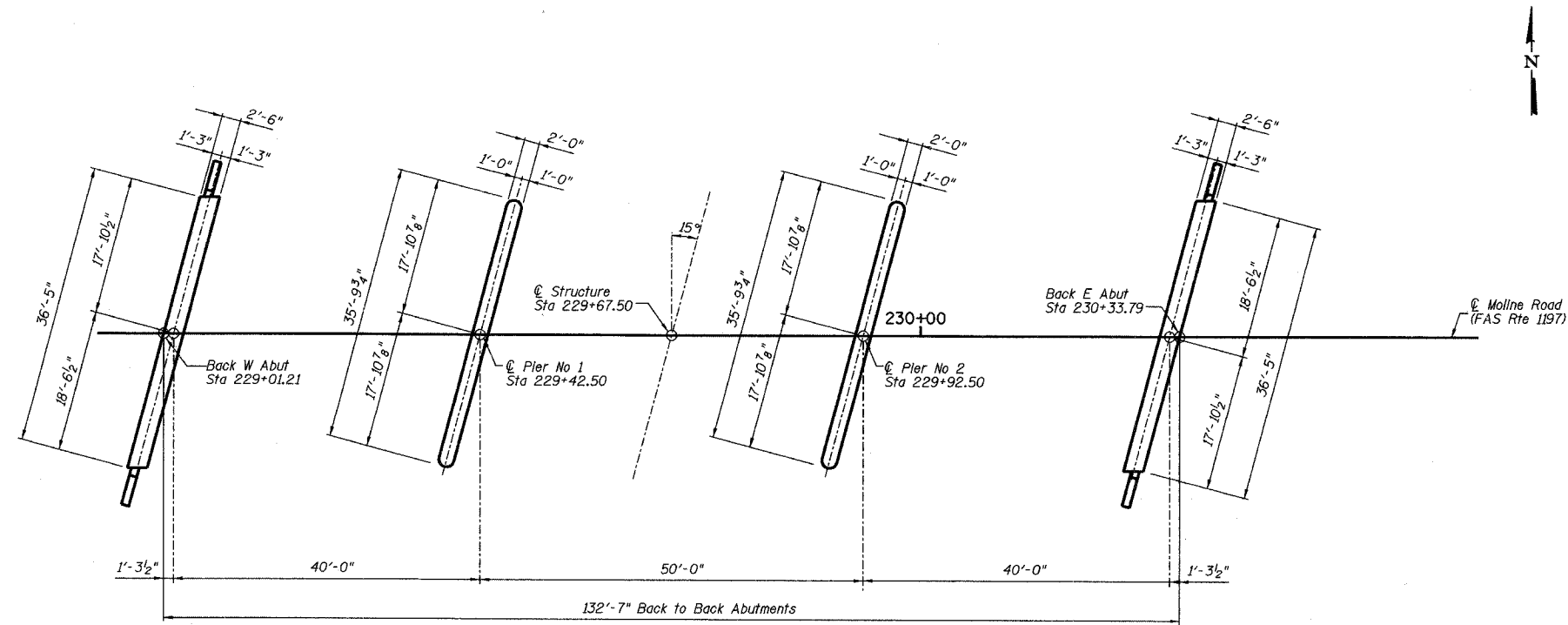

PLAN

GENERAL NOTES

- Reinforcement bars shall conform to the requirements of AASHTO M 31 or M 322 Grade 60.
- Layout of slope protection system may be varied in the field to suit ground conditions as directed by the Engineer.
- The Contractor shall make allowance for the deflection of forms, shrinkage and settlement of falsework. In addition to allowance for dead load deflection.
- The Contractor shall drive one test pile in a permanent location at the West Abut as directed by the Engineer before ordering the remainder of piles.
- Excavation behind the existing abutment walls shall be done before removing the existing superstructure.
- All Construction joints shall be bonded.

TOTAL BILL OF MATERIAL

ITEM	UNIT	SUPER	SUB	TOTAL
Porous Granular Embankment	Cu Yd		83	83
Stone Riprap Class A5	Sq Yd		1018	1018
Filter Fabric for use with Riprap	Sq Yd		1018	1018
Removal of Existing Structures No. 1	Each	1		1
Structure Excavation	Cu Yd		121	121
Floor Drains	Each	12		12
Concrete Structures	Cu Yd		88.2	88.2
Concrete Superstructure	Cu Yd	293.4		293.4
Bridge Deck Grooving	Sq Yd	439		439
Protective Coat	Sq Yd	578		578
Reinforcement Bars, Epoxy Coated	Pound	65,280	8,200	73,480
Furnishing Steel Piles HP12x63	LIn Ft		1381	1381
Driving Steel Piles	LIn Ft		1381	1381
Test Pile Steel HP12x63	Each		1	1
Name Plates	Each	1		1
Underwater Structure Excavation Protection - Location 1	Each		1	1
Underwater Structure Excavation Protection - Location 2	Each		1	1

FOUNDATION PLAN

REVISIONS	MOLINE ROAD OVER UNNAMED TRIBUTARY TO ROCK RIVER	DRAWN BY DATE
1		R King 8/04
2		CHECKED BY DATE
3		CMV 8/04
4		QA/QC BY DATE
5		CWC 8/04
6		BOOK NUMBER
7	FAS ROUTE 1197 SECTION 105BR-2	PROJECT No.
8	SN 098-0110	4858-3
9	STA 229+67.50 WHITESIDE COUNTY	SHEET No.
10	HOMER L. CHASTAIN & ASSOCIATES, LLP	
11	CONSULTING ENGINEERS	
12	184-001397	