

F.A.P. RTE.	SECTION	COUNTY	TOTAL SHEETS	SHEET NO.
595	1-3-K	ROCK ISLAND	476	63
STA.		TO STA.		
FED. ROAD DIST. NO.		ILLINOIS FED. AID PROJECT		

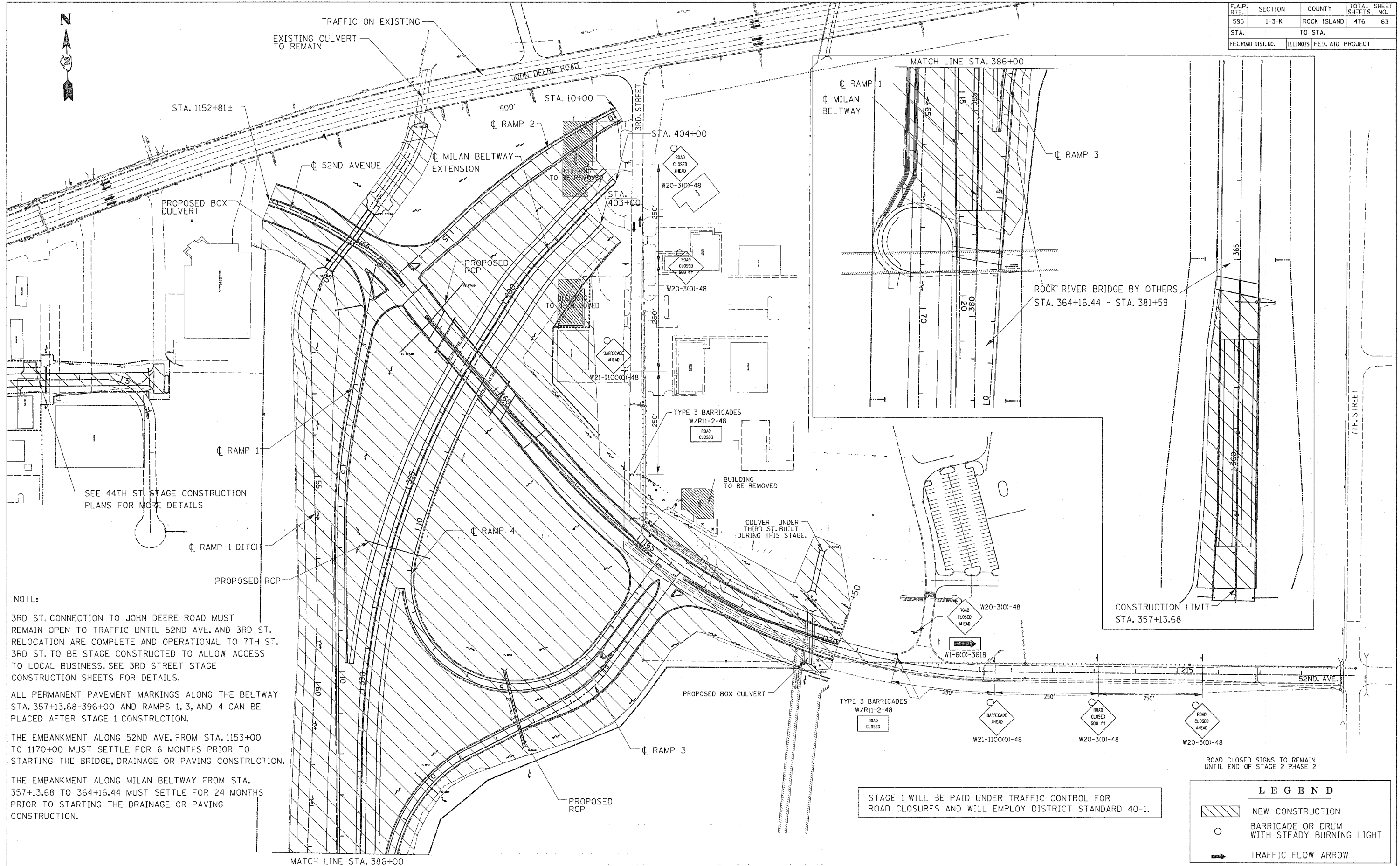

**NOTE:**  
 3RD ST. CONNECTION TO JOHN DEERE ROAD MUST REMAIN OPEN TO TRAFFIC UNTIL 52ND AVE. AND 3RD ST. RELOCATION ARE COMPLETE AND OPERATIONAL TO 7TH ST. 3RD ST. TO BE STAGE CONSTRUCTED TO ALLOW ACCESS TO LOCAL BUSINESS. SEE 3RD STREET STAGE CONSTRUCTION SHEETS FOR DETAILS.

ALL PERMANENT PAVEMENT MARKINGS ALONG THE BELTWAY STA. 357+13.68-396+00 AND RAMPS 1, 3, AND 4 CAN BE PLACED AFTER STAGE 1 CONSTRUCTION.

THE EMBANKMENT ALONG 52ND AVE. FROM STA. 1153+00 TO 1170+00 MUST SETTLE FOR 6 MONTHS PRIOR TO STARTING THE BRIDGE, DRAINAGE OR PAVING CONSTRUCTION.

THE EMBANKMENT ALONG MILAN BELTWAY FROM STA. 357+13.68 TO 364+16.44 MUST SETTLE FOR 24 MONTHS PRIOR TO STARTING THE DRAINAGE OR PAVING CONSTRUCTION.

STAGE 1 WILL BE PAID UNDER TRAFFIC CONTROL FOR ROAD CLOSURES AND WILL EMPLOY DISTRICT STANDARD 40-1.

**LEGEND**

	NEW CONSTRUCTION
	BARRICADE OR DRUM WITH STEADY BURNING LIGHT
	TRAFFIC FLOW ARROW

ROAD CLOSED SIGNS TO REMAIN UNTIL END OF STAGE 2 PHASE 2

**STAGE 1 BELTWAY EXT/52ND AVE. CONSTRUCTION PLAN**