

F.A.P. RTE.	SECTION	COUNTY	TOTAL SHEETS	SHEET NO.
595	1-3-K	ROCK ISLAND	476	123
STA. 19+20		TO STA. 21+43.30		
FED. ROAD DIST. NO.		ILLINOIS FED. AID PROJECT		

PLAN

SURVEYED	BY	DATE
ALIGNED		
CHECKED		
FT. OF WAY CHECKED		
NO. _____		

PROFILE

SURVEYED	BY	DATE
GRADES CHECKED		
NO. NOTED		
STRUCTURE HEIGHTS CHECKED		
NO. _____		

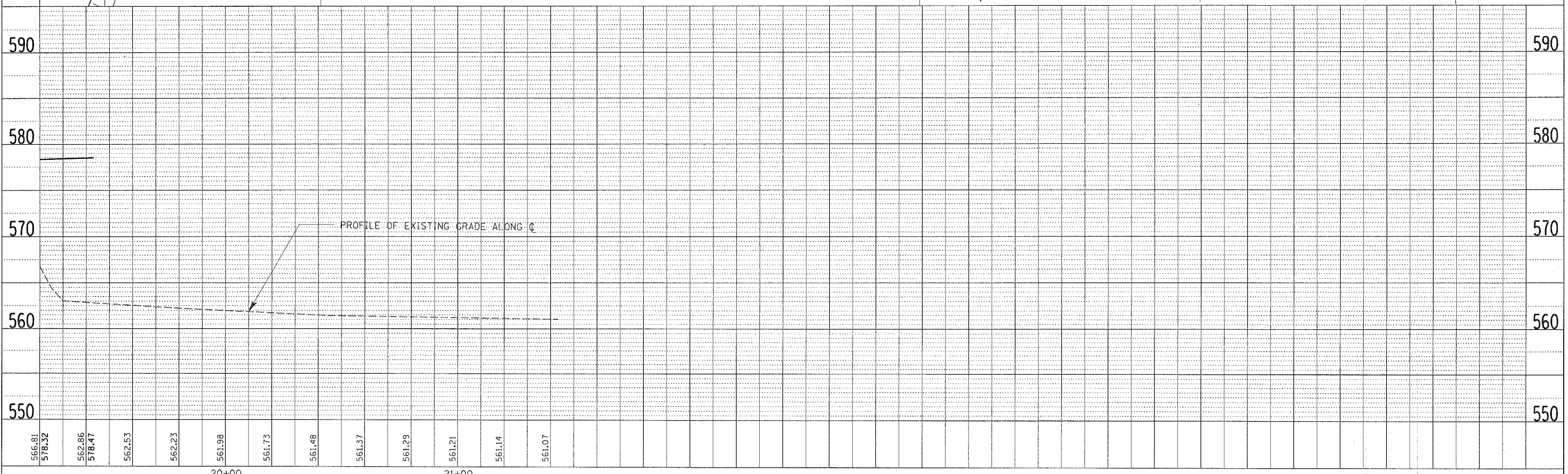
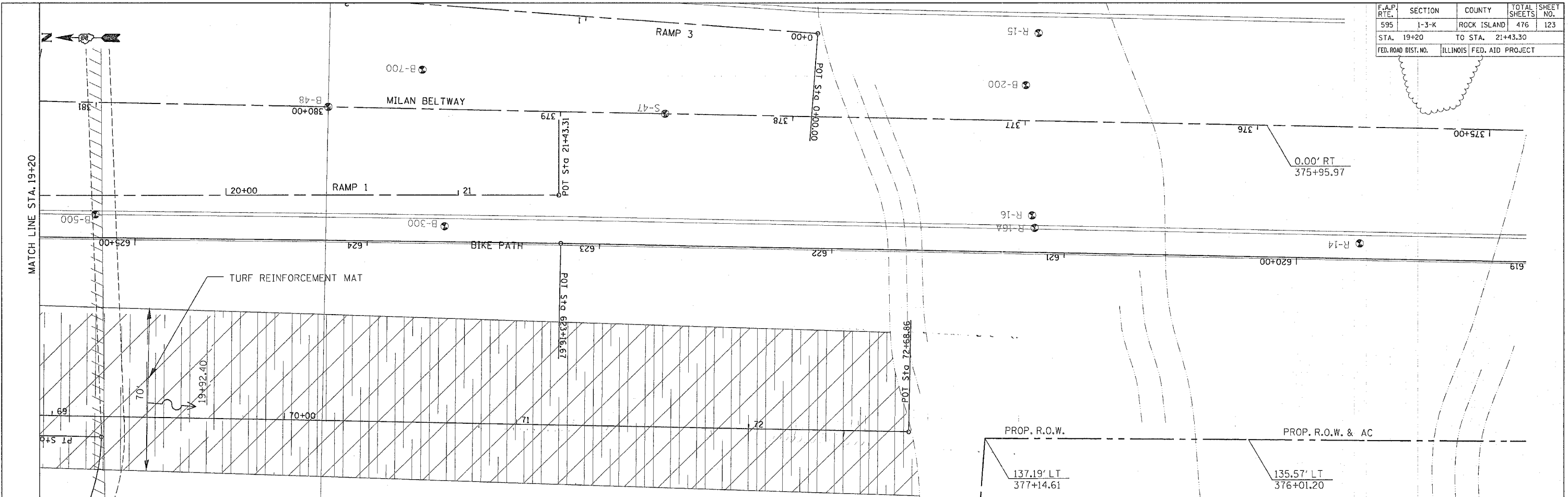

52ND AVENUE RAMP 1 - STA. 19+20 TO STA. 21+43.30