

F.A.P. RTE.	SECTION	COUNTY	TOTAL SHEETS	SHEET NO.
595	1-3-K	ROCK ISLAND	476	242
STA.		TO STA.		
FED. ROAD DIST. NO.		ILLINOIS	FED. AID PROJECT	

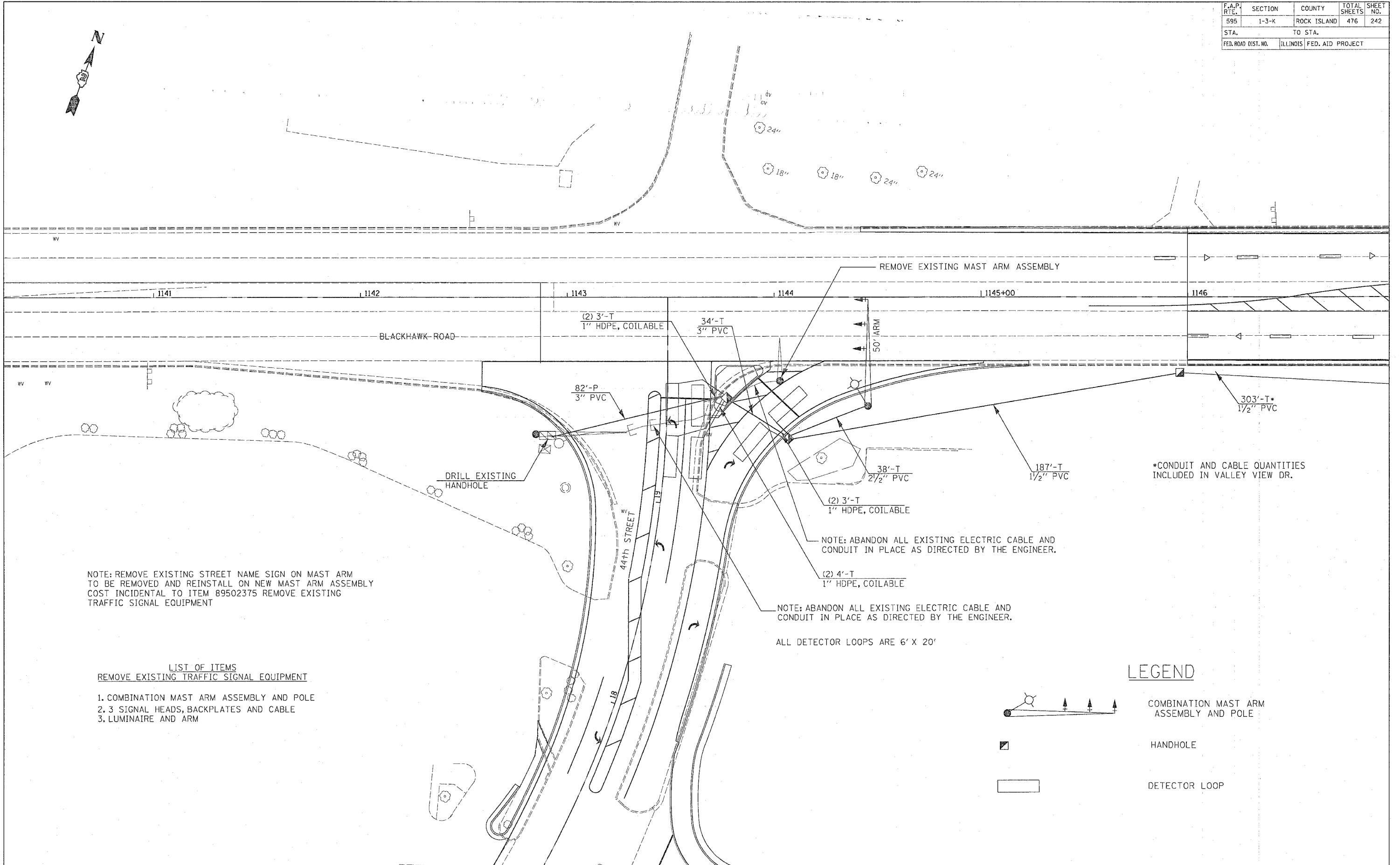

NOTE: REMOVE EXISTING STREET NAME SIGN ON MAST ARM TO BE REMOVED AND REINSTALL ON NEW MAST ARM ASSEMBLY COST INCIDENTAL TO ITEM 89502375 REMOVE EXISTING TRAFFIC SIGNAL EQUIPMENT

**LIST OF ITEMS**  
REMOVE EXISTING TRAFFIC SIGNAL EQUIPMENT

1. COMBINATION MAST ARM ASSEMBLY AND POLE
2. 3 SIGNAL HEADS, BACKPLATES AND CABLE
3. LUMINAIRE AND ARM



NOTE: ABANDON ALL EXISTING ELECTRIC CABLE AND CONDUIT IN PLACE AS DIRECTED BY THE ENGINEER.

NOTE: ABANDON ALL EXISTING ELECTRIC CABLE AND CONDUIT IN PLACE AS DIRECTED BY THE ENGINEER.

ALL DETECTOR LOOPS ARE 6' X 20'

\*CONDUIT AND CABLE QUANTITIES INCLUDED IN VALLEY VIEW DR.

**LEGEND**

-  COMBINATION MAST ARM ASSEMBLY AND POLE
-  HANDHOLE
-  DETECTOR LOOP