

STATE OF ILLINOIS
DEPARTMENT OF TRANSPORTATION
DIVISION OF HIGHWAYS

F.A.P. RTE.	SECTION	COUNTY	TOTAL SHEETS	SHEET NO.
327/42	113RS-6, 14-16Z-RS-1	CLINTON	32	1
		ILLINOIS	CONTRACT NO. 76J06	

**PROPOSED
HIGHWAY PLANS**

FAP ROUTE 327 /42(US 50 /IL 127)
SECTION 113RS-6, 14-16Z-RS-1
PROJECT ACSTP-0327 (061)
PATCHING & RESURFACING
CLINTON COUNTY

FOR INDEX OF SHEETS, SEE SHEET NO. 2

TRAFFIC DATA

IL 127	US 50
ADT: 10600 (2013)	ADT: 4850 (2013)
10700 (2015) EST.	4900 (2015) EST.
12400 (2035) EST.	5700 (2035) EST.
SU: 12.3%	SU: 3.2%
MU: 9.9%	MU: 9.8%

FUNCTIONAL CLASSIFICATION:

MINOR ARTERIAL (IL 127)
OTHER ARTERIAL (US 50)

C-98-056-15

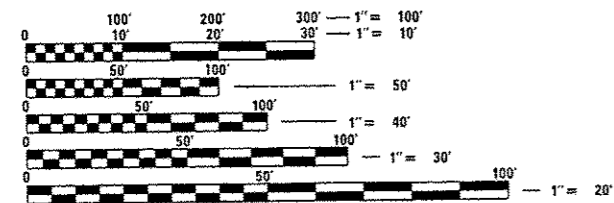
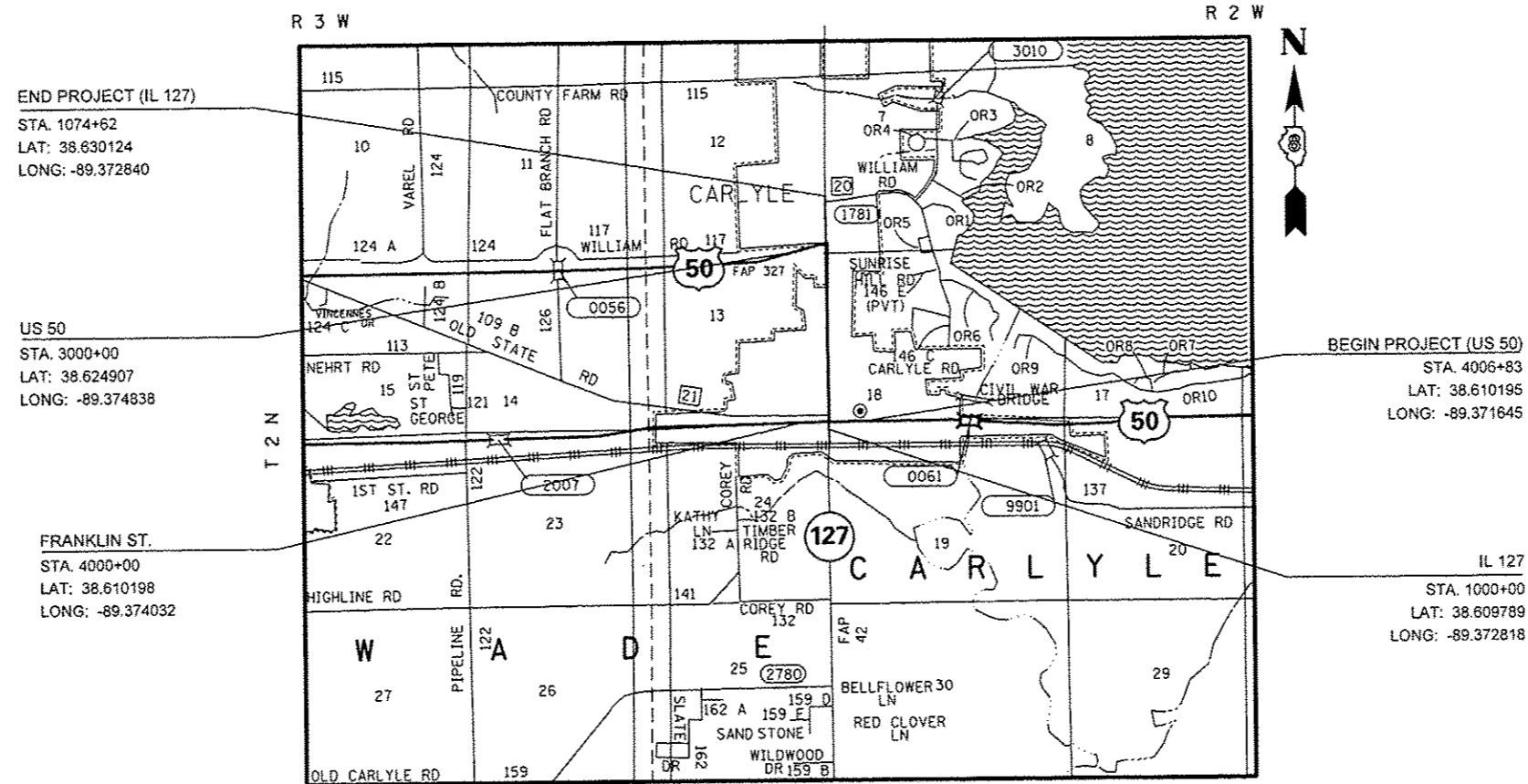
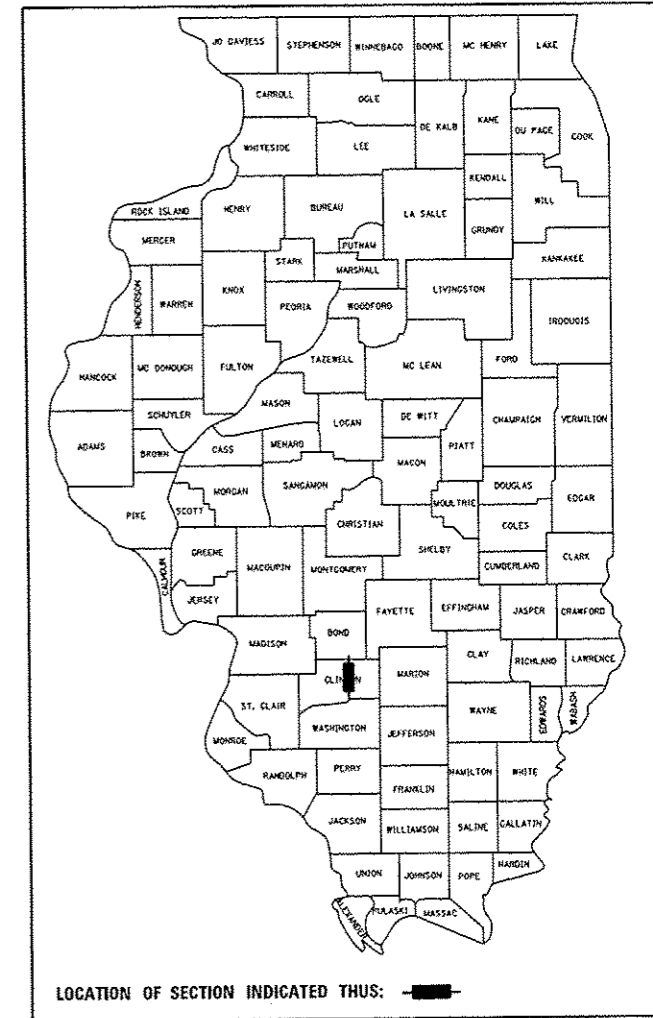

FULL SIZE PLANS HAVE BEEN PREPARED USING STANDARD ENGINEERING SCALES. REDUCED SIZED PLANS WILL NOT CONFORM TO STANDARD SCALES. IN MAKING MEASUREMENTS ON REDUCED PLANS, THE ABOVE SCALES MAY BE USED.

J.U.L.I.E.
JOINT UTILITY LOCATION INFORMATION FOR EXCAVATION
1-800-892-0123
OR 811

PROJECT ENGINEER: HERVE GELIN (618) 346-3179
DESIGNER: ALVIN NIEVES-ROSARIO (618) 346-3187

CONTRACT NO. 76J06

GROSS LENGTH = 8671.00 FT. = 1.642 MILES
NET LENGTH = 8671.00 FT. = 1.642 MILES

STATE OF ILLINOIS
DEPARTMENT OF TRANSPORTATION
DIVISION OF HIGHWAYS

SUBMITTED *Jan 25 2016*
Jeffrey E. K... DEPUTY DIRECTOR OF HIGHWAYS, REGION 5 ENGINEER
March 18 2016
Muhammad M. Adib, P.E. ENGINEER OF DESIGN AND ENVIRONMENT
March 18 2016
Omer Osman, P.E. DIRECTOR OF HIGHWAYS, CHIEF ENGINEER

PRINTED BY THE AUTHORITY
OF THE STATE OF ILLINOIS

INDEX OF SHEETS

- 1 COVER SHEET
- 2 INDEX OF SHEETS, HIGHWAY STANDARDS, GENERAL NOTES & COMMITMENTS
- 3-5 SUMMARY OF QUANTITIES
- 6-9 TYPICAL SECTIONS
- 10 LOCATION MAPS
- 11-13 SCHEDULES OF QUANTITIES
- 14-19 DETAILS
- 20-29 ADA DETAILS
- 30-32 DETECTOR LOOP REPLACEMENT PLANS

HIGHWAY STANDARDS

- 000001-06 STANDARD SYMBOLS, ABBREVIATIONS AND PATTERNS
- 001001-02 AREAS OF REINFORCEMENT BARS
- 001006 DECIMAL OF AN INCH AND OF A FOOT
- 420701-03 PAVEMENT WELDED WIRE REINFORCEMENT
- 424006-02 DIAGONAL CURB RAMPS FOR SIDEWALKS
- 424011-02 CORNER PARALLEL CURB RAMPS FOR SIDEWALKS
- 424016-02 MID-BLOCK CURB RAMPS FOR SIDEWALKS
- 424021-03 DEPRESSED CORNER FOR SIDEWALKS
- 442101-07 CLASS B PATCHES
- 602306-03 INLET - TYPE B
- 604006-05 FRAME AND GRATE TYPE 3
- 606001-06 CONCRETE CURB TYPE B AND COMBINATION CONCRETE CURB AND GUTTER
- 606301-04 PC CONCRETE ISLANDS AND MEDIANS
- 630001-10 STEEL PLATE BEAM GUARDRAIL
- 630301-06 SHOULDER WIDENING FOR TYPE 1 (SPECIAL) GUARDRAIL TERMINALS
- 701001-02 OFF-RD OPERATIONS, 2L, 2W, MORE THAN 15' (4.5 m) AWAY
- 701006-05 OFF-RD OPERATIONS, 2L, 2W, 15' (4.5 m) TO 24" (600 mm) FROM PAVEMENT EDGE
- 701011-04 OFF-RD MOVING OPERATIONS, 2L, 2W, DAY ONLY
- 701201-04 LANE CLOSURE, 2L, 2W, DAY ONLY, FOR SPEEDS > 45 MPH
- 701301-04 LANE CLOSURE, 2L, 2W, SHORT TIME OPERATIONS
- 701306-03 LANE CLOSURE, 2L, 2W, SLOW MOVING OPERATIONS DAY ONLY, FOR SPEEDS > 45 MPH
- 701311-03 LANE CLOSURE, 2L, 2W, MOVING OPERATIONS - DAY ONLY
- 701326-04 LANE CLOSURE, 2L, 2W, PAVEMENT WIDENING, FOR SPEEDS > 45 MPH
- 701501-06 URBAN LANE CLOSURE, 2L, 2W, UNDIVIDED
- 701502-06 URBAN LANE CLOSURE, 2L, 2W, WITH BIDIRECTIONAL LEFT TURN LANE
- 701701-10 URBAN LANE CLOSURE, MULTILANE INTERSECTION
- 701801-06 SIDEWALK, CORNER OR CROSSWALK CLOSURE
- 701901-05 TRAFFIC CONTROL DEVICES
- 720001-01 SIGN PANEL MOUNTING DETAILS
- 720006-04 SIGN PANEL ERECTION DETAILS
- 725001 OBJECT AND TERMINAL MARKERS
- 780001-05 TYPICAL PAVEMENT MARKINGS
- 781001-04 TYPICAL APPLICATIONS RAISED REFLECTIVE PAVEMENT MARKERS
- 782001-01 CURB REFLECTORS
- 782006 GUARDRAIL AND BARRIER WALL REFLECTOR MOUNTING DETAILS
- 814001-03 HANDHOLES
- 876001-04 PEDESTRIAN PUSH BUTTON POST
- 886001-01 DETECTOR LOOP INSTALLATIONS
- 886006-01 TYPICAL LAYOUTS FOR DETECTION LOOPS

GENERAL NOTES

1. ILLINOIS STATE LAW REQUIRES A 48-HOUR NOTICE TO BE GIVEN TO ALL UTILITIES WITHIN THE PROJECT AREA BEFORE DIGGING. FIELD MARKING OF FACILITIES MAY BE OBTAINED BY CONTACTING J.U.L.I.E. OR FOR NON-MEMBERS THE UTILITY COMPANY DIRECTLY. AGENCIES KNOWN TO HAVE FACILITIES WITHIN THE PROJECT AREA ARE AS FOLLOWS:

	ABOVE GROUND	BELOW GROUND
•AMEREN ILLINOIS (GAS & ELCTRIC)	X	X
•AT&T ILLINOIS (COMMUNICATIONS)	X	X
•CITY OF CARLYLE (WATER & SANITARY SEWER)	X	X
•CITY OF CARLYLE (ELECTRIC)	X	X
•CHARTER COMMUNICATIONS, INC. (CABLE TV)	X	X
•CLINTON COUNTY ELECTRIC COOPERATIVE, INC. (ELECTRIC)	X	X

MEMBERS OF J.U.L.I.E. CALL TOLL FREE (800)-892-0123 OR 811 AND ARE INDICATED BY * . NON J.U.L.I.E. MEMBERS MUST BE NOTIFIED INDIVIDUALLY.

2. THE CONTRACTOR AND ENGINEER SHALL BE AWARE THAT NO SURVEY WAS PERFORMED FOR THIS PROJECT. THE STATIONING, TOPOGRAPHY AND QUANTITIES SHOWN IN THE PLANS WERE CREATED USING MICROFILM AND FIELD MEASUREMENTS. ALL SHALL BE ASSUMED TO BE APPROXIMATE. THE CONTRACTOR SHALL VERIFY DIMENSIONS AND CONDITIONS IN THE FIELD PRIOR TO CONSTRUCTION AND ORDERING OF MATERIALS.

3. THE STATIONING SHOWN IN THE PLANS SHALL ONLY APPLY TO THIS PROJECT.

4. THE USE OF VIBRATORY ROLLERS WILL NOT BE PERMITTED WITHIN THE CITY LIMITS OF CARLYLE. THIS DOES NOT RELIEVE THE CONTRACTOR OF DENSITY REQUIREMENTS FOR THE CONSTRUCTION OF THE BITUMINOUS PAVEMENTS AS SPECIFIED IN SECTIONS 406 & 407 OF THE STANDARD SPECIFICATIONS.

5. NO OVERNIGHT LANE CLOSURES WILL BE PERMITTED.

6. THE PROPOSED PAVEMENT MARKING SHALL MATCH THE LOCATIONS OF THE EXISTING PAVEMENT MARKING, AS DIRECTED BY THE ENGINEER.

7. THE RECONSTRUCTION OF EXISTING SIDEWALK, PAVEMENT, CURB AND GUTTER, AS WELL AS OTHER MISCELLANEOUS ITEMS MAY REQUIRE EXCAVATIONS, EMBANKMENT OR AGGREGATE FILL MATERIAL DURING LEVELING TO ESTABLISH THE SUBGRADE OR FORMING FOR THE VARIOUS RECONSTRUCTION OPERATIONS FOR THIS PROJECT. ANY EARTHWORK, EMBANKMENT OR AGGREGATE FILL REQUIRED FOR SIDEWALK RECONSTRUCTION SHALL BE INCLUDED IN THE COST OF PORTLAND CEMENT CONCRETE SIDEWALK 4 INCH.

8. ANY ADDITIONAL PAVEMENT REMOVAL OR CONSTRUCTION OF ADDITIONAL PROPOSED PAVEMENT OR WIDER GUTTER FLAG REQUIRED TO CONSTRUCT THE PROPOSED COMBINATION CONCRETE CURB AND GUTTER SHALL BE INCLUDED IN THE COST OF COMBINATION CONCRETE CURB AND GUTTER, TYPE B-6.24.

9. ALL AREAS DISTURBED FOR ANY REASON SHALL BE SEEDED WITH CLASS 1 SEEDING AS DIRECTED BY THE ENGINEER. NUTRIENTS SHALL CONFORM TO ARTICLE 250.04 OF THE STANDARD SPECIFICATIONS. ANY SEEDING REQUIRED OUTSIDE THE CONSTRUCTION LIMITS FOR THIS CONTRACT SECTION WILL NOT BE PAID FOR SEPARATELY AND WILL BE CONSIDERED AS A CONTRACTOR'S EXPENSE.

10. THE THICKNESS OF HOT-MIX ASPHALT SURFACE MIXTURES SHOWN ON THE PLANS IS THE NOMINAL THICKNESS. DEVIATIONS MAY OCCUR DUE TO IRREGULARITIES IN THE EXISTING SURFACE OR BASE ON WHICH THE BITUMINOUS MIXTURE IS PLACED.

11. THE QUALITY CONTROL FOR PERFORMANCE ITEMS AND QUANTITIES ARE AS FOLLOWS:

HMA SURFACE COURSE, MIX "D", N90, IL 9.5 - 3770 TONS
LEVELING BINDER (MACHINE METHOD), IL-9.5FG, N90 - 2605 TONS

12. CONTRACTOR SHALL BE AWARE THAT THE LOCATION OF PATCHES ARE APPROXIMATE AND SHOULD BE COORDINATED WITH THE RESIDENT ENGINEER AND OPERATIONS PERSONNEL. PRIOR TO CONSTRUCTION, THE ENGINEER SHALL CONTACT THE OPERATIONS FIELD TECHNICIAN JASON ROECKENHAUS AT (618) 594-3001 PRIOR TO MARKING PATCHING LOCATIONS.

COMMITMENTS

NONE

MIXTURE REQUIREMENTS

ROUTE	FAP 327 / FAP 42
SECTION	113RS-6, 14-16Z-RS-1
COUNTY	CLINTON
CONTRACT	76J06

DESCRIPTION:	PATCHING & RESURFACING - 3P (TRAC-N) 0.2 MI N OF WILLIAM RD TO 11TH ST IN CARLYLE
--------------	---

ADT (CONSTRUCTION YR.)	10600
MU%:	6.9
SU%:	6.2
20 YR. ESAL:	4.80

MIXTURE USE	SURFACE	LEVEL BINDER	SHOULDER > 2.25"
AC/PG	PG-64-22	PG-64-22	PG-64-22
RAP % (MAX)	SEE SPEC	SEE SPEC	SEE SPEC
DESIGN AIR VOIDS	4.0% @ Ndes=90	4.0% @ Ndes=90	4.0% @ Ndes=30
MIX COMPOSITION (GRADATION MIXTURE)	IL 9.5	IL 9.5 FG	IL 19.0 L
FRICTION AGG	MIXTURE "D"	MIXTURE "C"	
QUALITY MGMT PROGRAM	QCP	QCP	QC/QA

PLAN QUANTITIES FOR BITUMINOUS CONCRETE SURFACE COURSE ITEMS ARE CALCULATED USING A UNIT WEIGHT OF 112 LB/SQ YD/INCH (0.056 TONS/SQ YD/INCH).

SURVEY MONUMENT LOCATIONS

MONUMENT #1	IL 127 LEFT TURN LANE ON US 50 INTERSECTION APPROXIMATE STA 1055+50
-------------	---

CODE NO.	ITEM	UNIT	TOTAL QUANTITY	CONSTR. CODE
				80% FED 20% STATE ROADWAY 0005 RURAL
44300200	STRIP REFLECTIVE CRACK CONTROL TREATMENT	FOOT	31098	31098
48102100	AGGREGATE WEDGE SHOULDER, TYPE B	TON	258	258
48203100	HOT-MIX ASPHALT SHOULDERS	TON	1046	1046
550A0410	STORM SEWERS, CLASS A, TYPE 2 24"	FOOT	115	115
55101200	STORM SEWER REMOVAL 24"	FOOT	115	115
60240220	INLETS, TYPE B, TYPE 3 FRAME AND GRATE	EACH	2	2
60260100	INLETS TO BE ADJUSTED	EACH	2	2
60500060	REMOVING INLETS	EACH	2	2
60605000	COMBINATION CONCRETE CURB AND GUTTER, TYPE B-6.24	FOOT	390	390
* 63000001	STEEL PLATE BEAM GUARDRAIL, TYPE A, 6 FOOT POSTS	FOOT	125	125
* 63100167	TRAFFIC BARRIER TERMINAL, TYPE 1 (SPECIAL) TANGENT	EACH	2	2
63200310	GUARDRAIL REMOVAL	FOOT	301	301
67000400	ENGINEER'S FIELD OFFICE, TYPE A	CAL MO	6	6
67100100	MOBILIZATION	LSUM	1	1

CODE NO.	ITEM	UNIT	TOTAL QUANTITY	CONSTR. CODE
				80% FED 20% STATE ROADWAY 0005 RURAL
70100450	TRAFFIC CONTROL AND PROTECTION, STANDARD 701201	LSUM	1	1
70100460	TRAFFIC CONTROL AND PROTECTION, STANDARD 701306	LSUM	1	1
70100500	TRAFFIC CONTROL AND PROTECTION, STANDARD 701326	LSUM	1	1
70100600	TRAFFIC CONTROL AND PROTECTION, STANDARD 701336	LSUM	1	1
70102622	TRAFFIC CONTROL AND PROTECTION, STANDARD 701502	LSUM	1	1
70102635	TRAFFIC CONTROL AND PROTECTION, STANDARD 701701	LSUM	1	1
70102640	TRAFFIC CONTROL AND PROTECTION, STANDARD 701801	LSUM	1	1
70300100	SHORT TERM PAVEMENT MARKING	FOOT	4072	4072
70300150	SHORT TERM PAVEMENT MARKING REMOVAL	SO FT	676	676
70300210	TEMPORARY PAVEMENT MARKING LETTERS AND SYMBOLS	SO FT	2196	2196
70300220	TEMPORARY PAVEMENT MARKING - LINE 4"	FOOT	31042	31042
70300260	TEMPORARY PAVEMENT MARKING - LINE 12"	FOOT	2199	2199
70300280	TEMPORARY PAVEMENT MARKING - LINE 24"	FOOT	315	315
* 72400710	RELOCATE SIGN PANEL - TYPE 1	SO FT	7	7

* SPECIALTY ITEM

FILE NAME =	USER NAME = njeveee	DESIGNED -	REVISED -	STATE OF ILLINOIS DEPARTMENT OF TRANSPORTATION	SUMMARY OF QUANTITIES				F.A.P. RTE.	SECTION	COUNTY	TOTAL SHEETS	SHEET NO.
p:\11884EBID\INTEG\Illinois.gov\PIV001\Do	Documents\DOT Offices\District 8\Projects\087	REVISIONS	REVISIONS						327/42	113RS-6, J4-16Z-RS-1	CLINTON	32	4
PLOT SCALE = 100.0000 1/4"	CHECKED -	REVISIONS	REVISIONS		CONTRACT NO. 76J06								
PLOT DATE = 1/25/2016	DATE -	REVISIONS	REVISIONS		SCALE:	SHEET NO.	OF	SHEETS	STA.	TO STA.	FED. ROAD DIST. NO.	ILLINOIS FED. AID PROJECT	

CODE NO.	ITEM	UNIT	TOTAL QUANTITY	CONSTR. CODE
				80% FED 20% STATE ROADWAY 0005 RURAL
* 72501000	TERMINAL MARKER - DIRECT APPLIED	EACH	2	2
* 73000100	WOOD SIGN SUPPORT	FOOT	15	15
* 78000100	THERMOPLASTIC PAVEMENT MARKING - LETTERS AND SYMBOLS	SQ FT	2196	2196
* 78000200	THERMOPLASTIC PAVEMENT MARKING - LINE 4"	FOOT	31042	31042
* 78000600	THERMOPLASTIC PAVEMENT MARKING - LINE 12"	FOOT	2199	2199
* 78000650	THERMOPLASTIC PAVEMENT MARKING - LINE 24"	FOOT	315	315
* 78100100	RAISED REFLECTIVE PAVEMENT MARKER	EACH	474	474
* 78200005	GUARDRAIL REFLECTORS, TYPE A	EACH	3	3
* 78200020	CURB REFLECTOR	EACH	39	39
78300100	PAVEMENT MARKING REMOVAL	SQ FT	14720	14720
78300200	RAISED REFLECTIVE PAVEMENT MARKER REMOVAL	EACH	474	474
* 80300100	LOCATING UNDERGROUND CABLE	FOOT	110	110
* 81028350	UNDERGROUND CONDUIT, PVC, 2" DIA.	FOOT	7	7
* 87301215	ELECTRIC CABLE IN CONDUIT, SIGNAL NO. 14 2C	FOOT	283	283

CODE NO.	ITEM	UNIT	TOTAL QUANTITY	CONSTR. CODE
				80% FED 20% STATE ROADWAY 0005 RURAL
* 87600100	PEDESTRIAN PUSH-BUTTON POST, TYPE 1	EACH	1	1
* 87900200	DRILL EXISTING HANDHOLE	EACH	1	1
* 88600600	DETECTOR LOOP REPLACEMENT	FOOT	3102	3102
* 88800100	PEDESTRIAN PUSH-BUTTON	EACH	8	8
* 89502350	REMOVE AND REINSTALL ELECTRIC CABLE FROM CONDUIT	FOOT	283	283
* 89502375	REMOVE EXISTING TRAFFIC SIGNAL EQUIPMENT	EACH	8	8
* 89502376	REBUILD EXISTING HANDHOLE	EACH	1	1
φ Z0076600	TRAINEES	hour	500	500
Z0036200	PAINT CURB	FOOT	252	252
φ Z0076604	TRAINEES TRAINING PROGRAM GRADUATE	hour	500	500
Z0070100	SURVEY MONUMENT COVER ASSEMBLY	EACH	1	1

* SPECIALTY ITEM
φ 0042

FILE NAME = <small>p:\11848481\INTEGallinois.gov\PIDOT\Documents\1007 Offices\District B\Proje\m4\007-08\000\01\640\sheet\0876J06-sht-pln.d</small>	USER NAME = njeve DESIGNED - CHECKED - DATE -	REVISED - REVISED - REVISED -	STATE OF ILLINOIS DEPARTMENT OF TRANSPORTATION	SUMMARY OF QUANTITIES SCALE: SHEET NO. OF SHEETS STA. TO STA.	F.A.P. RTE. 327/42 SECTION 113RS-6, 14-162-RS-1 COUNTY CLINTON TOTAL SHEETS 32 SHEET NO. 5 CONTRACT NO. 76J06 <small>FED. ROAD DIST. NO. ILLINOIS FED. AID PROJECT</small>
--	--	-------------------------------------	---	--	---

 PROPOSED HMA SURFACE REMOVAL, 3"

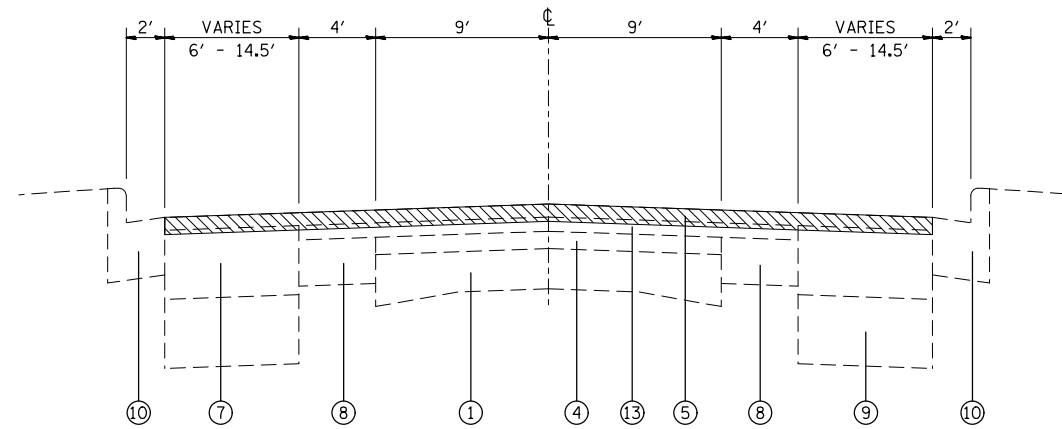

EXISTING TANGENT SECTION (IL 127)

STA. 1000+00 TO STA. 1019+04
 STA. 1003+61 (RT) TO STA. 1004+76 (RT)
 PROPOSED COMB. CURB AND GUTTER REMOVAL

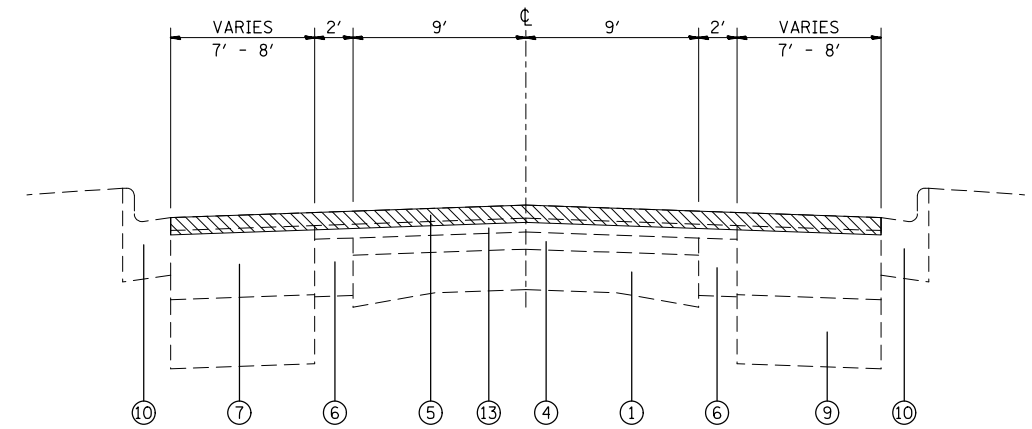

EXISTING TANGENT SECTION (IL 127)

STA. 1019+04 TO STA. 1047+10

LEGEND

- ① EXISTING PCC PAVEMENT, 9-7-9
- ② EXISTING BITUMINOUS SHOULDER, 8"
- ③ EXISTING AGGREGATE SHOULDER
- ④ EXISTING BITUMINOUS SURFACE, 3"
- ⑤ EXISTING BITUMINOUS SURFACE, 2.25"
- ⑥ EXISTING BITUMINOUS WIDENING, 10"
- ⑦ EXISTING BITUMINOUS WIDENING, 12"
- ⑧ EXISTING PCC BASE COURSE WIDENING, 8"
- ⑨ EXISTING LIME MODIFIED SOIL, 12"
- ⑩ EXISTING COMBINATION CURB AND GUTTER, TYPE B-6.24
- ⑪ EXISTING CRPCC PAVEMENT, 8"
- ⑫ EXISTING CRPCC SHOULDER, 8"
- ⑬ EXISTING BITUMINOUS SURFACE, 2.5"
- ⑭ PROPOSED LEVELING BINDER (MACHINE METHOD), IL-9.5FG, N90
- ⑮ PROPOSED HMA SURFACE COURSE, MIX "D", N90, IL 9.5
- ⑯ PROPOSED BITUMINOUS MATERIAL (TACK COAT)
- ⑰ PROPOSED HMA SHOULDERS
- ⑱ PROPOSED STRIP REFLECTIVE CRACK CONTROL TREATMENT
- ⑲ PROPOSED COMBINATION CONCRETE CURB AND GUTTER, TYPE B-6.24
- ⑳ PROPOSED AGGREGATE WEDGE SHOULDER, TYPE B

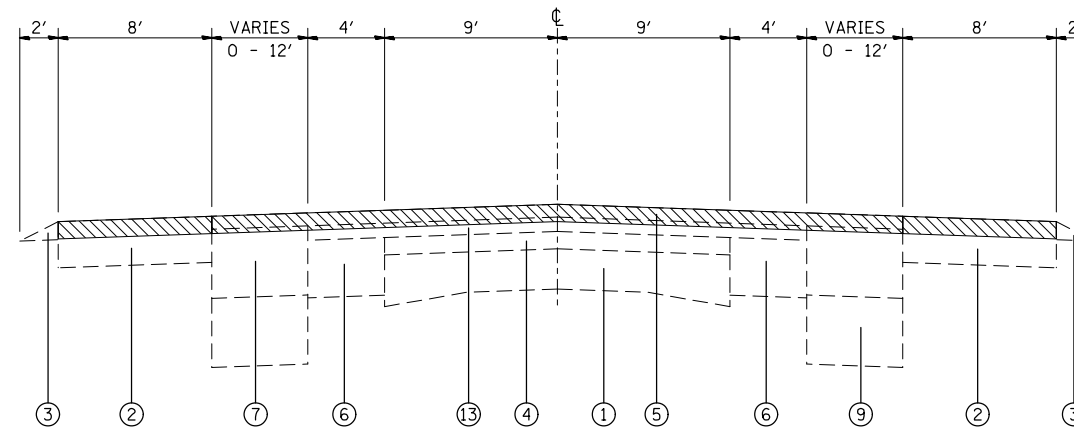

EXISTING TANGENT SECTION (IL 127)

STA. 1047+10 TO STA. 1055+99
 STA. 1055+99 TO STA. 1074+62
 STA. 1054+46 TO STA. 1060+44
 PROPOSED HMA REMOVAL 0.5"

FILE NAME =	USER NAME = nievesa	DESIGNED -	REVISED -	STATE OF ILLINOIS DEPARTMENT OF TRANSPORTATION	EXISTING TYPICALS (IL 127)	F.A.P. RTE.	SECTION	COUNTY	TOTAL SHEETS	SHEET NO.	
						327/42	113RS-5, 14-16Z-R5-I	CLINTON	32	6	
						CONTRACT NO. 76J06					
						FED. ROAD DIST. NO.	ILLINOIS	FED. AID PROJECT			
PLOT SCALE = 1/8" = 100.0000' / 1in. PLOT DATE = 1/25/2016						SCALE:	SHEET NO. 1 OF 2 SHEETS	STA.	TO STA.		

 PROPOSED HMA SURFACE REMOVAL, 3"

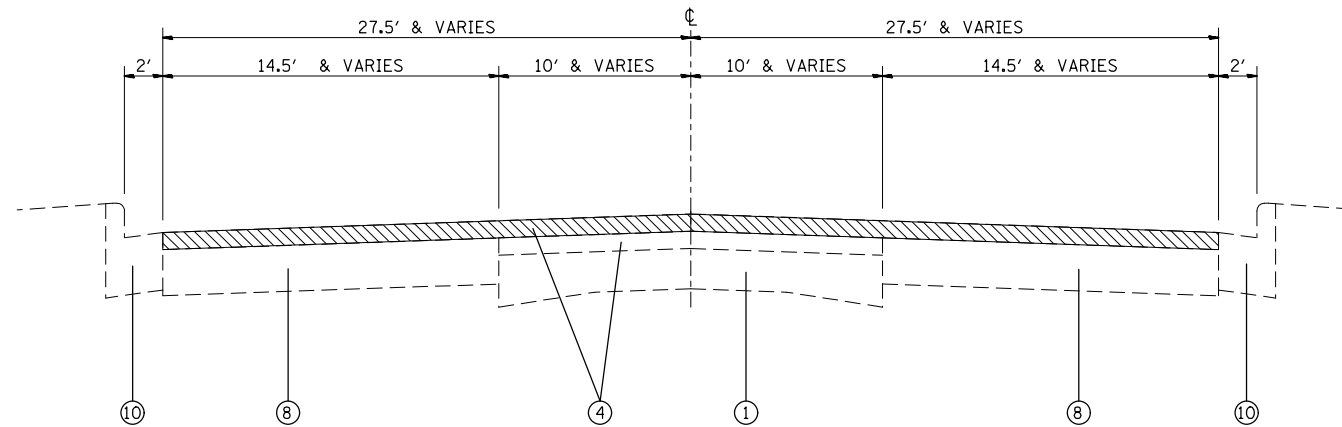

EXISTING TANGENT SECTION (FRANKLIN ST & US 50 EAST LEG)

STA. 4000+00 TO STA. 4003+20
STA. 4003+75 TO STA. 4006+83

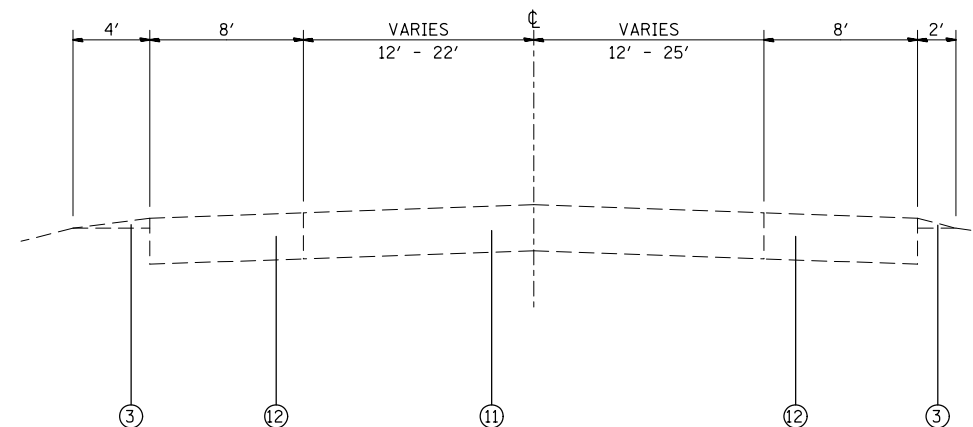

EXISTING TANGENT SECTION (US 50)

STA. 3000+00 TO STA. 3005+26

LEGEND

- ① EXISTING PCC PAVEMENT, 9-7-9
- ② EXISTING BITUMINOUS SHOULDER, 8"
- ③ EXISTING AGRREGATE SHOULDER
- ④ EXISTING BITUMINOUS SURFACE, 3"
- ⑤ EXISTING BITUMINOUS SURFACE, 2.25"
- ⑥ EXISTING BITUMINOUS WIDENING, 10"
- ⑦ EXISTING BITUMINOUS WIDENING, 12"
- ⑧ EXISTING PCC BASE COURSE WIDENING, 8"
- ⑨ EXISTING LIME MODIFIED SOIL, 12"
- ⑩ EXISTING COMBINATION CURB AND GUTTER, TYPE B-6.24
- ⑪ EXISTING CRPCC PAVEMENT, 8"
- ⑫ EXISTING CRPCC SHOULDER, 8"
- ⑬ EXISTING BITUMINOUS SURFACE, 2.5"
- ⑭ PROPOSED LEVELING BINDER (MACHINE METHOD), IL-9.5FG, N90
- ⑮ PROPOSED HMA SURFACE COURSE, MIX "D", N90, IL 9.5
- ⑯ PROPOSED BITUMINOUS MATERIAL (TACK COAT)
- ⑰ PROPOSED HMA SHOULDERS
- ⑱ PROPOSED STRIP REFLECTIVE CRACK CONTROL TREATMENT
- ⑲ PROPOSED COMBINATION CONCRETE CURB AND GUTTER, TYPE B-6.24
- ⑳ PROPOSED AGGREGATE WEDGE SHOULDER, TYPE B

FILE NAME =	USER NAME = nievesa	DESIGNED -	REVISED -	STATE OF ILLINOIS DEPARTMENT OF TRANSPORTATION	EXISTING TYPICALS (FRANKLIN ST & US 50)	F.A.P. RTE.	SECTION	COUNTY	TOTAL SHEETS	SHEET NO.	
pw:\IL\084EBIDINTEG.illinois.gov\PIWIDOT\Documents\DOT Offices\District 8\Projects\0876\DRAWING\EA\Sheets\D876J06-sht-pln.dgn						327/42	113RS-6, 14-16Z-RS-1	CLINTON	32	7	
PLOT SCALE = 100.0000' / 1in.						CHECKED -	REVISED -	CONTRACT NO. 76J06			
PLOT DATE = 1/25/2016						DATE -	REVISED -	FED. ROAD DIST. NO. ILLINOIS FED. AID PROJECT			
						SCALE:	SHEET NO. 2 OF 2 SHEETS	STA.	TO STA.		

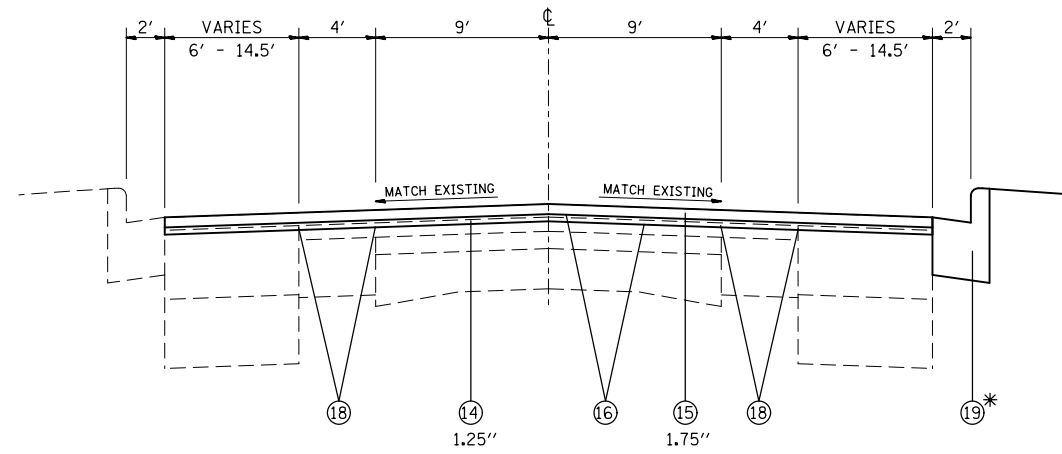

PROPOSED TANGENT SECTION (IL 127)
 STA. 1000+00 TO STA. 1019+04
 *STA. 1003+61 TO STA. 1004+76

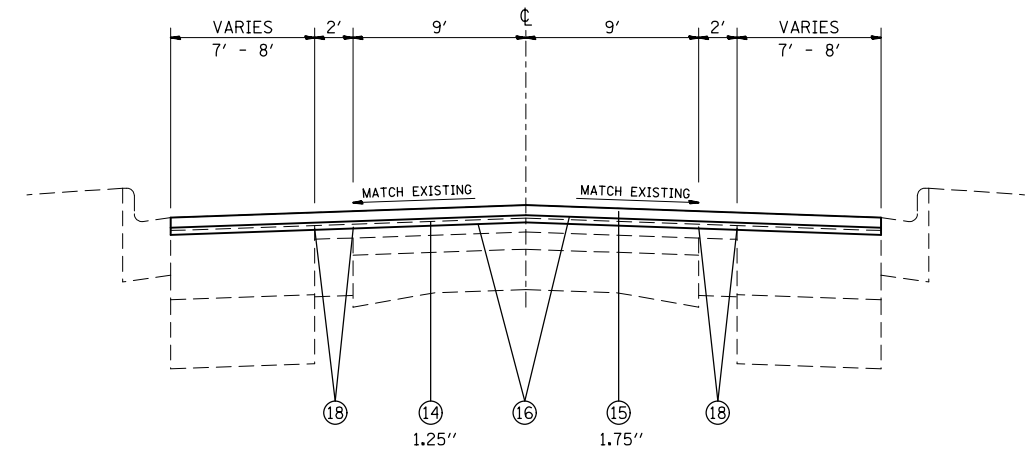

PROPOSED TANGENT SECTION (IL 127)
 STA. 1019+04 TO STA. 1047+10

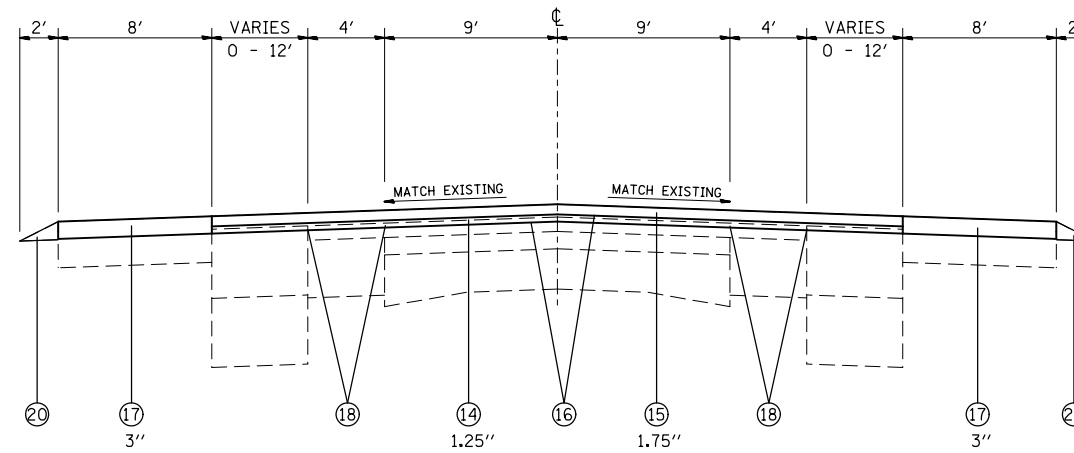

PROPOSED TANGENT SECTION (IL 127)
 STA. 1047+10 TO STA. 1055+99
 STA. 1055+99 TO STA. 1074+62

LEGEND

- ① EXISTING PCC PAVEMENT, 9-7-9
- ② EXISTING BITUMINOUS SHOULDER, 8"
- ③ EXISTING AGRREGATE SHOULDER
- ④ EXISTING BITUMINOUS SURFACE, 3"
- ⑤ EXISTING BITUMINOUS SURFACE, 2.25"
- ⑥ EXISTING BITUMINOUS WIDENING, 10"
- ⑦ EXISTING BITUMINOUS WIDENING, 12"
- ⑧ EXISTING PCC BASE COURSE WIDENING, 8"
- ⑨ EXISTING LIME MODIFIED SOIL, 12"
- ⑩ EXISTING COMBINATION CURB AND GUTTER, TYPE B-6.24
- ⑪ EXISTING CRPCC PAVEMENT, 8"
- ⑫ EXISTING CRPCC SHOULDER, 8"
- ⑬ EXISTING BITUMINOUS SURFACE, 2.5"
- ⑭ PROPOSED LEVELING BINDER (MACHINE METHOD), IL-9.5FG, N90
- ⑮ PROPOSED HMA SURFACE COURSE, MIX "D", N90, IL 9.5
- ⑯ PROPOSED BITUMINOUS MATERIAL (TACK COAT)
- ⑰ PROPOSED HMA SHOULDERS
- ⑱ PROPOSED STRIP REFLECTIVE CRACK CONTROL TREATMENT
- ⑲ PROPOSED COMBINATION CONCRETE CURB AND GUTTER, TYPE B-6.24
- ⑳ PROPOSED AGGREGATE WEDGE SHOULDER, TYPE B

FILE NAME =	USER NAME = rievesa	DESIGNED -	REVISED -
pw:\IL\084EBIDINTEG\illinois.gov\PIDOT\Documents\DOT Offices\District 8\Projects\0876\DRAWING\DATA\EA0sheets\0876J06-sht-pln.dgn		REVISOR -	REVISED -
	PLOT SCALE = 100.0000' / 1in.	CHECKED -	REVISED -
	PLOT DATE = 1/25/2016	DATE -	REVISED -

**STATE OF ILLINOIS
 DEPARTMENT OF TRANSPORTATION**

PROPOSED TYPICALS (IL 127)

SCALE: SHEET NO. 1 OF 2 SHEETS STA. TO STA.

F.A.P. RTE.	SECTION	COUNTY	TOTAL SHEETS	SHEET NO.
327/42	113RS-6, 14-16Z-RS-1	CLINTON	32	8
FED. ROAD DIST. NO. ILLINOIS FED. AID PROJECT			CONTRACT NO. 76J06	

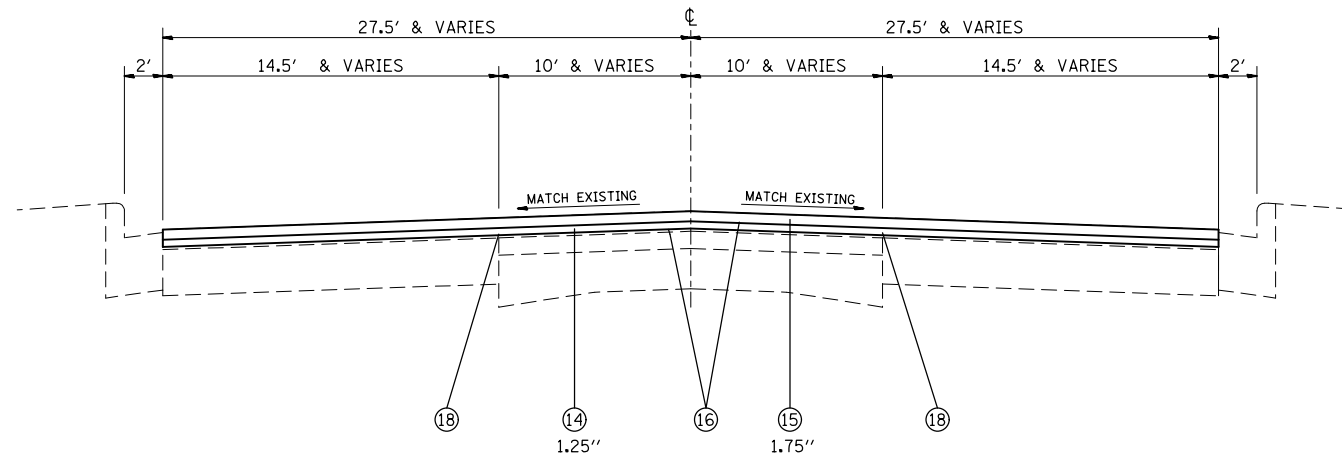

PROPOSED TANGENT SECTION (FRANKLIN ST & US 50 EAST LEG)

STA. 4000+00 TO STA. 4003+20
 STA. 4003+75 TO STA. 4006+83

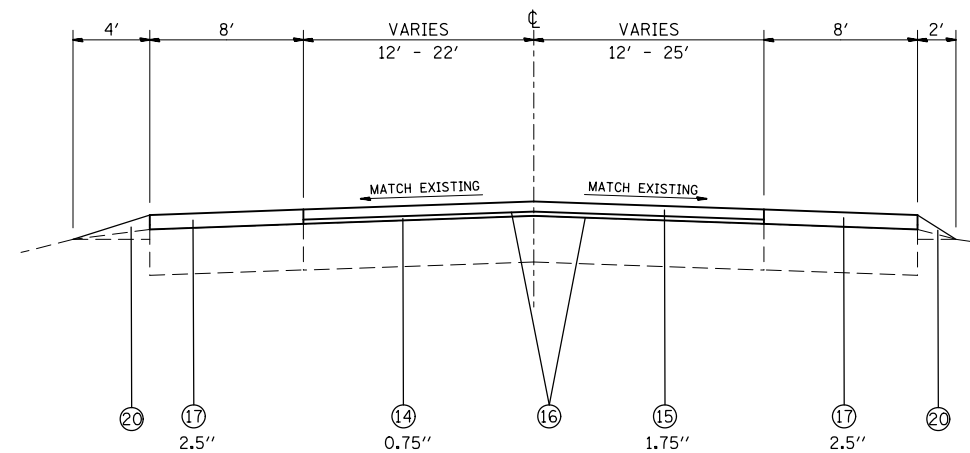

PROPOSED TANGENT SECTION (US 50)

STA. 3000+00 TO STA. 3005+26

LEGEND

- ① EXISTING PCC PAVEMENT, 9-7-9
- ② EXISTING BITUMINOUS SHOULDER, 8"
- ③ EXISTING AGRREGATE SHOULDER
- ④ EXISTING BITUMINOUS SURFACE, 3"
- ⑤ EXISTING BITUMINOUS SURFACE, 2.25"
- ⑥ EXISTING BITUMINOUS WIDENING, 10"
- ⑦ EXISTING BITUMINOUS WIDENING, 12"
- ⑧ EXISTING PCC BASE COURSE WIDENING, 8"
- ⑨ EXISTING LIME MODIFIED SOIL, 12"
- ⑩ EXISTING COMBINATION CURB AND GUTTER, TYPE B-6.24
- ⑪ EXISTING CRPCC PAVEMENT, 8"
- ⑫ EXISTING CRPCC SHOULDER, 8"
- ⑬ EXISTING BITUMINOUS SURFACE, 2.5"
- ⑭ PROPOSED LEVELING BINDER (MACHINE METHOD), IL-9.5FG, N90
- ⑮ PROPOSED HMA SURFACE COURSE, MIX "D", N90, IL 9.5
- ⑯ PROPOSED BITUMINOUS MATERIAL (TACK COAT)
- ⑰ PROPOSED HMA SHOULDERS
- ⑱ PROPOSED STRIP REFLECTIVE CRACK CONTROL TREATMENT
- ⑲ PROPOSED COMBINATION CONCRETE CURB AND GUTTER, TYPE B-6.24
- ⑳ PROPOSED AGGREGATE WEDGE SHOULDER, TYPE B

FILE NAME =	USER NAME = nievesa	DESIGNED -	REVISED -
pw:\IL\084EBIDINTEG\illinois.gov\PIDOT\Documents\DOT Offices\District 8\Projects\0876\DRAWING\DATA\EA0sheets\0876J06-sht.pln.dgn		DRAWN -	REVISED -
	PLOT SCALE = 100.0000' / 1in.	CHECKED -	REVISED -
	PLOT DATE = 1/25/2016	DATE -	REVISED -

**STATE OF ILLINOIS
 DEPARTMENT OF TRANSPORTATION**

PROPOSED TYPICALS (FRANKLIN ST & US 50)

SCALE: SHEET NO. 2 OF 2 SHEETS STA. TO STA.

F.A.P. RTE.	SECTION	COUNTY	TOTAL SHEETS	SHEET NO.
327/42	113RS-6, 14-16Z-RS-1	CLINTON	32	9
FED. ROAD DIST. NO. ILLINOIS FED. AID PROJECT			CONTRACT NO. 76J06	

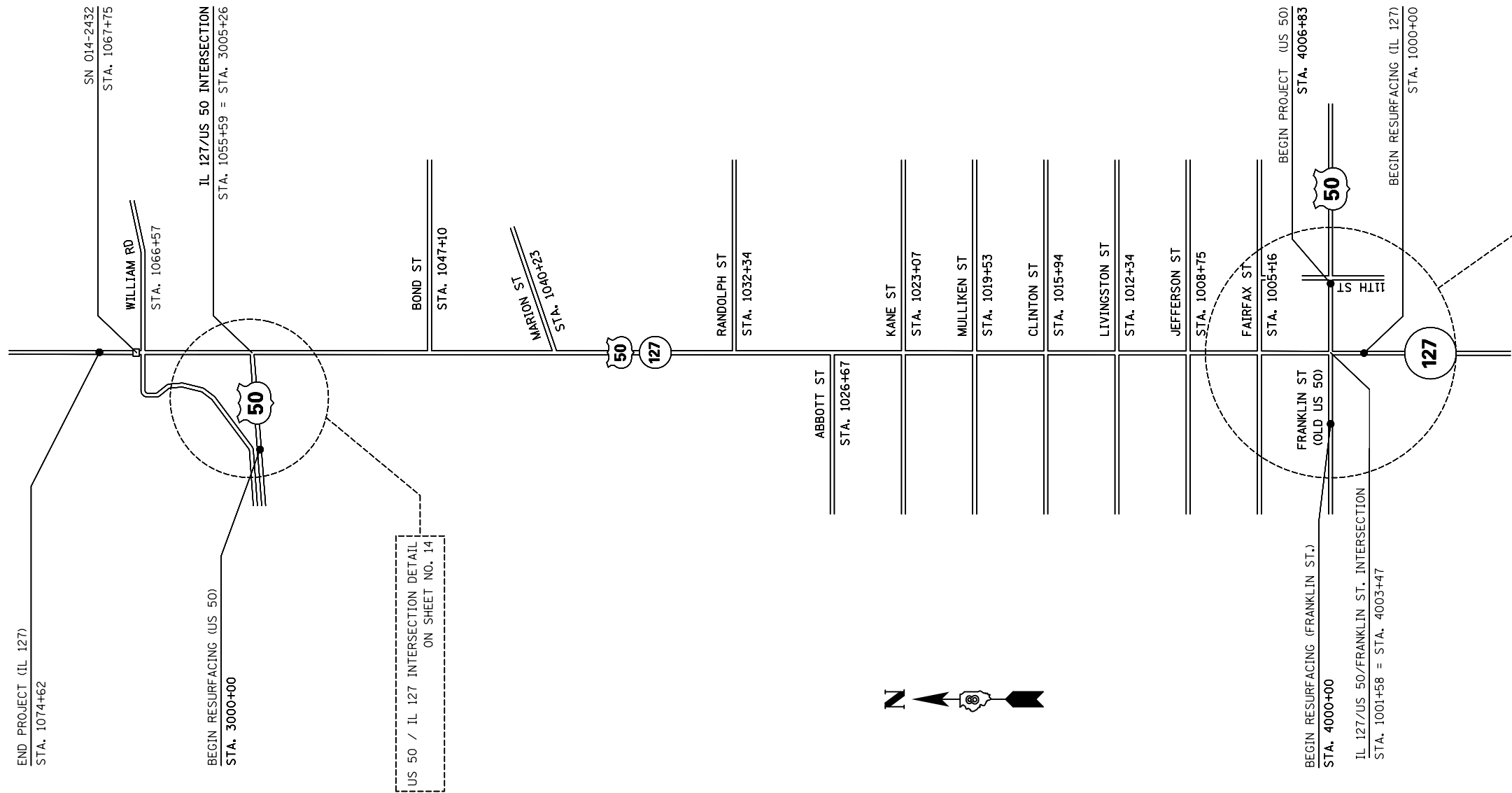

US 50 / IL 127 INTERSECTION DETAIL
ON SHEET NO. 14

OLD US 50 / US 50 INTERSECTION DETAIL
ON SHEET NO. 15

NOT TO SCALE

FILE NAME =	USER NAME = nievesa	DESIGNED -	REVISED -
pw:\IL\084EBID\INTEG\illinois.gov\PIDOT\Documents\IDOT Offices\District 8\Projects\0876\DRAWING\DATA\EAD\Sheets\0876J06-sht-pln.dgn		REVISOR -	REVISED -
	PLOT SCALE = 100.0000' / in.	CHECKED -	REVISED -
	PLOT DATE = 1/25/2016	DATE -	REVISED -

**STATE OF ILLINOIS
DEPARTMENT OF TRANSPORTATION**

LOCATION MAP - US 50, IL 127 & FRANKLIN ST.

SCALE: SHEET NO. OF SHEETS STA. TO STA.

F.A.P. RTE.	SECTION	COUNTY	TOTAL SHEETS	SHEET NO.
327/42	113RS-6, 14-16Z-RS-1	CLINTON	32	10
CONTRACT NO. 76J06				
FED. ROAD DIST. NO.	ILLINOIS	FED. AID PROJECT		

CLASS B PATCHING SCHEDULE												
LOCATION	LANE OFFSET	LENGTH	WIDTH	CLASS B PATCHES, 15 INCH		CLASS B PATCHES, 20 INCH			SAW CUTS	DOWEL BARS 1 1/2"	TIE BARS 3/4"	WELDED WIRE REINFORCEMENT
				TYPE II	TYPE IV	TYPE II	TYPE III	TYPE IV				
STATION		FOOT	FOOT	SQ YD	SQ YD	SQ YD	SQ YD	SQ YD	FOOT	EACH	EACH	SQ YD
IL 127/US 50												
1004+08	NB	200	12					267	636	20	198	267
1019+35	NB	12	12				16		72	20		16
1019+35	C TL	12	14				19		78	24		19
1019+35	SB	12	12				16		72	20		16
1036+88	NB	12	12				16		72	20		16
1036+88	C TL	12	14				19		78	24		19
1052+40	NB	12	12				16		72	20		16
1052+40	C TL	12	14				19		78	24		19
1060+66	SB	6	12				8		54	20		8
FRANKLIN ST.												
4000+50	EB	6	12	8					54	20		8
4000+75	WB	6	12	8					54	20		8
4001+00	EB	6	12	8					54	20		8
4001+25	WB	6	12	8					54	20		8
4001+50	EB	6	12	8					54	20		8
4001+75	WB	6	12	8					54	20		8
4002+00	EB	6	12	8					54	20		8
4002+00	EB TL	6	12	8					54	20		8
4002+00	WB	6	12	8					54	20		8
4002+25	EB	6	12	8					54	20		8
4002+25	EB TL	6	12	8					54	20		8
4002+25	WB	6	12	8					54	20		8
4002+50	EB	6	12	8					54	20		8
4002+50	EB TL	6	12	8					54	20		8
4002+50	WB	6	12	8					54	20		8
4002+75	EB	6	12	8					54	20		8
4002+75	EB TL	6	12	8					54	20		8
4002+75	WB	6	12	8					54	20		8
4004+00	EB	6	12	8					54	20		8
4004+25	WB	40	12		53				156	20	38	53
4005+25	EB	30	12		40				126	20	28	40
4005+75	EB	20	12		27				96	20		27
SUBTOTAL				152	120	8	120	267	2616	632	264	667
ANTICIPATED FAILURE 15%				23	18	1	18	40	392	95	40	100
TOTAL QUANTITY				175	138	9	138	307	3008	727	304	767

RAISED ISLAND SCHEDULE			
LOCATION	RT/LT	PAINT CURB	CURB REFLECTOR
		FOOT	EACH
1055+61	LT	117	16
1056+30	LT	70	13
1067+07	LT	65	10
TOTAL		252	39

BUTT JOINT & TEMPORARY RAMP SCHEDULE		
LOCATION	HMA SURFACE REMOVAL BUTT JOINT	TEMPORARY RAMPS
STATION	SQ YD	SQ YD
1000+00		55
1054+56		53
1060+44		42
1074+53		55
3000+00	233	40
4000+00		38
4006+83		36
TOTAL	233	319

GUARDRAIL SCHEDULE									
LOCATION			NB/SB	LENGTH	STEEL PLATE BEAM GUARDRAIL, TYPE A, 6 FOOT POSTS	TRAFFIC BARRIER TERMINAL, TYPE 1, (SPECIAL), TANGENT	GUARDRAIL MARKERS, TYPE A	TERMINAL MARKER - DIRECT APPLIED	GUARDRAIL REMOVAL
STATION	TO	STATION							
1067+52	TO	1069+15	NB						163
1067+03	TO	1069+28	SB	225.00	125.0	2	3	2	138
TOTAL					125.0	2	3	2	301

HMA RESURFACING SCHEDULE												
LOCATION			DIMENSIONS		HMA SURFACE REMOVAL, 3"	HMA SURFACE REMOVAL, 0.5"	BITUMINOUS MATERIAL (TACK COAT)	LEVELING BINDER (MACHINE METHOD), IL-9.5FG, N90	HMA SURFACE COURSE MIX "D", N90, IL 9.5	HMA SHOULDERS	AGGREGATE WEDGE SHOULDER, TYPE B	STRIP REFLECTIVE CRACK CONTROL TREATMENT
			LENGTH	WIDTH								
STATION	TO	STATION	FOOT	FOOT	SQ YD	SQ YD	POUND	TON	TON	TON	TON	FOOT
US 50/IL 127												
1000+00		1019+04	1904.00	VAR.	8998		6074	630	882			7616
1019+04		1047+10	2806.00	37.00	11536		7787	808	1131			11224
1047+10		1054+46	736.00	VAR.	4752		3208	216	302	283	55	2944
1054+46		1060+44	598.00	VAR.		2933	1980	157	220	117	23	2392
1060+44		1074+62	1418.00	VAR.	8226		5553	413	578	392	106	5672
FRANKLIN ST.												
4000+00		4003+20	320.00	VAR.	1799		1214	126	177			640
4003+78		4006+83	305.00	VAR.	1732		1169	122	170			610
US 50 (NORTH LEG)												
3000+00		3005+26	526.00	VAR.			3153	133	310	254	74	
TOTAL					37043	2933	30138	2605	3770	1046	258	31098

STORM SEWER SCHEDULE									
LOCATION			COMBINATION CURB AND GUTTER REMOVAL	STORM SEWER REMOVAL 24"	REMOVING INLETS	COMBINATION CONCRETE CURB AND GUTTER, TYPE B-6.24	STORM SEWERS, CLASS A, TYPE 2 24"	TRENCH BACKFILL	INLET, TYPE B, TYPE 3 FRAME AND GRATE
STATION	TO	STATION	FOOT	FOOT	EACH	FOOT	FOOT	CU YD	EACH
1003+61	TO	1004+61	100	100		100	100	110	
1004+61	TO	1004+76	15	15		15	15	17	
1004+61					1				1
1037+88					1				1
TOTAL			115*	115	2	115*	115	127	2

* NOT FINAL QUANTITY. SEE SHEET 20 FOR ADDITIONAL QUANTITY.

SEEDING SCHEDULE						
STATION	SEEDING, CLASS 1	NITROGEN FERTILIZER NUTRIENT	PHOSPHORUS FERTILIZER NUTRIENT	POTASSIUM FERTILIZER NUTRIENT	MULCH, METHOD 1	TEMPORARY EROSION CONTROL SEEDING
	ACRE	POUND	POUND	POUND	ACRE	POUND
1001+58	0.01	1	1	1	0.01	1
1008+75	0.01	1	1	1	0.01	1
1012+34	0.01	1	1	1	0.01	1
1015+94	0.04	4	4	4	0.04	4
1026+67	0.03	3	3	3	0.03	3
1032+34	0.07	6	6	6	0.07	7
1040+23	0.08	7	7	7	0.08	8
TOTAL	0.25	23	23	23	0.25	25

PAVEMENT MARKING SCHEDULE

STATION TO	STATION	LENGTH (FOOT)	NO PASSING DIRECTION	THERMOPLASTIC								LETTERS AND SYMBOLS (SQ FT)	SHORT TERM		PAVEMENT MARKING REMOVAL (SQ FT)	SHORT TERM PAVEMENT MARKING REMOVAL (SQ FT)	RAISED REFLECTIVE PAVEMENT MARKERS			RAISED REFLECTIVE PAVEMENT MARKERS REMOVAL (EACH)	
				LINE 4"				LINE 24"	LINE 12"	LINE 12"	LINE 12"		LINE 4"	LINE 4"			CRYSTAL (EACH)	AMBER ONE-WAY (EACH)	AMBER TWO-WAY (EACH)		
				SOLID (FOOT)	SKIP-DASH (FOOT)	SOLID (FOOT)	SKIP-DASH (FOOT)	WHITE STOP BAR (FOOT)	WHITE DIAGONAL (FOOT)	WHITE CROSSWALK (FOOT)	YELLOW DIAGONAL (FOOT)		SKIP-DASH YELLOW (FOOT)	SKIP-DASH WHITE (FOOT)							
US 50/IL 127																					
1000+00	1000+32	32	BOTH			128						15	210	6	6	268	2		2	2	
1000+32	1001+28	96	BOTH	96		192		31					50	18	80	208	17	3	6	9	
1001+28	1002+31	103								660											
1002+31	1002+76	45	BOTH	90				36					42		90	144	15	4		4	
1002+76	1003+37	61	BOTH	122		122		12					67	12	24	173	6	4		4	
1003+37	1004+64	127	BOTH			254							25	24		110	4			8	
1004+64	1005+31	67	BOTH			268									26	90	5		4	4	
1005+31	1052+92	4761		1176		9522	2390			448			1050	1732	92	5861	304			240	
1052+92	1053+50	58	BOTH	116		116								12	10	78	4			4	
1053+50	1055+42	192	BOTH	576		384		24					50	36	114	418	25	5		10	
1055+42	1055+99	57		114											10	38	2				
IL 127																					
1055+99	1056+23	24	BOTH	24											4	8	1				
1056+23	1056+83	60	BOTH	240		120		12					50	22	46	194					
1056+83	1058+58	175	BOTH	552		700								175	64	60	593	21	5	14	
1058+58	1060+84	226	BOTH	452		904								100	84	38	552	21		12	
1060+84	1063+38	254	BOTH	508		1016								100	94	42	608	23		14	
1063+38	1064+98	160	BOTH	320	40	640								45	60	26	379	15		8	
1064+98	1066+18	120	BOTH	360		240		12					134	22	66	358	15	3		6	
1066+18	1066+43	25	BOTH	75				25	35					6	56	110	11	1			
1066+43	1066+73	30	BOTH	30					20							30					
1066+73	1067+08	35																			
1067+08	1067+38	30	BOTH	30					20					6	12	30					
1067+38	1067+53	15	BOTH	15										4	6	5	2	1			
1067+53	1068+12	59	BOTH	550		118		42	191				50	12	22	548	6	2		4	
1068+12	1069+41	129	BOTH	516		258							50	24	68	308	16	8		8	
1069+41	1071+01	160	BOTH	320	80	640								45	60	26	392	15		8	
1071+01	1071+51	50	BOTH	100	13	200								55	20	8	160	5		4	
1071+51	1074+62	311	BOTH	622		1244								150	114	50	772	28		16	
US 50 (NORTH LEG)*																					
3000+00	3002+67	267	BOTH	534		534								50	44	356	16			7	
3002+67	3004+53	186	BOTH	558		372							100	34	30	410	11			10	
3004+53	3005+04	51	BOTH	204		102		45					50	10	108	242	20	2		4	
FRANKLIN ST.																					
4000+00	4002+02	202	BOTH			808						75		74		345	13			12	
4002+02	4003+01	99	BOTH	99		198		32					134	18	82	297	17	3		6	
4003+01	4004+01	100																			
4004+01	4004+43	42	BOTH	80				32					42		80	133	14	4			
4004+43	4005+11	68	BOTH	136		136		12					92	14	50	207	11	4		4	
4005+11	4006+83	172	BOTH			688								65	64	295	11			10	
SUB-TOTALS				8615	133	19904	2390	315	266	1108	825	2196	2722	1350	14720	676	49	102	323	474	
TOTALS				31042				315		2199		2196	4072	14720	676		474				474

* THE EXISTING PAINTED MEDIAN SHALL BE REMOVED AND REPLACED WITH A STANDARD 4" SOLID DOUBLE YELLOW CENTERLINE



P.C.C. RIGHT TURN LANE BEGINS
STA. 1060+44

BUTT JOINT
US 50 STA. 3000+00

IL 127/US 50
STA. 1055+99 = STA. 3005+26

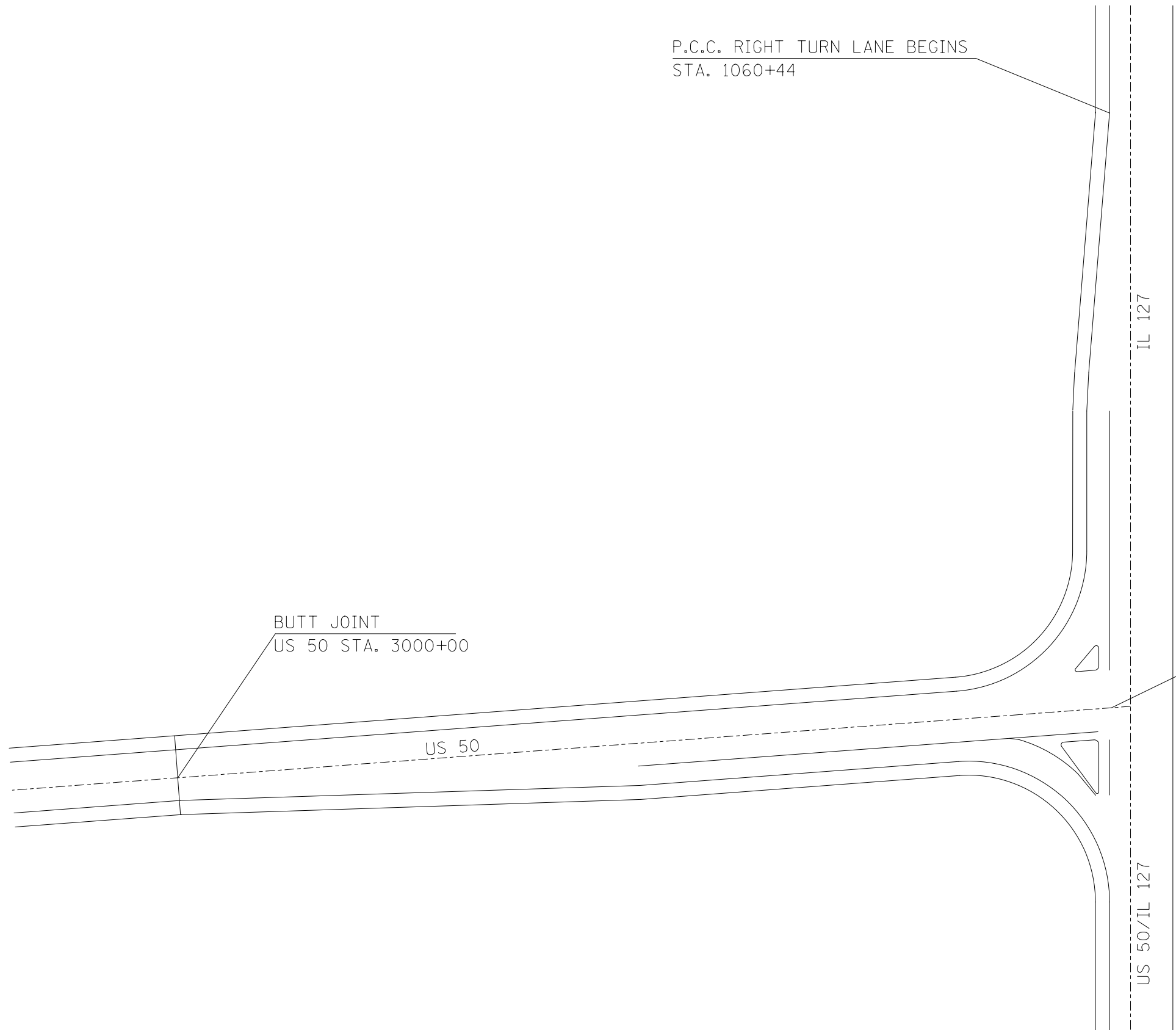

NOT TO SCALE

FILE NAME =	USER NAME = nievesa	DESIGNED -	REVISED -	STATE OF ILLINOIS DEPARTMENT OF TRANSPORTATION	US 50 /IL 127 INTERSECTION DETAIL			F.A.P. RTE.	SECTION	COUNTY	TOTAL SHEETS	SHEET NO.	
pw:\IL\084EBIDINTEG.illinois.gov\PWIDOT\Documents\IDOT Offices\District 8\Projects\0876-DRAWING\0876-DATA\EA0sheets\0876-sht-pln.dgn	PLLOT SCALE = 100.0000' / in.	CHECKED -	REVISED -					327/42	113RS-6, 14-16Z-RS-1	CLINTON	32	14	
	PLOT DATE = 1/25/2016	DATE -	REVISED -		SCALE:			SHEET NO.	OF SHEETS	STA.	TO STA.	CONTRACT NO. 76J06	
												FED. ROAD DIST. NO. ILLINOIS FED. AID PROJECT	

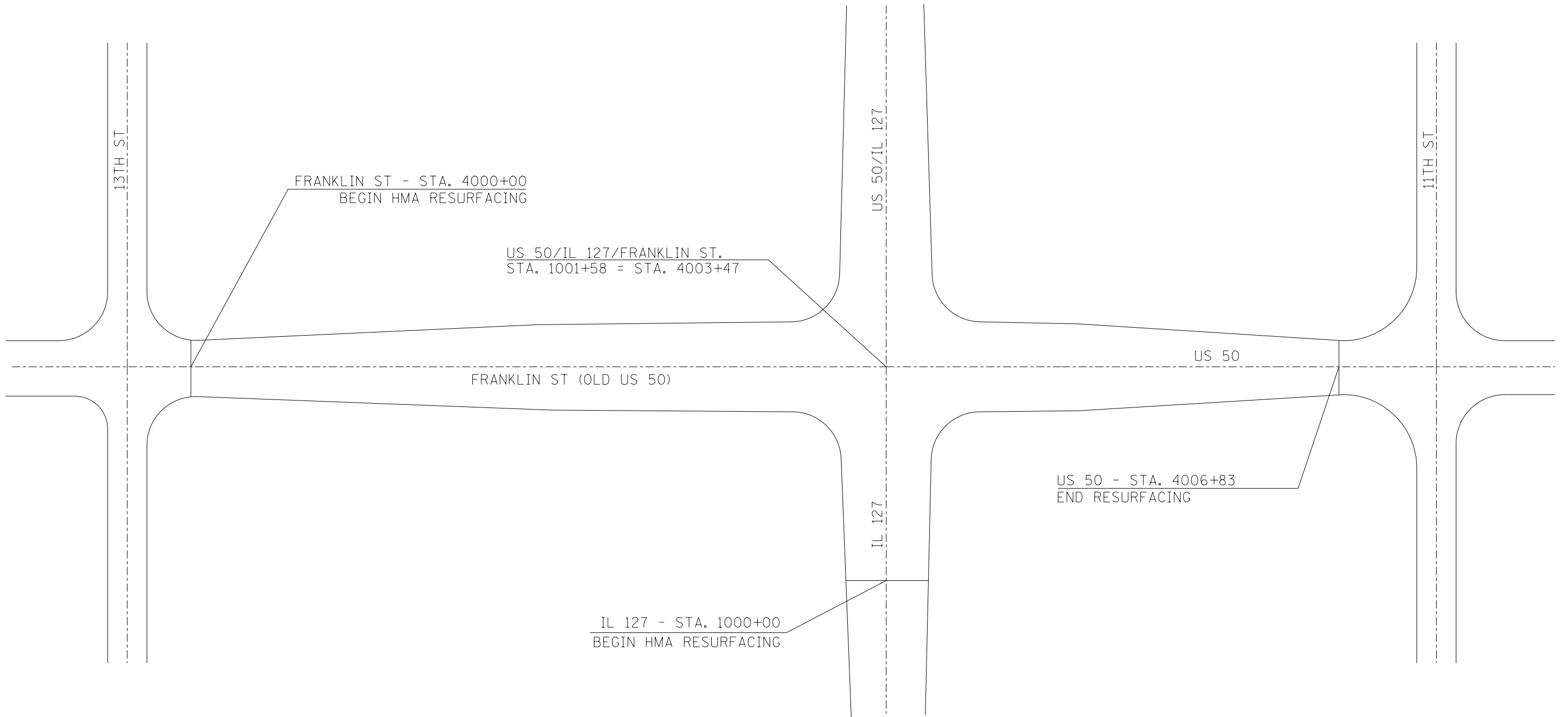

NOT TO SCALE

FILE NAME =	USER NAME = nievesa	DESIGNED -	REVISED -
p:\IL\084EBIDINTEG.illinois.gov\PWIDOT\Documents\DOT Offices\District 8\Projects\0876-DRAWING\084EBIDINTEG\084EBIDINTEG\084EBIDINTEG.dwg		REVISIONS	REVISIONS
	PLOT SCALE = 100.0000' / 1in.	CHECKED -	REVISED -
	PLOT DATE = 1/25/2016	DATE -	REVISED -

**STATE OF ILLINOIS
DEPARTMENT OF TRANSPORTATION**

OLD US 50 /US 50 INTERSECTION DETAIL

SCALE: SHEET NO. OF SHEETS STA. TO STA.

F.A.P. RTE.	SECTION	COUNTY	TOTAL SHEETS	SHEET NO.
327/42	113RS-6, 14-16Z-RS-1	CLINTON	32	15
FED. ROAD DIST. NO. ILLINOIS FED. AID PROJECT			CONTRACT NO. 76J06	

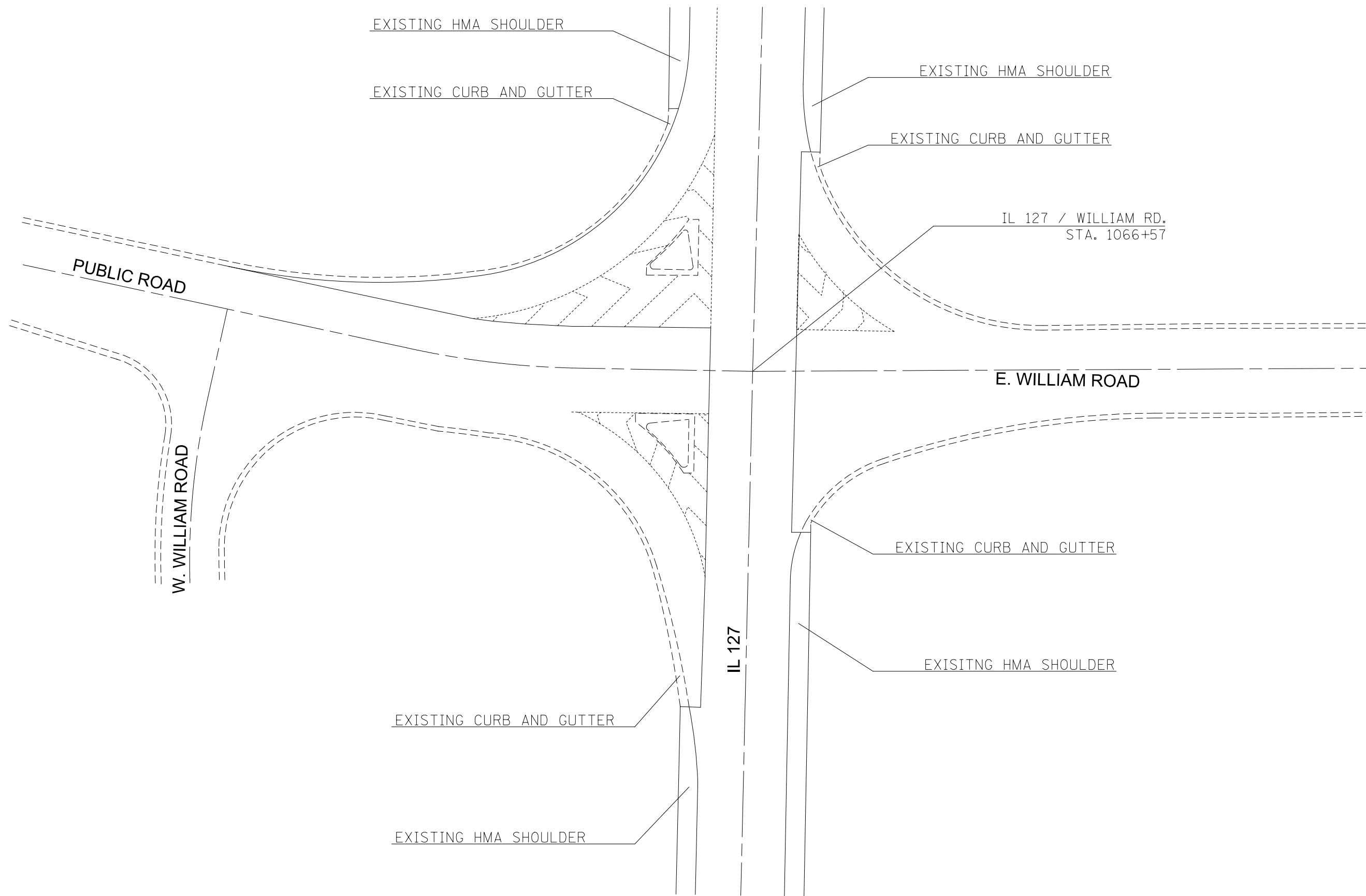

NOT TO SCALE

FILE NAME =	USER NAME = nievesa	DESIGNED -	REVISED -
pw:\IL084EBIDINTEG.illinois.gov\PWIDOT\Documents\IDOT Offices\District 8\Projects\0876-DRAWING\DATA\EA0sheets\0876J06-sht-pln.dgn		DRAWN -	REVISED -
	PLOT SCALE = 100.0000' / 1in.	CHECKED -	REVISED -
	PLOT DATE = 1/25/2016	DATE -	REVISED -

**STATE OF ILLINOIS
DEPARTMENT OF TRANSPORTATION**

L 127 /WILLIAM RD.INTERSECTION DETAIL

SCALE: SHEET NO. 2 OF 3 SHEETS STA. TO STA.

F.A.P. RTE.	SECTION	COUNTY	TOTAL SHEETS	SHEET NO.
327 42	113RS-6, 14-16Z-RS-1	CLINTON	32	16
FED. ROAD DIST. NO. ILLINOIS FED. AID PROJECT			CONTRACT NO. 76J06	

PROPOSED HMA RESURFACING DETAIL

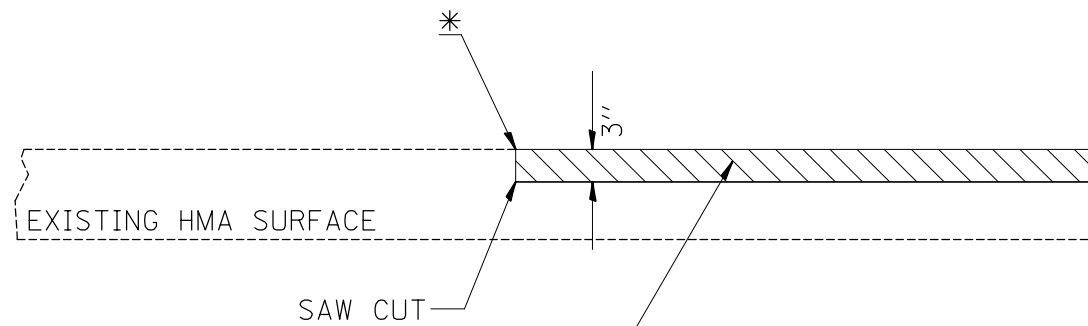

PROPOSED HMA SURFACE REMOVAL
& PROPOSED HMA RESURFACING

- * STA. 1000+00
- STA. 1074+62
- STA. 4000+00
- STA. 4006+83

NOT TO SCALE

PROPOSED HMA BUTT JOINT

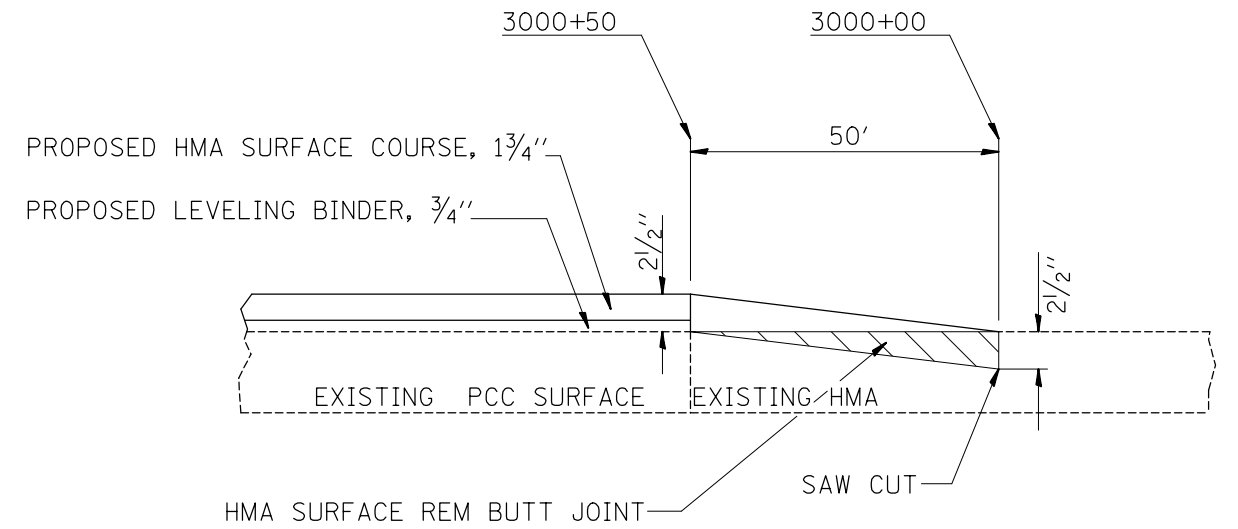

NOT TO SCALE

PROPOSED MILLING TRANSITION DETAIL IN HMA PAVEMENT

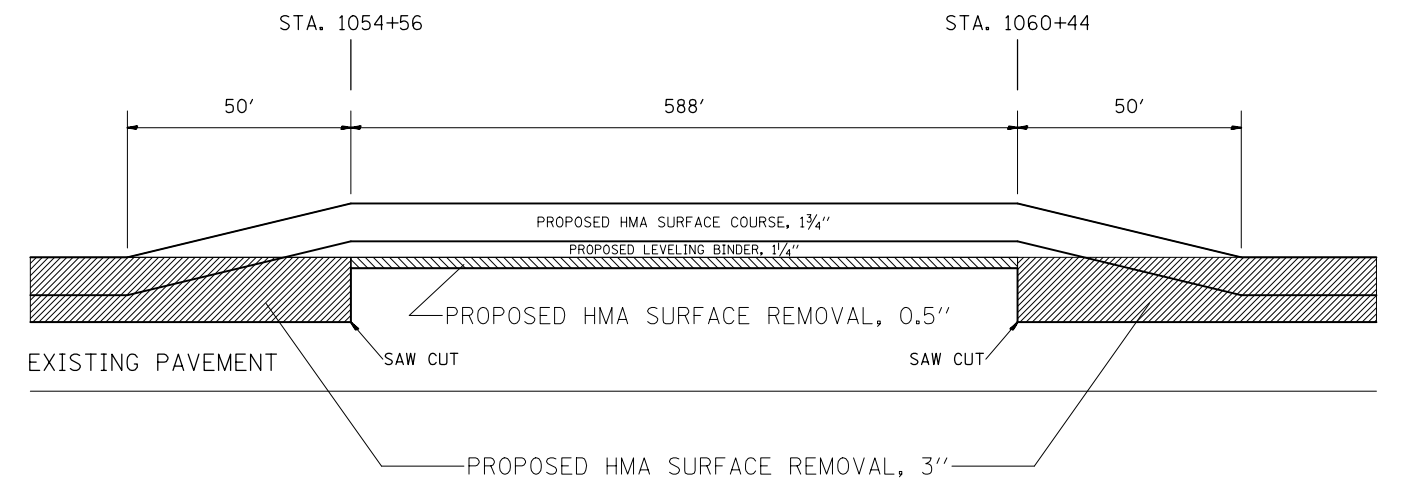

NOT TO SCALE

FILE NAME =	USER NAME = nievesa	DESIGNED -	REVISED -
pw:\IL\084EBIDINTEG.illinois.gov\PIDOT\Documents\DOT Offices\District 8\Projects\0875\DRAWING\EA0sheets\0875-sht-pln.dgn		DRAWN -	REVISED -
		CHECKED -	REVISED -
		DATE -	REVISED -

STATE OF ILLINOIS
DEPARTMENT OF TRANSPORTATION

BUTT JOINT AND RESURFACING DETAILS

SCALE: SHEET NO. OF SHEETS STA. TO STA.

F.A.P. RTE.	SECTION	COUNTY	TOTAL SHEETS	SHEET NO.
327/42	113RS-6, 14-16Z-RS-1	CLINTON	32	18
CONTRACT NO. 76J06				
FED. ROAD DIST. NO. ILLINOIS FED. AID PROJECT				

CURB RAMP SCHEDULE

LOCATION		PORTLAND CEMENT CONCRETE SIDEWALK 4 INCH (SQ FT)	DETECTABLE WARNINGS (SQ FT)	PAVEMENT REMOVAL (SQ YD)	COMBINATION CURB AND GUTTER REMOVAL (FOOT)	SIDEWALK REMOVAL (SQ FT)	INLETS TO BE ADJUSTED (EACH)	COMBINATION CONCRETE CURB AND GUTTER, TYPE B-6,24 (FOOT)	RELOCATE SIGN PANEL - TYPE I (SQ FT)	WOOD SIGN SUPPORT (FOOT)
INTERSECTION	LOCATION									
SOUTH OF MARION	EAST SIDE	33.4	10.0			33.4				
SOUTH OF MARION	WEST SIDE	36.7	10.0			36.7				
NORTH OF RANDOLPH	EAST SIDE	37.7	10.0			37.7				
NORTH OF RANDOLPH	WEST SIDE	43.6	10.0			43.6				
SOUTH OF ABBOTT	EAST SIDE	21.0	10.0			21.0				
SOUTH OF ABBOTT	WEST SIDE	31.8	10.0			31.8				
CLINTON ST	NORTHWEST QUADRANT	191.9	22.2		18.0	161.7		18		
LIVINGSTON ST	NORTHWEST QUADRANT	37.3	18.4		16.5	35.9		16.5		
LIVINGSTON ST	NORTHEAST QUADRANT	130.6	22.3		18.4	136.7		18.4		
JEFFERSON ST	NORTHWEST QUADRANT	135.8	16.9		15.8	119.5		15.8		
JEFFERSON ST	NORTHEAST QUADRANT	329.3	13.3	21.5	52.0	185.4		59.8	6.25	14.5
JEFFERSON ST	SOUTHWEST QUADRANT	147.7	19.9		17.2	116.0		17.2		
JEFFERSON ST	SOUTHEAST QUADRANT	136.6	15.4		15.0	119.1		15		
US 50/FRANKLIN ST	NORTHWEST QUADRANT	167.6	15.8		33.2	155.0	1	33.2		
US 50/FRANKLIN ST	NORTHEAST QUADRANT	152.5	11.5		20.3	152.5		20.3		
US 50/FRANKLIN ST	SOUTHWEST QUADRANT	217.1	25.3		26.7	188.5		26.7		
US 50/FRANKLIN ST	SOUTHEAST QUADRANT	228.4	9.9		33.3	208.0	1	33.3		
	SUBTOTAL	2079.0	250.9	21.5	266.4	1782.5	2	274.2	6.25	14.5
	TOTAL	2079	251	22	267	1783	2	275	7	15

BY: Brian R. Mueller DATE: 01-14-2016

EXPIRES 11-30-2017

APPLIES TO PLAN SHEETS: 20-29

CONSULTING ENGINEERS



LOCHMUELLER GROUP

1928 S/A BRADLEY R. SMITH DRIVE
TROY, ILLINOIS 62294
PHONE (618) 667-1400

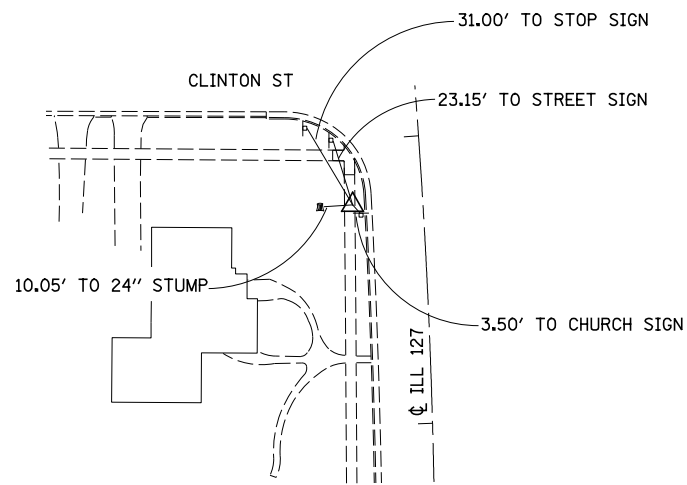

CONTROL POINT #1
N 5000.00 E 5000.00

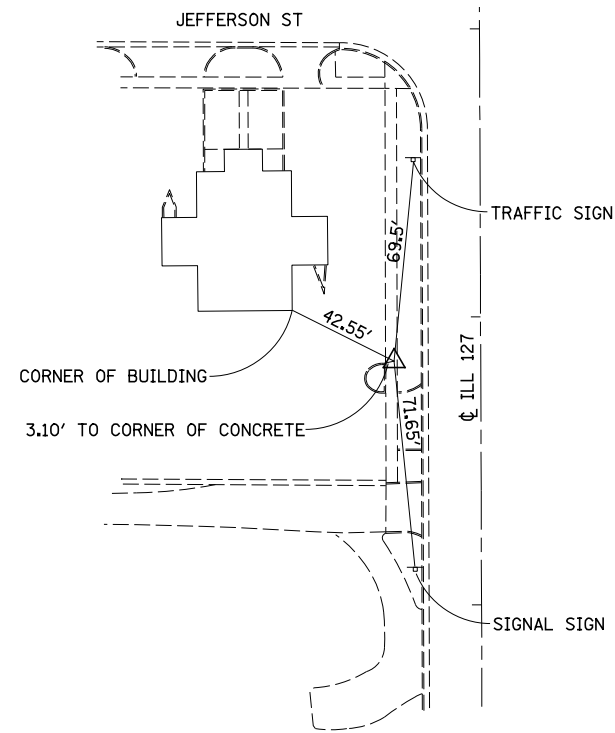

CONTROL POINT #3
N 4208.76 E 5000.96

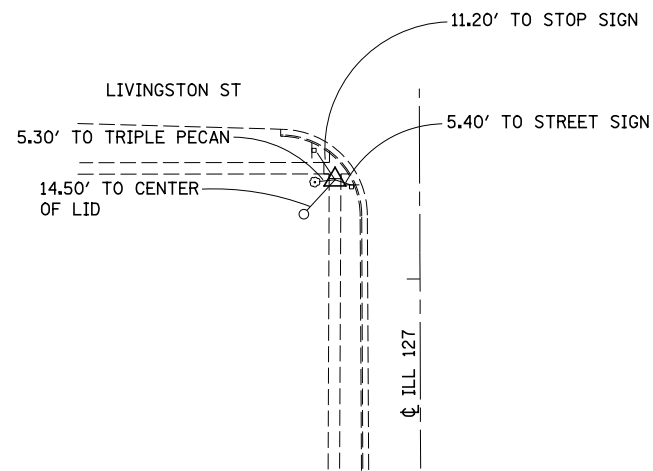

CONTROL POINT #2
N 4658.62 E 5000.00

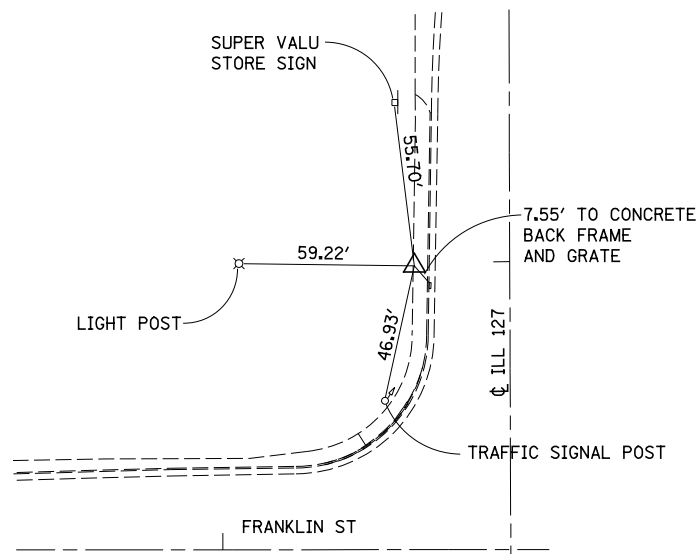

CONTROL POINT #4
N 3722.73 E 4999.66

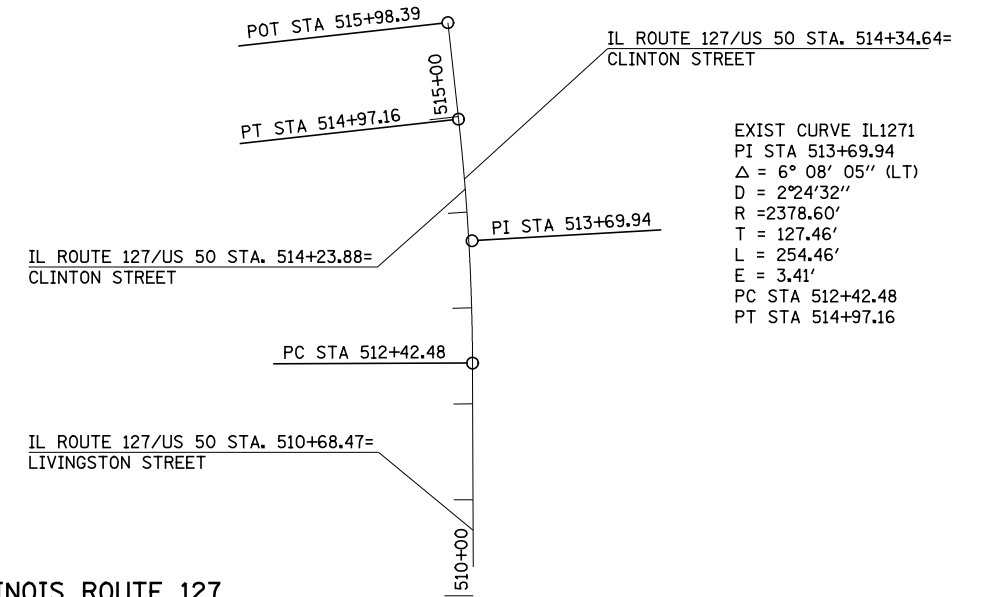

ILLINOIS ROUTE 127

DESCRIPTION	COORDINATE	
	NORTHING	EASTING
POT STA 498+00.00	3424.17	5033.86
PC STA 512+42.48	4866.65	5028.66
PI STA 513+69.94	4994.11	5028.20
PT STA 514+97.16	5120.79	5014.12
POT STA 515+98.39	5221.39	5002.94

US 50 (FRANKLIN STREET)

DESCRIPTION	COORDINATE	
	NORTHING	EASTING
POT STA 195+89.89	3623.94	4623.04
POT STA 204+10.10	3624.40	5443.24

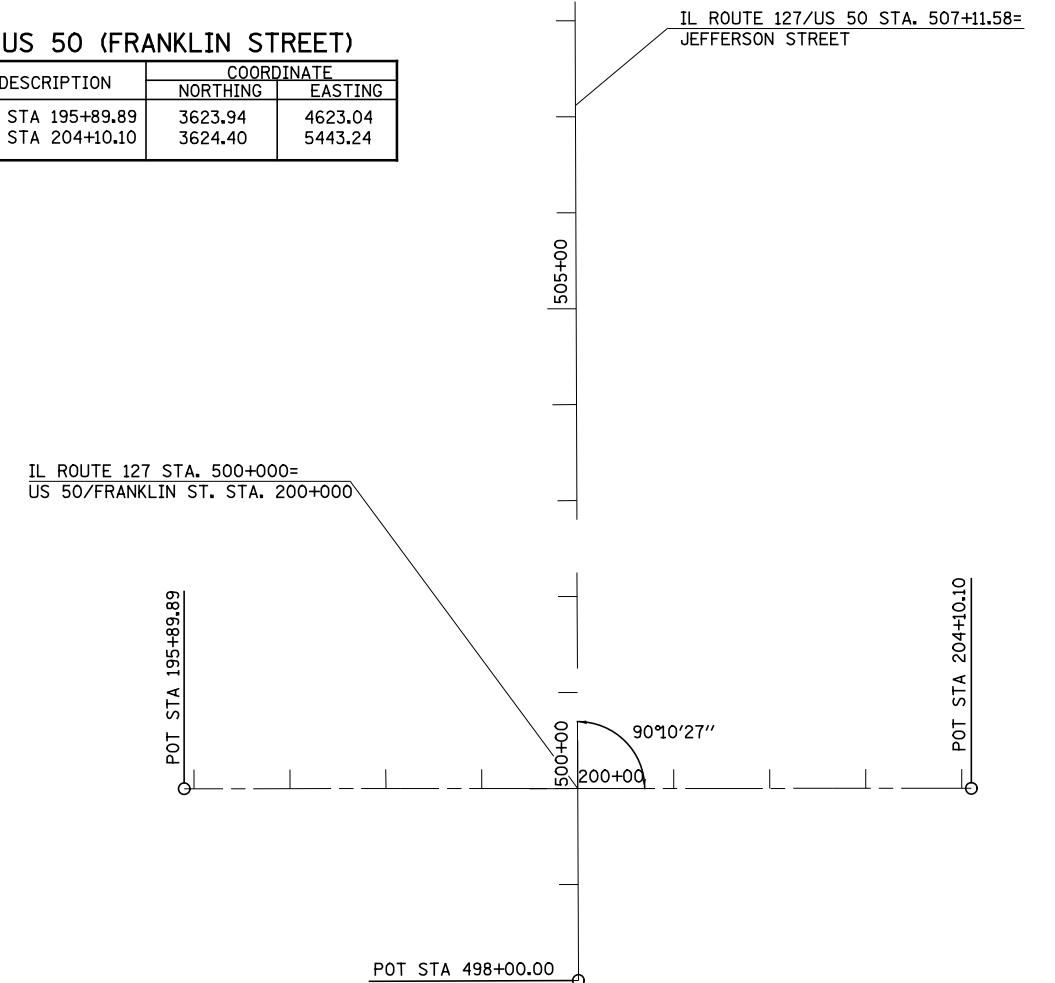

EXIST CURVE IL1271
PI STA 513+69.94
Δ = 6° 08' 05" (LT)
D = 2°24'32"
R = 2378.60'
T = 127.46'
L = 254.46'
E = 3.41'
PC STA 512+42.48
PT STA 514+97.16

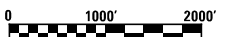

USER NAME = betsy	DESIGNED - ESW	REVISED -
	DRAWN - LEC	REVISED -
PLOT SCALE = 200.0000' / in.	CHECKED - BRM	REVISED -
PLOT DATE = 1/11/2016	DATE - 1-20-15	REVISED -

**STATE OF ILLINOIS
DEPARTMENT OF TRANSPORTATION**

ALIGNMENT SHEET

SCALE: SHEET 1 OF 1 SHEETS STA. TO STA.

F.A.P. RTE.	SECTION	COUNTY	TOTAL SHEETS	SHEET NO.
42/327	113RS-6, 14-16Z-RS-1	CLINTON	32	21
CONTRACT NO. 76J06			ILLINOIS FED. AID PROJECT	

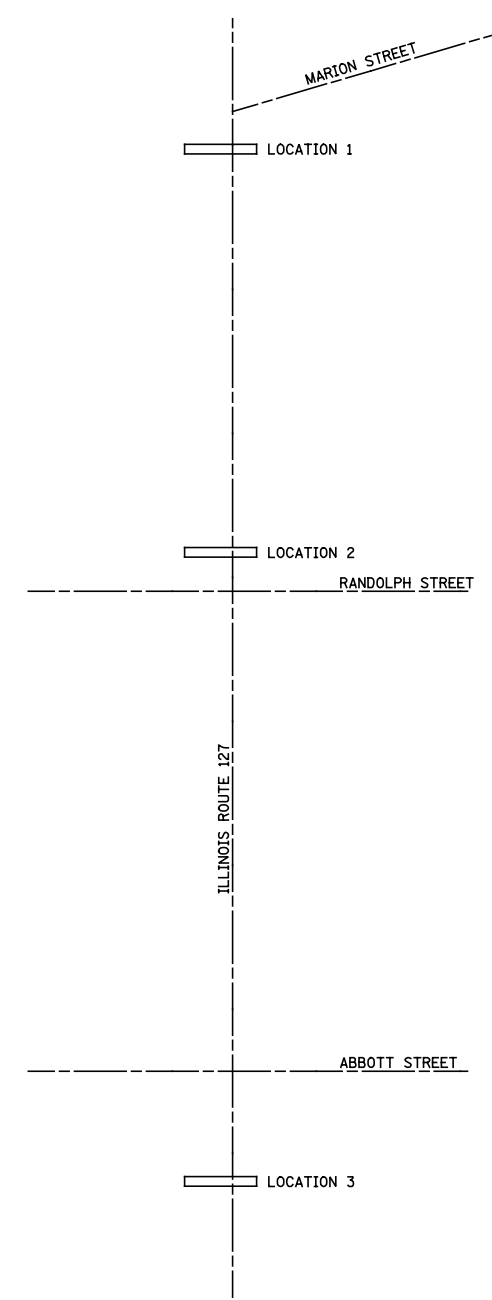
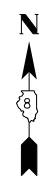

LOCATION MAP
(NOT TO SCALE)

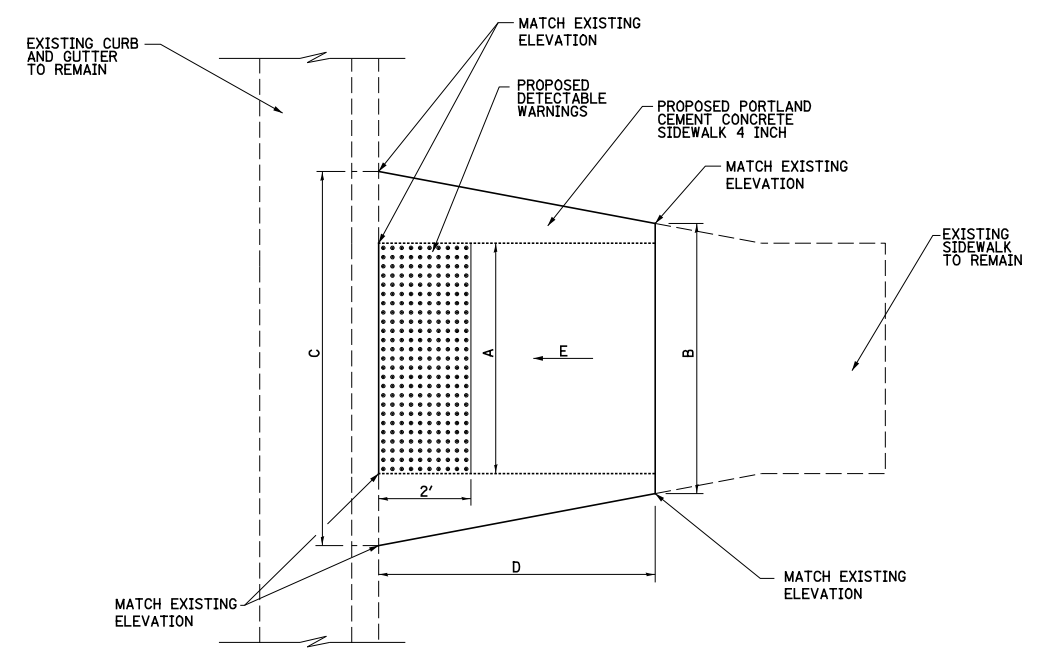

MID-BLOCK CURB RAMP DETAIL

	CROSS STREET	RAMP WIDTH (A)	SIDEWALK WIDTH (B)	CURB OPENING (C)	RAMP LENGTH (D)	SLOPE (E)
LOCATION 1	EAST, SOUTH OF MARION STREET	5.00	6.25	7.83	4.75	6.3%
LOCATION 1	WEST, SOUTH OF MARION STREET	5.00	6.67	8.00	5.00	1.7%
LOCATION 2	EAST, NORTH OF RANDOLPH STREET	5.00	6.83	8.25	5.00	4.4%
LOCATION 2	WEST, NORTH OF RANDOLPH STREET	5.00	6.25	8.08	6.08	2.0%
LOCATION 3	EAST, SOUTH OF ABBOTT STREET	5.00	6.00	8.00	3.00	-4.6%
LOCATION 3	WEST, SOUTH OF ABBOTT STREET	5.00	5.00	8.17	4.83	-1.8%

NOTE:
MID-BLOCK CROSSINGS WERE NOT SURVEYED,
DIMENSIONS TAKEN FROM FIELD MEASUREMENTS.



USER NAME = betsy	DESIGNED - ESW	REVISED -
	DRAWN - PDB	REVISED -
PLOT SCALE = 40.0000' / in.	CHECKED - BRM	REVISED -
PLOT DATE = 1/11/2016	DATE - 1-19-15	REVISED -

STATE OF ILLINOIS
DEPARTMENT OF TRANSPORTATION

MID-BLOCK CROSSING
TYPICAL APPLICATION DETAIL

SCALE: 1"=20' SHEET NO. 1 OF 1 SHEETS STA. TO STA.

F.A.P. RTE.	SECTION	COUNTY	TOTAL SHEETS	SHEET NO.
42/327	113RS-6, 14-16Z-RS-1	CLINTON	32	22
CONTRACT NO. 76J06			ILLINOIS FED. AID PROJECT	

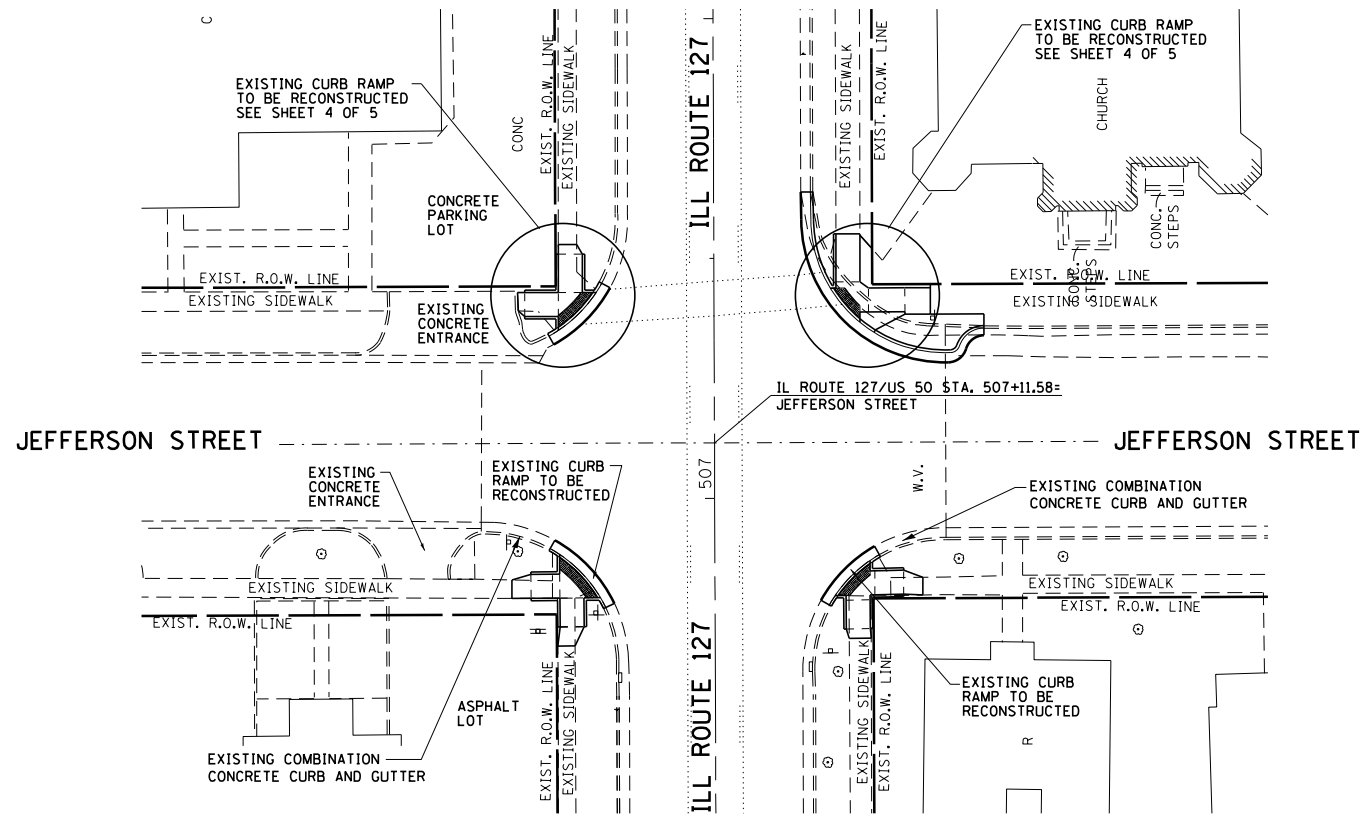

NOTE:
ALL STATIONS AND OFFSETS
ARE FROM ILL ROUTE 127

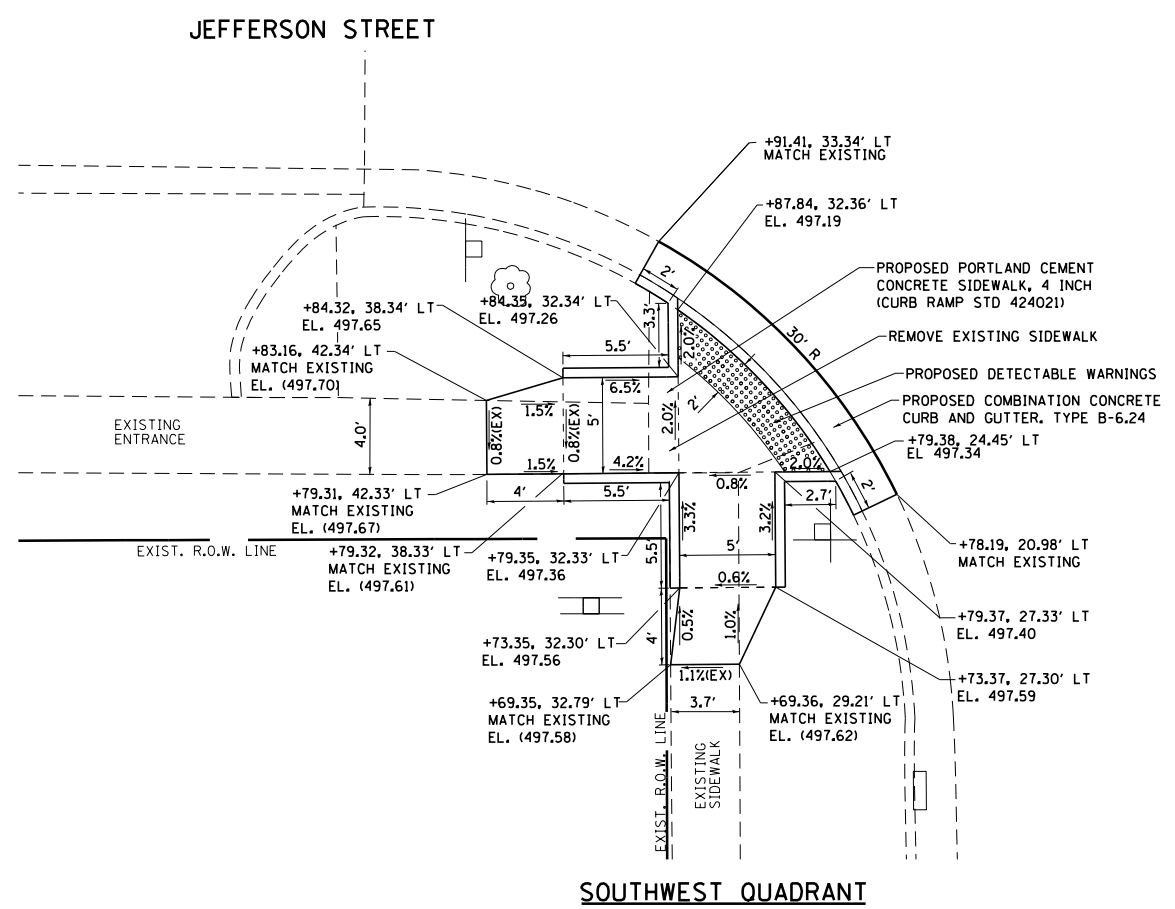
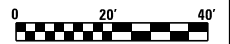

SOUTHWEST QUADRANT

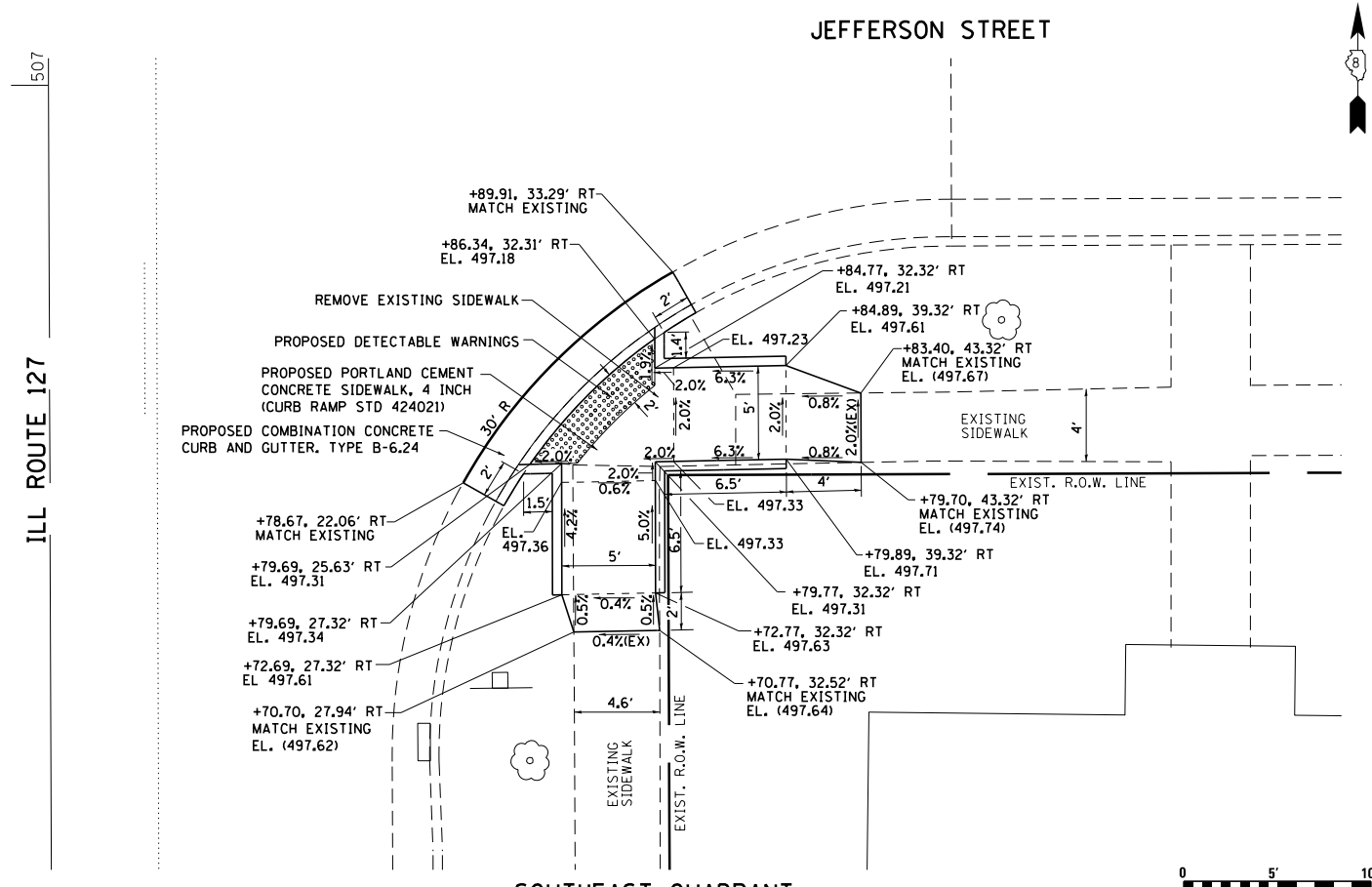

SOUTHEAST QUADRANT



USER NAME = betsy	DESIGNED - ESW	REVISED -
PLOT SCALE = 48.0000' / in.	DRAWN - PDB	REVISED -
PLOT DATE = 1/14/2016	CHECKED - BRM	REVISED -
	DATE - 1-19-15	REVISED -

**STATE OF ILLINOIS
DEPARTMENT OF TRANSPORTATION**

**CURB RAMP DETAILS
JEFFERSON STREET**

SCALE: SHEET NO. 3 OF 5 SHEETS STA. TO STA.

F.A.P. RTE.	SECTION	COUNTY	TOTAL SHEETS	SHEET NO.
42/327	113RS-6, 14-162-RS-1	CLINTON	32	25
CONTRACT NO. 76J06			ILLINOIS FED. AID PROJECT	

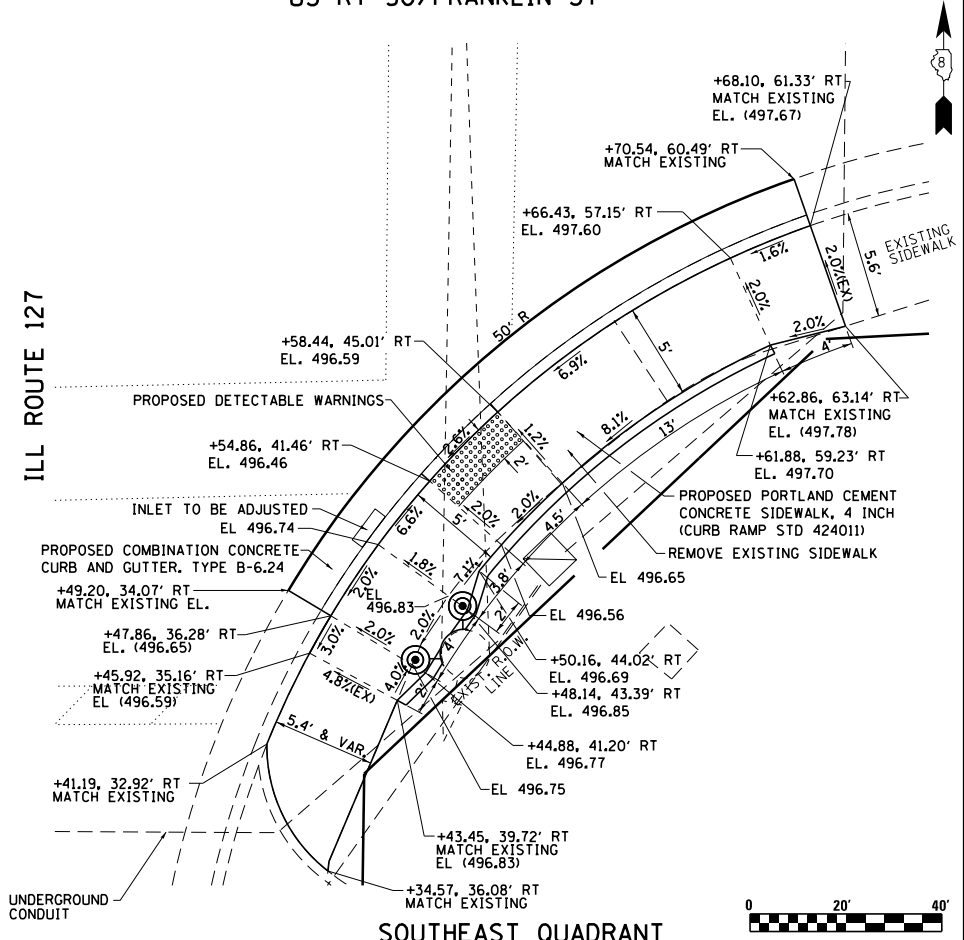
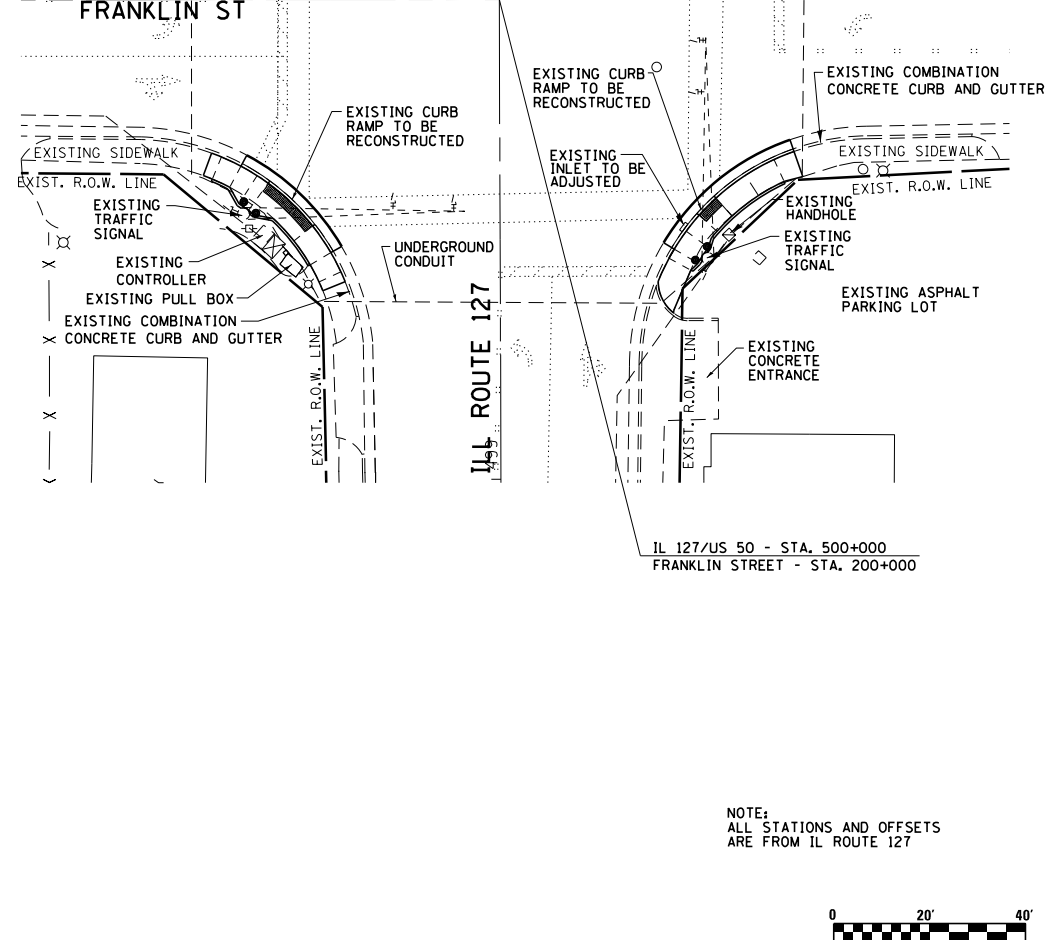
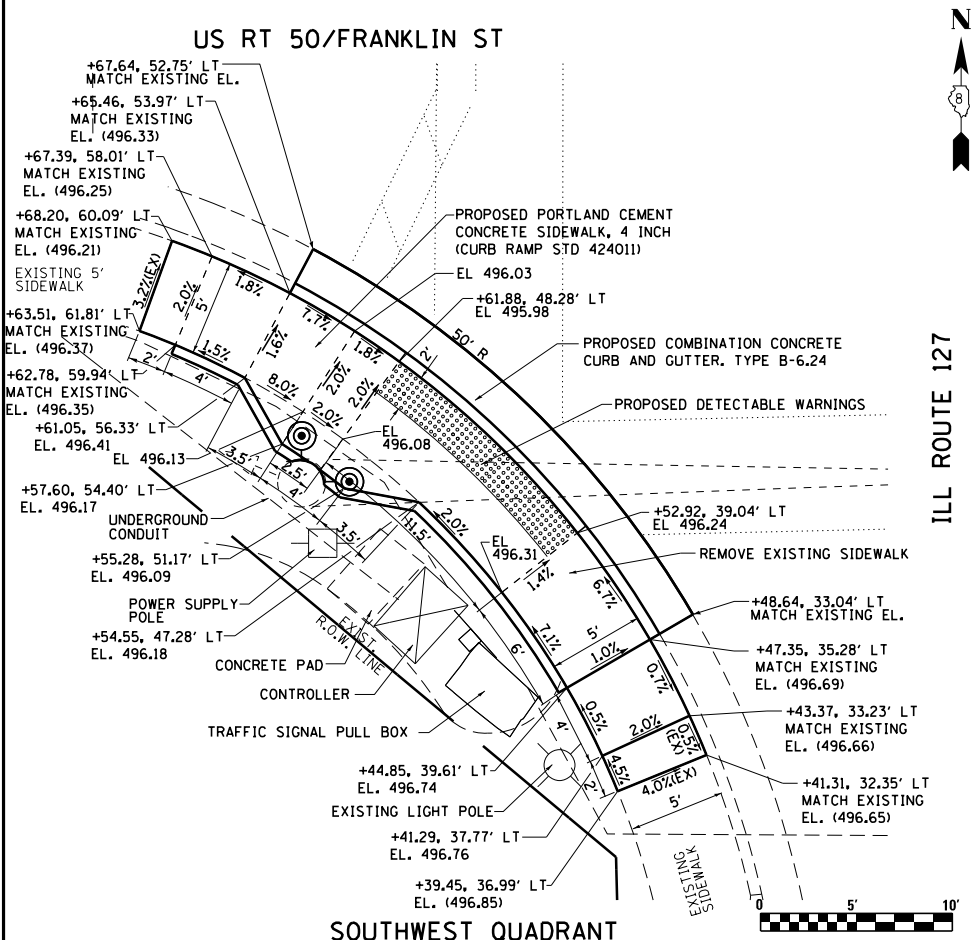
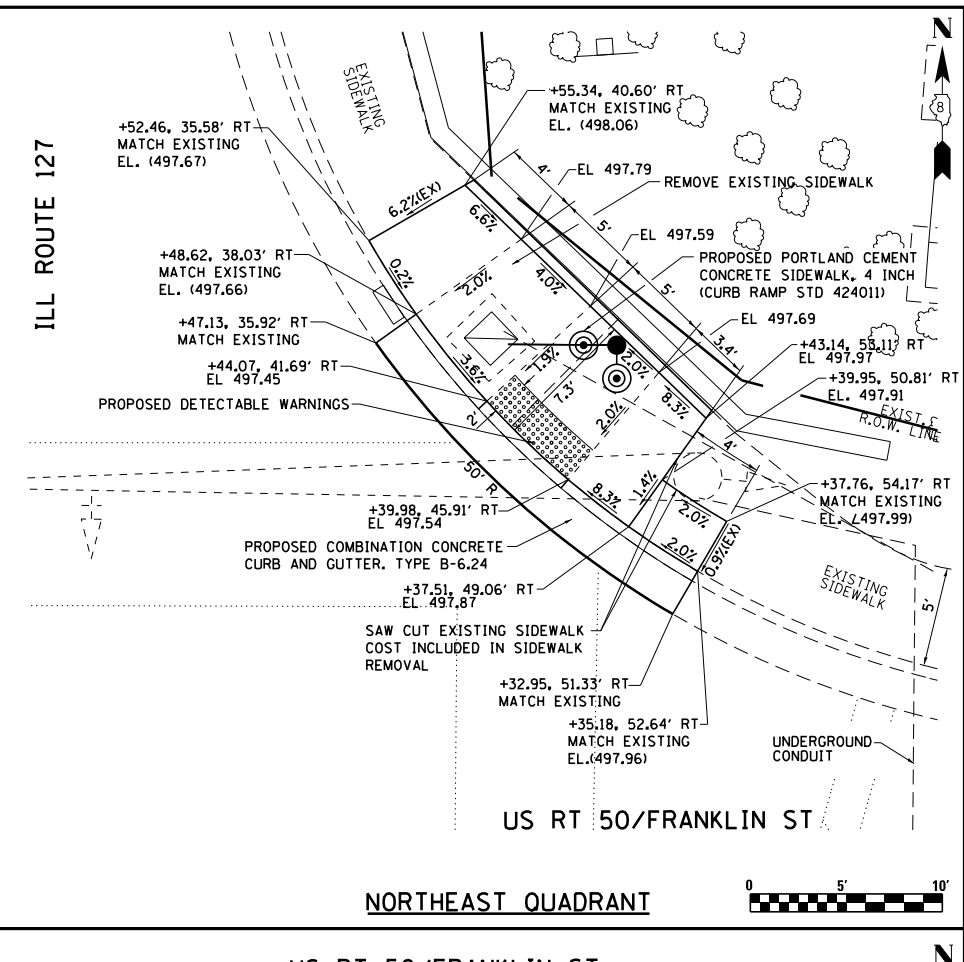
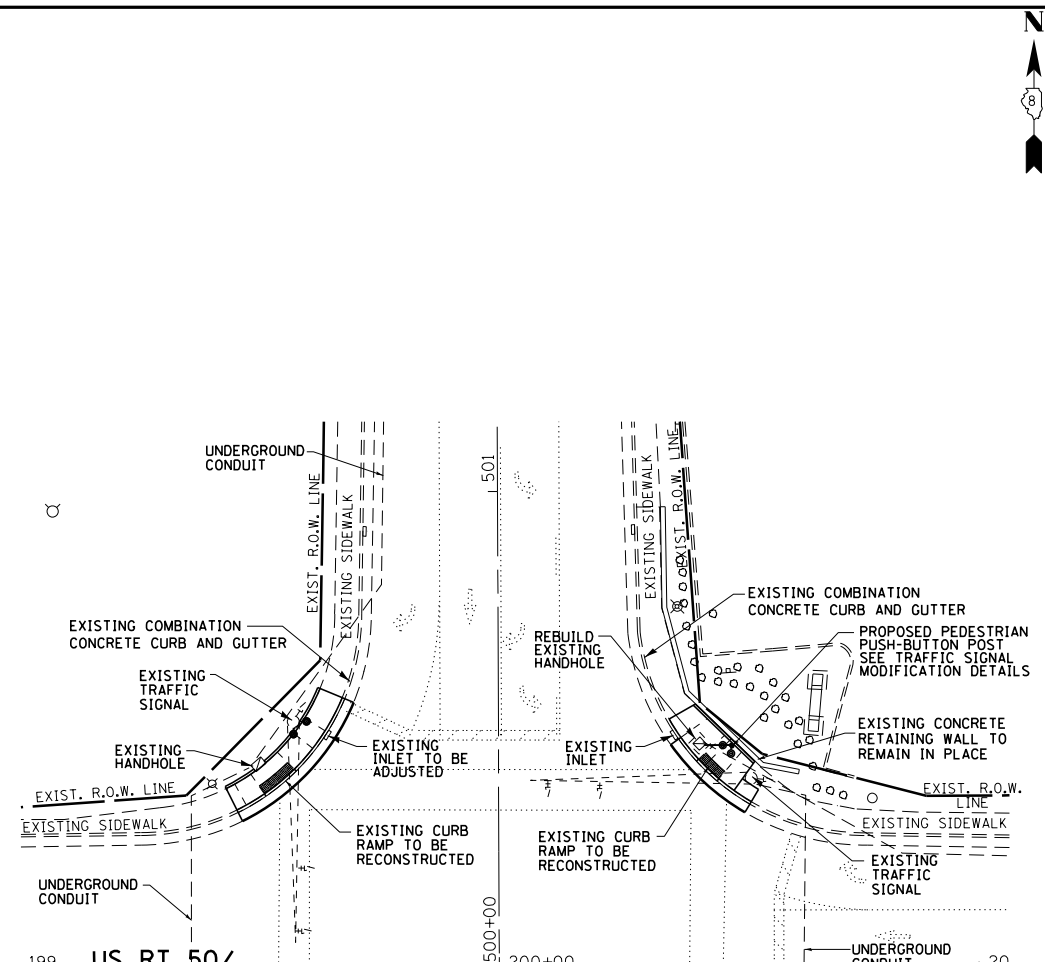
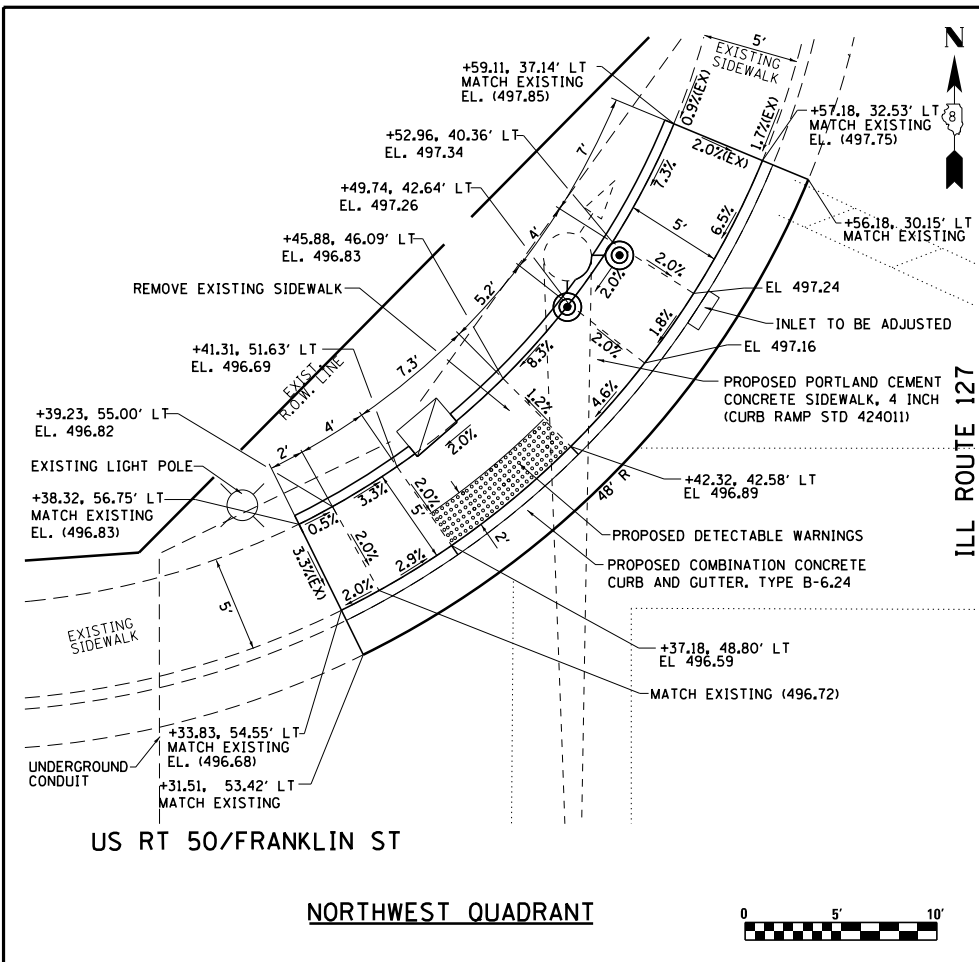

USER NAME = betsy	DESIGNED - ESW	REVISED -
PLOT SCALE = 48.0000' / in.	DRAWN - PDB	REVISED -
PLOT DATE = 1/14/2016	CHECKED - BRM	REVISED -
	DATE - 1-19-15	REVISED -

**STATE OF ILLINOIS
DEPARTMENT OF TRANSPORTATION**

**CURB RAMP DETAILS
US ROUTE 50 /FRANKLIN STREET**

SCALE: SHEET NO. 5 OF 5 SHEETS STA. TO STA.

F.A.P. RTE. 42/327	SECTION 113RS-6, 14-162-RS-1	COUNTY CLINTON	TOTAL SHEETS 32	SHEET NO. 27
				CONTRACT NO. 76J06
ILLINOIS FED. AID PROJECT				

SCHEDULE OF QUANTITIES			TOTAL QUANTITIES	IL 127 & US ROUTE 50 NORTHWEST QUADRANT	IL 127 & US ROUTE 50 NORTHEAST QUADRANT	IL 127 & US ROUTE 50 SOUTHWEST QUADRANT	IL 127 & US ROUTE 50 SOUTHEAST QUADRANT
CODE NO	ITEM	UNIT					
81028350	UNDERGROUND CONDUIT, PVC, 2" DIA.	FOOT	7		7		
87301215	ELECTRIC CABLE IN CONDUIT, SIGNAL NO. 14 2C	FOOT	283		283		
87600100	PEDESTRIAN PUSH-BUTTON POST, TYPE I	EACH	1		1		
87900200	DRILL EXISTING HANDHOLE	EACH	1		1		
88800100	PEDESTRIAN PUSH-BUTTON	EACH	8	2	2	2	2
89502350	REMOVE AND REINSTALL ELECTRIC CABLE FROM CONDUIT	FOOT	283		283		
89502375	REMOVE EXISTING TRAFFIC SIGNAL EQUIPMENT	EACH	8	2	2	2	2
89502376	REBUILD EXISTING HANDHOLE	EACH	1		1		

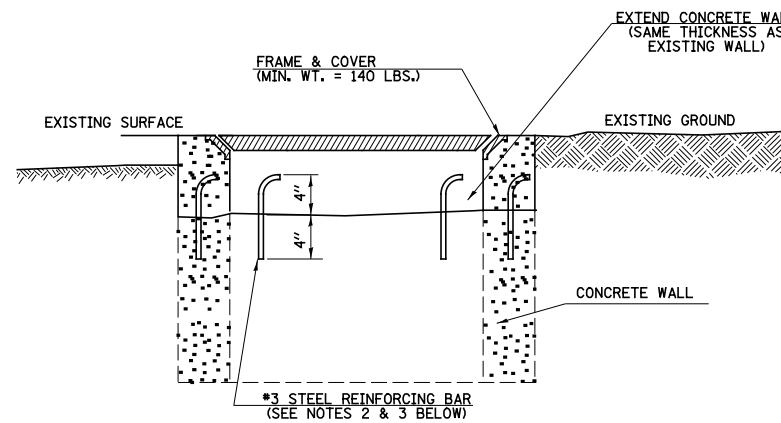

DETAIL
REBUILD EXISTING HANDHOLE

NOTES:

1. REMOVE EXISTING FRAME AND COVER.
2. DRILL CONCRETE WALL (8 LOCATIONS EQUALLY SPACED & CENTERED)
3. INSTALL REBAR AND GROUT.
4. RAISE/LOWER ELEVATION OF CONCRETE WALLS SO THAT THE TOP OF THE INSTALLED FRAME AND COVER WILL BE THE SAME GRADE AS THE TOP OF THE PROPOSED GRADE.
5. THIS DETAIL TO BE USED IN CONJUNCTION WITH STANDARD 814001, GENERAL NOTES AND THE SPECIAL PROVISIONS "REBUILD EXISTING HANDHOLE".
6. THE CONTRACTOR SHALL BE RESPONSIBLE FOR DAMAGE THAT MAY OCCUR TO THE EXISTING CABLES.



USER NAME = betsy	DESIGNED - ESW	REVISED -
	DRAWN - PDB	REVISED -
PLOT SCALE = 40.0000' / in.	CHECKED - BRM	REVISED -
PLOT DATE = 1/11/2016	DATE - 2-19-15	REVISED -

STATE OF ILLINOIS
DEPARTMENT OF TRANSPORTATION

TRAFFIC SIGNAL MODIFICATION DETAILS

SCALE: SHEET 1 OF 2 SHEETS STA. TO STA.

F.A.P. RTE.	SECTION	COUNTY	TOTAL SHEETS	SHEET NO.
42/327	113RS-6, 14-16Z-RS-1	CLINTON	32	28
CONTRACT NO. 76J06			ILLINOIS FED. AID PROJECT	

NOTES:

SEE TABLE "DETECTOR LOOP REQUIREMENTS AND CALCULATIONS" FOR LOOP SIZE AND CALCULATED NUMBER OF TURNS.

SEE "DETAIL A" FOR INSTALLING DETECTOR LOOP WIRES IN EXISTING CONDUITS.

SCHEDULE OF QUANTITIES			TOTAL QUANTITIES	IL 127 & E. WILLIAMS ST.	IL 127 (US 50) & FRANKLIN ST.
CODE NO.	ITEM	UNIT			
80300100	LOCATING UNDERGROUND CABLE	FOOT	110	40	70
88600600	DETECTOR LOOP REPLACEMENT	FOOT	3102	962	2140

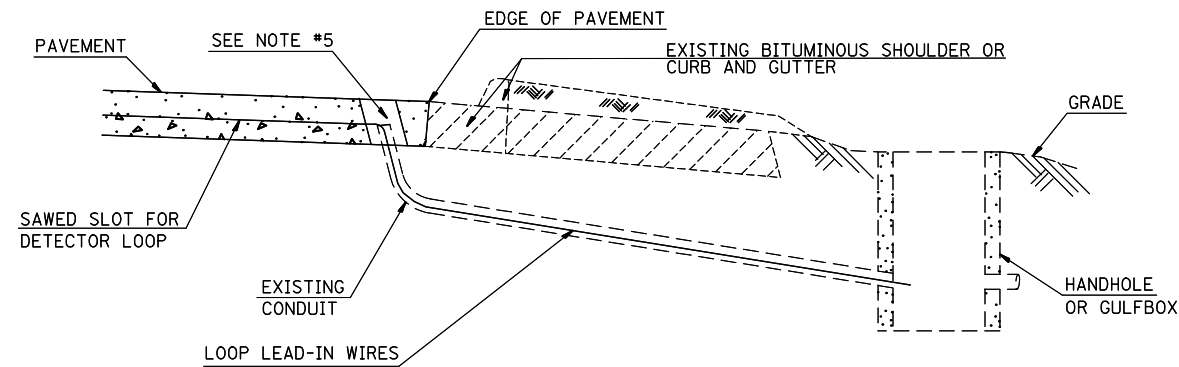

DETAIL A
(NO SCALE)

INSTALLING DETECTOR LOOP WIRES IN EXISTING CONDUIT

1. DRILL OUT PAVEMENT SEALANT AND CLEAN EXISTING CONDUIT.
2. REMOVE EXISTING DETECTOR LOOP WIRES TO HANDHOLE OR GULFBOX.
3. INSTALL NEW LOOP LEAD-IN WIRES IN EXISTING CONDUIT.
4. SPLICE NEW DETECTOR LOOP WIRES TO EXISTING LOOP LEAD-IN CABLE IN HANDHOLE OR GULFBOX.
5. FILL HOLE WITH APPROVED SEALER. PREVENT SEALER FROM ENTERING INTO CONDUIT.
6. LOCATING UNDERGROUND CABLE WILL BE PAID FOR SEPARATELY.

NOT A PAY ITEM. THE COST OF THIS WORK SHALL BE INCLUDED IN THE PAY ITEM "DETECTOR LOOP REPLACEMENT"

DETECTOR LOOP REPLACEMENT LEGEND

- EX. HANDHOLE
- EX. DETECTOR LOOP
- EX. TRAFFIC SIGNAL CONTROLLER
- EXISTING CONDUIT
- PROPOSED DETECTOR LOOP

FILE NAME =	USER NAME = nievesa	DESIGNED -	REVISED -	STATE OF ILLINOIS DEPARTMENT OF TRANSPORTATION	DETECTOR LOOP REPLACEMENT PLAN GENERAL NOTES, SCHEDULE OF QUANTITIES, DETAIL AND LEGEND	F.A.P. RTE.	SECTION	COUNTY	TOTAL SHEETS	SHEET NO.	
pw:\IL\084EBIDINTEG\illinois.gov\PWIDOT\Documents\DOT Offices\District 8\Projects\0876\DRAWING\084EBIDINTEG\084EBIDINTEG.dwg	DESIGNED BY =	REVISIONS	REVISED -			327	113RS-6, 14-16Z-RS-1	CLINTON	32	30	
	PLOT SCALE = 100.0000' / 1in.	CHECKED -	REVISED -			CONTRACT NO. 76J06					
	PLOT DATE = 1/25/2016	DATE -	REVISED -			SCALE:	SHEET NO. 1 OF 3 SHEETS	STA.	TO STA.	FED. ROAD DIST. NO.	ILLINOIS FED. AID PROJECT

LOOP#	PHASE #	LOOP SIZE (FT. X FT.)	REQUIRED # OF TURNS	CALCULATED INDUCTANCE MICROHENRIES	CALCULATED RESISTANCE OHMS
1. EB LT CD	7	6 x 50(Q)	3-6-3	836.6	2.7
2. EB THRU CD	4	6 x 50(Q)	3-6-3	833.7	2.7
3. EB RT CD	OLB	6 x 50(Q)	3-6-3	832.0	2.6
4. NB CCO	6	6 x 6	6	373.9	3.1
5. NB LT CD	5	6 x 50(Q)	3-6-3	850.3	3.1
6. NB THRU CD	6	6 x 50(Q)	3-6-3	847.2	3.0
7. WB LT CD	3	6 x 50(Q)	6	849.6	3.0
8. WB THRU CD	8	6 x 50(Q)	3-6-3	846.7	3.0
9. WB RT CD	8	6 x 50(Q)	3-6-3	846.3	3.0
10. SB CCO	5	6 x 6	6	322.9	1.9
11. SB LT CD	2	6 x 50(Q)	3-6-3	804.9	2.0
12. SB THRU CD	2	6 x 50(Q)	3-6-3	802.3	2.0
13. SB RT CD	OLA	6 x 50(Q)	3-6-3	797.7	1.9

THE ABOVE VALUES ARE CALCULATED OF COMBINED LOOP AND LEAD-IN INDUCTANCE AND RESISTANCE. ACTUAL MEASURED VALUES SHOULD BE WITHIN +/- 20% OF THESE VALUES.

Q=QUADRAPOLE

⊛=SEE DETAIL "A"

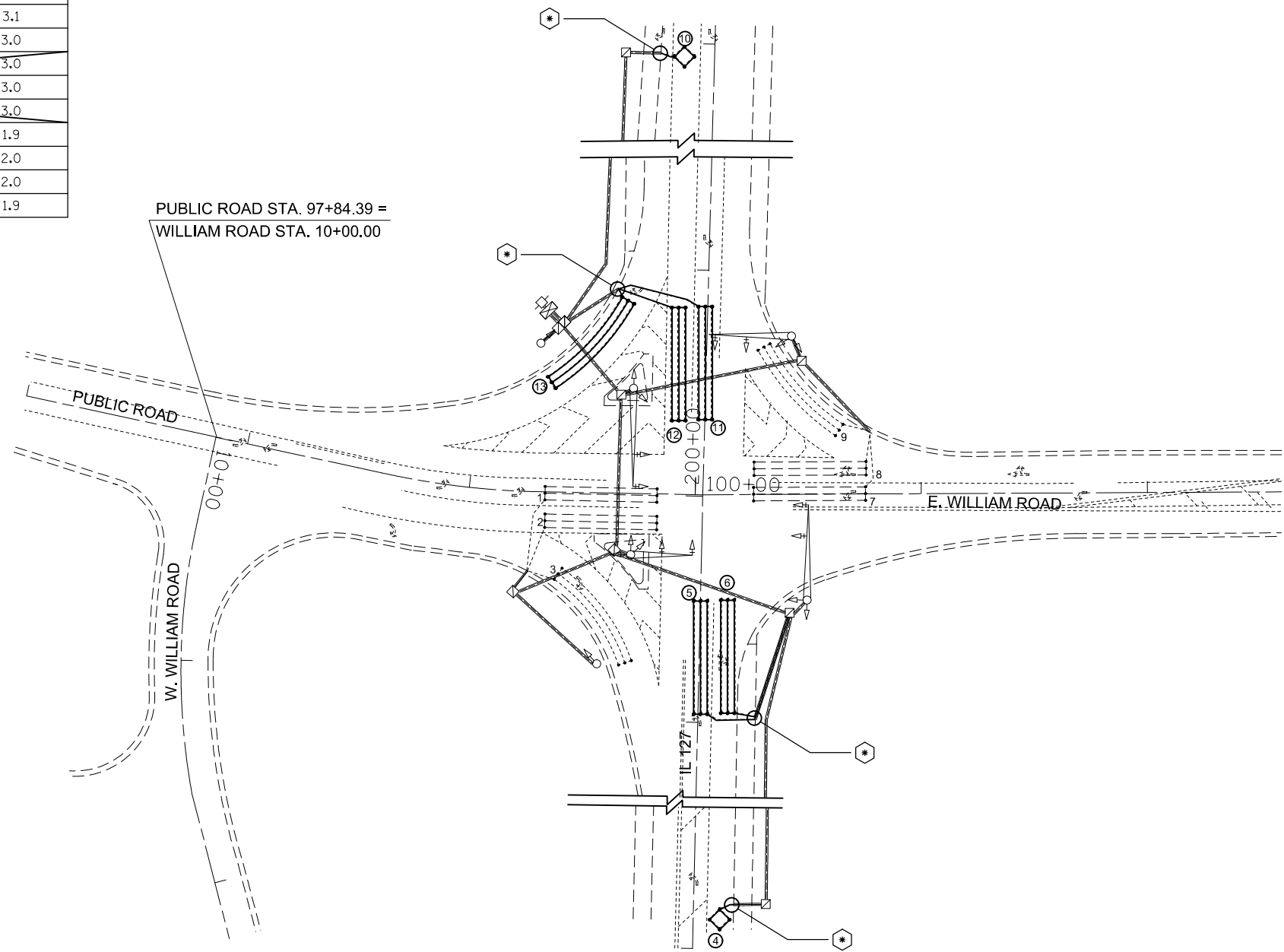

IL 127 & E. WILLIAM RD.



FILE NAME =	USER NAME = nievesa	DESIGNED -	REVISED -	STATE OF ILLINOIS DEPARTMENT OF TRANSPORTATION	DETECTOR LOOP REPLACEMENT PLAN IL 127 & E. WILLIAM RD.	F.A.P. RTE.	SECTION	COUNTY	TOTAL SHEETS	SHEET NO.
pw\11084EBIDINTEG.illinois.gov\PIDOT\Documents\IDOT Offices\District 8\Projects\0876\DRAWING\EA\Sheets\d876J06-ts-plan.dwg	PLOT SCALE = 64.5383' / in.	CHECKED -	REVISED -			327 42	113RS-6, 14-16Z-RS-1	CLINTON	32	31
PLOT DATE = 1/25/2016	DATE -	REVISED -				CONTRACT NO. 76J06		FED. ROAD DIST. NO. ILLINOIS FED. AID PROJECT		

LOOP#	PHASE #	LOOP SIZE (FT. X FT.)	REQUIRED # OF TURNS	CALCULATED INDUCTANCE MICROHENRIES	CALCULATED RESISTANCE OHMS
1. EB CCO	2	6 x 6	6	305.9	1.5
2. EB LT CD	5	6 x 50(Q)	3-6-3	800.5	1.9
3. EB THRU CD	2	6 x 50(Q)	3-6-3	797.9	1.9
4. NB CCO	8	6 x 6	6	327.3	2.0
5. NB LT CD	3	6 x 50(Q)	3-6-3	823.0	2.4
6. NB RT CD	8	6 x 50(Q)	3-6-3	820.8	2.4
7. WB CCO	6	6 x 20	6	646.4	2.9
8. WB LT CD	1	6 x 50(Q)	3-6-3	852.9	3.1
9. WB THRU CD	6	6 x 50(Q)	3-6-3	849.8	3.0
10. WB RT CD	6	6 x 50(Q)	3-6-3	846.5	3.0
11. SB CCO	4	6 x 15	6	525.0	2.4
12. SB LT CD	7	6 x 50(Q)	3-6-3	830.9	2.6
13. SB THRU CD	4	6 x 50(Q)	3-6-3	827.8	2.5
14. SB RT CD	4	6 x 50(Q)	3-6-3	822.5	2.4

THE ABOVE VALUES ARE CALCULATED OF COMBINED LOOP AND LEAD-IN INDUCTANCE AND RESISTANCE. ACTUAL MEASURED VALUES SHOULD BE WITHIN +/- 20% OF THESE VALUES.

Q=QUADRAPOLE
 * =SEE DETAIL "A"

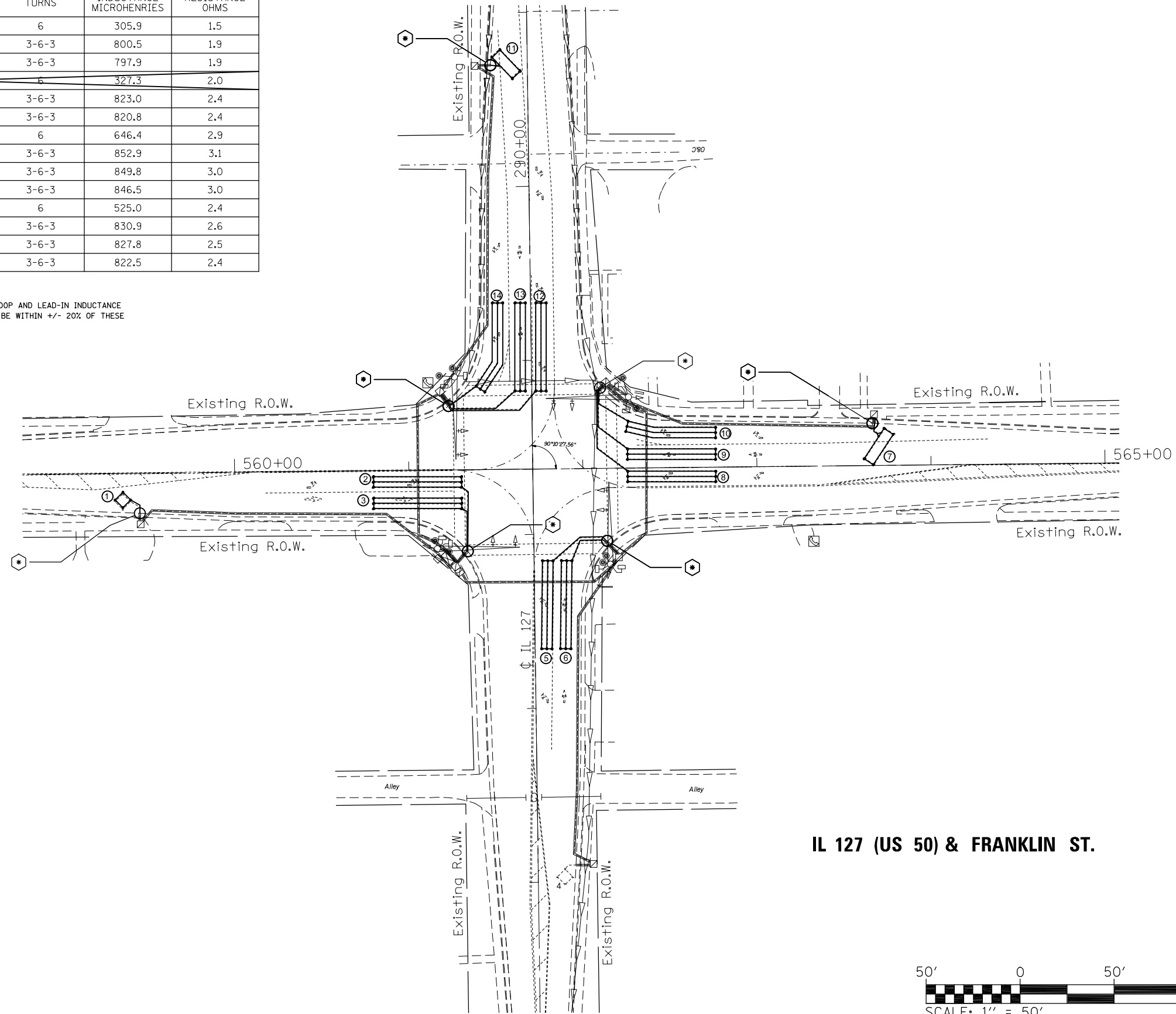

IL 127 (US 50) & FRANKLIN ST.

FILE NAME =	USER NAME = nievesa	DESIGNED -	REVISED -
pw:\IL084EBIDINTEG\illinois.gov\PWIDOT\Documents\IDOT Offices\District 8\Projects\0876\DRAWING\DATA\EA0\sheets\d876J06-ts-plan.dwg		REVISOR -	REVISED -
	PLOT SCALE = 64.5383' / in.	CHECKED -	REVISED -
	PLOT DATE = 1/25/2016	DATE -	REVISED -

**STATE OF ILLINOIS
 DEPARTMENT OF TRANSPORTATION**

**DETECTOR LOOP REPLACEMENT PLAN
 IL 127 (US 50) & FRANKLIN ST.**

SCALE: SHEET NO. 3 OF 3 SHEETS STA. TO STA.

F.A.P. RTE.	SECTION	COUNTY	TOTAL SHEETS	SHEET NO.
327/42	113RS-6, 14-16Z-RS-1	CLINTON	32	32
FED. ROAD DIST. NO. ILLINOIS FED. AID PROJECT			CONTRACT NO. 76J06	