

DATE	BY

DATE	BY

DATE	BY

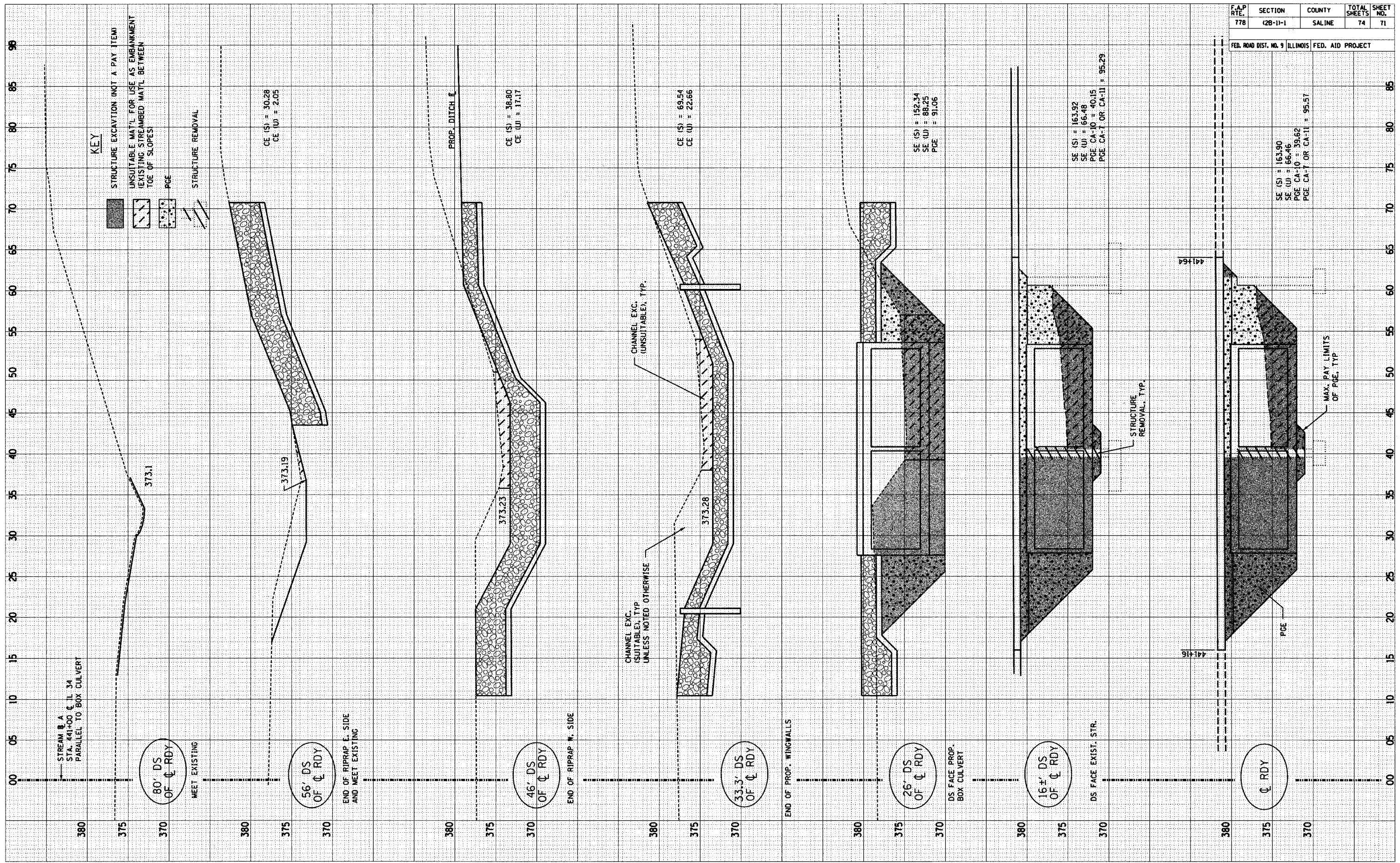

F.A.P. RTE.	SECTION	COUNTY	TOTAL SHEETS	SHEET NO.
778	(28-1)-1	SALINE	74	71

FED. ROAD DIST. NO. 9	ILLINOIS	FED. AID PROJECT
SE (S) = 163.90	SE (W) = 66.46	PGE CA-10 = 39.62
PGE CA-1 OR CA-11 = 95.57		