

F.A.P. RTE.	SECTION	COUNTY	TOTAL SHEETS	SHEET NO.
322	4-1	WACKSON	26	11
STA. 756+52.47		TO STA. 772+41.77		
FED. ROAD DIST. NO.		ILLINOIS	FED. AID PROJECT	
CONTRACT NO. 98807				

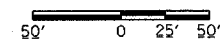

VILLAGE OF DOWELL

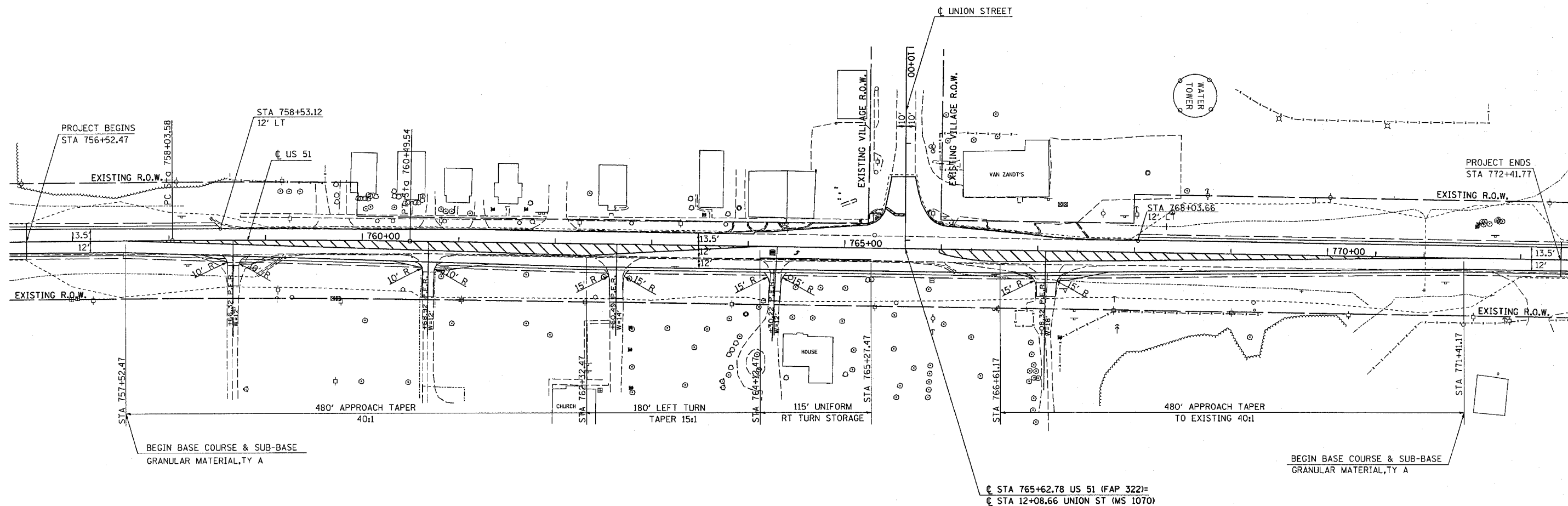

EXIST CURVE 6
 PI STA. = 759+26.57
 $\Delta = 1^\circ 13' 47''$ (RT)
 $D = 0^\circ 30' 00''$
 $R = 11,459.19'$
 $T = 122.98'$
 $L = 245.95'$
 $E = 0.66'$
 P.C. STA. = 758+03.58
 P.T. STA. = 760+49.54

☐ STA 765+62.78 US 51 (FAP 322)=
 ☐ STA 12+08.66 UNION ST (MS 1070)

DATE TIME
 CON-SPEC
 REF 100004
 REF