

F.A.P. RTE	SECTION	COUNTY	TOTAL SHEETS	SHEET NO
331	5-(2,3)I-1,TS-2	JACKSON	94	38
STA.		TO STA.		
FED. ROAD DIST. NO.	ILLINOIS	FED. AID PROJECT		

STAGE 8

1. CLOSE RIGHT TURN LANE AS SHOWN. THE TURN LANE SHOULD BE OPENED AT THE END OF EACH DAY'S OPERATION.
2. REMOVE TEMPORARY PLUG AND PAVEMENT FROM STA 100+11.29 TO STA 100+67.17 AS SHOWN.
3. BORE CONDUIT FROM NORTHEAST HANDHOLE TO PROPOSED MAST ARM FOUNDATION. CONSTRUCT MAST ARM FOUNDATION.
4. CONSTRUCT P.C.C. PAVEMENT AND ISLAND FROM STA 100+11.29 TO STA 100+67.17 AS SHOWN.

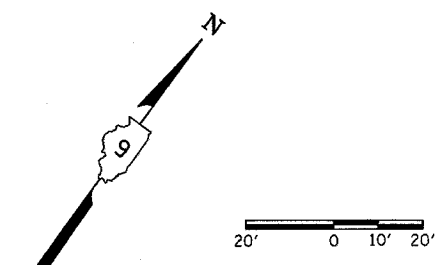
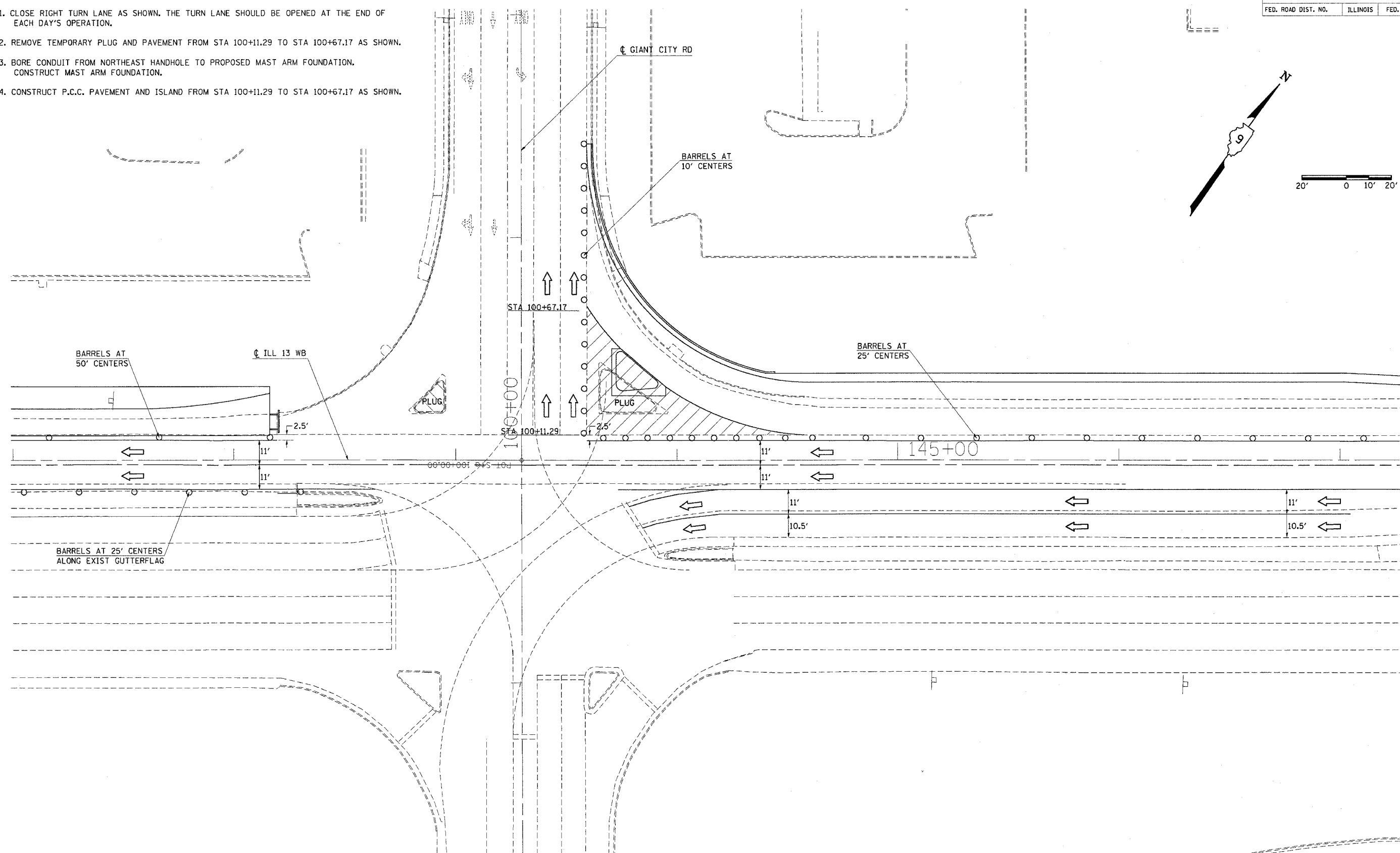

Thu Feb 19 16:53:43 2004
 C:\projects\98833\stage8\stage8.dwg Lvs: 63
 D:\D9\98833\stage8\stage8.dwg Lvs: 128