

F.A.P. RTE	SECTION	COUNTY	TOTAL SHEETS	SHEET NO
331	5-(2,3) 1-L, TS-2	JACKSON	94	44A
STA	TO STA			
FED. ROAD DIST. NO.	ILLINOIS	FED. AID PROJECT		

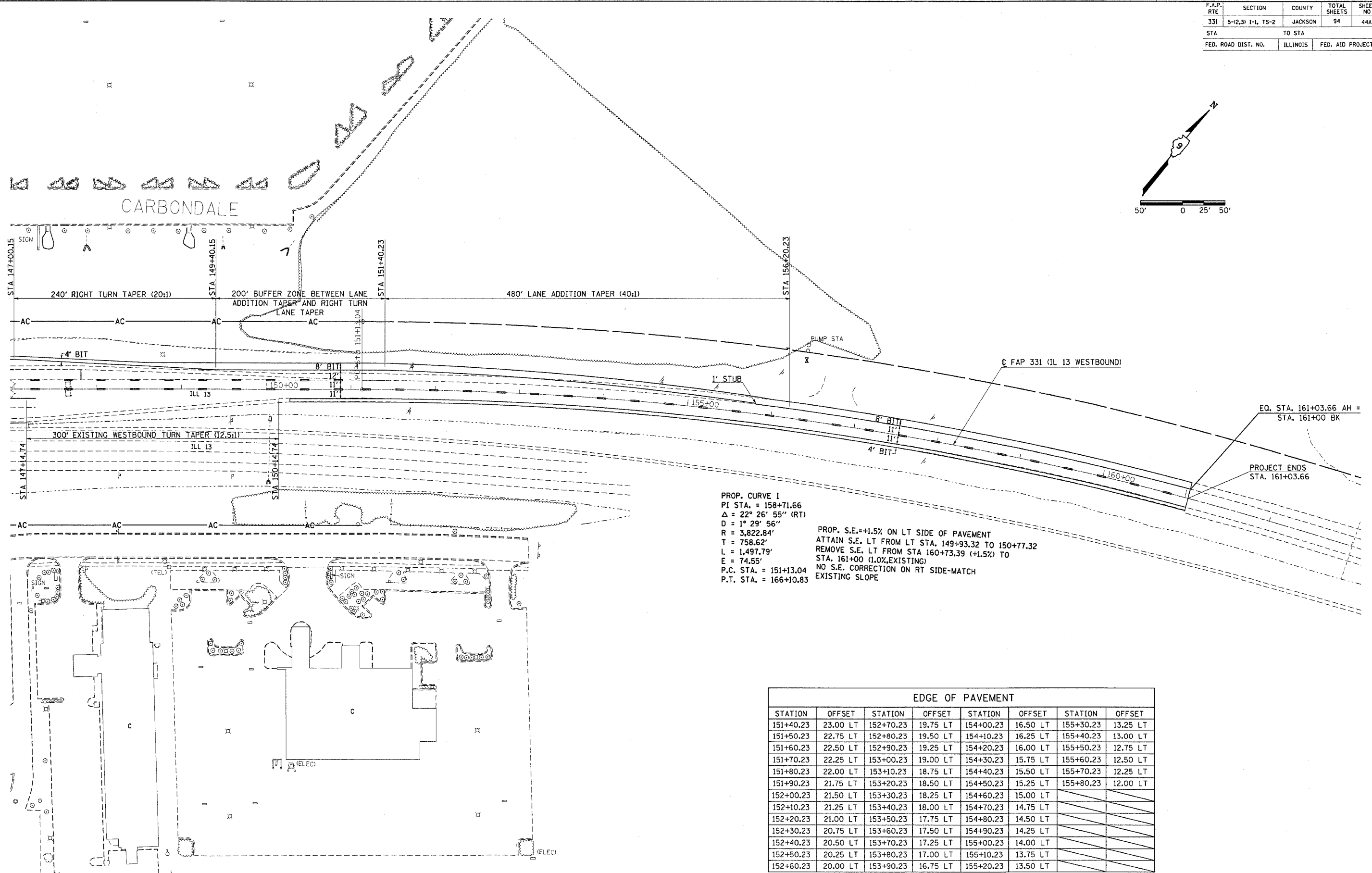
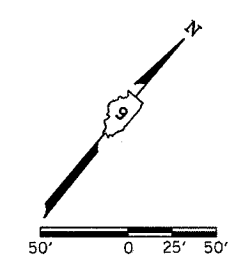

PROP. CURVE 1
 PI STA. = 158+71.66
 $\Delta = 22^\circ 26' 55''$ (RT)
 $D = 1^\circ 29' 56''$
 $R = 3,822.84'$
 $T = 758.62'$
 $L = 1,497.79'$
 $E = 74.55'$
 P.C. STA. = 151+13.04
 P.T. STA. = 166+10.83

PROP. S.E. = +1.5% ON LT SIDE OF PAVEMENT
 ATTAIN S.E. LT FROM LT STA. 149+93.32 TO 150+77.32
 REMOVE S.E. LT FROM STA 160+73.39 (+1.5%) TO STA. 161+00 (1.0% EXISTING)
 NO S.E. CORRECTION ON RT SIDE-MATCH
 EXISTING SLOPE

STATION	OFFSET	STATION	OFFSET	STATION	OFFSET	STATION	OFFSET
151+40.23	23.00 LT	152+70.23	19.75 LT	154+00.23	16.50 LT	155+30.23	13.25 LT
151+50.23	22.75 LT	152+80.23	19.50 LT	154+10.23	16.25 LT	155+40.23	13.00 LT
151+60.23	22.50 LT	152+90.23	19.25 LT	154+20.23	16.00 LT	155+50.23	12.75 LT
151+70.23	22.25 LT	153+00.23	19.00 LT	154+30.23	15.75 LT	155+60.23	12.50 LT
151+80.23	22.00 LT	153+10.23	18.75 LT	154+40.23	15.50 LT	155+70.23	12.25 LT
151+90.23	21.75 LT	153+20.23	18.50 LT	154+50.23	15.25 LT	155+80.23	12.00 LT
152+00.23	21.50 LT	153+30.23	18.25 LT	154+60.23	15.00 LT		
152+10.23	21.25 LT	153+40.23	18.00 LT	154+70.23	14.75 LT		
152+20.23	21.00 LT	153+50.23	17.75 LT	154+80.23	14.50 LT		
152+30.23	20.75 LT	153+60.23	17.50 LT	154+90.23	14.25 LT		
152+40.23	20.50 LT	153+70.23	17.25 LT	155+00.23	14.00 LT		
152+50.23	20.25 LT	153+80.23	17.00 LT	155+10.23	13.75 LT		
152+60.23	20.00 LT	153+90.23	16.75 LT	155+20.23	13.50 LT		

Tue Feb 24 07:49:25 2004
 C:\projects\0804903\0804903.dwg LV-2-63
 DMS:0804903.dwg PLOT:0804903.dwg
 DMS:0804903.dwg PLOT:0804903.dwg