

F.A.P. RTE.	SECTION	COUNTY	TOTAL SHEETS	SHEET NO.
331	5-(2,3)1-1,TS-2	JACKSON	94	65
STA. 13+50		TO STA. 14+50		
FED. ROAD DIST. NO.	ILLINOIS FED. AID PROJECT			

DATE	
BY	
FINAL SURVEY	
NOTE BOOK	
TEMPLATE	
AREAS CHECKED	
NO.	

DATE	
BY	
ORIGINAL SURVEY	
NOTE BOOK	
TEMPLATE	
AREAS CHECKED	
NO.	

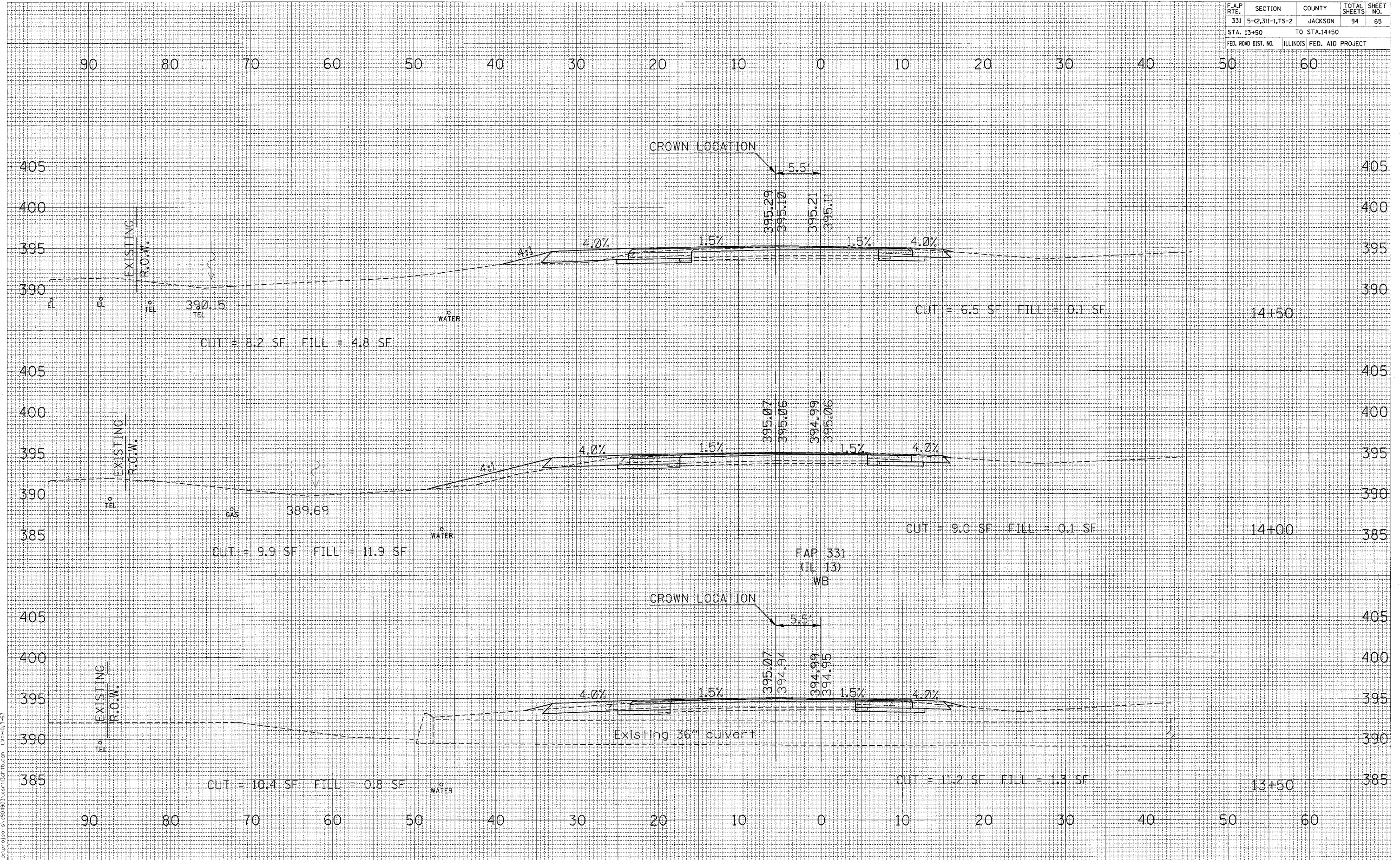

CROSS SECTIONS STA 13+50 TO STA 14+50

Thu Feb 19 14:16:33 2004