

F.A.P. RTE.	SECTION	COUNTY	TOTAL SHEETS	SHEET NO.
331	5-12,311-1,TS-2	JACKSON	94	71
STA. 138+50		TO STA.139+50		
FED. ROAD DIST. NO.		ILLINOIS FED. AID PROJECT		

DATE	BY

DATE	BY

Thu Feb 04 10:58:39 2004
 C:\P\311\311-1\TS-2\138+50-139+50.dwg LVH:JLS

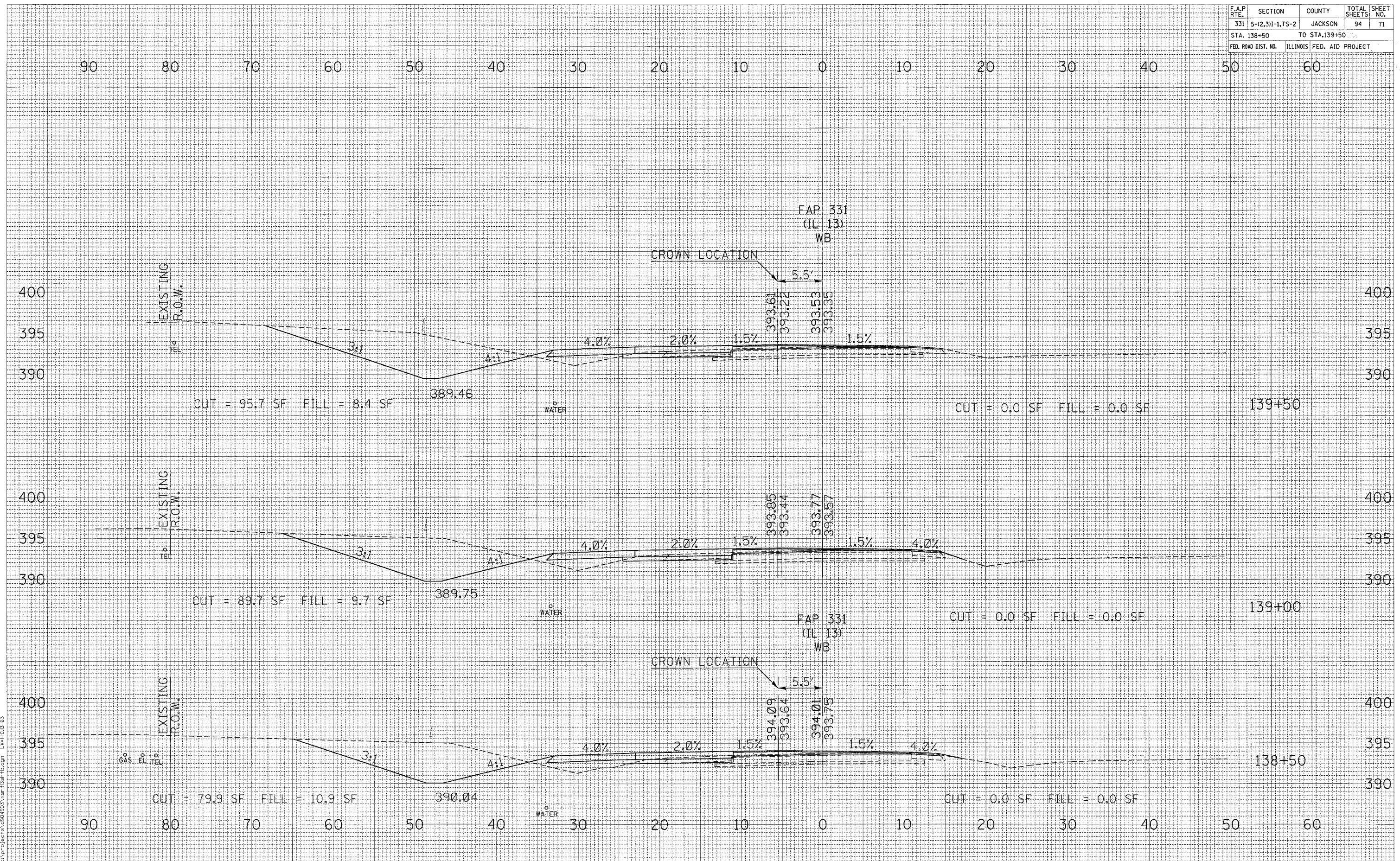

CROSS SECTIONS STA 138+50 TO STA 139+50