

**SECTION A-A**  
(FOR PCC PAVEMENT)

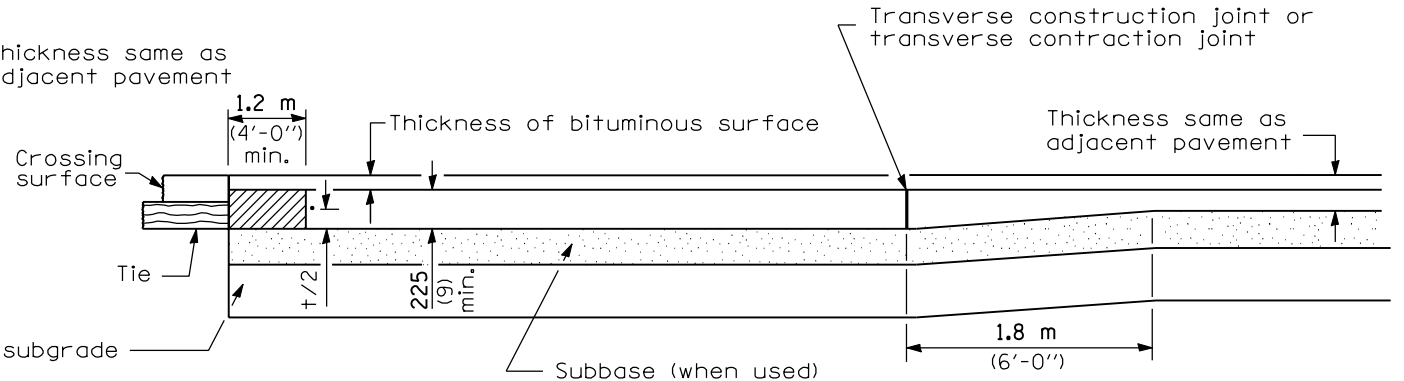

**SECTION A-A**  
(FOR PCC BASE COURSE WITH BITUMINOUS SURFACE)

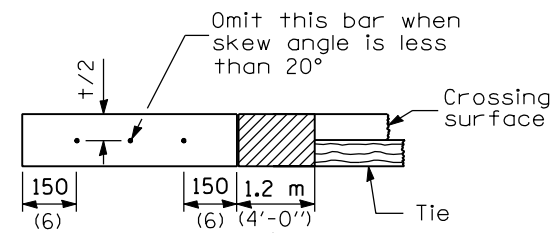

**SECTION B-B**

**GENERAL NOTES**

See Standard 420001 for joint details not shown.

All dimensions are in millimeters (inches) unless otherwise shown.

Illinois Department of Transportation

PASSED January 1, 2004  
*Michael Beard*  
 ENGINEER OF POLICY AND PROCEDURES

APPROVED January 1, 2004  
*Michael L. Hine*  
 ENGINEER OF DESIGN AND ENVIRONMENT

ISSUED 1-1-99

DATE	REVISIONS
1-1-04	Minor corrections of joint information
1-1-00	Widen Bit. Conc. binder course plug from 2' to 4'.

**PCC PAVEMENT AND PCC BASE COURSE ADJACENT TO RAILROAD GRADE CROSSING**

**STANDARD 420501-02**