

RECOMMENDED LOCATION OF RAMPS

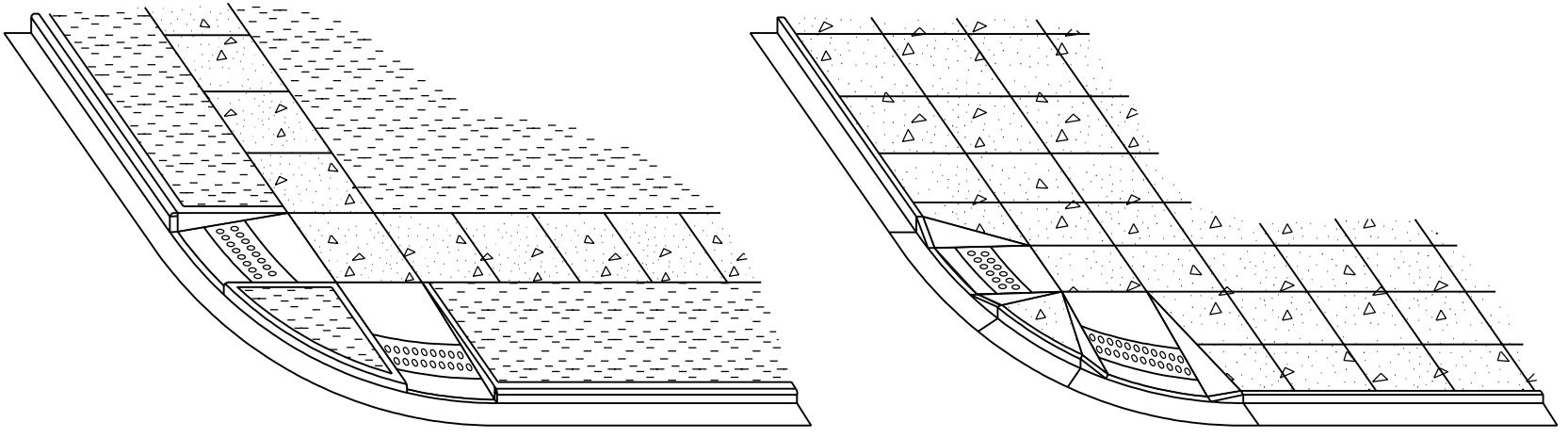

TYPE A RAMPS

TYPE B RAMPS

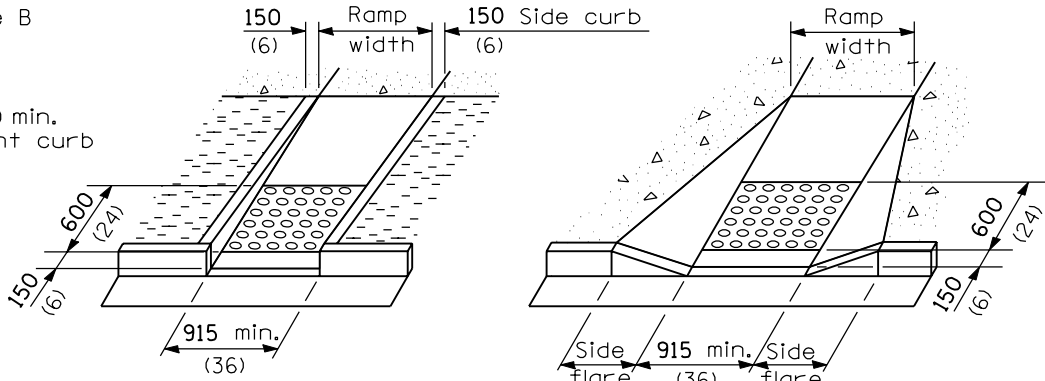

TYPE A

TYPE B

DETAILS OF RAMPS

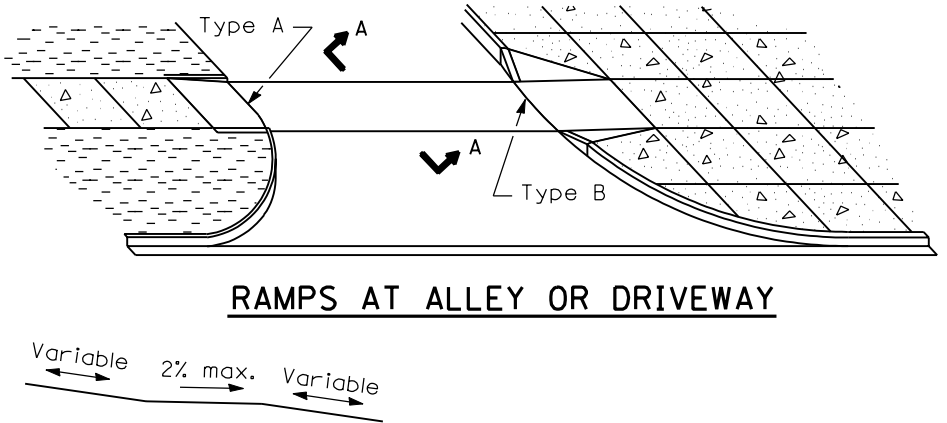

RAMPS AT ALLEY OR DRIVEWAY

SECTION A-A

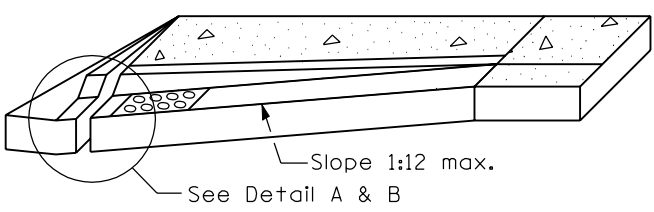

RAMP PROFILE

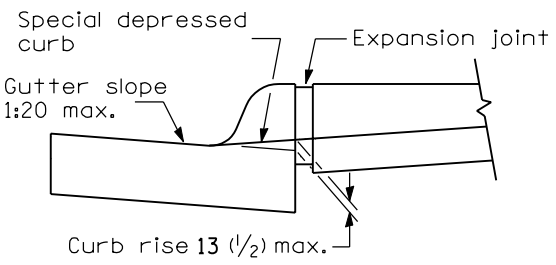

DETAIL A

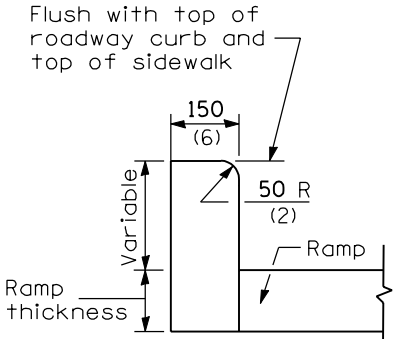

DETAIL OF SIDE CURB

(Side curb may be constructed monolithically with ramp)

GENERAL NOTES

The maximum slope of the side flare for Type B ramps shall be 1:10; however, if the width of the landing area between the top of the ramp and an obstruction is less than 1.2 m (4'-0") then the maximum slope shall be 1:12.

All slope ratios are expressed as units of vertical displacement to units of horizontal displacement (V:H).

All dimensions are in millimeters (inches) unless otherwise shown.

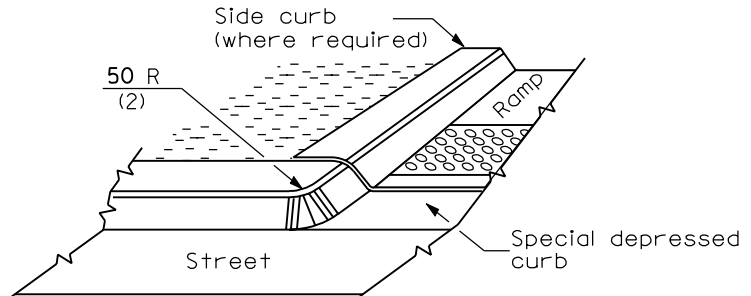

DETAIL B

- LEGEND**
- Sidewalk
 - Ramp
 - Detectable Warnings
 - Non walking area

| DATE | REVISIONS |
|--------|--|
| 1-1-04 | Added detectable warnings and changed title. |
| 1-1-00 | Revised Standard title. |

CURB RAMPS FOR SIDEWALKS

(Sheet 1 of 2)

STANDARD 424001-03

Illinois Department of Transportation

PASSED January 1, 2004
Michael Brand
 ENGINEER OF POLICY AND PROCEDURES

APPROVED January 1, 2004
Michael L. Hine
 ENGINEER OF DESIGN AND ENVIRONMENT

ISSUED 1-1-97

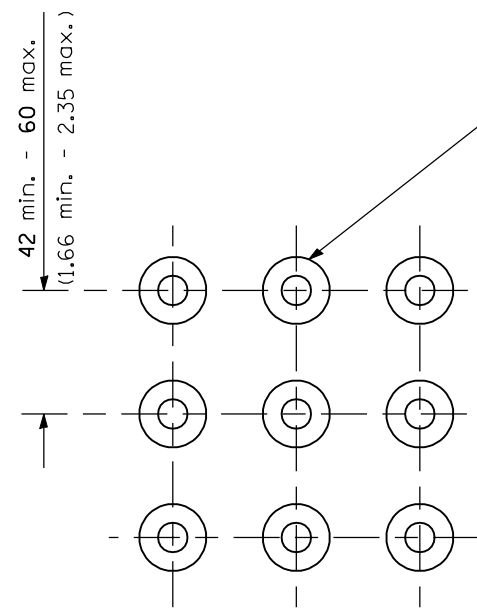

SQUARE PATTERN
(Parallel Alignment)

Truncated Dome

Direction of Travel

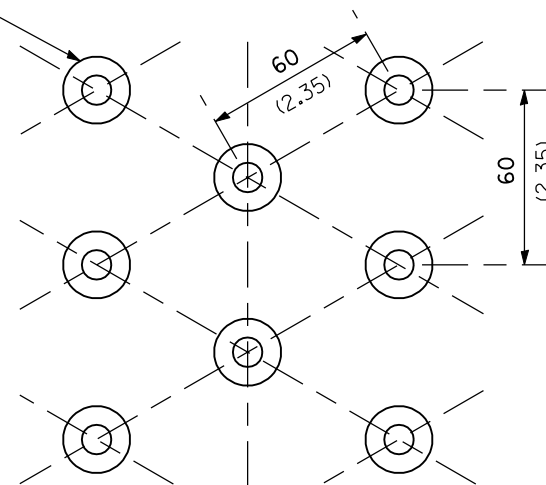

TRIANGULAR PATTERN

DETECTIBLE WARNINGS DETAIL

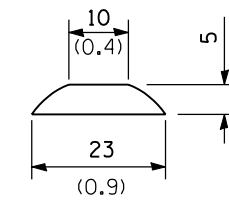

TRUNCATED DOME DETAIL

All slope ratios are expressed as units of vertical displacement to units of horizontal displacement (V:H).

All dimensions are in millimeters (inches) unless otherwise shown.

| | |
|---|---------------|
| Illinois Department of Transportation | |
| PASSED <u>January 1, 2004</u> <i>Michael Beard</i> ENGINEER OF POLICY AND PROCEDURES | ISSUED 1-1-97 |
| APPROVED <u>January 1, 2004</u> <i>Michael L. Hine</i> ENGINEER OF DESIGN AND ENVIRONMENT | |

| |
|--|
| CURB RAMPS FOR SIDEWALKS <small>(Sheet 2 of 2)</small> |
| STANDARD 424001-03 |