

TYPE B GUTTER

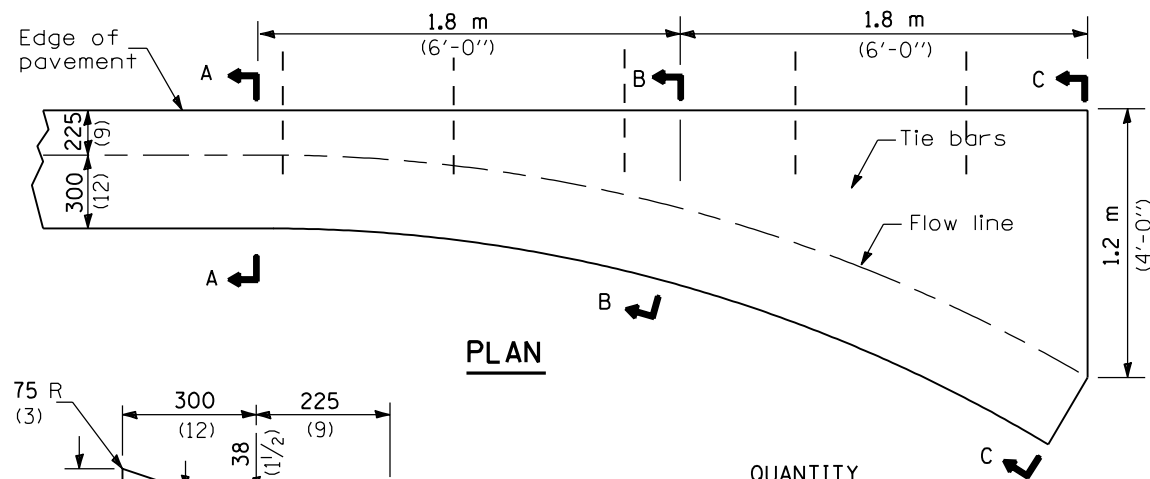

PLAN

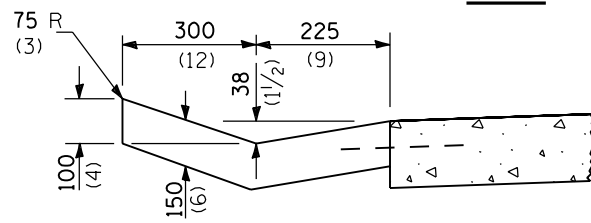

SECTION A-A

QUANTITY
Section C-C to A-A
0.49 m³ (0.64 cu. yd.)
concrete.

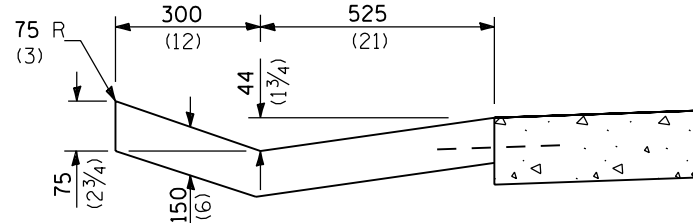

SECTION B-B

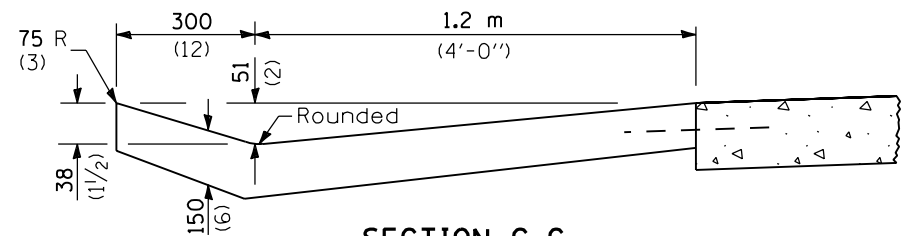

SECTION C-C

INLET

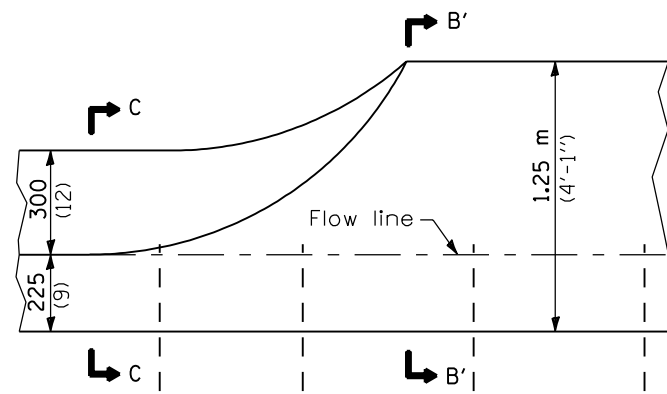

PLAN

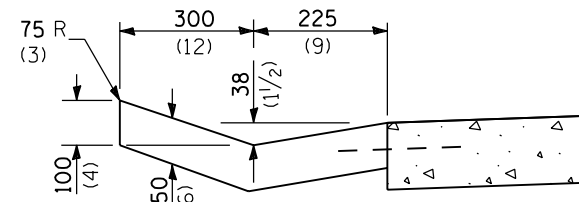

SECTION A-A & C-C

QUANTITY
Section B'-B' to B-B = 0.19 m³/m
(0.076 cu. yd./ft.).
Section C-C to B'-B' + B'-B' to
A-A = 0.23 m³ (0.30 cu. yd.).

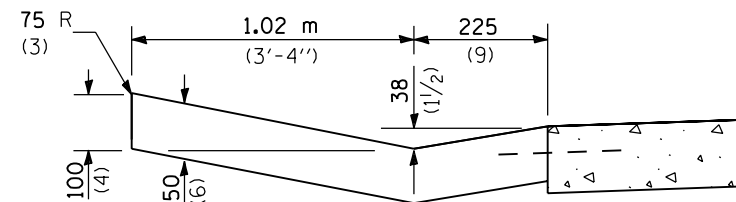

SECTION B-B & B'-B'

ENTRANCE

GENERAL NOTES

Tie bars shall be No. 20 (No. 6) at 600 mm (24") centers unless otherwise shown.

Gutter, gutter inlet, gutter outlet and gutter entrance shall be tied to the pavement in accordance with details for longitudinal construction joint shown on Standard 420001.

Two 32 mm x 450 mm (1-1/4" x 18") dowel bars shall be installed in all joints when the gutter is constructed adjacent to flexible pavement.

All dimensions are in millimeters (inches) unless otherwise shown.

DATE	REVISIONS
1-1-97	Renum. Standard 1914-7.
6-15-94	Moved G.N. to Specs. Added Metric.

**TYPE B GUTTER
(INLET, OUTLET & ENTRANCE)**

(Sheet 1 of 2)

STANDARD 606201

Illinois Department of Transportation

PASSED January 1, 1997

ENGINEER OF POLICY AND PROCEDURES

APPROVED January 1, 1997

ENGINEER OF DESIGN AND ENVIRONMENT

ISSUED 1-1-97

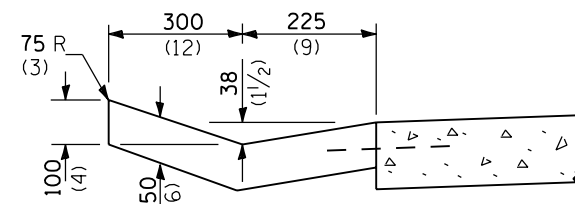

SECTION A-A

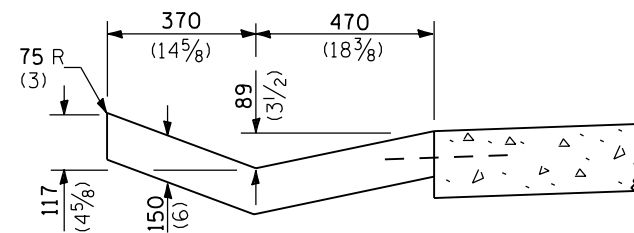

SECTION B-B

QUANTITY
 Section A-A to E-E and curtain wall
 1.45 m³ (1.9 cu. yd.) concrete.
 Section F-F = 0.17 m³/m
 (0.068 cu. yd./ft.).

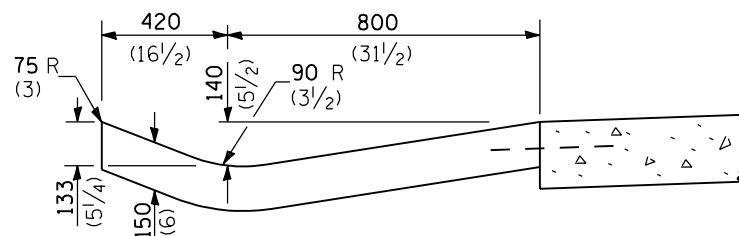

SECTION C-C

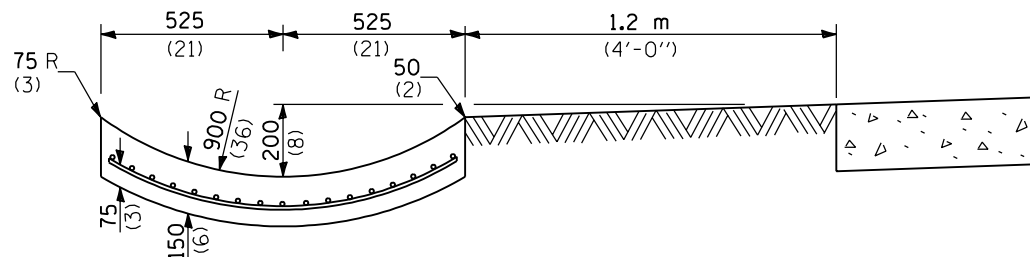

SECTION E-E

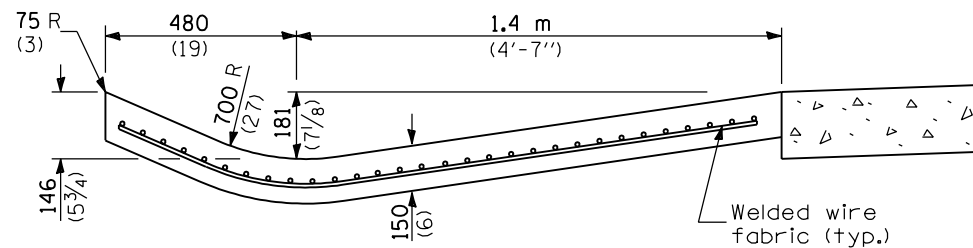

SECTION D-D

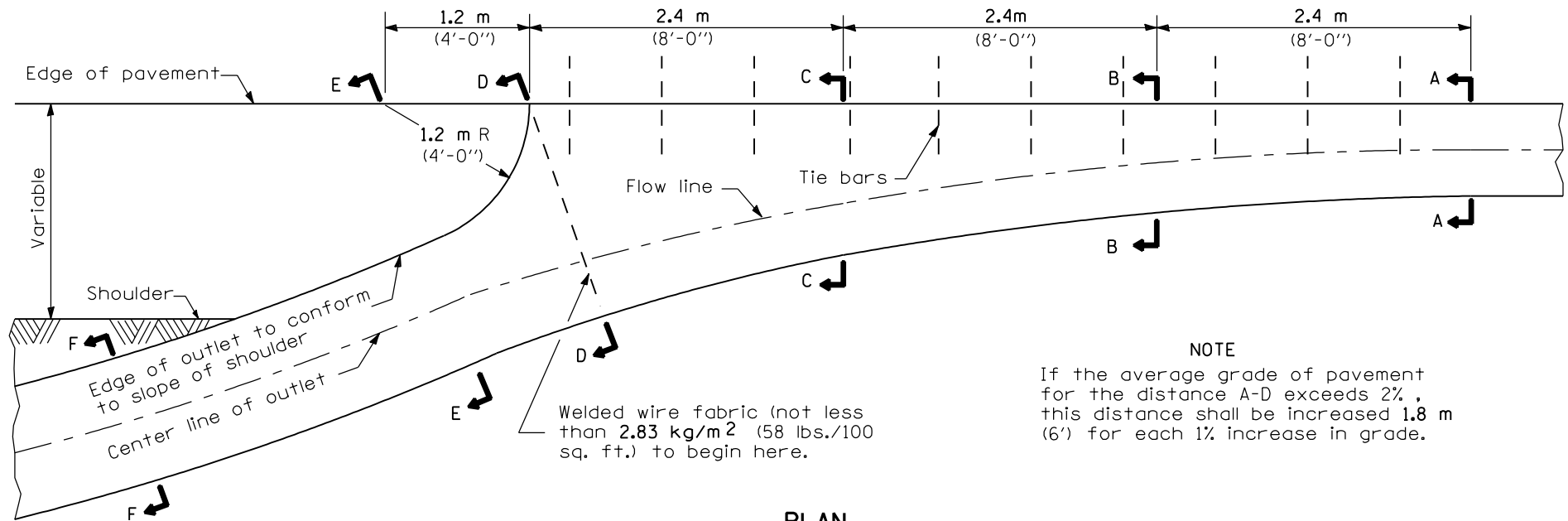

PLAN

NOTE
 If the average grade of pavement
 for the distance A-D exceeds 2%,
 this distance shall be increased 1.8 m
 (6') for each 1% increase in grade.

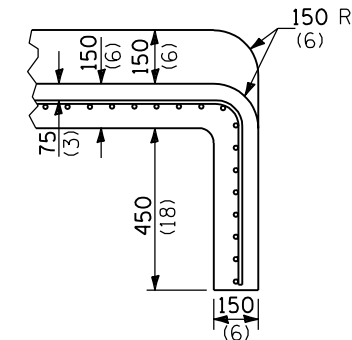
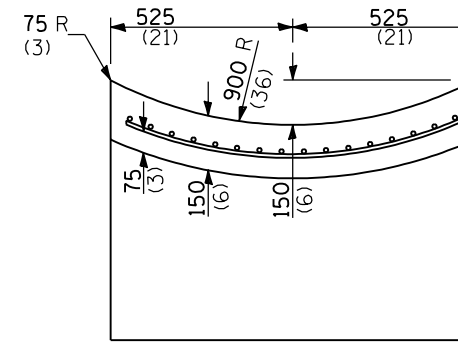

SECTIONS AT END OF OUTLET

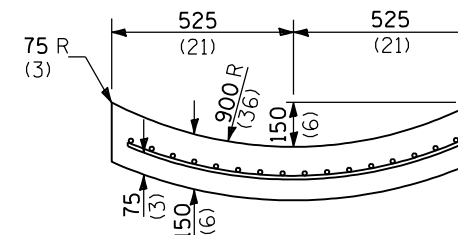

SECTION F-F

All dimensions are in millimeters (inches)
 unless otherwise shown.

OUTLET

**TYPE B GUTTER
 (INLET, OUTLET & ENTRANCE)**
 (Sheet 2 of 2)
STANDARD 606201

Illinois Department of Transportation
 PASSED January 1, 1997
 ENGINEER OF POLICE AND PROCEDURES
 APPROVED January 1, 1997
 ENGINEER OF DESIGN AND ENVIRONMENT
 ISSUED 1-6-97