

NOTE:
 THE PARKING STALL WIDTH OF 8.5' IS THE MINIMUM
 WIDTH REQUIRED. IT IS THE INTENT OF THE PROJECT
 TO MATCH THE EXISTING PARKING AREAS. PARKING
 STALLS WIDTHS OF 9' OR GREATER SHALL BE USED
 WHERE POSSIBLE TO MATCH THE EXISTING WIDTHS.

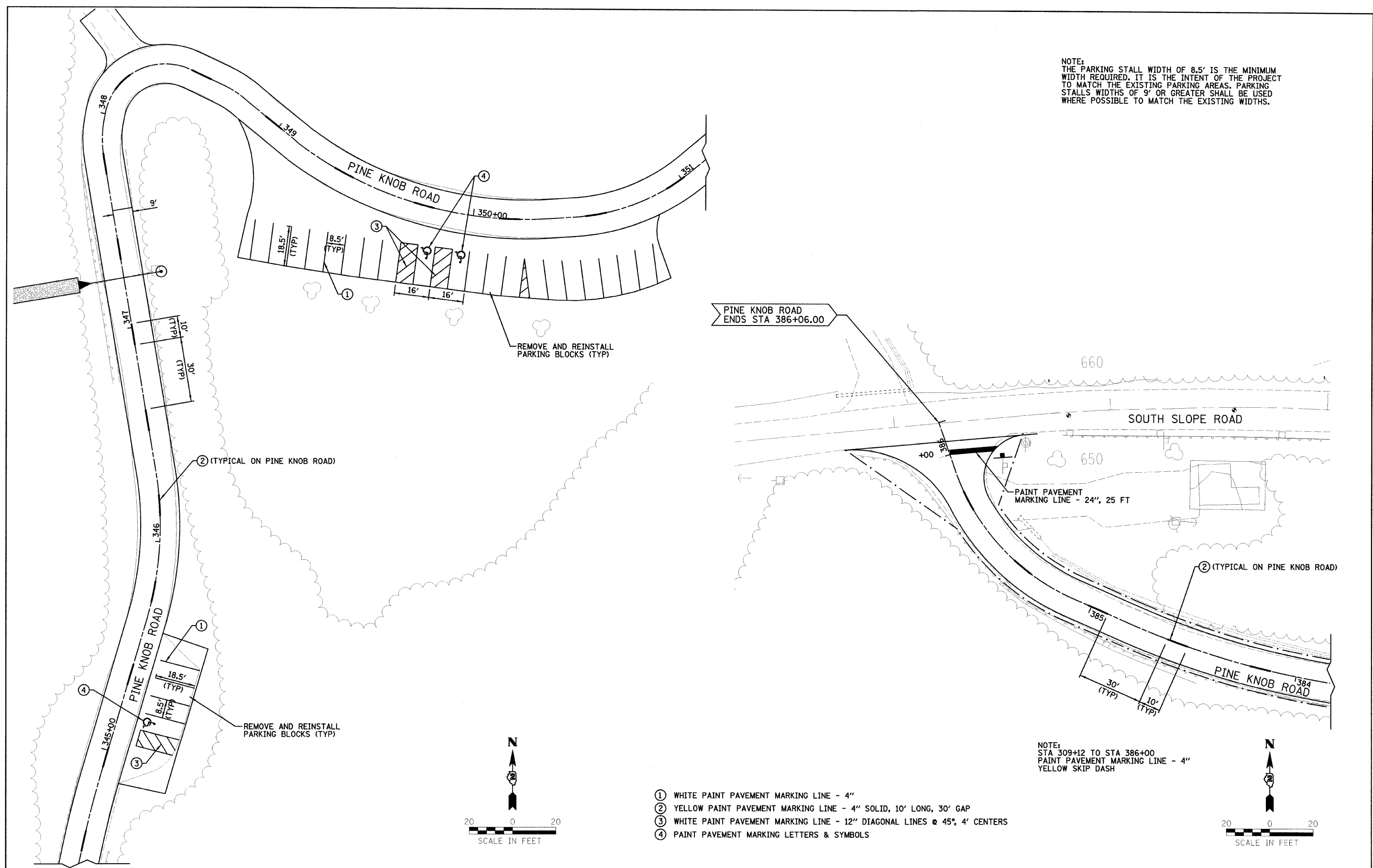

PINE KNOB ROAD
 ENDS STA 386+06.00

PAINT PAVEMENT
 MARKING LINE - 24", 25 FT

NOTE:
 STA 309+12 TO STA 386+00
 PAINT PAVEMENT MARKING LINE - 4"
 YELLOW SKIP DASH

- ① WHITE PAINT PAVEMENT MARKING LINE - 4"
- ② YELLOW PAINT PAVEMENT MARKING LINE - 4" SOLID, 10' LONG, 30' GAP
- ③ WHITE PAINT PAVEMENT MARKING LINE - 12" DIAGONAL LINES @ 45°, 4' CENTERS
- ④ PAINT PAVEMENT MARKING LETTERS & SYMBOLS

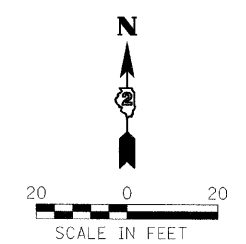
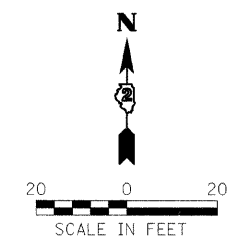

| | |
|-----------------|-----------|
| DESIGNED - LAW | REVISED - |
| DRAWN - DRR | REVISED - |
| CHECKED - PJM | REVISED - |
| DATE - 01/27/10 | REVISED - |

STATE OF ILLINOIS
DEPARTMENT OF TRANSPORTATION
DIVISION OF HIGHWAYS

PAVEMENT MARKING PLAN

SCALE: SHEET NO. 18 OF 35 SHEETS STA. TO STA.

IDOT/IDNR STATEWIDE
MISSISSIPPI PALISADES STATE PARK
PINE KNOB ROAD

| | | | | |
|---------------------|---------------------------|---------|--------------|-----------|
| F.A. | SECTION | COUNTY | TOTAL SHEETS | SHEET NO. |
| | PINE KNOB ROAD | CARROLL | 35 | 18 |
| CONTRACT NO. 46093 | | | | |
| FED. ROAD DIST. NO. | ILLINOIS FED. AID PROJECT | | | |