

NOTE:
REFER TO HIGHWAY STANDARD 701601
FOR ADVANCE SIGNING AND ADDITIONAL
DETAILS NOT SHOWN

- CONSTRUCTION WORK ZONE
- DIRECTION OF TRAFFIC
- TEMPORARY CONCRETE BARRIER
- IMPACT ATTENUATOR TEMPORARY
- FLASHING ARROW BOARD
- TYPE III BARRICADE
- BARRICADE OR DRUM
50' CTC ON TANGENTS
20' CTC IN TAPER

NOTE:
FIBER OPTIC CABLES ARE ATTACHED TO THE WEST SIDE OF THE
SOUTHBOUND BRIDGE (SN 016-2512) FOR TRAFFIC SIGNAL INTERCONNECT.
THERE ARE DRAIN PIPES ATTACHED TO THE BOTTOM OF THE DECK AND
DIAPHRAGMS. THERE MAY BE ELECTRICAL CONDUIT IN THE DECK FOR
THE LIGHTING ON THE BRIDGE.
USE DIRECTION INDICATOR BARRICADES IN LANE CLOSURE TAPERS

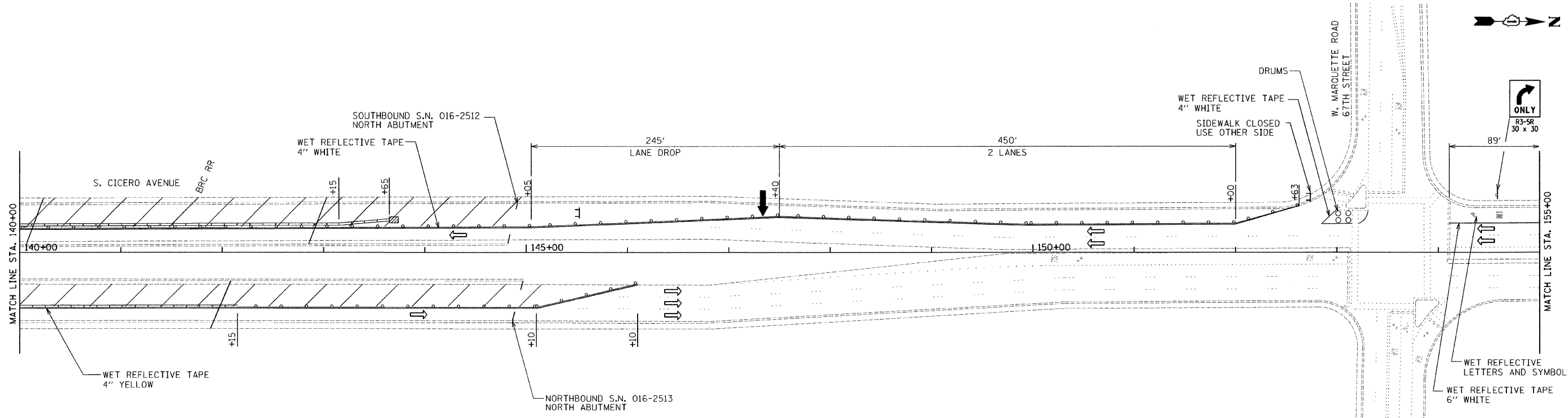
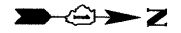

P:\Jobs\2009\20090223-02\cod\site\00\DIR\76-sht+st+cgel01.dgn
10/22/2009 10:58:04 AM

FILE NAME =	USER NAME = ..USER..	DESIGNED - RS	REVISED -	STATE OF ILLINOIS DEPARTMENT OF TRANSPORTATION	IL 50 (CICERO AVENUE) MAINTENANCE OF TRAFFIC STAGE 1			F.A.P. RTE. 350	SECTION 50-1 VB-1-BR	COUNTY COOK	TOTAL SHEETS 33	SHEET NO. 6
	PLOT SCALE = 50.0045' / IN.	CHECKED - EF	REVISED -		SCALE: 50	SHEET NO. 1 OF 4 SHEETS	STA. TO STA.	CONTRACT NO. 60H76				
	PLOT DATE = 10/22/2009	DATE - 10/23/09	REVISED -		ILLINOIS FED. AID PROJECT							