







**LEGEND**

-  Interstate
-  Interstate (Detour)
-  Main Local Roads
-  Main Local Roads (Detour)
-  Collector Roads
-  Existing overhead DMS on NB I-55
-  County Line Road

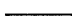

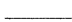
Rev. Sheet 4-13-10

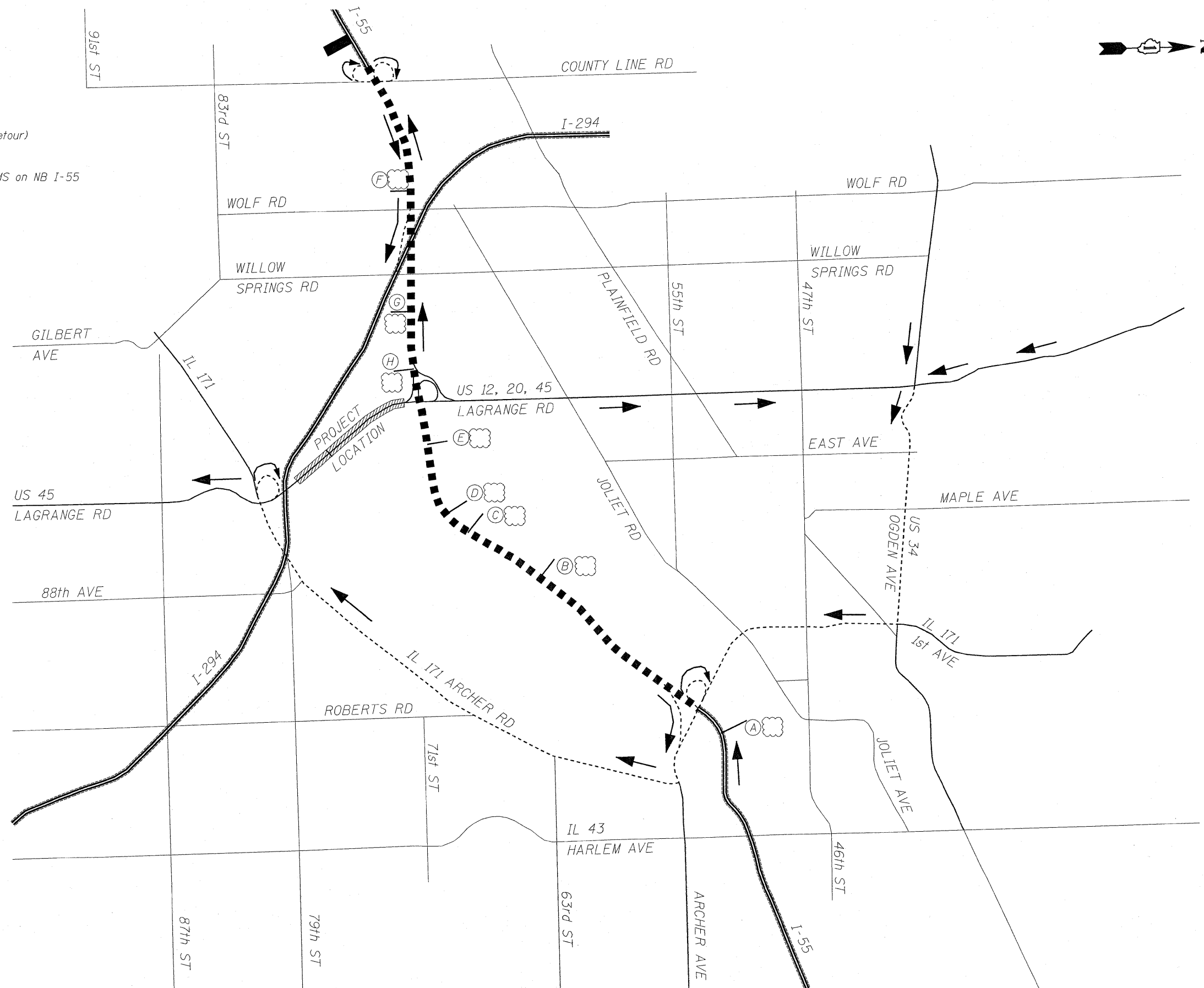
**LOCO, INC.**  
 CONSULTING ENGINEERS  
 1960 WALL ST, SUITE 222  
 NAPERVILLE, ILLINOIS 60563 PH: 630/577-3100

DESIGNED - MJY	REVISED - 4/13/2010
DRAWN - SV	REVISED -
CHECKED - MJY, DC	REVISED -
DATE - 01/29/2010	REVISED -

**STATE OF ILLINOIS  
 DEPARTMENT OF TRANSPORTATION**

**DETOUR PLAN - OVERVIEW**  
**US 12, 20, 45 SB (LA GRANGE RD) OVER SANTA FE DR, RRs, DES PLAINES**  
 SCALE: NONE SHEET NO. 17 OF 54 SHEETS STA. 31+99.36 TO STA. 69+00.70

F.A.P. RTE. 330	SECTION 462 X-B-1	COUNTY COOK	TOTAL SHEETS 54	SHEET NO. 17
D-91-227-10		CONTRACT NO. 60J37		
FED. ROAD DIST. NO.		ILLINOIS FED. AID PROJECT		