

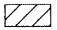

LEGEND

-  WORK AREA
-  IMPACT ATTENUATORS, TEMPORARY (FULLY REDIRECTIVE, NARROW), TEST LEVEL 3
-  TEMPORARY CONCRETE BARRIER
-  DRUM WITH STEADY BURN MONODIRECTIONAL LIGHT / DIRECTION INDICATOR BARRICADE WITH STEADY BURN MONODIRECTIONAL LIGHT (PER HWY. STD. 701402-07)
-  SIGN
-  ARROW BOARD

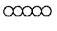
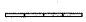
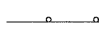
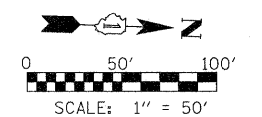
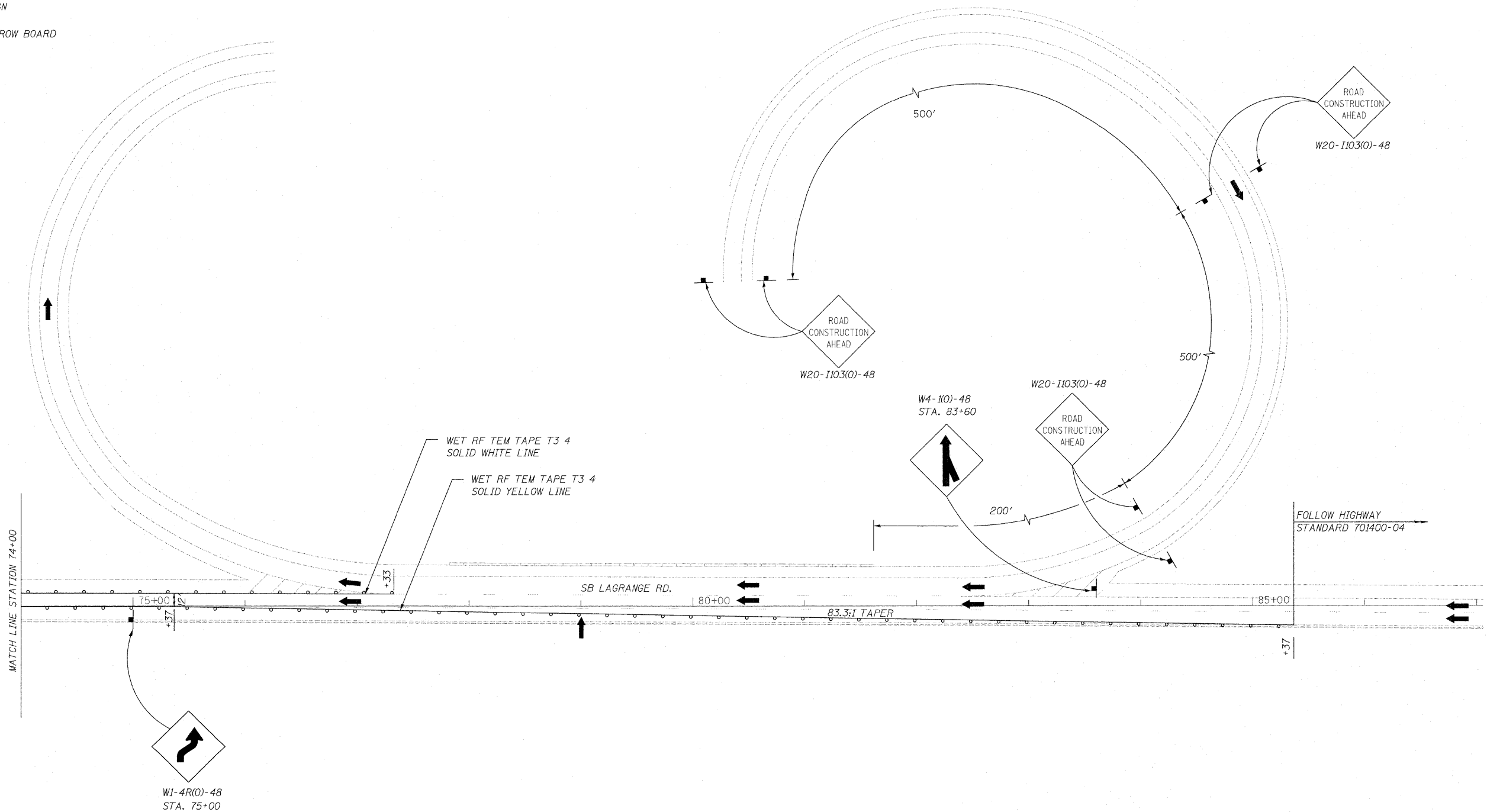

FILE NAME =	USER NAME = #USER#	DESIGNED - ST	REVISED -	STATE OF ILLINOIS DEPARTMENT OF TRANSPORTATION	MAINTENANCE OF TRAFFIC - STAGE II US ROUTE 12, 20, 45 SB (LA GRANGE RD) - S.N. 016-2407			F.A.P. RTE. 330	SECTION 462 X-B-I	COUNTY COOK	TOTAL SHEETS 54	SHEET NO. 12
#FILEL#		DRAWN - ST	REVISED -		SCALE: 1"=50'	SHEET NO. 12 OF 54 SHEETS	STA. 31+99.36	TO STA. 69+00.70	CONTRACT NO. 60J37			
		CHECKED - FML	REVISED -						ILLINOIS FED. AID PROJECT			
		DATE - 01/2010	REVISED -									