

**FOUNDATION & CONDUIT PLAN**  
SCALE: 1"=20'

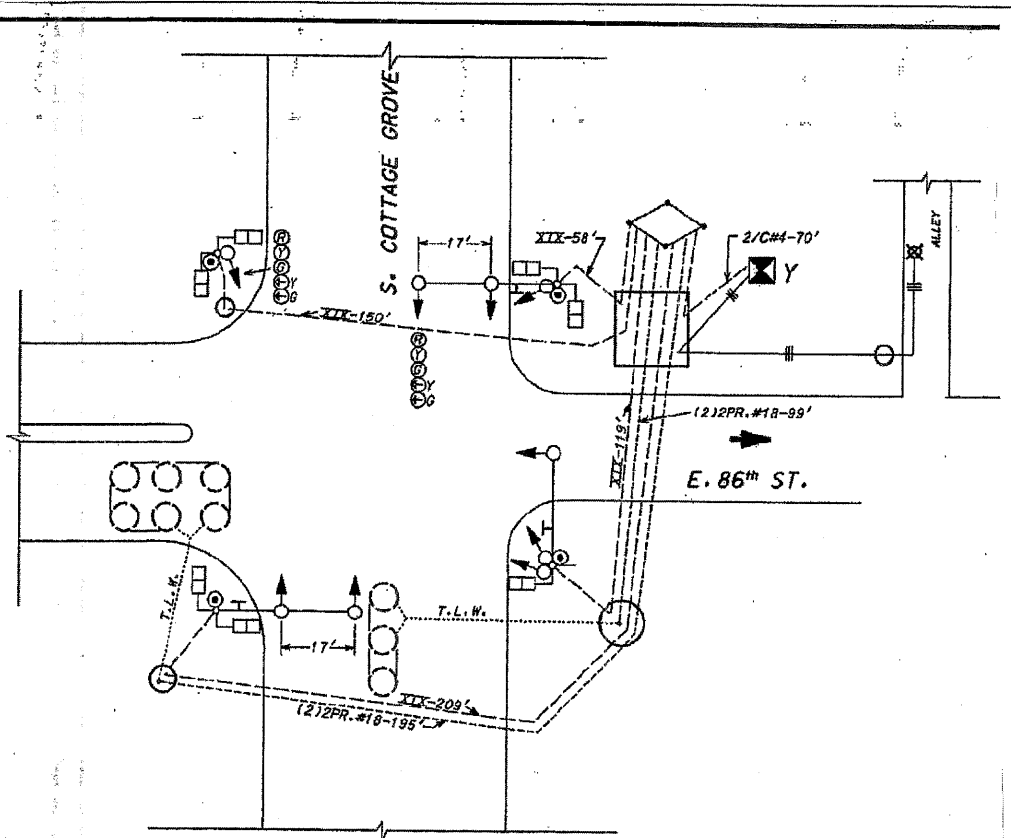

**CABLE & SIGNAL PLAN**  
NOT TO SCALE

- FOREMAN TO CONTACT ALL UTILITIES PRIOR TO EXCAVATION FOR EXACT LOCATION OF THEIR UNDERGROUND FACILITIES.
- ALL FOUNDATIONS IN SIDEWALK TO BE INSTALLED AS PER DRAWING #828 & #837.
- MOUNT ALL PEDESTRIAN SIGNALS BELOW TRAFFIC SIGNALS WHERE APPLICABLE.
- FOR CODE SEE DRAWING #826.
- Z - FOREMAN TO CHISEL MARK FOR EXACT LOCATION OF CONDUIT END.

- \* - DENOTES SPLICE #18 CABLE TO TWISTED LOOP WIRE.
- + - DENOTES D3-2 STREET NAME SIGN, 5' OFF CENTER OF POLE.
- ⊕ - DENOTES INSTALL PEDESTRIAN PUSH-BUTTON.
- Y - INSTALL 70AMP. CIRCUIT BREAKER.

**NOTE:**  
OPERATIONS SUCH AS PAVEMENT GRINDING OR PATCHING WHICH RESULT IN THE DESTRUCTION OF TRAFFIC SIGNAL DETECTION REQUIRE A NOTIFICATION OF INTENT TO WORK AND AN INSPECTION. A MINIMUM OF SEVEN (7) WORKING DAYS PRIOR TO THE DETECTION REMOVAL, THE CONTRACTOR SHALL NOTIFY ROBERT NELSON, CITY OF CHICAGO BUREAU OF ELECTRICITY TRAFFIC SIGNAL MAINTENANCE SUPERVISOR AT (312)746-4525 AT WHICH TIME ARRANGEMENTS WILL BE MADE TO ADJUST THE TRAFFIC CONTROLLER TIMING TO COMPENSATE FOR THE ABSENCE OF DETECTION. FINAL LOCATIONS OF THE DETECTOR LOOP REPLACEMENT WILL BE APPROVED BY THE CITY OF CHICAGO AND ENGINEER.

THIS PLAN IS FOR INFORMATION AND IS FOR THE SOLE PURPOSE OF DETECTOR LOOP REPLACEMENTS ONLY.

REPLACE ALL DETECTOR LOOPS AS SHOWN  
(WITHIN THE RESURFACING LIMITS)

CODE	QUANTITY	UNIT	ITEM
88600600	323	FOOT	DETECTOR LOOP REPLACEMENT

DATE	REVISION
WORK ORDER NO. 1213043	DATE 7-10-02
COST ALLOCATION ACCOUNT	
APPROPRIATION ACCOUNT	MATERIAL
	LABOR
<b>TRAFFIC CONTROL SIGNALS</b> S. COTTAGE GROVE & E. 86 <sup>th</sup> ST.	
CITY OF CHICAGO DEPT. OF STREET AND SANITATION BUREAU OF ELECTRICITY DIVISION OF ELECTRICAL ENGINEERING	
DRAWN BY: ARMANDO VIVANCO	CHIEF DRAFTSMAN: ROBERTO CARTER
SUPERVISING ENGINEER: [Signature]	ENGINEER: ARMANDO VIVALDI
ENGINEER - DEPT. OF ELECTRICITY: [Signature]	ELEC. DESIGN ENGR. [Signature]
GEN'L. SUPT. OF ELECTRICITY: [Signature]	DWG. NO. 2381
DEPUTY COMMISSIONER: [Signature]	
SIZE: 22" x 36"	SCALE: AS NOTED
	DATE: 7-10-

FILE NAME: P:\2002\ME\90808L\_Ver-Vor-Phil\CADD\W011\_CottageGr-Ave-Shts\DI60J68-Border-CottageGr.dgn  
 PLOT SCALE: 1"=20' / IN.  
 USER NAME: Millennia Professional Services

**MILLENNIA PROFESSIONAL SERVICES**  
 200 22ND Street, Suite 216, Lombard, IL 60148  
 630.785.0110 voice, 630.839.2566 fax  
 WWW.MPS-IL.COM

DESIGNED - CJD	REVISED -
DRAWN - CJD	REVISED -
CHECKED - RPD	REVISED -
DATE -	REVISED -

**STATE OF ILLINOIS**  
**DEPARTMENT OF TRANSPORTATION**

**COTTAGE GROVE AVENUE**  
83RD STREET TO 92ND STREET

**DETECTOR LOOP REPLACEMENT PLANS**  
COTTAGE GROVE AVE AT 86<sup>th</sup> STREET

SCALE: 1"=20'    SHEET NO. 06    OF    SHEETS    STA. 1+00.00    TO    STA. 1+06.00

F.A.U. RTE. 2919	SECTION 2009-118 RS	COUNTY COOK	TOTAL SHEETS 29	SHEET NO. 13
FED. ROAD DIST. NO. 1 ILLINOIS			CONTRACT NO. 60J68	

P:\2002\ME\90808L\_Ver-Vor-Phil\CADD\W011\_CottageGr-Ave-Shts\DI60J68-Border-CottageGr.dgn