

STATE OF ILLINOIS
DEPARTMENT OF TRANSPORTATION

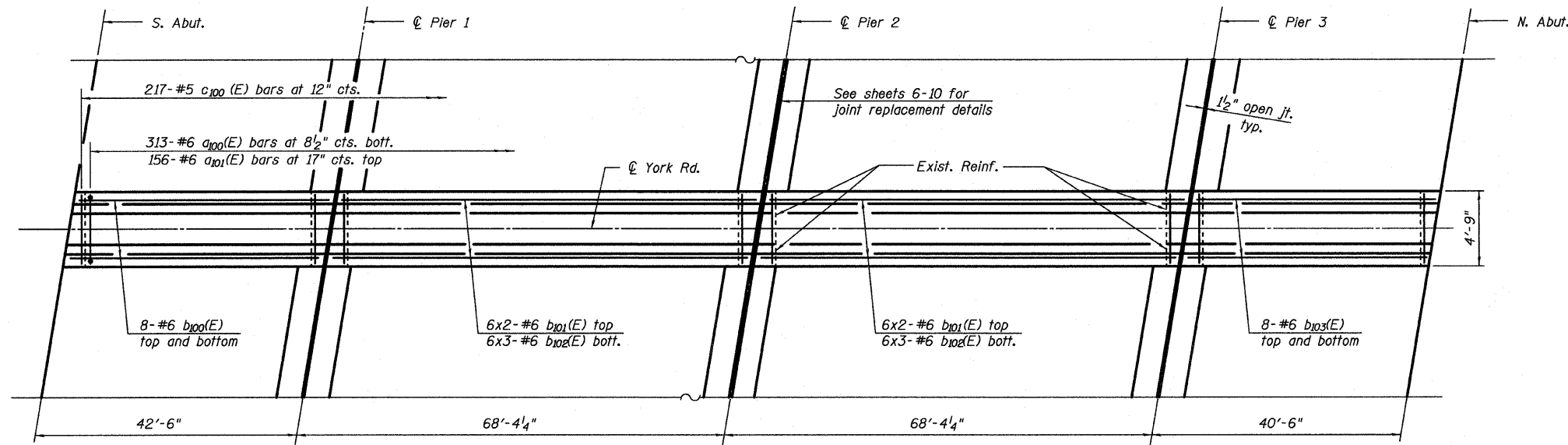

PARTIAL PLAN SHOWING MEDIAN REPLACEMENT

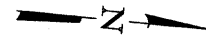
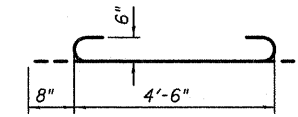

BAR a100(E)

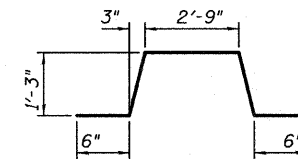

BAR c100(E)

BILL OF MATERIAL
(MEDIAN ONLY)

Bar	No.	Size	Length	Shape
a100(E)	313	#6	5'-10"	
a101(E)	156	#6	4'-6"	
b100(E)	16	#6	42'-1"	
b101(E)	24	#6	35'-6"	
b102(E)	36	#6	24'-9"	
b103(E)	16	#6	40'-1"	
c100(E)	217	#5	6'-3"	
Protective Coat		Sq. Yd.	134	
Concrete Removal		Cu. Yd.	39.6	
Concrete Superstructure		Cu. Yd.	44.6	
Reinforcement Bars, Epoxy Coated		Pound	9,810	

Bars labeled thus 4x2-#5 etc. indicate 4 lines of bars with 2 lengths per line.

Notes:

Hatched areas indicate concrete sections to be removed and replaced. Perimeters of concrete removal areas shall be saw cut 3/4" prior to removal of the concrete.

Existing reinforcement shall be cleaned, straightened (if required) and incorporated into the new construction. Cost included with Concrete Removal.

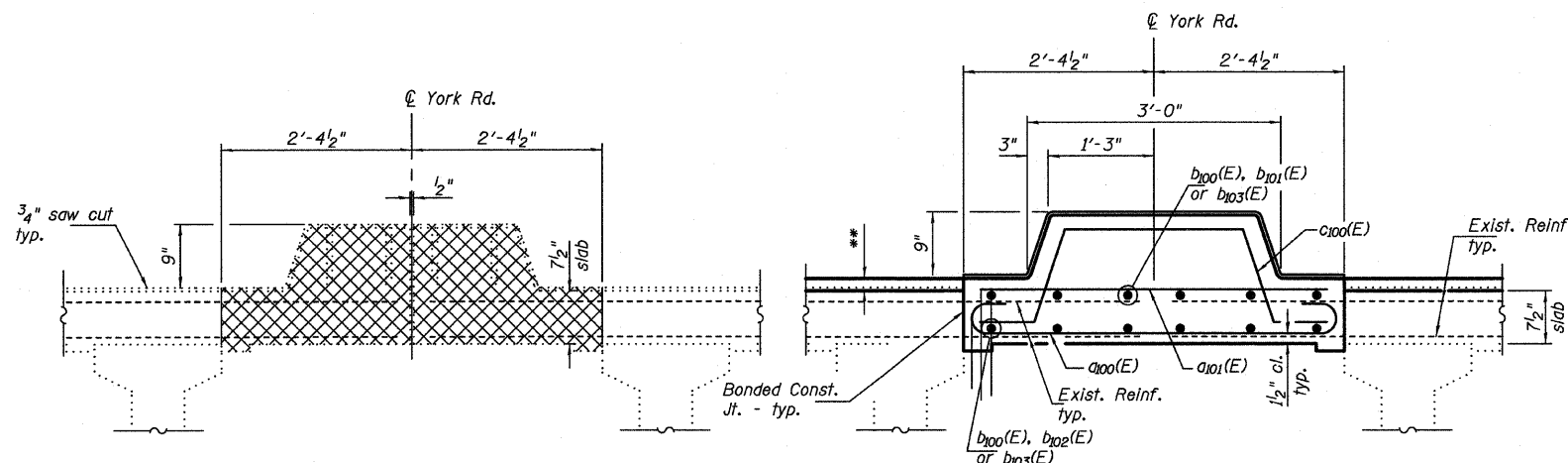

SECTION THRU MEDIAN REMOVAL

SECTION THRU MEDIAN REPLACEMENT

** Concrete to be 1 3/4" higher than exist. since exist. deck will get 1/2" hydroscarification, and 2 1/4" Latex concrete overlay, for an increase of 1 3/4".

DESIGNED - CMV
CHECKED - SDS
DRAWN - DLH
CHECKED - CMV

WHKS & CO.
ENGINEERING
7018 KINGSMILL CT.,
SPRINGFIELD, IL
(217) 483-9457
DESIGN FIRM #184001036

LONGITUDINAL JOINT CLOSURE DETAILS
F.A.U. RTE. 2678 (YORK ROAD) OVER
F.A.P. RTE. 347 (IL RTE. 38 - ROOSEVELT ROAD)
SECTION 163 HB-I-1
DUPAGE COUNTY
STATION 621+01.69
STRUCTURE NO. 022-0067

SHEET NO. 13 16 SHEETS	F.A.U. RTE. 2678	SECTION 163 HB-I-1	COUNTY DUPAGE	TOTAL SHEETS 31	SHEET NO. 23
	C-91-275-10		CONTRACT NO. 60J85		
ILLINOIS FED. AID PROJECT					