

ROUTE	SECTION	COUNTY	TOTAL SHEETS	SHEET NUMBER
VARIOUS	2010-011 RS	KANE	26	1

STATE OF ILLINOIS
DEPARTMENT OF TRANSPORTATION
DIVISION OF HIGHWAYS
DISTRICT ONE
PROPOSED HIGHWAY PLANS

CONTRACT NO. 60K30

D-91-469-10

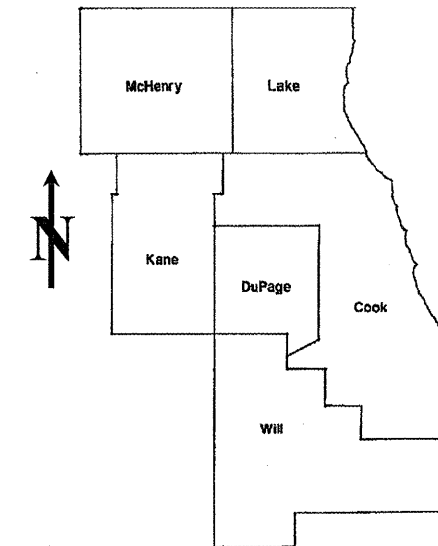

LOCATION OF IMPROVEMENT INDICATED THUS:

FOR INDEX OF SHEETS SEE SHEET 2

VARIOUS ROUTES
 SECTION: 2010-011 RS
 VARIOUS LOCATIONS IN KANE COUNTY
 INTERMITTENT PAVEMENT RESURFACING
 KANE COUNTY
 C-91-469-10

STATE OF ILLINOIS
DEPARTMENT OF TRANSPORTATION
DIVISION OF HIGHWAYS
 SUBMITTED: FEBRUARY 16, 2010
Diane M. O'Keefe
 DEPUTY DIRECTOR OF HIGHWAYS, REGION ENGINEER
March 19, 2010
Scott E. Still, P.E.
 acting ENGINEER OF DESIGN AND ENVIRONMENT
March 19, 2010
Christine M. Reed
 DIRECTOR, DIVISION OF HIGHWAYS

PRINTED BY THE AUTHORITY
OF THE STATE OF ILLINOIS

J.U.L.I.E.: JOINT UTILITY LOCATION
INFORMATION FOR EXCAVATION
(312) 744-7000

CONTRACT NO. 60K30

DISTRICT ONE - DESIGN - PLAN PREPARATION ENGINEER:
 KEN ENG / (847) 705-4247

INDEX OF SHEETS

STATE STANDARDS

GENERAL NOTES

<u>SHEET NO.</u>	<u>DESCRIPTION</u>	<u>STANDARD NO.</u>	<u>DESCRIPTION</u>
1	TITLE SHEET	000001-05	TYPICAL SYMBOLS, ABBREVIATIONS AND PATTERNS
2	INDEX OF SHEETS, STATE STANDARDS AND GENERAL NOTES	701201-03	LANE CLOSURE, 2L, 2W, DAY ONLY
3	SUMMARY OF QUANTITIES	701301-03	LANE CLOSURE, 2L, 2W, SHORT TIME OPERATIONS
4	GENERAL LOCATION MAP	701306-02	LANE CLOSURE, 2L, 2W, SLOW MOVING OPERATIONS - DAY ONLY
5	SUMMARY OF PATCHING SCHEDULE	701336-05	LANE CLOSURE, 2L, 2W, WORK AREAS IN SERIES
6-19	PATCHING SCHEDULE	701501-05	URBAN LANE CLOSURE, 2L, 2W, UNDIVIDED
20	BUTT JOINT AND HMA TAPER DETAILS	701601-06	URBAN LANE CLOSURE, MULTILANE, 1W OR 2W WITH NONTRAVERSABLE MEDIAN
21	TRAFFIC CONTROL AND PROTECTION FOR SIDE ROADS, INTERSECTIONS AND DRIVEWAYS	701606-06	URBAN LANE CLOSURE, MULTILANE, 2W WITH MOUNTABLE MEDIAN
22	TYPICAL APPLICATIONS: RAISED REFLECTIVE PAVEMENT MARKERS (SNOW-PLOW RESISTANT)	701701-06	URBAN LANE CLOSURE, MULTILANE INTERSECTION
23	DISTRICT ONE TYPICAL PAVEMENT MARKINGS	701901-01	TRAFFIC CONTROL DEVICES
24	TRAFFIC CONTROL AND PROTECTION OF TURN BAYS (TO REMAIN OPEN TO TRAFFIC)		
25	ARTERIAL ROAD INFORMATION SIGN		
26	DETECTOR LOOP INSTALLATION DETAIL FOR ROADWAY RESURFACING		

BEFORE STARTING ANY EXCAVATION, THE CONTRACTOR SHALL CALL "JULIE" AT (800) 892-0123 OR 811 FOR FIELD LOCATIONS OF BURIED ELECTRIC, TELEPHONE AND GAS FACILITIES. (48 HOUR NOTIFICATION REQUIRED)

THE CONTRACTOR WILL NOT BE ALLOWED TO SET UP A YARD OR FIELD OFFICE ON STATE (OR TOLLWAY) PROPERTY WITHOUT WRITTEN PERMISSION FROM THE DEPARTMENT (OR ISTHA)

WHEN ARTIFICIAL LIGHTING IS UTILIZED IN NIGHT OPERATIONS, THE CONTRACTOR SHALL EXERCISE THE UTMOST PRECAUTIONS IN PREVENTING ADVERSE VISIBILITY TO THE MOTORING PUBLIC AND ADJOINING RESIDENTIAL AREAS.

ANY PAVEMENT MARKINGS AND RAISED REFLECTIVE PAVEMENT MARKERS OBLITERATED BY MILLING AND RESURFACING OPERATIONS ON SIDE STREETS AND ENTRANCES SHALL BE REPLACED AND PAID FOR IN KIND.

BEFORE BEGINNING ANY WORK, THE CONTRACTOR SHALL RETAIN AND RECORD FOR FUTURE REFERENCE, ALL EXISTING PAVEMENT MARKING LINES (AND RAISED REFLECTIVE PAVEMENT MARKERS) IN ORDER THAT THESE LOCATIONS CAN BE RE-ESTABLISHED FOR STRIPING. EXACT LOCATIONS OF ALL PAVEMENT MARKINGS SHALL BE AS DIRECTED BY THE ENGINEER.

ALL PAVEMENT PATCHING LOCATIONS WILL BE DETERMINED IN THE FIELD BY THE ENGINEER.

THE CONTRACTOR SHALL CONTACT THE DISTRICT ONE TRAFFIC CONTROL SUPERVISOR AT (847) 705-4470 A MINIMUM OF 72 HOURS IN ADVANCE OF BEGINNING WORK.

THE ENGINEER SHALL CONTACT MR. DON CHIARUGI, AREA TRAFFIC FIELD ENGINEER AT (847) 741-9857 MINIMUM OF TWO (2) WEEKS PRIOR TO PLACEMENT OF PERMANENT PAVEMENT MARKINGS.

DOUBLE LANE MARKERS ARE TO BE USED AS SHOWN ON THE DISTRICT ONE DETAIL "TYPICAL APPLICATIONS - RAISED REFLECTIVE PAVEMENT MARKERS (SNOW-PLOW RESISTANT)" SHOWN IN THE PLANS.

THE EXISTING ROADWAY TYPICAL SECTION IS ASSUMED TO HAVE A 3 INCH HOT-MIX ASPHALT OVERLAY ON TOP OF A TEN INCH CONCRETE BASE.

ALL PAVEMENT PATCHES SHOWN IN THE PLANS ARE TWO (2) INCH MILL AND RESURFACE ONLY. THE MINIMUM WIDTH FOR MILLING AND PATCHING SHALL BE TWO (2) FEET.

NO PATCHING OR RESURFACING IS TO BE DONE WITHIN FIFTY (50) FEET OF ANY RAILROAD CROSSING WITHOUT OBTAINING THE PROPER RAILROAD PROTECTIVE LIABILITY INSURANCE.

THE COST OF TRAFFIC CONTROL AND PROTECTION FOR THE PROJECT SHALL BE INCLUDED IN THE COST OF THE ASSOCIATED ROAD WORK.

THE COST OF ANY PARTIAL OR FULL DEPTH PATCHING REQUIRED AFTER THE REMOVAL OF THE EXISTING 2 INCH HOT-MIX ASPHALT SURFACE SHALL BE PAID FOR IN ACCORDANCE WITH ARTICLE 109.04 OF THE STANDARD SPECIFICATIONS.

HOT-MIX ASPHALT MIXTURE REQUIREMENTS

MIXTURE TYPE	AC TYPE	AIR VOIDS (%)
HOT-MIX ASPHALT SURFACE COURSE, MIX "D", N70 (IL 9.5MM), 2"	PG 64-22	4% @ 70 GYR

THE UNIT WEIGHT USED TO CALCULATE ALL HOT-MIX ASPHALT SURFACE MIXTURE QUANTITIES IS 112 LBS/SY/IN.

FILE NAME =	USER NAME = wilgreendp	DESIGNED -	REVISED -	STATE OF ILLINOIS DEPARTMENT OF TRANSPORTATION	INDEX OF SHEETS, STATE STANDARDS AND GENERAL NOTES	F.A. RTE.	SECTION	COUNTY	TOTAL SHEETS	SHEET NO.
ct:\pw\work\PWIDOT\WILGREENDP\d0183613\0183613.dgn	DRAWN -	REVISED -	VAR.			2010-011 RS	KANE	26	2	
PLOT SCALE = 100.0000' / IN.	CHECKED -	REVISED -	CONTRACT NO. 60K30							
PLOT DATE = 2/20/2010	DATE -	REVISED -	FED. ROAD DIST. NO. 1 ILLINOIS FED. AID PROJECT							
					SCALE:	SHEET NO.	OF	SHEETS	STA.	TO STA.

SUMMARY OF QUANTITIES				CONSTRUCTION TYPE CODE					SUMMARY OF QUANTITIES				CONSTRUCTION TYPE CODE						
CODE NO	ITEM	UNIT	TOTAL QUANTITIES						CODE NO	ITEM	UNIT	TOTAL QUANTITIES							
			1000																
40600200	BITUMINOUS MATERIALS (PRIME COAT)	TON	10	10															
40600300	AGGREGATE (PRIME COAT)	TON	49	49															
40600400	MIXTURE FOR CRACKS, JOINTS, AND FLANGEWAYS	TON	37	37															
40600982	HOT-MIX ASPHALT SURFACE REMOVAL - BUTT JOINT	SO YD	733	733															
40603340	HOT-MIX ASPHALT SURFACE COURSE, MIX "D", N70	TON	2734	2734															
44000157	HOT-MIX ASPHALT SURFACE REMOVAL, 2"	SO YD	24403	24403															
67000400	ENGINEER'S FIELD OFFICE, TYPE A	CAL MO	6	6															
67100100	MOBILIZATION	L SUM	1	1															
70300100	SHORT-TERM PAVEMENT MARKING	FOOT	6452	6452															
70301000	WORK ZONE PAVEMENT MARKING REMOVAL	SO FT	2151	2151															
*78000100	THERMOPLASTIC PAVEMENT MARKING - LETTERS AND SYMBOLS	SO FT	100	100															
*78000200	THERMOPLASTIC PAVEMENT MARKING - LINE 4"	FOOT	38340	38340															
*78000400	THERMOPLASTIC PAVEMENT MARKING - LINE 6"	FOOT	1295	1295															
*78000600	THERMOPLASTIC PAVEMENT MARKING - LINE 12"	FOOT	200	200															
*78000650	THERMOPLASTIC PAVEMENT MARKING - LINE 24"	FOOT	175	175															
*78100100	RAISED REFLECTIVE PAVEMENT MARKER	EACH	775	775															
78300200	RAISED REFLECTIVE PAVEMENT MARKER REMOVAL	EACH	775	775															
*88600600	DETECTOR LOOP REPLACEMENT	FOOT	225	225															
X0322256	TEMPORARY INFORMATION SIGNING	SO FT	566	566															
* SPECIALTY ITEM																			

FILE NAME = c:\pw\work\pwl\wlgreendp\d0183613\Design.dgn	USER NAME = wlgreendp	DESIGNED -	REVISED -	STATE OF ILLINOIS DEPARTMENT OF TRANSPORTATION				SUMMARY OF QUANTITIES				F.A. - RTE.	SECTION	COUNTY	TOTAL SHEETS	SHEET NO.			
		DRAWN -	REVISED -									VAR.	2010-011 RS	KANE	26	3			
		CHECKED -	REVISED -													CONTRACT NO. 60K30			
		DATE -	REVISED -									SCALE:	SHEET NO.	OF	SHEETS	STA.	TO STA.	FED. ROAD DIST. NO. 1 ILLINOIS FED. AID PROJECT	

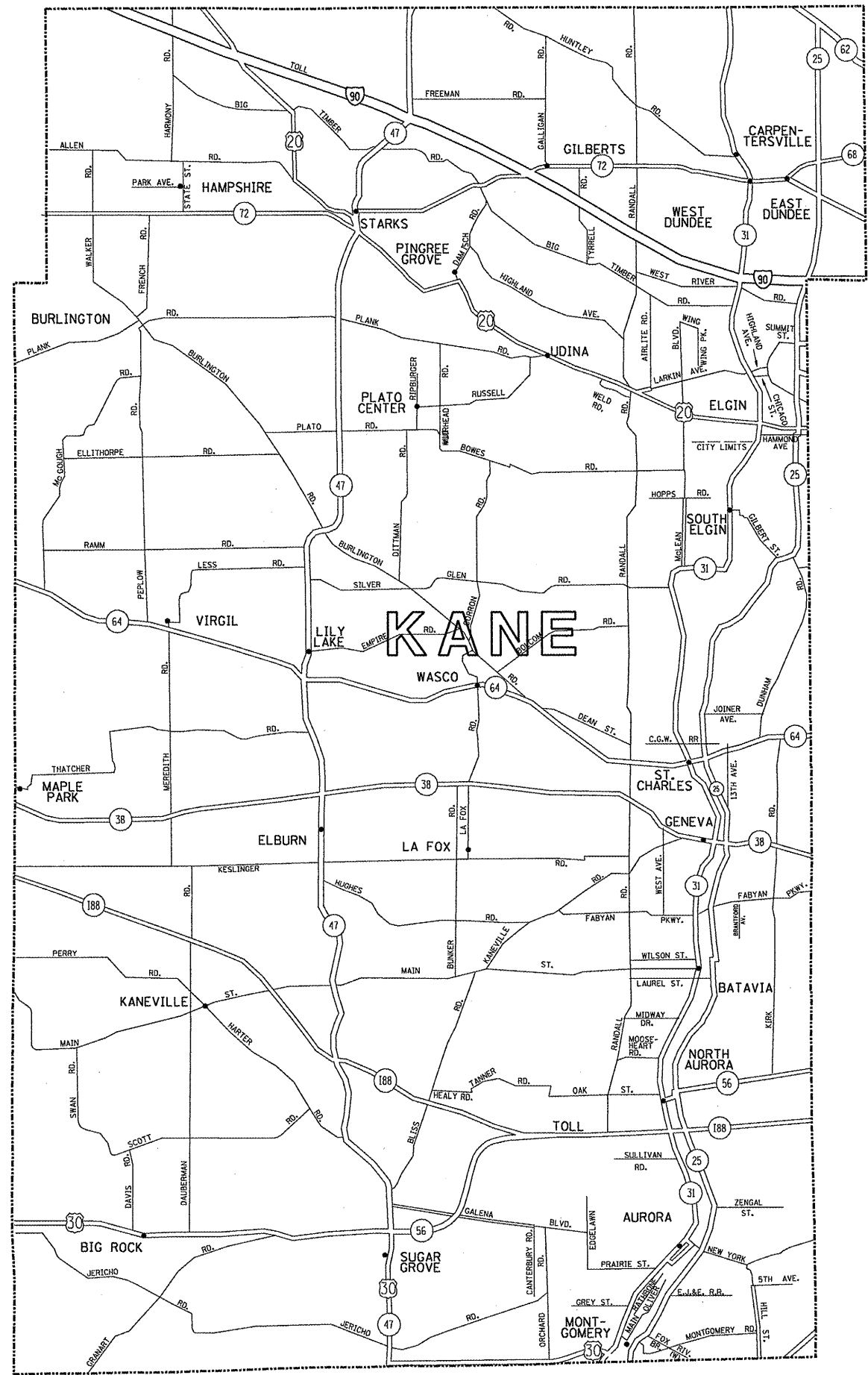

FILE NAME =
 c:\pwwork\p1dot\wilgreendp\d0183613\De

USER NAME = wilgreendp
 DESIGNED -
 DRAWN -
 PLOT SCALE = 100.0000' / IN.
 PLOT DATE = 2/10/2010

DESIGNED -
 DRAWN -
 CHECKED -
 DATE -

REVISED -
 REVISED -
 REVISED -
 REVISED -

**STATE OF ILLINOIS
 DEPARTMENT OF TRANSPORTATION**

GENERAL LOCATION MAP - KANE COUNTY

SCALE: SHEET NO. OF SHEETS STA. TO STA.

F.A. RTE.	SECTION	COUNTY	TOTAL SHEETS	SHEET NO.
VAR.	2010-011 RS	KANE	26	4
CONTRACT NO. 60K30				
[ILLINOIS] FED. AID PROJECT				

SUMMARY - KANE COUNTY ROUTES	HMA 2" MILL & RESURFACE (SY)
IL 25 (JOHNER AVE. TO HAMMOND AVE.)	794
IL 38 (IL 47 TO DEKALB COUNTY LINE)	8782
IL 38 (IL 47 TO RANDALL RD.)	3624
IL 47 (IL 38 TO IL 64)	2441
IL 47 (PLATO RD. TO US 20 / IL 72)	2293
IL 62 (IL 31 TO SANDBLOOM RD.)	457
IL 68 (IL 72 TO IL 62)	965
US 20 RAMPS AT IL 25	739
US 30 (GRIFFIN DR. TO DICKSON RD.)	87
US 30 (US 34 TO HARVEY RD.)	1196
IL 31 (WEBSTER ST. TO FOX VALLEY SANITARY DISTRICT)	3025
KANE COUNTY TOTALS =	24403
	SY

FILE NAME = c:\pwwork\pwwork\wilgreendp\d0183613\Design.dgn	USER NAME = wilgreendp	DESIGNED -	REVISED -	STATE OF ILLINOIS DEPARTMENT OF TRANSPORTATION	SUMMARY OF PATCHING SCHEDULE KANE COUNTY	F.A. RTE.	SECTION	COUNTY	TOTAL SHEETS	SHEET NO.
PLOT SCALE = 100.0000 ' / IN.	DRAWN -	REVISED -	VAR.			2010-011 RS	KANE	26	5	
PLOT DATE = 2/20/2010	CHECKED -	REVISED -	CONTRACT NO. 60K30							
	DATE -	REVISED -	SCALE:			SHEET NO. OF SHEETS	STA. TO STA.	FED. ROAD DIST. NO. 1 ILLINOIS FED. AID PROJECT		

ROUTE: IL 38 (IL 47 to DeKalb County Line)							
CROSS STREETS		DIRECTION (EB/WB) (NB/SB)	LANE NO. (1, 2, 3)	PAVEMENT PATCH WIDTH	PAVEMENT PATCH LENGTH	REPAIR AREA (SQ FT)	REPAIR AREA (SQ YD)
FROM	TO						
IL 47	DeKalb County Line	WB	1	12	6	72	8
IL 47	DeKalb County Line	WB	1	12	6	72	8
IL 47	DeKalb County Line	WB	1	12	6	72	8
IL 47	DeKalb County Line	WB	1	12	6	72	8
IL 47	DeKalb County Line	WB	1	12	6	72	8
IL 47	DeKalb County Line	WB	1	12	6	72	8
IL 47	DeKalb County Line	WB	1	12	12	144	16
IL 47	DeKalb County Line	WB	1	12	18	216	24
IL 47	DeKalb County Line	WB	1	12	6	72	8
IL 47	DeKalb County Line	WB	1	12	6	72	8
IL 47	DeKalb County Line	WB	1	12	12	144	16
IL 47	DeKalb County Line	WB	1	12	18	216	24
IL 47	DeKalb County Line	WB	1	12	6	72	8
IL 47	DeKalb County Line	WB	1	12	24	288	32
IL 47	DeKalb County Line	WB	1	12	6	72	8
IL 47	DeKalb County Line	WB	1	12	8	96	11
IL 47	DeKalb County Line	WB	1	12	6	72	8
IL 47	DeKalb County Line	WB	1	12	6	72	8
IL 47	DeKalb County Line	WB	1	12	26	312	35
IL 47	DeKalb County Line	WB	1	12	6	72	8
IL 47	DeKalb County Line	WB	1	12	6	72	8
IL 47	DeKalb County Line	WB	1	12	6	72	8
IL 47	DeKalb County Line	WB	1	12	12	144	16
IL 47	DeKalb County Line	WB	1	12	12	144	16
IL 47	DeKalb County Line	WB	1	12	12	144	16
IL 47	DeKalb County Line	WB	1	12	8	96	11
IL 47	DeKalb County Line	WB	1	12	6	72	8
IL 47	DeKalb County Line	WB	1	12	24	288	32
IL 47	DeKalb County Line	WB	1	12	6	72	8
IL 47	DeKalb County Line	WB	1	12	6	72	8
IL 47	DeKalb County Line	WB	1	12	24	288	32
IL 47	DeKalb County Line	WB	1	12	6	72	8
IL 47	DeKalb County Line	WB	1	12	8	96	11
IL 47	DeKalb County Line	WB	1	12	6	72	8
IL 47	DeKalb County Line	WB	1	12	6	72	8
IL 47	DeKalb County Line	WB	1	12	6	72	8
IL 47	DeKalb County Line	WB	1	12	6	72	8
IL 47	DeKalb County Line	WB	1	12	8	96	11
IL 47	DeKalb County Line	WB	1	12	8	96	11
IL 47	DeKalb County Line	WB	1	12	6	72	8
IL 47	DeKalb County Line	WB	1	12	6	72	8
IL 47	DeKalb County Line	WB	1	12	12	144	16
IL 47	DeKalb County Line	WB	1	12	12	144	16
IL 47	DeKalb County Line	WB	1	12	12	144	16
IL 47	DeKalb County Line	WB	1	12	18	216	24
IL 47	DeKalb County Line	WB	1	12	6	72	8
IL 47	DeKalb County Line	WB	1	12	6	72	8
IL 47	DeKalb County Line	WB	1	12	6	72	8
IL 47	DeKalb County Line	WB	1	12	8	96	11
IL 47	DeKalb County Line	WB	1	12	8	96	11
IL 47	DeKalb County Line	WB	1	12	6	72	8
IL 47	DeKalb County Line	WB	1	12	24	288	32
IL 47	DeKalb County Line	WB	1	12	6	72	8
IL 47	DeKalb County Line	WB	1	12	8	96	11
IL 47	DeKalb County Line	WB	1	12	24	288	32
IL 47	DeKalb County Line	WB	1	12	18	216	24
IL 47	DeKalb County Line	WB	1	12	6	72	8
IL 47	DeKalb County Line	WB	1	12	8	96	11
IL 47	DeKalb County Line	WB	1	12	36	432	48
IL 47	DeKalb County Line	WB	1	12	8	96	11
IL 47	DeKalb County Line	WB	1	12	6	72	8
IL 47	DeKalb County Line	WB	1	12	8	96	11
IL 47	DeKalb County Line	WB	1	12	8	96	11
IL 47	DeKalb County Line	WB	1	12	8	96	11
IL 47	DeKalb County Line	WB	1	12	8	96	11
IL 47	DeKalb County Line	WB	1	12	8	96	11
IL 47	DeKalb County Line	WB	1	12	8	96	11
IL 47	DeKalb County Line	WB	1	12	8	96	11
IL 47	DeKalb County Line	WB	1	12	8	96	11
IL 47	DeKalb County Line	WB	1	12	8	96	11
IL 47	DeKalb County Line	WB	1	12	8	96	11
IL 47	DeKalb County Line	WB	1	12	8	96	11
IL 47	DeKalb County Line	WB	1	12	8	96	11
IL 47	DeKalb County Line	WB	1	12	12	144	16
IL 47	DeKalb County Line	WB	1	12	8	96	11
IL 47	DeKalb County Line	WB	1	12	10	120	13
IL 47	DeKalb County Line	WB	1	12	10	120	13

ROUTE: IL 38 (IL 47 to DeKalb County Line)							
CROSS STREETS		DIRECTION (EB/WB) (NB/SB)	LANE NO. (1, 2, 3)	PAVEMENT PATCH WIDTH	PAVEMENT PATCH LENGTH	REPAIR AREA (SQ FT)	REPAIR AREA (SQ YD)
FROM	TO						
IL 47	DeKalb County Line	WB	1	12	8	96	11
IL 47	DeKalb County Line	WB	1	12	10	120	13
IL 47	DeKalb County Line	WB	1	12	8	96	11
IL 47	DeKalb County Line	WB	1	12	10	120	13
IL 47	DeKalb County Line	WB	1	12	8	96	11
IL 47	DeKalb County Line	WB	1	12	8	96	11
IL 47	DeKalb County Line	WB	1	12	8	96	11
IL 47	DeKalb County Line	WB	1	12	8	96	11
IL 47	DeKalb County Line	WB	1	12	8	96	11
IL 47	DeKalb County Line	WB	1	12	10	120	13
IL 47	DeKalb County Line	WB	1	12	8	96	11
IL 47	DeKalb County Line	WB	1	12	10	120	13
IL 47	DeKalb County Line	WB	1	12	8	96	11
IL 47	DeKalb County Line	WB	1	12	8	96	11
IL 47	DeKalb County Line	WB	1	12	8	96	11
IL 47	DeKalb County Line	WB	1	12	10	120	13
IL 47	DeKalb County Line	WB	1	12	8	96	11
IL 47	DeKalb County Line	WB	1	12	8	96	11
IL 47	DeKalb County Line	WB	1	12	12	144	16
IL 47	DeKalb County Line	WB	1	12	8	96	11
IL 47	DeKalb County Line	WB	1	12	8	96	11
IL 47	DeKalb County Line	WB	1	12	8	96	11
IL 47	DeKalb County Line	WB	1	12	8	96	11
IL 47	DeKalb County Line	WB	1	12	6	72	8
IL 47	DeKalb County Line	WB	1	12	8	96	11
IL 47	DeKalb County Line	WB	1	12	8	96	11
IL 47	DeKalb County Line	WB	1	12	6	72	8
IL 47	DeKalb County Line	WB	1	12	8	96	11
IL 47	DeKalb County Line	WB	1	12	8	96	11
IL 47	DeKalb County Line	WB	1	12	18	216	24
IL 47	DeKalb County Line	WB	1	12	8	96	11
IL 47	DeKalb County Line	WB	1	12	8	96	11
IL 47	DeKalb County Line	WB	1	12	8	96	11
IL 47	DeKalb County Line	WB	1	12	10	120	13
IL 47	DeKalb County Line	WB	1	12	8	96	11
IL 47	DeKalb County Line	WB	1	12	8	96	11
IL 47	DeKalb County Line	WB	1	12	8	96	11
IL 47	DeKalb County Line	WB	1	12	6	72	8
IL 47	DeKalb County Line	WB	1	12	6	72	8
IL 47	DeKalb County Line	WB	1	12	12	144	16
IL 47	DeKalb County Line	WB	1	12	10	120	13
IL 47	DeKalb County Line	WB	1	12	8	96	11
IL 47	DeKalb County Line	WB	1	12	8	96	11
IL 47	DeKalb County Line	WB	1	12	8	96	11
IL 47	DeKalb County Line	WB	1	12	8	96	11
IL 47	DeKalb County Line	WB	1	12	8	96	11
IL 47	DeKalb County Line	WB	1	12	8	96	11
IL 47	DeKalb County Line	WB	1	12	8	96	11
IL 47	DeKalb County Line	WB	1	12	8	96	11
IL 47	DeKalb County Line	WB	1	12	8	96	11
IL 47	DeKalb County Line	WB	1	12	8	96	11
IL 47	DeKalb County Line	WB	1	12	8	96	11
IL 47	DeKalb County Line	WB	1	12	8	96	11
IL 47	DeKalb County Line	WB	1	12	8	96	11
IL 47	DeKalb County Line	WB	1	12	8	96	11
IL 47	DeKalb County Line	WB	1	12	8	96	11
IL 47	DeKalb County Line	WB	1	12	8	96	11
IL 47	DeKalb County Line	WB	1	12	12	144	16
IL 47	DeKalb County Line	WB	1	12	10	120	13
IL 47	DeKalb County Line	WB	1	12	10	120	13

CONTINUED ON NEXT SHEET

FILE NAME =	USER NAME = wilgreendp	DESIGNED -	REVISED -	STATE OF ILLINOIS DEPARTMENT OF TRANSPORTATION	PATCHING SCHEDULE L 38	F.A. RTE.	SECTION	COUNTY	TOTAL SHEETS	SHEET NO.
cr:\pwwork\VPWIDOT\WILGREENDP\00183613\Design.dgn	DRAWN -	REVISED -	VAR.			2010-011 RS	KANE	26	7	
PLOT SCALE = 100.0000' / IN.	CHECKED -	REVISED -	CONTRACT NO. 60K30							
PLOT DATE = 2/28/2010	DATE -	REVISED -	SCALE:			SHEET NO. OF SHEETS	STA. TO STA.	FED. ROAD DIST. NO. 1 ILLINOIS FED. AID PROJECT		

ROUTE: IL 38 (IL 47 to Randall Rd.)							
CROSS STREETS		DIRECTION (EB/WB) (NB/SB)	LANE NO. (1, 2, 3)	PAVEMENT PATCH WIDTH	PAVEMENT PATCH LENGTH	REPAIR AREA (SQ FT)	REPAIR AREA (SQ YD)
FROM	TO						
IL. 47	POULEY ROAD	EB	1	12	10	120	13
IL. 47	POULEY ROAD	EB	1	12	4	48	5
IL. 47	POULEY ROAD	EB	1	12	4	48	5
IL. 47	POULEY ROAD	EB	1	12	5	60	7
IL. 47	POULEY ROAD	EB	1	2	200	400	44
IL. 47	POULEY ROAD	EB	1	12	4	48	5
IL. 47	POULEY ROAD	EB	1	12	6	72	8
IL. 47	POULEY ROAD	EB	1	12	8	96	11
IL. 47	POULEY ROAD	EB	1	12	4	48	5
IL. 47	POULEY ROAD	EB	1	12	4	48	5
IL. 47	POULEY ROAD	EB	1	2	700	1400	156
IL. 47	POULEY ROAD	EB	1	12	4	48	5
IL. 47	POULEY ROAD	EB	1	12	8	96	11
POULEY ROAD	BOWGREN ROAD	EB	1	2	100	200	22
POULEY ROAD	BOWGREN ROAD	EB	1	2	25	50	6
POULEY ROAD	BOWGREN ROAD	EB	1	12	150	1800	200
POULEY ROAD	BOWGREN ROAD	EB	1	2	25	50	6
POULEY ROAD	BOWGREN ROAD	EB	1	2	500	1000	111
BOWGREN ROAD	BEITH ROAD	EB	1	12	4	48	5
BEITH ROAD	LA FOX ROAD	EB	1	2	400	800	89
BEITH ROAD	LA FOX ROAD	EB	1	2	250	500	56
BEITH ROAD	LA FOX ROAD	EB	1	2	400	800	89
BEITH ROAD	LA FOX ROAD	EB	1	2	150	300	33
BEITH ROAD	LA FOX ROAD	EB	1	12	250	3000	333
BEITH ROAD	LA FOX ROAD	EB	1	2	15	30	3
BEITH ROAD	LA FOX ROAD	EB	1	12	4	48	5
LA FOX ROAD	BRUNDIGE ROAD	EB	1	12	20	240	27
LA FOX ROAD	BRUNDIGE ROAD	EB	1	12	5	60	7
LA FOX ROAD	BRUNDIGE ROAD	EB	1	2	200	400	44
LA FOX ROAD	BRUNDIGE ROAD	EB	1	12	20	240	27
LA FOX ROAD	BRUNDIGE ROAD	EB	1	12	8	96	11
LA FOX ROAD	BRUNDIGE ROAD	EB	1	12	5	60	7
LA FOX ROAD	BRUNDIGE ROAD	EB	1	12	20	240	27
BRUNDIGE ROAD	PECK ROAD	EB	1	2	150	300	33
BRUNDIGE ROAD	PECK ROAD	EB	1	2	300	600	67
BRUNDIGE ROAD	PECK ROAD	EB	1	2	150	300	33
BRUNDIGE ROAD	PECK ROAD	EB	1	2	200	400	44
BRUNDIGE ROAD	PECK ROAD	EB	1	12	15	180	20
BRUNDIGE ROAD	PECK ROAD	EB	1	2	100	200	22
BRUNDIGE ROAD	PECK ROAD	EB	1	2	100	200	22
BRUNDIGE ROAD	PECK ROAD	EB	1	12	5	60	7
BRUNDIGE ROAD	PECK ROAD	EB	1	12	8	96	11
BRUNDIGE ROAD	PECK ROAD	EB	1	2	300	600	67
BRUNDIGE ROAD	PECK ROAD	EB	1	12	4	48	5
BRUNDIGE ROAD	PECK ROAD	EB	1	12	5	60	7
BRUNDIGE ROAD	PECK ROAD	EB	1	12	150	1800	200
BRUNDIGE ROAD	PECK ROAD	EB	1	2	200	400	44
BRUNDIGE ROAD	PECK ROAD	EB	1	2	150	300	33
BRUNDIGE ROAD	PECK ROAD	EB	1	12	6	72	8
BRUNDIGE ROAD	PECK ROAD	EB	1	12	25	300	33

ROUTE: IL 38 (IL 47 to Randall Rd.)							
CROSS STREETS		DIRECTION (EB/WB) (NB/SB)	LANE NO. (1, 2, 3)	PAVEMENT PATCH WIDTH	PAVEMENT PATCH LENGTH	REPAIR AREA (SQ FT)	REPAIR AREA (SQ YD)
FROM	TO						
PECK ROAD	RANDALL ROAD	EB	1	2	100	200	22
PECK ROAD	RANDALL ROAD	EB	1	12	4	48	5
PECK ROAD	RANDALL ROAD	EB	1	2	200	400	44
PECK ROAD	RANDALL ROAD	EB	1	2	175	350	39
PECK ROAD	RANDALL ROAD	EB	1	12	4	48	5
PECK ROAD	RANDALL ROAD	EB	1	12	150	1800	200
RANDALL ROAD	PECK ROAD	WB	1	12	25	300	33
RANDALL ROAD	PECK ROAD	WB	1	12	100	1200	133
RANDALL ROAD	PECK ROAD	WB	1	12	8	96	11
RANDALL ROAD	PECK ROAD	WB	1	2	50	100	11
RANDALL ROAD	PECK ROAD	WB	1	12	20	240	27
RANDALL ROAD	PECK ROAD	WB	1	12	20	240	27
RANDALL ROAD	PECK ROAD	WB	1	2	15	30	3
RANDALL ROAD	PECK ROAD	WB	1	12	5	60	7
PECK ROAD	BRUNDIGE ROAD	WB	1	2	30	60	7
PECK ROAD	BRUNDIGE ROAD	WB	1	12	4	48	5
PECK ROAD	BRUNDIGE ROAD	WB	1	2	50	100	11
PECK ROAD	BRUNDIGE ROAD	WB	1	12	8	96	11
PECK ROAD	BRUNDIGE ROAD	WB	1	2	350	700	78
BRUNDIGE ROAD	LA FOX ROAD	WB	1	12	5	60	7
BRUNDIGE ROAD	LA FOX ROAD	WB	1	12	10	120	13
BRUNDIGE ROAD	LA FOX ROAD	WB	1	12	5	60	7
BRUNDIGE ROAD	LA FOX ROAD	WB	1	2	30	60	7
LA FOX ROAD	BEITH ROAD	WB	1	12	15	180	20
LA FOX ROAD	BEITH ROAD	WB	1	12	25	300	33
LA FOX ROAD	BEITH ROAD	WB	1	12	10	120	13
LA FOX ROAD	BEITH ROAD	WB	1	12	100	1200	133
LA FOX ROAD	BEITH ROAD	WB	1	12	20	240	27
LA FOX ROAD	BEITH ROAD	WB	1	12	4	48	5
LA FOX ROAD	BEITH ROAD	WB	1	12	8	96	11
BEITH ROAD	HARLEY ROAD	WB	1	12	4	48	5
BEITH ROAD	HARLEY ROAD	WB	1	12	8	96	11
BEITH ROAD	HARLEY ROAD	WB	1	2	200	400	44
HARLEY ROAD	POULEY ROAD	WB	1	2	500	1000	111
HARLEY ROAD	POULEY ROAD	WB	1	12	15	180	20
HARLEY ROAD	POULEY ROAD	WB	1	12	4	48	5
POULEY ROAD	ANDERSON ROAD	WB	1	12	4	48	5
POULEY ROAD	ANDERSON ROAD	WB	1	2	15	30	3
POULEY ROAD	ANDERSON ROAD	WB	1	12	4	48	5
POULEY ROAD	ANDERSON ROAD	WB	1	12	4	48	5
POULEY ROAD	ANDERSON ROAD	WB	1	12	4	48	5
POULEY ROAD	ANDERSON ROAD	WB	1	12	4	48	5
POULEY ROAD	ANDERSON ROAD	WB	1	12	6	72	8
POULEY ROAD	ANDERSON ROAD	WB	1	12	4	48	5
POULEY ROAD	ANDERSON ROAD	WB	1	12	4	48	5
ANDERSON ROAD	IL. 47	WB	1	12	4	48	5
ANDERSON ROAD	IL. 47	WB	1	12	4	48	5
ANDERSON ROAD	IL. 47	WB	1	12	4	48	5
ANDERSON ROAD	IL. 47	WB	1	12	4	48	5
ANDERSON ROAD	IL. 47	WB	1	12	150	1800	200
ANDERSON ROAD	IL. 47	WB	1	12	50	600	67
ANDERSON ROAD	IL. 47	WB	1	12	50	600	67
TOTALS:						8076	3624
						FT	SY

ROUTE: IL 47 (IL 38 to IL 64)							
CROSS STREETS		DIRECTION	LANE	PAVEMENT	PAVEMENT	REPAIR	REPAIR
FROM	TO	(EB/WB)	NO.	PATCH	PATCH	AREA	AREA
		(NB/SB)	(1, 2, 3)	WIDTH	LENGTH	(SQ FT)	(SQ YD)
IL 64	IL 38	SB	1	12	6	72	8
		SB	1	12	18	216	24
		SB	1	12	6	72	8
		SB	1	12	36	432	48
		SB	1	12	18	216	24
		SB	1	12	8	96	11
		SB	1	12	24	288	32
		SB	1	12	18	216	24
		SB	1	12	12	144	16
		SB	1	12	24	288	32
		SB	1	12	6	72	8
		SB	1	12	8	96	11
		SB	1	12	6	72	8
		SB	1	2	80	160	18
		SB	1	12	4	48	4
		SB	1	12	8	96	11
		SB	1	12	4	48	4
		SB	1	2	120	240	27
		SB	1	12	4	48	4
		SB	1	12	4	48	4
		SB	1	12	6	72	8
		SB	1	12	12	144	16
		SB	1	12	4	48	4
		SB	1	12	6	72	8
		SB	1	12	24	288	32
		SB	1	12	8	96	11
		SB	1	12	8	96	11
		SB	1	12	6	72	8
		SB	1	12	6	72	8
		SB	1	12	12	144	16
		SB	1	12	4	48	4
		SB	1	12	4	48	4
		SB	1	12	4	48	4
		SB	1	12	8	96	11
		SB	1	12	4	48	4
		SB	1	2	140	280	31
		SB	1	12	12	144	16
		SB	1	12	4	48	4
		SB	1	12	6	72	8
		SB	1	12	26	312	35
		SB	1	12	36	432	48
		SB	1	12	12	144	16
IL 64	IL 38	SB	1	12	12	144	16
				TOTALS:		2155	2441
						FT	SY

ROUTE: IL 62 (IL 31 to Sandbloom Rd.)							
CROSS STREETS		DIRECTION	LANE	PAVEMENT	PAVEMENT	REPAIR	REPAIR
FROM	TO	(EB/WB)	NO.	PATCH	PATCH	AREA	AREA
		(NB/SB)	(1, 2, 3)	WIDTH	LENGTH	(SQ FT)	(SQ YD)
IL 31		EB	2	12	4	48	5
		EB	2	12	4	48	5
		EB	2	12	8	96	11
		EB	1	12	4	48	5
		EB	1	7 x 12	3	252	28
		EB	2	6 x 12	3	216	24
		EB	2	12	4	48	5
Longwood Eastgate	Longwood Eastgate	EB	1	12	4	48	5
		EB	2	12	4	48	5
Eastgate		EB	2	12	4	48	5
		EB	2	2	80	160	18
		EB	1	12	4	48	5
		EB	2	12	4	48	5
		EB	2	2	4	8	1
		EB	1	6 x 12	3	216	24
		EB	2	17 x 12	3	612	68
Sandbloom		WB	1	12	4	48	5
		WB	1	12	12	144	16
		WB	1	12	8	96	11
Eastgate	Eastgate	WB	1	8 x 12	3	288	32
		WB	2	20 x 12	3	720	80
		WB	1	12	4	48	5
		WB	2	12	4	48	5
		WB	joint	2	20	40	4
		WB	joint	2	40	80	9
		WB	1	7 x 12	3	252	28
	IL 31	WB	2	10 x 12	3	360	40
		TOTALS:				244	457
						FT	SY

ROUTE: US 30 (Griffin Dr. to Dickson Rd.)							
CROSS STREETS		DIRECTION	LANE	PAVEMENT	PAVEMENT	REPAIR	REPAIR
FROM	TO	(EB/WB)	NO.	PATCH	PATCH	AREA	AREA
		(NB/SB)	(1, 2, 3)	WIDTH	LENGTH	(SQ FT)	(SQ YD)
1000 ft E of Prescott	Prescott Dr	WB		12	40	480	53
		WB		12	25	300	33
TOTALS:						65	87
					FT		SY

ROUTE: US 30 (US 34 to Harvey Rd.)							
CROSS STREETS		DIRECTION	LANE	PAVEMENT	PAVEMENT	REPAIR	REPAIR
FROM	TO	(EB/WB)	NO.	PATCH	PATCH	AREA	AREA
		(NB/SB)	(1, 2, 3)	WIDTH	LENGTH	(SQ FT)	(SQ YD)
US 34		SB	1	12	12	144	16
		NB	1	6	10	60	7
		NB	1	12	160	1920	213
		NB	1	12	360	4320	480
	HARVEY	NB	1	12	360	4320	480
TOTALS:						902	1196
					FT		SY

FILE NAME =	USER NAME = wilgreendp	DESIGNED -	REVISED -	STATE OF ILLINOIS DEPARTMENT OF TRANSPORTATION	PATCHING SCHEDULE US 30			F.A. RTE.	SECTION	COUNTY	TOTAL SHEETS	SHEET NO.			
ct\pwwork\pwwid\WILGREENDP\d0183613\0	esign.dgn	DRAWN -	REVISED -		SCALE:	SHEET NO.	OF	SHEETS	STA.	TO STA.	VAR.	2010-011 RS	KANE	26	18
		CHECKED -	REVISED -												
		DATE -	REVISED -												

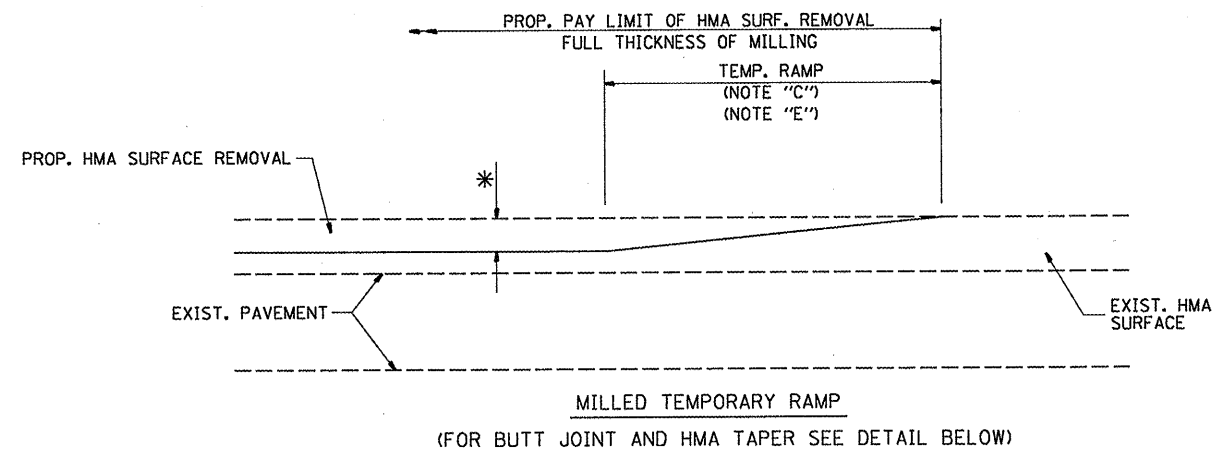

OPTION 1

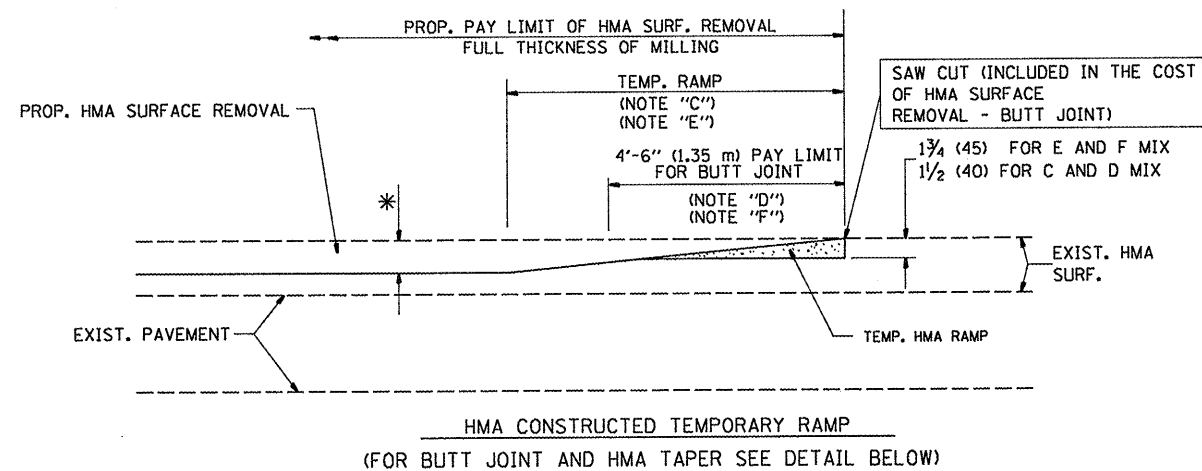

**OPTION 2
TYPICAL TEMPORARY RAMP**

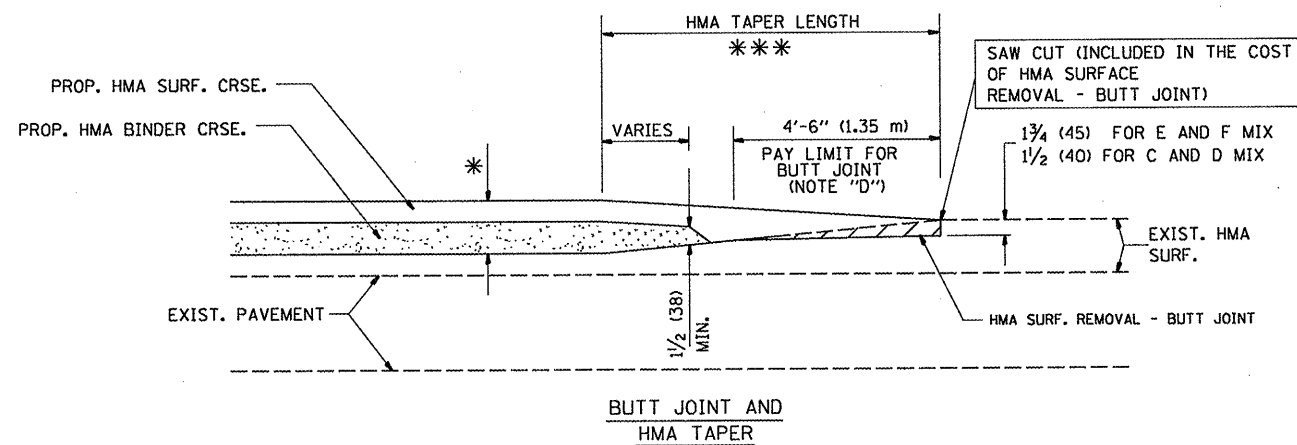

**TYPICAL BUTT JOINT AND HMA TAPER
FOR MILLING AND RESURFACING**

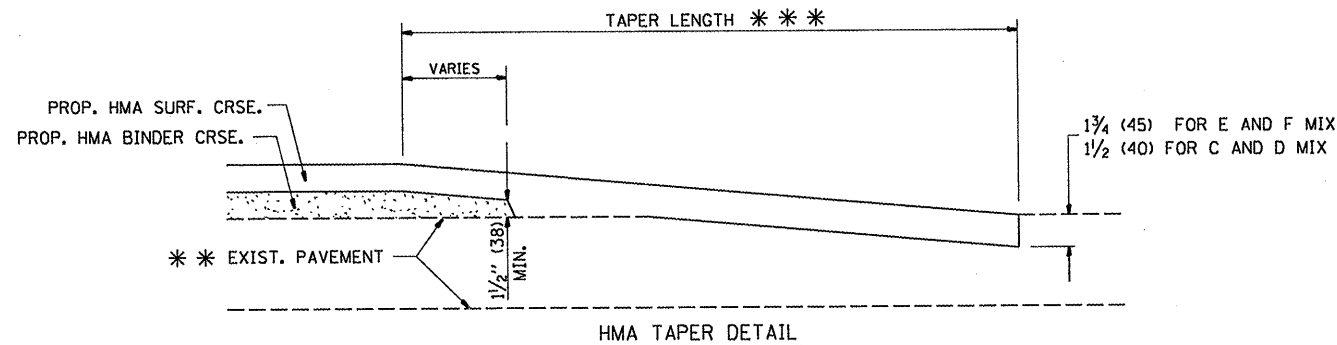
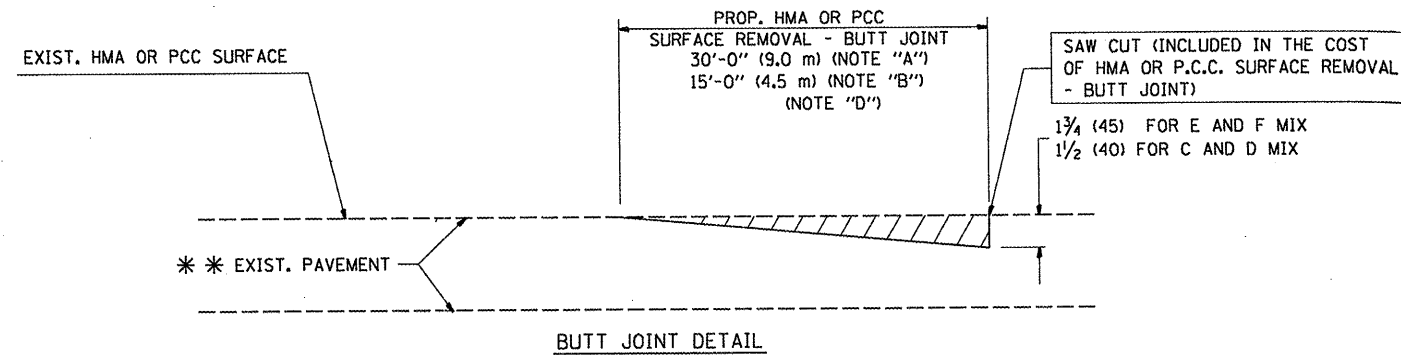

**TYPICAL BUTT JOINT AND HMA TAPER
FOR RESURFACING ONLY**

*** PC CONCRETE, HMA OR HMA RESURFACED PAVEMENT.

NOTES

- A: MAINLINE ROADWAYS AND MAJOR SIDE ROADS.
 - B: MINOR SIDE ROADS.
 - C: THE TEMP. RAMP SHALL BE CONSTRUCTED IMMEDIATELY UPON REMOVAL OF THE EXISTING HMA SURFACE.
 - D: THE BUTT JOINT SHALL BE CONSTRUCTED IMMEDIATELY PRIOR TO PLACING THE PROPOSED HMA COURSES.
 - E: TAPER THE TEMP. RAMP AT A RATE OF 3'-0" (900 mm) PER 1 INCH (25 mm) OF MILLING THICKNESS.
 - F: INSTALLATION AND REMOVAL OF THE 4'-6" (1.35 m) TEMP. RAMP IS INCLUDED IN COST OF HMA SURFACE REMOVAL - BUTT JOINT
 - G: SEE ARTICLE 406.08 AND 406.14 OF THE STANDARD SPECIFICATIONS FOR "HMA AND/OR PCC SURFACE REMOVAL, BUTT JOINT".
- * SEE TYPICAL SECTIONS FOR MILLING THICKNESS.
- *** 20'-0" (6.1 m) PER 1 (25) RESURFACING (NOTE "A")
10'-0" (3.0 m) PER 1 (25) RESURFACING (NOTE "B")

BASIS OF PAYMENT:

THE BUTT JOINT WILL BE PAID FOR AT THE CONTRACT UNIT PRICE PER SQUARE YARD (SQUARE METER) FOR "HOT-MIX ASPHALT SURFACE REMOVAL - BUTT JOINT" OR FOR "PORTLAND CEMENT CONCRETE SURFACE REMOVAL - BUTT JOINT".

ALL DIMENSIONS ARE IN INCHES (MILLIMETERS) UNLESS OTHERWISE SHOWN.

FILE NAME =	USER NAME = wilgreendp	DESIGNED - M. DE YONG	REVISED - R. SHAH 10-25-94
ct:\pw\work\NPWIDOT\WILGREENDP\d0183609.dwg	estStd.dgn	DRAWN -	REVISED - A. ABBAS 03-21-97
PLOT SCALE = 1/8" = 1' / IN.	CHECKED -	REVISED - M. GOMEZ 04-06-01	
PLOT DATE = 2/22/2010	DATE - 06-13-90	REVISED - R. BORO 01-01-07	

**STATE OF ILLINOIS
DEPARTMENT OF TRANSPORTATION**

BUTT JOINT AND HMA TAPER DETAILS			
SCALE: NONE	SHEET NO. 1 OF 1 SHEETS	STA.	TO STA.

F.A. RTE. VAR.	SECTION 2010-011 RS	COUNTY KANE	TOTAL SHEETS 26	SHEET NO. 20
BD400-05 BD32			CONTRACT NO. 60K30	
FED. ROAD DIST. NO. 1 ILLINOIS FED. AID PROJECT				

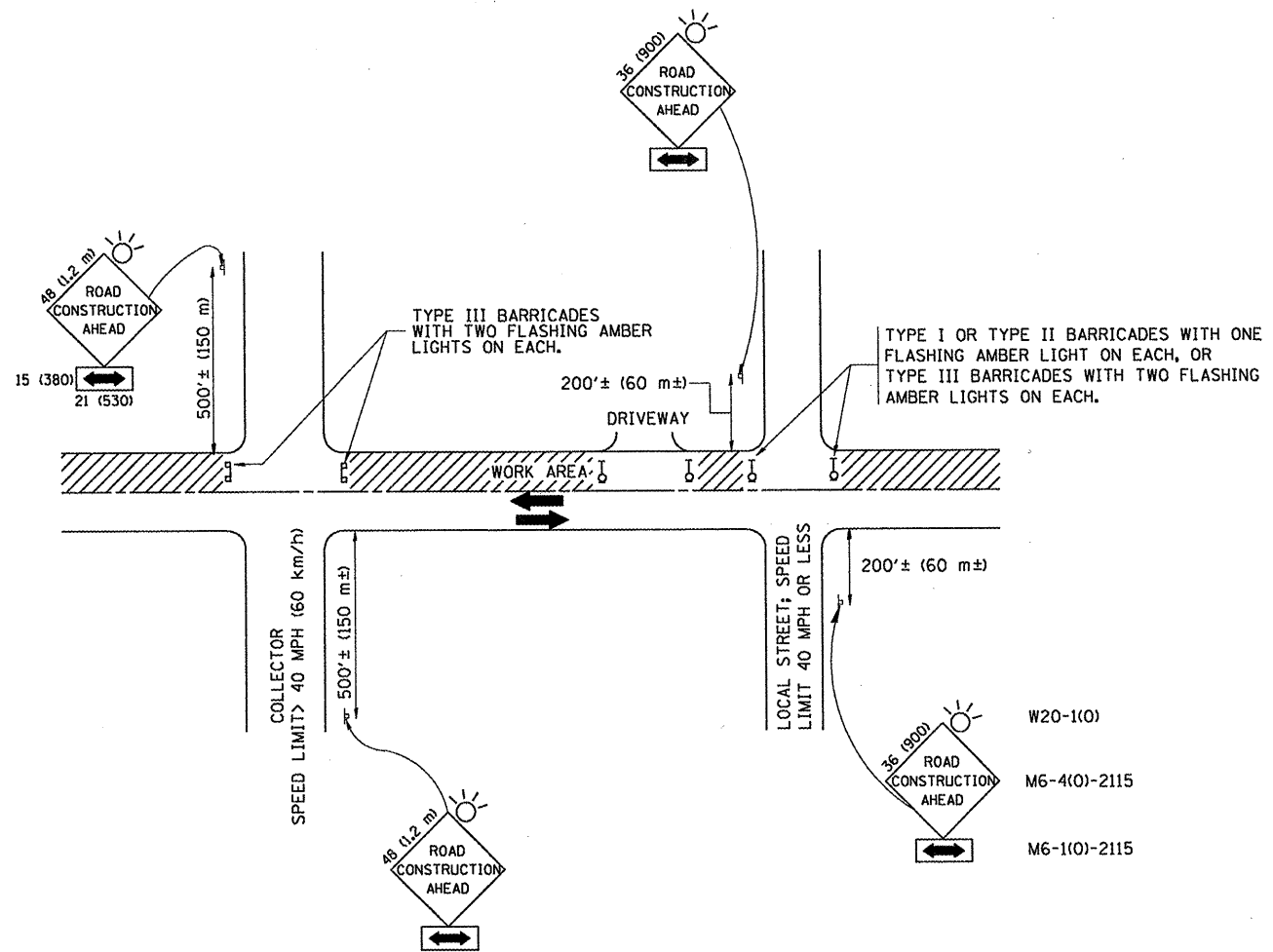

TRAFFIC CONTROL AND PROTECTION FOR SIDE ROADS, INTERSECTIONS, AND DRIVEWAYS

NOTES:

A. FOR NO LANE RESTRICTION ON THE SIDE ROAD OR DRIVEWAYS

1. SIDE ROAD WITH A SPEED LIMIT OF 40 MPH (60 km/h) OR LESS AS SHOWN ON THE DRAWING AND AS DIRECTED BY THE ENGINEER:
 - a) ONE ROAD CONSTRUCTION AHEAD SIGN 36 x 36 (900x900) WITH A FLASHER AND FLAG MOUNTED ON IT APPROXIMATELY 200' (60 m) IN ADVANCE OF THE MAIN ROUTE.
 - b) THE CLOSED PORTION OF THE MAIN ROUTE SHALL BE PROTECTED BY BLOCKING WITH TYPE I, TYPE II OR TYPE III BARRICADES, 1/3 OF THE CROSS SECTION OF THE CLOSED PORTION.
2. SIDE ROAD WITH A SPEED LIMIT GREATER THAN 40 MPH (60 km/h) AS SHOWN ON THE DRAWING AND AS DIRECTED BY THE ENGINEER:
 - a) ONE ROAD CONSTRUCTION AHEAD SIGN 48 x 48 (1.2 m x 1.2 m) WITH A FLASHER MOUNTED ON IT APPROXIMATELY 500' (150 m) IN ADVANCE OF THE MAIN ROUTE.
 - b) THE CLOSED PORTION OF THE MAIN ROUTE SHALL BE PROTECTED BY BLOCKING WITH TYPE III BARRICADES, 1/2 OF THE CROSS SECTION OF THE CLOSED PORTION.
3. WHEN THE SIDE ROAD LIES BETWEEN THE BEGINNING OF THE MAINLINE SIGNING AND THE WORK ZONE, A SINGLE HEADED ARROW (M6-1) SHALL BE USED IN LIEU OF THE DOUBLE HEADED ARROW (M6-4).

B. FOR A LANE CLOSURE ON A SIDE ROAD OR DRIVEWAY:

USE APPLICABLE PORTIONS OF THE TYPICAL APPLICATION OF TRAFFIC CONTROL DEVICES (STD. 701501, STD. 701606 OR THE APPROPRIATE STANDARD). THE SPACING OF SIGNS AND BARRICADES SHALL BE ADJUSTED FOR FIELD CONDITIONS AS DIRECTED BY THE ENGINEER. THE DIRECTIONAL ARROW SHALL BE COVERED OR REMOVED WHEN NO LONGER CONSISTENT WITH THE SIDE ROAD LANE CLOSURE.

C. ADVANCE WARNING SIGNS ARE TO BE OMITTED ON DRIVEWAY UNLESS OTHERWISE NOTED.

D. THE TRAFFIC CONTROL AND PROTECTION FOR SIDE ROADS, INTERSECTIONS, AND DRIVEWAYS SHALL BE INCIDENTAL TO THE COST OF SPECIFIED TRAFFIC CONTROL STANDARDS OR ITEMS.

All dimensions are in millimeters (inches) unless otherwise shown.

FILE NAME =	USER NAME = wilg-eendp	DESIGNED - LHA	REVISED - J. OBERLE 10-18-95
ca:\pwr\work\PIWIDOT\WILGREENDP\d0183609\stStd.dgn		DRAWN -	REVISED - A. HOUSEH 03-06-96
PLOT SCALE = 100.0000 "/ IN.		CHECKED -	REVISED - A. HOUSEH 10-15-96
PLOT DATE = 2/22/2010		DATE - 06-89	REVISED - T. RAMMACHER 01-06-00

**STATE OF ILLINOIS
DEPARTMENT OF TRANSPORTATION**

**TRAFFIC CONTROL AND PROTECTION FOR
SIDE ROADS, INTERSECTIONS, AND DRIVEWAYS**

SCALE: NONE SHEET NO. 1 OF 1 SHEETS STA. TO STA.

F.A. RTE.	SECTION	COUNTY	TOTAL SHEETS	SHEET NO.
VAR.	2010-011 RS	KANE	26	21
TC-10			CONTRACT NO. 60K30	
FED. ROAD DIST. NO. 1 ILLINOIS FED. AID PROJECT				

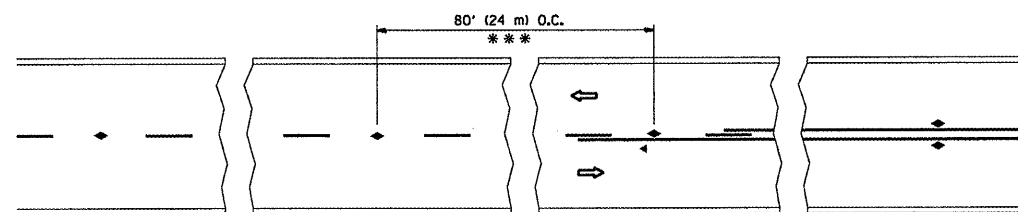

*** REDUCE TO 40' (12 m) O.C. ON CURVES WITH POSTED OR ADVISORY SPEED 45 M.P.H. (70 km/h) OR LESS.

TWO-LANE/TWO-WAY

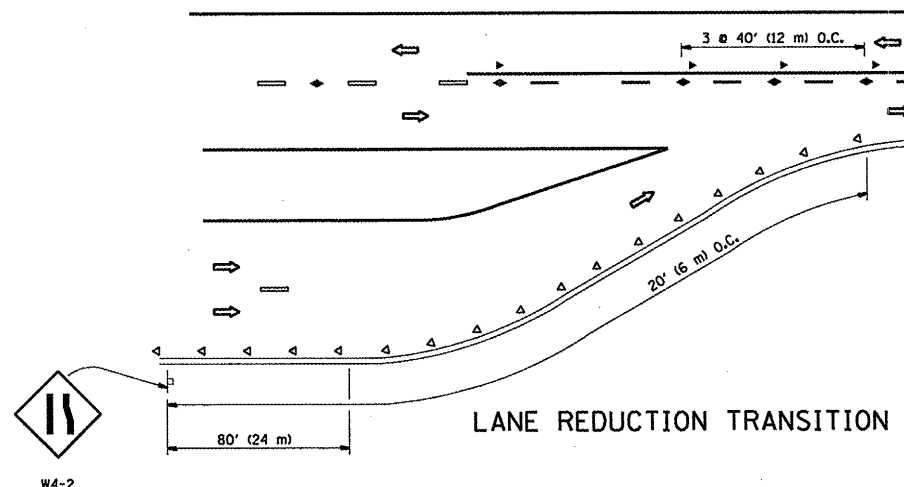

LANE REDUCTION TRANSITION

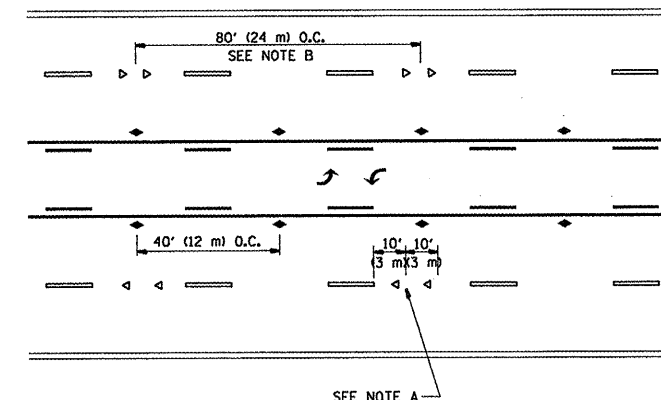

TWO-WAY LEFT TURN

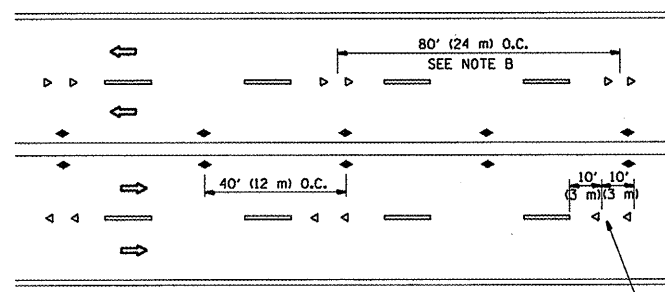

MULTI-LANE/UNDIVIDED

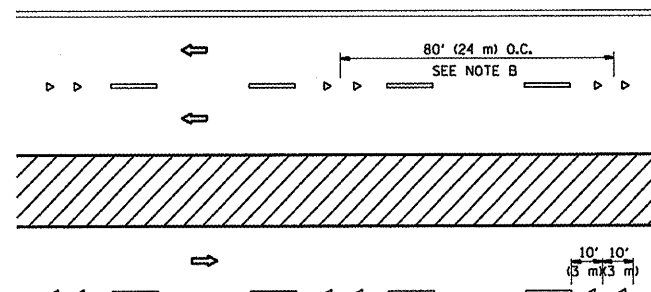

MULTI-LANE/DIVIDED

GENERAL NOTES

1. MARKERS USED WITH DASHED LINES SHALL BE CENTERED IN THE GAP BETWEEN SEGMENTS.
2. MARKERS USED ADJACENT TO SOLID LINES SHALL BE OFFSET 2 TO 3 (50 TO 75) TOWARD TRAFFIC AS SHOWN.
3. MARKERS THROUGH TANGENTS LESS THAN 500' (150 m) IN LENGTH BETWEEN CURVES SHALL BE INSTALLED AT THE LESSER OF THE TWO CURVE SPACINGS.

SYMBOLS

- YELLOW STRIPE
- WHITE STRIPE
- ◀ ONE-WAY AMBER MARKER
- ◀ ONE-WAY CRYSTAL MARKER (W/O)
- ◀ TWO-WAY AMBER MARKER

LANE MARKER NOTES

- A. USE DOUBLE LANE LINE MARKERS SPACED AS SHOWN.
- B. REDUCE TO 40' (12 m) O.C. ON CURVES WHERE ADVISORY SPEEDS ARE 10 M.P.H. (20 km/h) LOWER THAN POSTED SPEEDS.

DESIGN NOTES

1. DOUBLE LANE LINE MARKERS SHALL BE USED UNLESS SPECIFIED OTHERWISE.
2. EXCEPT AS SHOWN ON THE LANE REDUCTION TRANSITION AND FREEWAY EXIT RAMP DETAIL, MARKERS ARE NOT TO BE SPECIFIED ON RIGHT EDGE LINES.
3. THE EXACT MARKER LIMITS, SPACING, AND COLOR SHOULD BE INCLUDED IN THE PLANS.
4. MARKERS SHOULD NOT BE USED ALONGSIDE CURBS EXCEPT FOR EXTREMELY SHORT SECTIONS OF CURBS WHERE NOT MORE THAN TWO MARKERS WOULD BE INVOLVED.

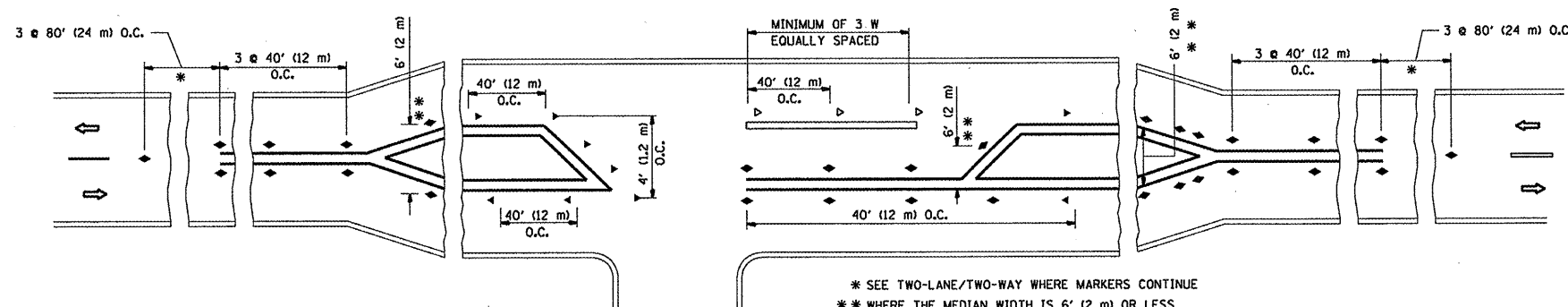

LEFT TURN

* SEE TWO-LANE/TWO-WAY WHERE MARKERS CONTINUE
 ** WHERE THE MEDIAN WIDTH IS 6' (2 m) OR LESS USE TWO-WAY MARKERS.

All dimensions are in inches (millimeters) unless otherwise shown.

FILE NAME =	USER NAME = wilgreendp	DESIGNED -	REVISED - T. RAMMACHER 09-19-94	STATE OF ILLINOIS DEPARTMENT OF TRANSPORTATION	TYPICAL APPLICATIONS			F.A. RTE.	SECTION	COUNTY	TOTAL SHEETS	SHEET NO.
et\pwork\VPWIDOT\WILGREENDP\0183609\Std.dgn	estStd.dgn	DRAWN -	REVISED - T. RAMMACHER 03-12-99		RAISED REFLECTIVE PAVEMENT MARKERS (SNOW-PLOW RESISTANT)			VAR.	2010-011 RS	KANE	26	22
PLOT SCALE = 1/8" = 1' / IN.		CHECKED -	REVISED - T. RAMMACHER 01-06-00		SCALE: NONE	SHEET NO. 1	OF 1 SHEETS	STA.	TO STA.	TC-11	CONTRACT NO.	60K30
PLOT DATE = 2/22/2010		DATE -	REVISED - C. JUCIUS 09-09-09		FED. ROAD DIST. NO. 1 ILLINOIS FED. AID PROJECT							

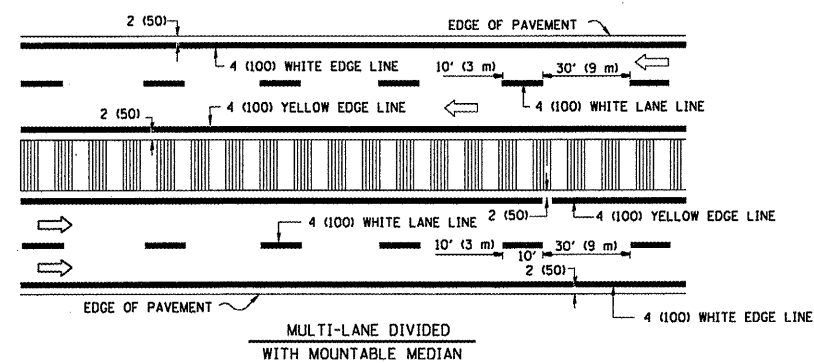
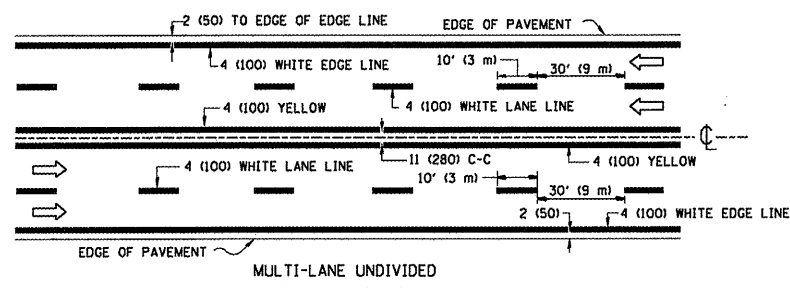
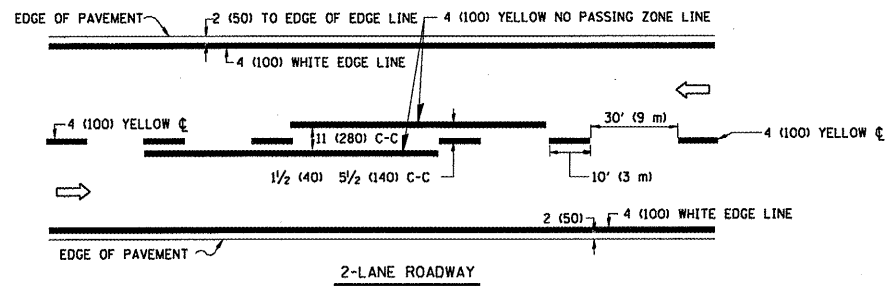

NOTE: MEDIANS WITH BARRIER CURB DO NOT REQUIRE AN EDGE LINE

TYPICAL LANE AND EDGE LINE MARKING

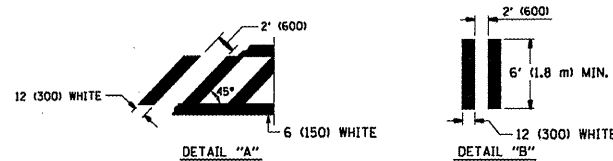
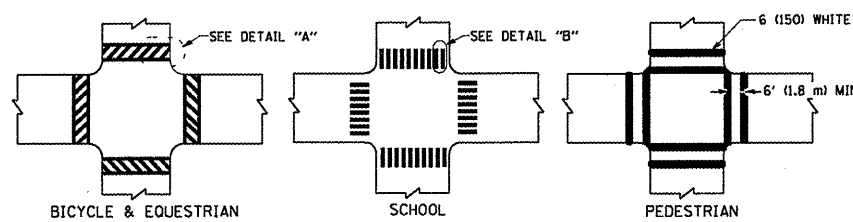

TYPICAL CROSSWALK MARKING

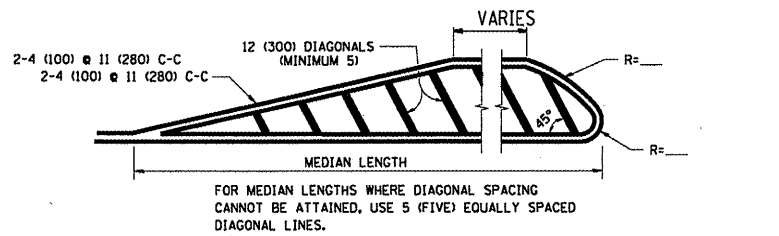
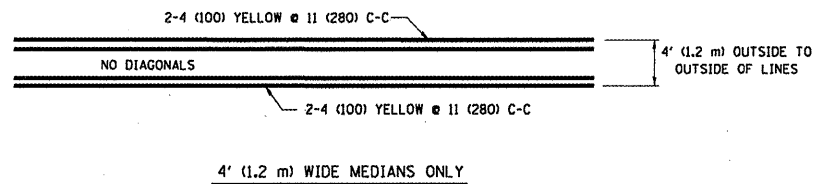

DIAGONAL LINE SPACING: 50' (15 m) C-C (LESS THAN 30MPH (50 km/h))
75' (25 m) C-C (30MPH (50 km/h) TO 45MPH (70 km/h))
150' (45 m) C-C (MORE THAN 45MPH (70 km/h))

MEDIANS OVER 4' (1.2 m) WIDE

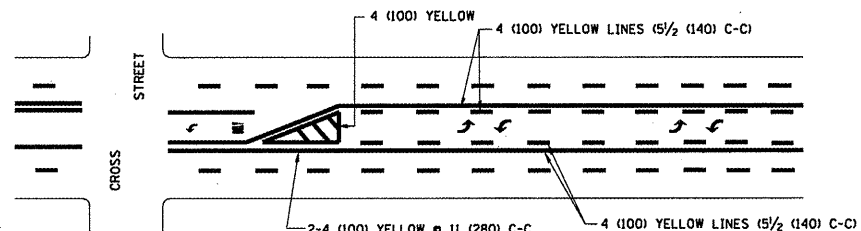

A MINIMUM OF TWO PAIRS OF TURN ARROWS SHALL BE USED, WHITE IN COLOR. ADDITIONAL PAIRS SHALL BE PLACED AT 200' (60 m) TO 300' (90 m) INTERVALS.

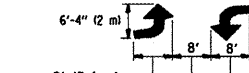

MEDIAN WITH TWO-WAY LEFT TURN LANE

TYPICAL PAINTED MEDIAN MARKING

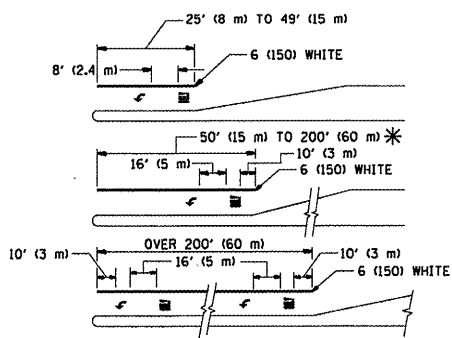

FULL SIZE LETTERS 8' (2.4 m) AND ARROWS SHALL BE USED.
AREA = 15.6 SQ. FT. (1.5 m²) ONLY AREA = 20.8 SQ. FT. (1.9 m²)

* TURN LANES IN EXCESS OF 400' (120 m) IN LENGTH MAY HAVE AN ADDITIONAL SET OF ARROW - "ONLY" INSTALLED MIDWAY BETWEEN THE OTHER TWO SETS OF ARROW - "ONLY".

TYPICAL LEFT (OR RIGHT) TURN LANE

TYPICAL TURN LANE MARKING

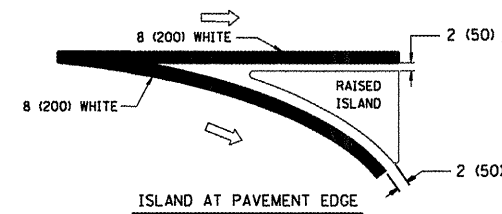
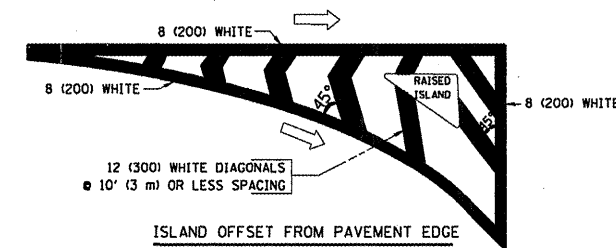

TYPICAL ISLAND MARKING

TYPE OF MARKING	WIDTH OF LINE	PATTERN	COLOR	SPACING / REMARKS
CENTERLINE ON 2 LANE PAVEMENT	4 (100)	SKIP-DASH	YELLOW	10' (3 m) LINE WITH 30' (9 m) SPACE
CENTERLINE ON MULTI-LANE UNDIVIDED PAVEMENT	2 @ 4 (100)	SOLID	YELLOW	11 (280) C-C
NO PASSING ZONE LINES: FOR ONE DIRECTION FOR BOTH DIRECTIONS	4 (100) 2 @ 4 (100)	SOLID SOLID	YELLOW YELLOW	5 1/2' (140) C-C FROM SKIP-DASH CENTERLINE 11 (280) C-C OMIT SKIP-DASH CENTERLINE BETWEEN
LANE LINES	4 (100) 5 (125) ON FREEWAYS	SKIP-DASH SKIP-DASH	WHITE WHITE	10' (3 m) LINE WITH 30' (9 m) SPACE
DOTTED LINES (EXTENSIONS OF CENTER, LANE OR TURN LANE MARKINGS)	SAME AS LINE BEING EXTENDED	SKIP-DASH	SAME AS LINE BEING EXTENDED	2' (600) LINE WITH 6' (1.8 m) SPACE
EDGE LINES	4 (100)	SOLID	YELLOW-LEFT WHITE-RIGHT	OUTLINE MOUNTABLE MEDIANS IN YELLOW; EDGE LINES ARE NOT USED NEXT TO BARRIER CURB
TURN LANE MARKINGS	6 (150) LINE; FULL SIZE LETTERS & SYMBOLS (8' (2.4m))	SOLID	WHITE	SEE TYPICAL TURN LANE MARKING DETAIL
TWO WAY LEFT TURN MARKING	2 @ 4 (100) EACH DIRECTION 8' (2.4m) LEFT ARROW	SKIP-DASH AND SOLID IN PAIRS	YELLOW WHITE	10' (3 m) LINE WITH 30' (9 m) SPACE FOR SKIP-DASH; 5 1/2' (140) C-C BETWEEN SOLID LINE AND SKIP-DASH LINE SEE TYPICAL TWO-WAY LEFT TURN MARKING DETAIL
CROSSWALK LINES (PEDESTRIAN) A. DIAGONALS (BIKE & EQUESTRIAN) B. LONGITUDINAL BARS (SCHOOL)	2 @ 6 (150) 12 (300) @ 45° 12 (300) @ 90°	SOLID SOLID SOLID	WHITE WHITE WHITE	NOT LESS THAN 6' (1.8 m) APART 2' (600) APART SEE TYPICAL CROSSWALK MARKING DETAILS.
STOP LINES	24 (600)	SOLID	WHITE	PLACE 4' (1.2 m) IN ADVANCE OF AND PARALLEL TO CROSSWALK, IF PRESENT. OTHERWISE, PLACE AT DESIRED STOPPING POINT. PARALLEL TO CROSSROAD CENTERLINE, WHERE POSSIBLE
PAINTED MEDIANS	2 @ 4 (100) WITH 12 (300) DIAGONALS @ 45° NO DIAGONALS USED FOR 4' (1.2 m) WIDE MEDIANS	SOLID	YELLOW; TWO WAY TRAFFIC WHITE; ONE WAY TRAFFIC	11 (280) C-C FOR THE DOUBLE LINE SEE TYPICAL PAINTED MEDIAN MARKING.
GORE MARKING AND CHANNELIZING LINES	8 (200) WITH 12 (300) DIAGONALS @ 45°	SOLID	WHITE	DIAGONALS: 15' (4.5 m) C-C (LESS THAN 30MPH (50 km/h)) 20' (6 m) C-C (30MPH (50 km/h) TO 45MPH (70 km/h)) 30' (9 m) C-C (OVER 45MPH (70 km/h))
RAILROAD CROSSING	24 (600) TRANSVERSE LINES; "RR" IS 6' (1.8 m) LETTERS; 16 (400) LINE FOR "X"	SOLID	WHITE	SEE STATE STANDARD 780001 AREA OF: "R"=3.6 SQ. FT. (0.33 m ²) EACH "X"=54.0 SQ. FT. (5.0 m ²)
SHOULDER DIAGONALS	12 (300) @ 45°	SOLID	WHITE - RIGHT YELLOW - LEFT	50' (15 m) C-C (LESS THAN 30MPH (50 km/h)) 75' (25 m) C-C (30 MPH (50 km/h) TO 45MPH (70 km/h)) 150' (45 m) C-C (OVER 45MPH (70 km/h))

FOR FURTHER DETAILS ON PAVEMENT MARKING REFER TO STANDARD SPECIFICATIONS FOR ROAD AND BRIDGE CONSTRUCTION AND STATE STANDARD 780001.

All dimensions are in inches (millimeters) unless otherwise shown.

FILE NAME =	USER NAME = wilgreendp	DESIGNED - EVERS	REVISED - T. RAMMACHER 10-27-94
ca:\pwwork\p\DOT\WILGREENDP\d0183559\d0183559.dgn		DRAWN -	REVISED - C. JUCCIUS 09-09-09
PLOT SCALE = 100.0000 / IN.		CHECKED -	REVISED -
PLOT DATE = 2/17/2010		DATE - 03-19-90	REVISED -

**STATE OF ILLINOIS
DEPARTMENT OF TRANSPORTATION**

**DISTRICT ONE
TYPICAL PAVEMENT MARKINGS**

SCALE: NONE SHEET NO. 1 OF 1 SHEETS STA. TO STA.

F.A. RTE.	SECTION	COUNTY	TOTAL SHEETS	SHEET NO.
VAR.	2010-011 RS	KANE	26	23
TC-13			CONTRACT NO. 60K30	
FED. ROAD DIST. NO. 1 [ILLINOIS] FED. AID PROJECT				

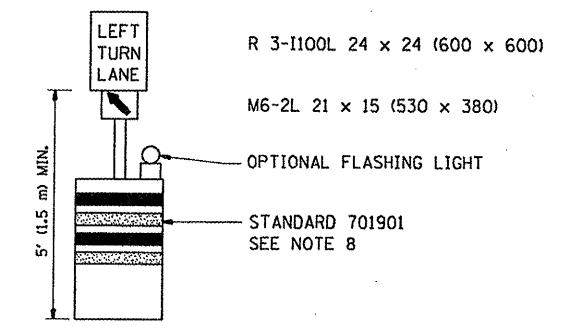
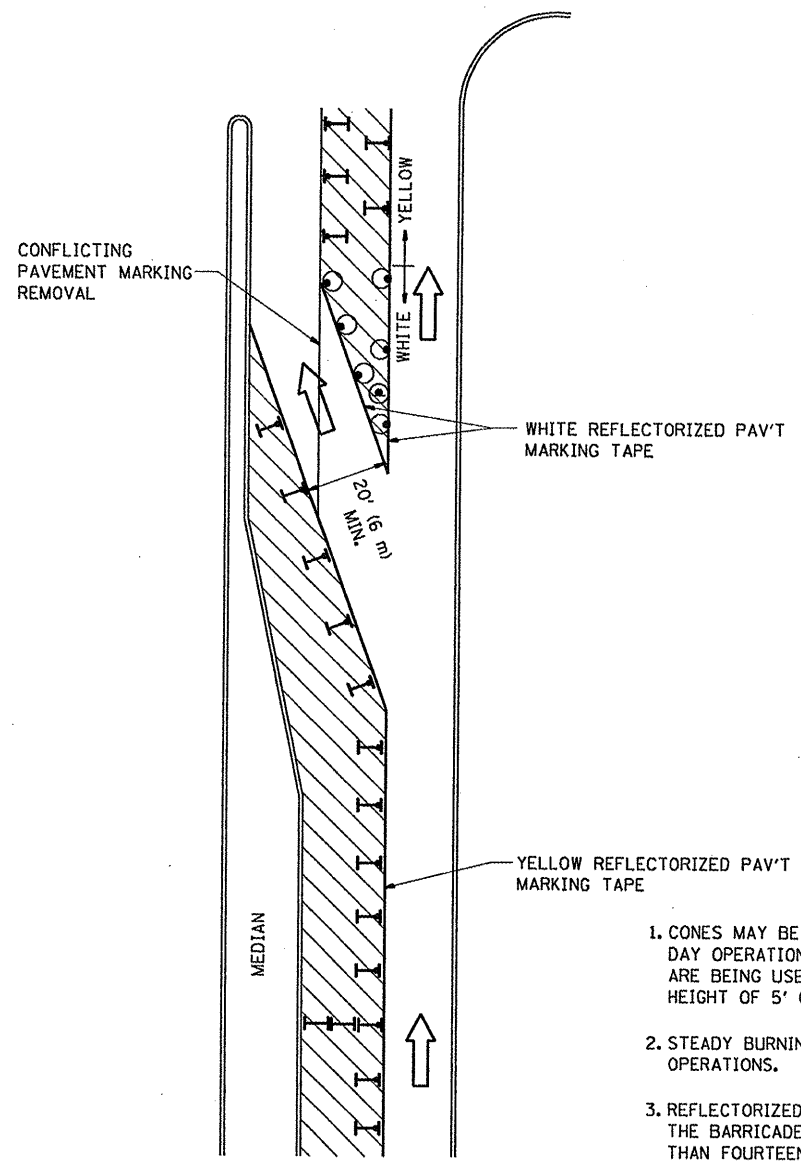



GENERAL NOTES

1. CONES MAY BE SUBSTITUTED FOR BARRICADES OR DRUMS AT HALF THE SPACING DURING DAY OPERATIONS. CONES SHALL BE A MINIMUM OF 28 (710) IN HEIGHT. WHEN CONES ARE BEING USED, THE "LEFT TURN LANE" SIGN MAY BE SKID MOUNTED AT A MINIMUM HEIGHT OF 5' (1.5 m).
2. STEADY BURNING LIGHTS WILL NOT BE REQUIRED ON BARRICADES OR DRUMS FOR DAY OPERATIONS. ALL LIGHTS SHALL BE MONODIRECTIONAL.
3. REFLECTORIZED TEMPORARY PAVEMENT MARKING TAPE SHALL BE PLACED THROUGHOUT THE BARRICADED AREA OF EACH TURN BAY WHERE THE CLOSURE TIME IS GREATER THAN FOURTEEN DAYS.
4. THIS APPLICATION ALSO APPLIES WHEN WORK IS BEING PERFORMED IN THE RIGHT LANE(S) AND THE RIGHT TURN BAY IS TO REMAIN OPEN. UNDER THIS CONDITION, "RIGHT TURN LANE" R3-100 24 x 24 (600 x 600) AND M6-2R 21 x 15 (530 x 380) SHALL BE USED.
5. THESE CONTROLS SHALL SUPPLEMENT MAINLINE TRAFFIC CONTROL FOR LANE CLOSURES.
6. LONGITUDINAL DIMENSIONS MAY BE ADJUSTED TO FIT FIELD CONDITIONS.
7. FORM OPER 725 IS REQUIRED.
8. IF A DRUM OR TYPE II BARRICADE WITH AN ATTACHED SIGN PANEL WHICH MEETS NCHRP 350 REQUIREMENTS IS NOT AVAILABLE, THE SIGNS SHALL BE MOUNTED, ABOVE THE BARRICADES, ON SEPARATE SIGNS SUPPORTS THAT MEET NCHR 350 PREQUIREMENTS.
9. TRAFFIC CONTROL AND PROTECTION AT TURN BAYS (TO REMAIN OPEN TO TRAFFIC) SHALL BE INCLUDED IN THE COST SPECIFIED TRAFFIC CONTROL STANDARDS OR ITEMS.

All dimensions are in inches (millimeters) unless otherwise shown.

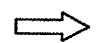
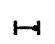
LEGEND

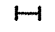
-  WORK AREA
-  LANE OPEN TO TRAFFIC
-  TYPE I OR II BARRICADE WITH STEADY BURN LIGHT
-  DRUM WITH STEADY BURN LIGHT
-  DRUM WITH SIGN (WITH OPTIONAL FLASHING LIGHT) SEE DETAIL
-  TYPE I OR II CHECK BARRICADE WITH FLASHING LIGHT

FILE NAME =	USER NAME = whttetar	REVISED -T. RAMMACHER 09-08-94	REVISED - R. BORO 09-14-09
cr:\pw_work\PW\DOT\WHITETAR\d0175544\Dis	Std.dgn	REVISED - A. HOUSEH 11-07-95	REVISED -
	PLOT SCALE = 1/8" = 1' / IN.	REVISED - A. HOUSEH 10-12-96	REVISED -
	PLOT DATE = 2/10/2010	REVISED -T. RAMMACHER 01-06-00	REVISED -

**STATE OF ILLINOIS
DEPARTMENT OF TRANSPORTATION**

**TRAFFIC CONTROL AND PROTECTION AT TURN BAYS
(TO REMAIN OPEN TO TRAFFIC)**

SCALE: NONE	SHEET NO. 1 OF 1 SHEETS	STA. TO STA.
-------------	-------------------------	--------------

F.A. RTE.	SECTION	COUNTY	TOTAL SHEETS	SHEET NO.
VAR	2010-011 RS	KANE	26	24
TC-14		CONTRACT NO. 60K30		
FED. ROAD DIST. NO. 1 ILLINOIS FED. AID PROJECT				

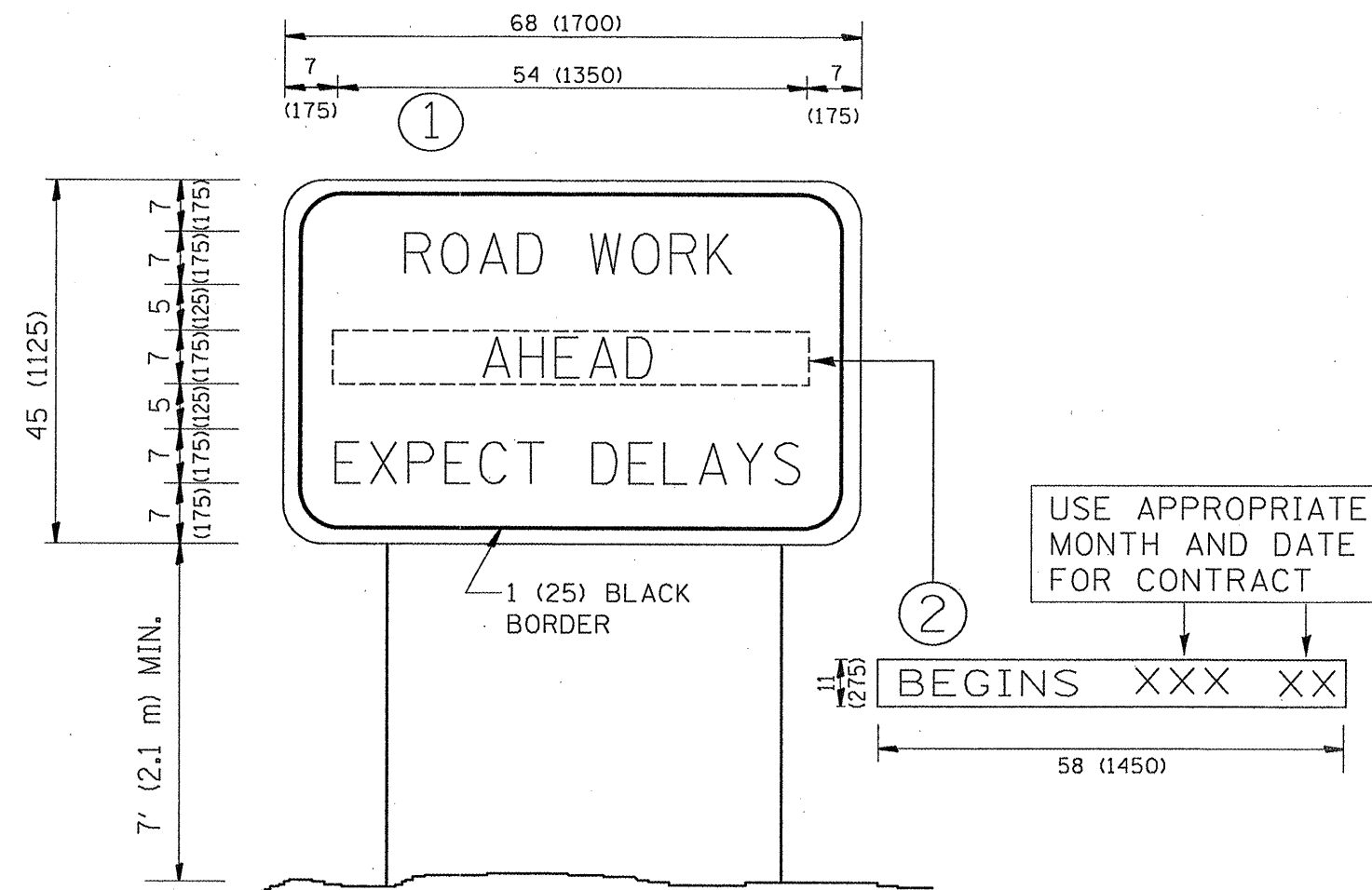

NOTES:

1. USE BLACK LETTERING ON ORANGE BACKGROUND.
2. ERECT SIGNS IN ADVANCE OF THE LOCATION FOR THE "ROAD CONSTRUCTION AHEAD" SIGN AT LOCATIONS AS DIRECTED BY THE ENGINEER.
3. ERECT SIGN ① WITH INSTALLED PANEL ② ONE WEEK PRIOR TO THE START OF CONSTRUCTION.
4. REMOVE PANEL ② SOON AFTER THE START OF CONSTRUCTION.
5. SEE SPECIAL PROVISION FOR "TEMPORARY INFORMATION SIGNING" FOR ADDITIONAL INFORMATION.
6. ONE SIGN ASSEMBLY EQUALS 25.70 SQ. FT. (2.3 SQ. M.)
7. SHALL BE PAID FOR AS TEMPORARY INFORMATION SIGNING.

ALL DIMENSIONS ARE IN INCHES (MILLIMETERS) UNLESS OTHERWISE SHOWN.

FILE NAME =	USER NAME = whitetar	DESIGNED -	REVISED - R. MIRS 09-15-97
et\p\work\PWIDOT\WHITETAR\d0175544\01	Std.dgn	DRAWN -	REVISED - R. MIRS 12-11-97
	PLOT SCALE = 100.0000 "/ IN.	CHECKED -	REVISED - T. RAMMACHER 02-02-99
	PLOT DATE = 2/10/2010	DATE -	REVISED - C. JUCIUS 01-31-07

**STATE OF ILLINOIS
DEPARTMENT OF TRANSPORTATION**

**ARTERIAL ROAD
INFORMATION SIGN**

SCALE: NONE SHEET NO. 1 OF 1 SHEETS STA. TO STA.

F.A. RTE.	SECTION	COUNTY	TOTAL SHEETS	SHEET NO.
VAR	2010-011 RS	KANE	26	25
TC-22		CONTRACT NO. 60K30		
FED. ROAD DIST. NO. 1 ILLINOIS FED. AID PROJECT				

LOOPS NEXT TO SHOULDERS

PROVIDE A PAVEMENT REPLACEMENT NOTE WHICH SHOULD EQUAL 3' (900 mm) X WIDTH OF PAVED SHOULDER.

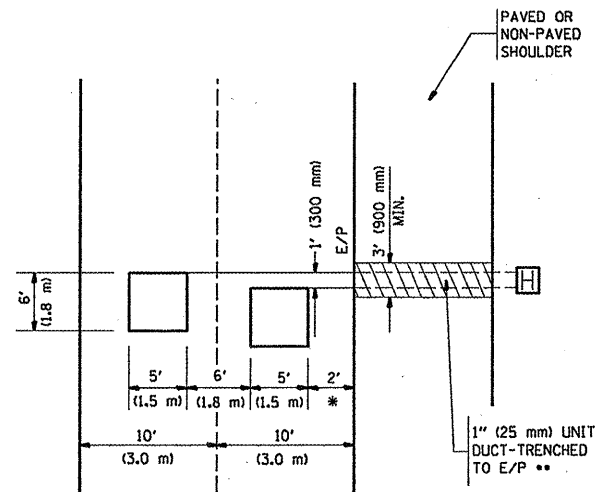

* = (600 mm)

** UNIT DUCT IS TO BE SHOWN ON PLAN SHEETS BUT SHALL NOT BE INCLUDED IN THE PAY ITEMS.

**LEFT TURN LANES WITH MEDIANS
VOLUME DENSITY ("FAR OUT" DETECTION)
ON SAME APPROACH
(PROTECTED / PERMITTED LEFT TURN PHASING)**

HANDHOLE LOCATION MAY VARY DEPENDING ON GEOMETRICS AND DESIGN OF TRAFFIC SIGNALS. HEAVY-DUTY HANDHOLES TO BE USED WHEN THE MEDIAN IS MOUNTABLE. REFER TO STANDARD 814001 TO ENSURE THAT HANDHOLE FITS IN MEDIAN.

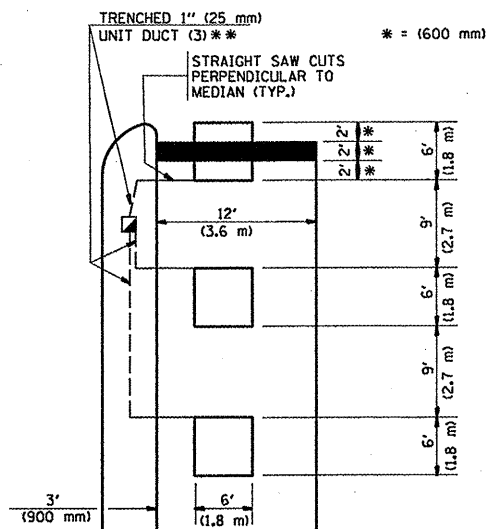

* = (600 mm)

** UNIT DUCT IS TO BE SHOWN ON PLAN SHEETS BUT SHALL NOT BE INCLUDED IN THE PAY ITEMS.

NOTE: DUAL LEFT TURNS NOT SHOWN REFER TO PLAN SHEET FOR DETECTOR LOOP REPLACEMENT

**LEFT TURN LANES WITHOUT MEDIANS
VOLUME DENSITY ("FAR OUT" DETECTION)
ON SAME APPROACH
(PROTECTED / PERMITTED LEFT TURN PHASING)**

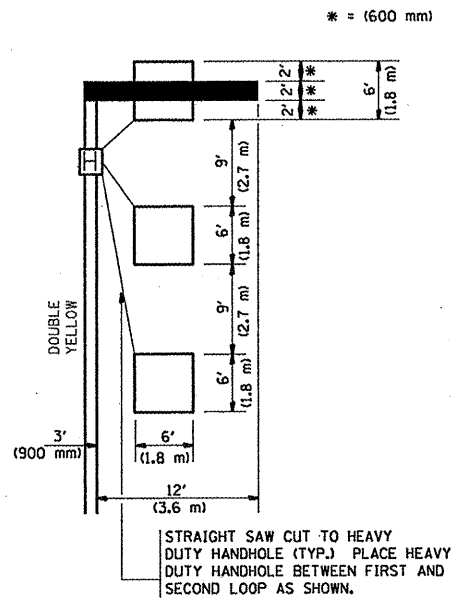

* = (600 mm)

NOTE: DUAL LEFT TURNS NOT SHOWN REFER TO PLAN SHEET FOR DETECTOR LOOP REPLACEMENT

**ARTERIAL-VOLUME DENSITY ("FAR OUT" DETECTION)
CROSS STREET-VOLUME DENSITY ("FAR OUT" DETECTION)**

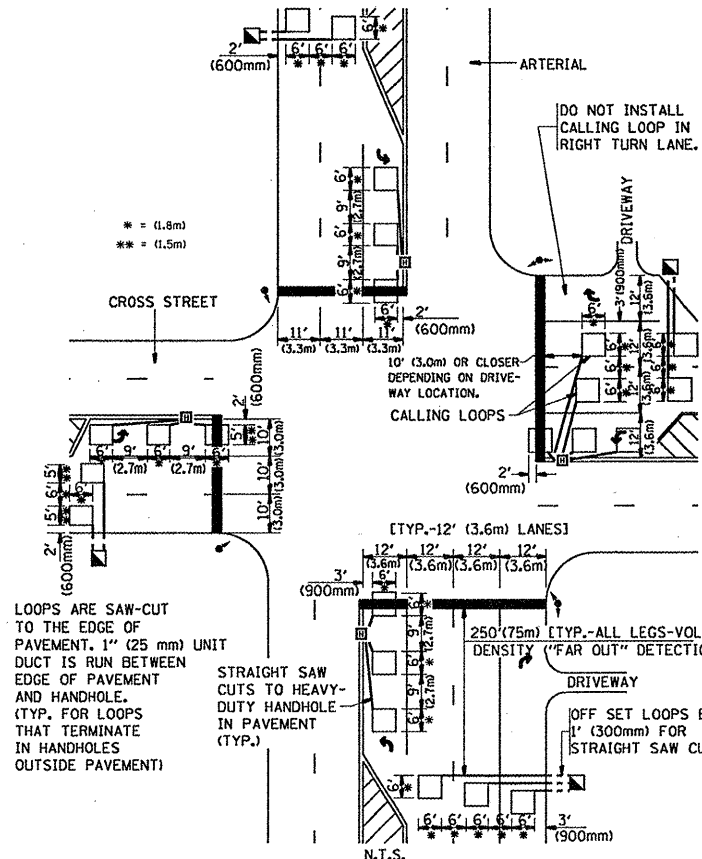

**DETAIL 1
N.T.S.**

**ARTERIAL-VOLUME DENSITY ("FAR OUT" DETECTION)
CROSS STREET-NON VOLUME DENSITY ("UPTIGHT" PRESENCE DETECTION)**

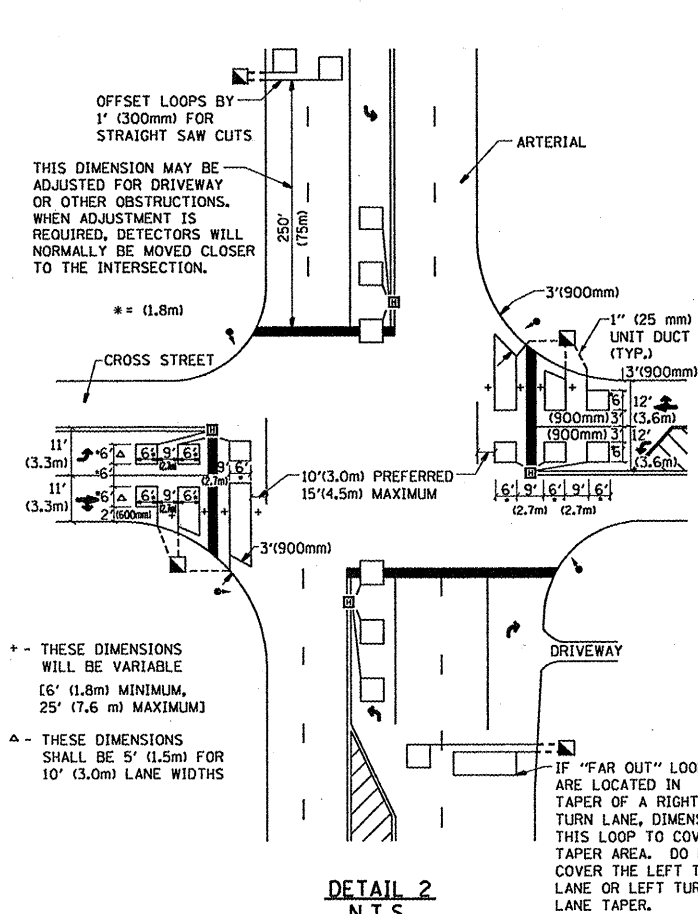

**DETAIL 2
N.T.S.**

NOTES:

VEHICLES LOOP DETECTORS

- * ALL LEAD IN CABLE SHALL BE TWO CONDUCTOR NO. 14 TWISTED, SHIELDED.
- * EACH DETECTOR LOOP SHALL HAVE ITS OWN SAW CUT FROM THE LOOP TO THE EDGE OF PAVEMENT OR TO A HANDHOLE IN THE PAVEMENT.
- * EACH DETECTOR LOOP SHALL HAVE ITS OWN ONE INCH (25 mm) UNIT DUCT BETWEEN THE EDGE OF PAVEMENT AND THE FIRST HANDHOLE OR JUNCTION BOX. EACH UNIT DUCT RUN SHALL BE SHOWN ON THE PLANS BY THE DESIGNER, BUT SHALL NOT BE PAID FOR SEPARATELY. THIS ITEM IS INCIDENTAL TO THE PAY ITEM FOR DETECTOR LOOPS.
- * ONE DIMENSION OF ALL DETECTOR LOOPS SHALL BE SIX FEET (1.8 m)
- * EACH LANE OF NON-LOCKING, PRESENCE DETECTION AND EACH LANE OF A DOUBLE LEFT TURN LANE REQUIRES A SEPARATE INDUCTIVE LOOP DETECTOR AND LEAD IN CABLE.
- * WHEN NON-LOCKING, PRESENCE DETECTION IS USED, MORE THAN ONE LOOP PER LANE IS REQUIRED BEHIND THE STOP BAR (i.e. 1-1/2, 1-3/4, 2).
- * WHEN SYSTEM LOOPS ARE REQUIRED ON AN APPROACH OF AN INTERSECTION, THE LOOPS USED FOR VOLUME DENSITY AND INTERSECTION TIMING SHALL ALSO BE USED AS SYSTEM DETECTORS. EACH ONE OF THESE TYPE OF LOOPS REQUIRES A SEPARATE TWO CONDUCTOR NO. 14 TWISTED SHIELDED CABLE AND A SEPARATE INDUCTIVE LOOP DETECTOR WHEN NEW CONTROLLERS ARE UTILIZED. THE DESIGNER SHALL LABEL THESE TYPES OF LOOPS AS "INTERSECTION AND SAMPLING (SYSTEM) DETECTORS" ON THE SIGNAL LAYOUT, THE INTERCONNECT PLAN AND THE SYSTEM CABLE PLAN. WHEN AN EXISTING CONTROLLER IS UTILIZED FOR THIS TYPE OF DETECTION, THE PAY ITEM "INDUCTIVE LOOP DETECTOR WITH SYSTEM OUTPUT" SHOULD BE USED.

PLACEMENT OF DETECTORS

THE FOLLOWING FIGURES REPRESENT THE MOST COMMON DETECTOR LOOP LOCATIONS AND SIZES. ADJUSTMENTS WILL BE NECESSARY FOR SPECIFIC GEOMETRIC CONSIDERATIONS.

LOCATIONS AND DEMENSIONS OF DETECTOR LOOPS ARE REQUIRED ON ALL SIGNAL LAYOUT PLAN SHEETS.

"FAR OUT" DETECTION REFERS TO LOCKING, PRESENCE TYPE DETECTION LOCATED IN THRU LANES, RIGHT TURN LANES, AND RIGHT TURN LANE TAPER AREAS (IF APPLICABLE), USUALLY 250' (75 m) IN ADVANCE OF STOP BARS. "UPTIGHT" DETECTION REFERS TO NON-LOCKING PRESENCE TYPE DETECTION LOCATED IN ALL LANES AND 10'-15' (3.0 m-4.5 m) BEHIND THE CROSSING STREET'S EDGE OF PAVEMENT EXTENDED.

NOTE:

ALL DETAILS AND NOTES SHOWN ARE FROM THE I.D.O.T. DISTRICT 1 TRAFFIC SIGNAL DESIGN GUIDELINES DATED JANUARY 1995

THIS DRAWING HAS BEEN PREPARED TO ASSIST THE RESIDENT ENGINEER FOR ALL ROADWAY RESURFACING OR S.M.A.R.T. PROJECTS WHERE THE DIMENSIONS ARE NOT SHOWN ON THE PLANS AND THE FINAL LOCATIONS FOR CROSSWALKS OR STOP BARS ARE NOT DETERMINED.

FILE NAME =	USER NAME = whitetar	DESIGNED -	REVISED -	STATE OF ILLINOIS DEPARTMENT OF TRANSPORTATION	DISTRICT 1 - DETECTOR LOOP INSTALLATION DETAILS FOR ROADWAY RESURFACING	F.A. -	SECTION	COUNTY	TOTAL SHEETS	SHEET NO.
os:\p\work\VP\W00T\WHITETAR\d0175544\013	Std.dgn	DRAWN -	REVISED -			VAR	2010-011 RS	KANE	26	26
	PLOT SCALE = 100.0000 ' / IN.	CHECKED - R.K.F.	REVISED -			TS-07		CONTRACT NO. 60K30		
	PLOT DATE = 2/10/2010	DATE -	REVISED -			SCALE: NONE	SHEET NO. 1 OF 1 SHEETS	STA.	TO STA.	FED. ROAD DIST. NO. 1 ILLINOIS FED. AID PROJECT