

**AUXILIARY LANE MARKINGS**

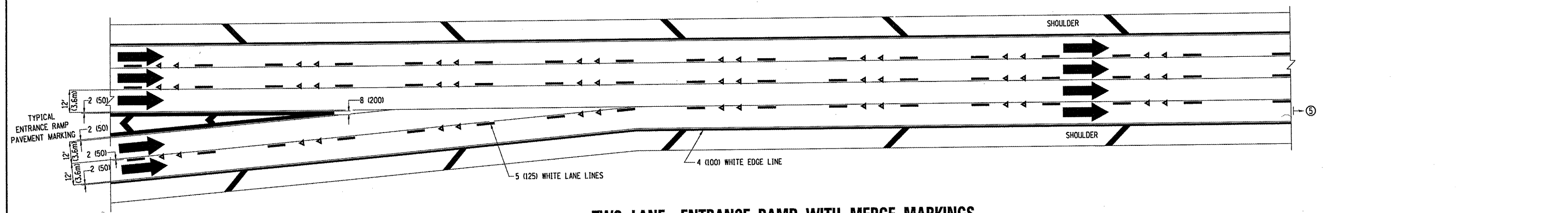

**TWO LANE ENTRANCE RAMP WITH MERGE MARKINGS**

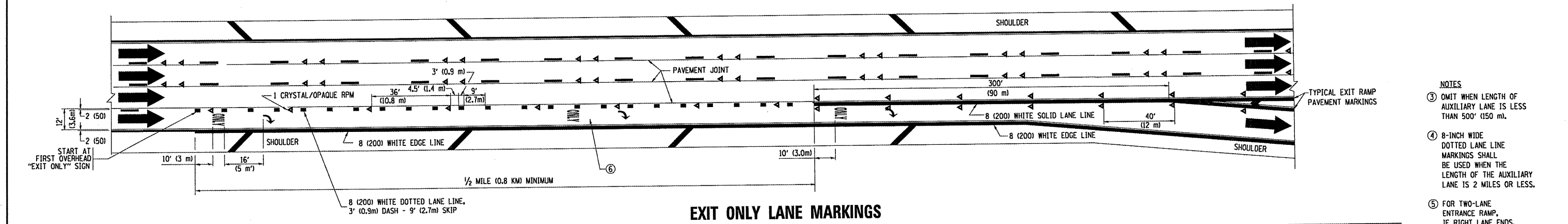

**EXIT ONLY LANE MARKINGS**

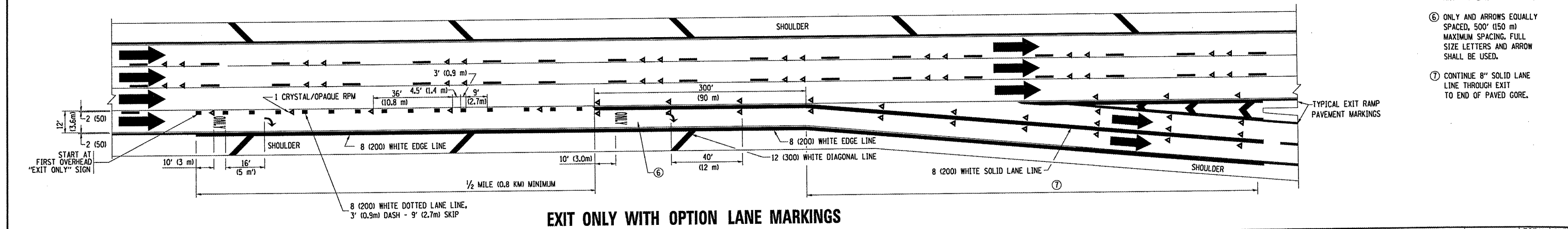

**EXIT ONLY WITH OPTION LANE MARKINGS**

- NOTES**
- ③ OMIT WHEN LENGTH OF AUXILIARY LANE IS LESS THAN 500' (150 m).
  - ④ 8-INCH WIDE DOTTED LANE LINE MARKINGS SHALL BE USED WHEN THE LENGTH OF THE AUXILIARY LANE IS 2 MILES OR LESS.
  - ⑤ FOR TWO-LANE ENTRANCE RAMP, IF RIGHT LANE ENDS, USE TYPICAL ENTRANCE RAMP PAVEMENT MARKINGS.
  - ⑥ ONLY AND ARROWS EQUALLY SPACED, 500' (150 m) MAXIMUM SPACING. FULL SIZE LETTERS AND ARROW SHALL BE USED.
  - ⑦ CONTINUE 8" SOLID LANE LINE THROUGH EXIT TO END OF PAVED GORE.

FILE NAME = c:\pwwork\VP\WIDOT\WILGREENDP\0183621\0	USER NAME = wilgreendp	DESIGNED - D.W.S.	REVISED - D.W.S. 07-96	<b>STATE OF ILLINOIS DEPARTMENT OF TRANSPORTATION</b>	<b>MULTI-LANE FREEWAY PAVEMENT MARKING DETAILS</b>		F.A. RTE. =	SECTION	COUNTY	TOTAL SHEETS	SHEET NO.
	DRAWN -	CHECKED -	DATE - 01-90		REVISED - J.A.F. 02-06	REVISED - S.P.B. 01-07	REVISED - S.P.B. 01-10	VAR. =	2010-014 RS	COOK	34
PLOT SCALE = 100.0000' / IN.				SCALE: NONE				TC-12		CONTRACT NO. 60K33	
PLOT DATE = 2/20/2010				SHEET NO. 2 OF 2 SHEETS				FED. ROAD DIST. NO. 1 ILLINOIS FED. AID PROJECT		STA. TO STA.	