

STATE OF ILLINOIS
DEPARTMENT OF TRANSPORTATION
DIVISION OF HIGHWAYS
PLANS FOR
PROPOSED FEDERAL
AID HIGHWAY

FAU ROUTE 1285 (PALATINE ROAD)
AT PLUM GROVE ROAD INTERSECTION
INTERSECTION IMPROVEMENT
SECTION 02-00075-00-PV
PROJECT NO. ARA-F-CMF-0305(038)
JOB NO. C-91-121-05
VILLAGE OF PALATINE
COOK COUNTY

F.A.U.	FISCAL YEAR	SHEET NO.	TOTAL SHEETS
1285	2008	1	161

SECTION: 02-00075-00-PV

CONTRACT NO. 63083

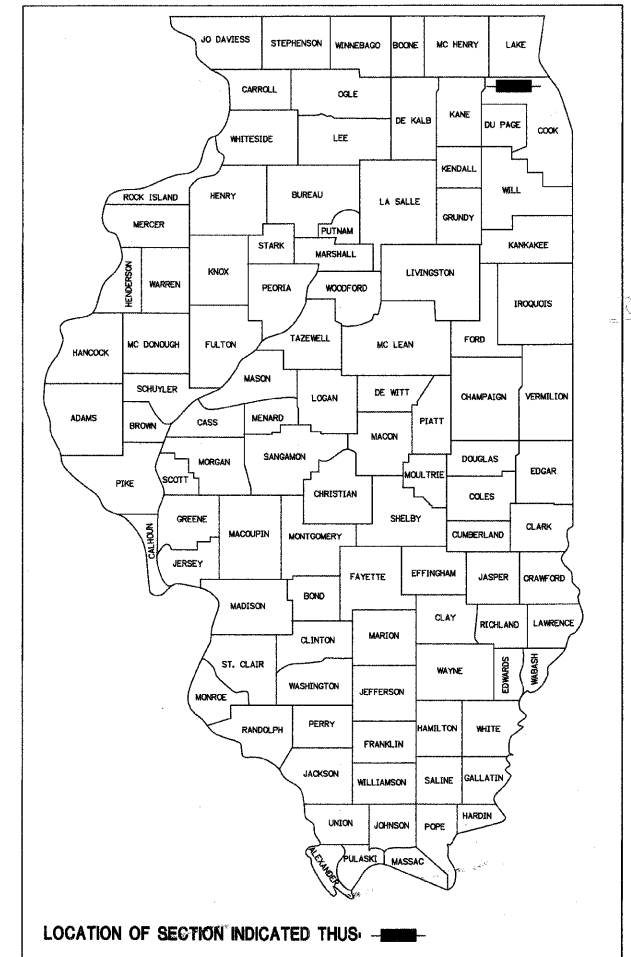

FOR INDEX OF SHEETS, SEE SHEET NO. 2

FOR HIGHWAY STANDARDS, SEE SHEET NO. 2

PROJECT LOCATED IN VILLAGE OF PALATINE

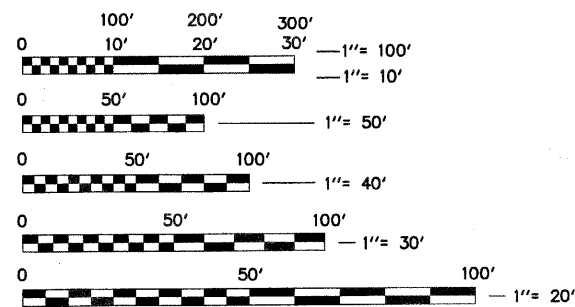

FULL SIZE PLANS HAVE BEEN PREPARED USING STANDARD ENGINEERING SCALES. REDUCED SIZED PLANS WILL NOT CONFORM TO STANDARD SCALES. IN MAKING MEASUREMENTS ON REDUCED PLANS, THE ABOVE SCALES MAY BE USED.

J.U.L.I.E.
JOINT UTILITY LOCATION INFORMATION FOR EXCAVATION. 1-800-892-0123 OR 811

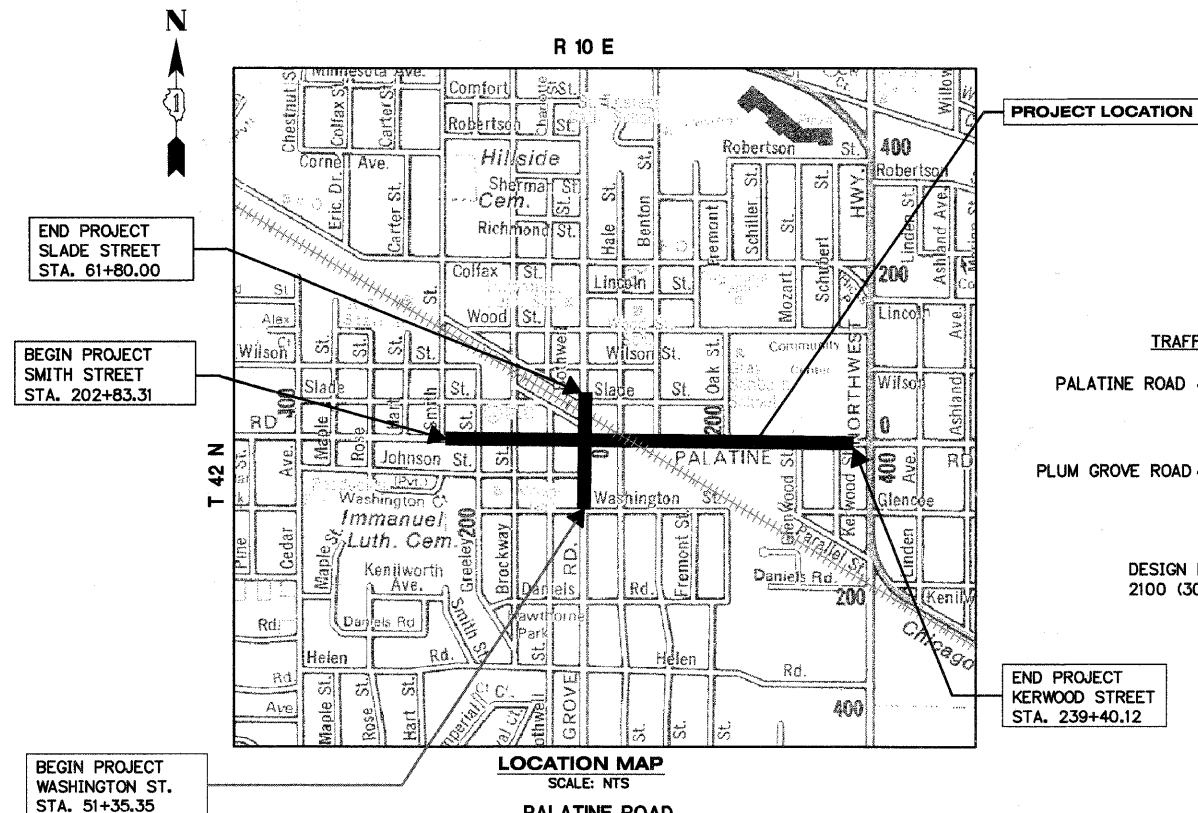

LOCATION MAP
SCALE: NTS

PALATINE ROAD
GROSS LENGTH = 3656.45 FEET (0.6925) MILES
PLUM GROVE ROAD
GROSS LENGTH = 984.63 FEET (0.1865) MILES
TOTAL NET LENGTH = 4641.08 FEET (0.8790) MILES

TRAFFIC DATA:

PALATINE ROAD { 2006 ADT = 20,000
2030 ADT = 28,000
SPEED LIMIT = 30 MPH
PLUM GROVE ROAD { 2006 ADT = 12,400
2030 ADT = 19,000
SPEED LIMIT = 30 MPH

DESIGN DESIGNATION:
2100 (30) MINOR ARTERIALS

STATE OF ILLINOIS DEPARTMENT OF TRANSPORTATION DIVISION OF HIGHWAYS	
APPROVED	October 22, 2009 <i>W. J. P. [Signature]</i> VILLAGE ENGINEER
PASSED	October 28, 2009 <i>C. H. [Signature]</i> DISTRICT 1 ENGINEER LOCAL ROADS & STREETS
RELEASING FOR BID BASED ON LIMITED REVIEW	October 29, 2009 <i>Diane M. O'Keefe [Signature]</i> DEPUTY DIRECTOR OF HIGHWAYS, REGION 1 ENGINEER



Expires: 11/30/11

October 22, 2009
Alan R. Swanson [Signature]
ALAN R. SWANSON, McDONOUGH ASSOCIATES INC.

PRINTED BY THE AUTHORITY OF THE STATE OF ILLINOIS

ASSOCIATE FIELD ENGINEER - KEVIN STALLWORTH (847) 705-4169

CONTRACT NO. 63083