

F.A.P. RTE.	SECTION	COUNTY	TOTAL SHEETS	SHEET NO.
1285	02-00075-00-PV	COOK	161	27
STA. _____ TO STA. _____		FED. ROAD DIST. NO. ILLINOIS FED. AID PROJECT		

DATE	BY	REVISIONS
		1. SUBMITTED
		2. PLOTTED
		3. CHECKED
		4. DATE FILED
		5. FILE NAME
		6. NO.

DATE	BY	REVISIONS
		1. SUBMITTED
		2. PLOTTED
		3. CHECKED
		4. DATE FILED
		5. FILE NAME
		6. NO.

EXISTING LEGEND

- XXXXX PCC SIDEWALK REMOVAL
- DRIVEWAY REMOVAL
- PAVEMENT REMOVAL
- 20" TREE REMOVAL

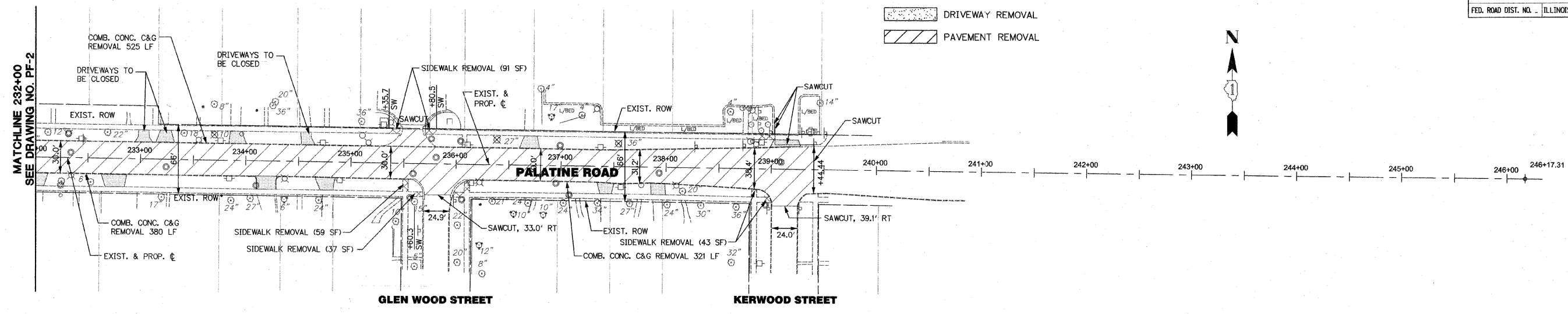

EXISTING CONDITIONS

PROPOSED LEGEND

- PROPOSED PAVEMENT
- C.D. - COMMERCIAL DRIVEWAY
- P.D. - PRIVATE DRIVEWAY
- * - CURB RAMP

NOTE 1: ALL THE EXISTING DRIVEWAYS WITHIN THE EXISTING R.O.W. ARE P.C.C. PAVEMENT

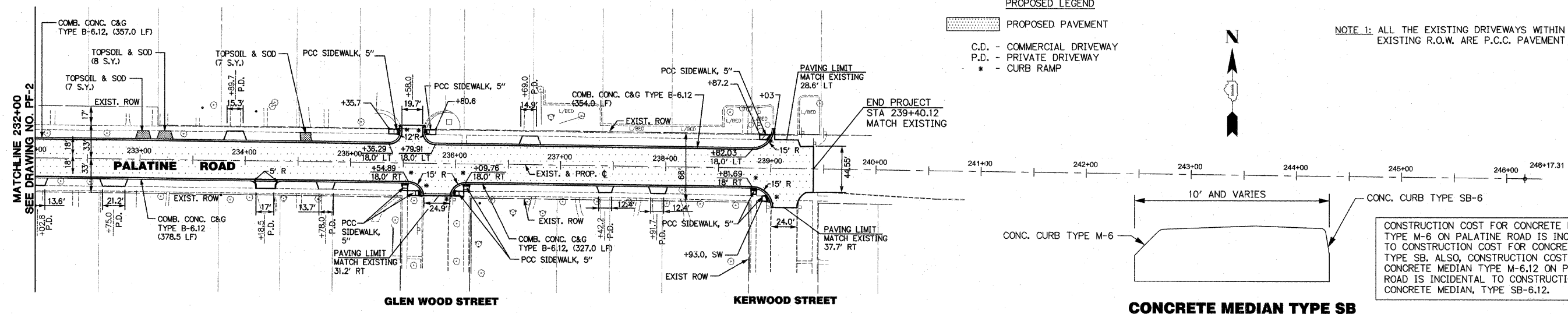

CONCRETE MEDIAN TYPE SB

CONSTRUCTION COST FOR CONCRETE MEDIAN TYPE M-6 ON PALATINE ROAD IS INCIDENTAL TO CONSTRUCTION COST FOR CONCRETE MEDIAN, TYPE SB. ALSO, CONSTRUCTION COST FOR CONCRETE MEDIAN TYPE M-6.12 ON PLUM GROVE ROAD IS INCIDENTAL TO CONSTRUCTION COST FOR CONCRETE MEDIAN, TYPE SB-6.12.

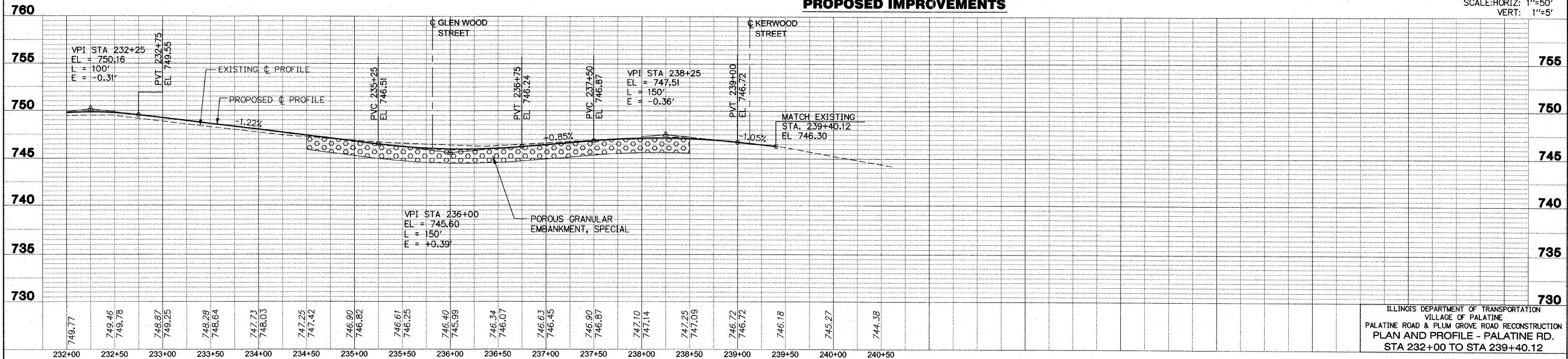

SCALE: HORIZ: 1"=50'
VERT: 1"=5'